

TEMPORARY 4 INCH WHITE LINE, PAINT
 DURABLE 4 INCH WHITE LINE
 191+00 TO 202+00 SOLID LT & RT

TEMPORARY 4 INCH YELLOW LINE, PAINT
 DURABLE 4 INCH YELLOW LINE
 191+00 TO 202+00 SOLID LT & RT

REMOVAL OF EXISTING BRIDGE RAILING
 191+07 TO 191+32 RT
 191+38 TO 191+76 LT

BRIDGE RAILING REPAIR, TYPE III
 191+06.8 TO 191+31.8 RT
 191+38.3 TO 191+75.8 LT

STEEL BEAM GUARDRAIL, GALVANIZED
 191+00 TO 191+07 LT
 191+63 TO 192+00.5 RT
 192+00.8 TO 192+13.3 LT

H.D. STEEL BEAM
 GUARDRAIL, GALVANIZED
 191+00 TO 191+06.8 RT
 191+07 TO 191+38.3 LT
 191+31.8 TO 191+63 RT
 191+75.8 TO 192+00.8 LT

ANCHOR FOR STEEL BEAM RAIL
 192+00.5 RT
 192+13.3 LT

REMOVAL AND DISPOSAL OF GUARDRAIL
 191+00 TO 191+07 RT
 191+00 TO 191+38 LT
 191+32 TO 191+96 RT
 191+76 TO 192+10 LT

DELINEATOR WITH STEEL POST
 192+00.5 RT
 192+13.3 LT

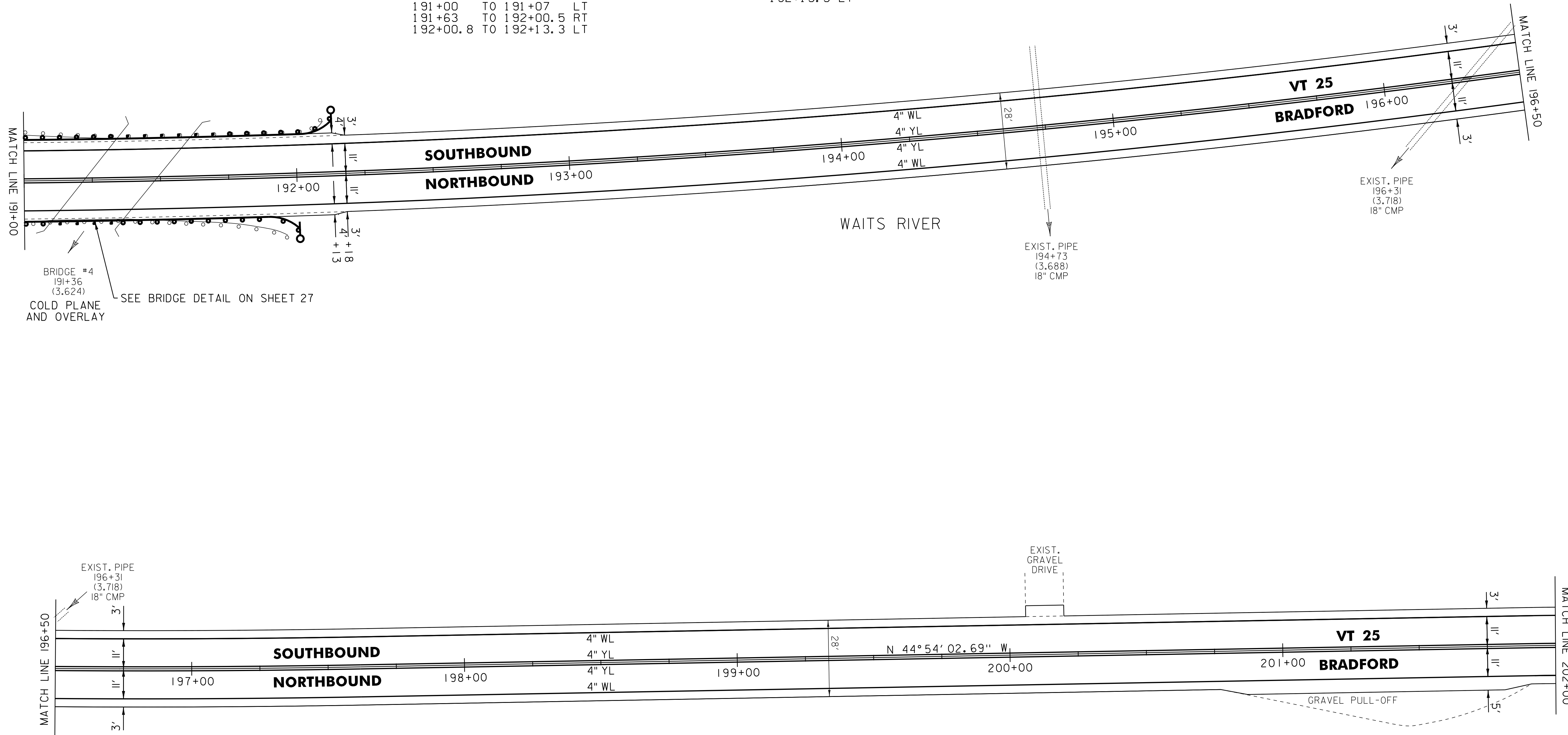

LEGEND

- R = REMOVE EXISTING
- S = SALVAGED
- R&S = REMOVE AND SALVAGE
- N = NEW
- RET = RETAIN
- B-B = BACK TO BACK
- = EXISTING GUARDRAIL
- = PROPOSED GUARDRAIL
- YL = YELLOW LINE
- WL = WHITE LINE
- = DELINEATOR
- ||||||| = RUMBLE STRIP

ROADWAY LAYOUT 24 VT 25

PROJECT NAME: BRADFORD	PLOT DATE: 03-SEP-2014 12:51
PROJECT NUMBER: STP 2917(I)	DRAWN BY: SNG
FILE NAME: p10b236.dgn	CHECKED BY: PTS
PROJECT LEADER: PTS	SHEET 65 OF 105
DESIGNED BY: NULL	
IPARM FILE NAME: p10b236_65	

NOT TO SCALE