

TEMPORARY 4 INCH WHITE LINE, PAINT
 DURABLE 4 INCH WHITE LINE
 180+00 TO 191+00 SOLID LT & RT

TEMPORARY 4 INCH YELLOW LINE, PAINT
 DURABLE 4 INCH YELLOW LINE
 180+00 TO 191+00 SOLID LT & RT

STEEL BEAM GUARDRAIL, GALVANIZED
 190+56.8 TO 190+81.8 RT
 190+69.5 TO 191+00 LT

H.D. STEEL BEAM
 GUARDRAIL, GALVANIZED
 190+81.8 TO 191+00 RT

ANCHOR FOR STEEL BEAM RAIL
 190+56.8 RT
 190+69.5 LT

REMOVAL AND DISPOSAL OF GUARDRAIL
 190+60 TO 191+00 RT
 190+76 TO 191+00 LT

DELINEATOR WITH STEEL POST
 190+56.8 RT
 190+69.5 LT

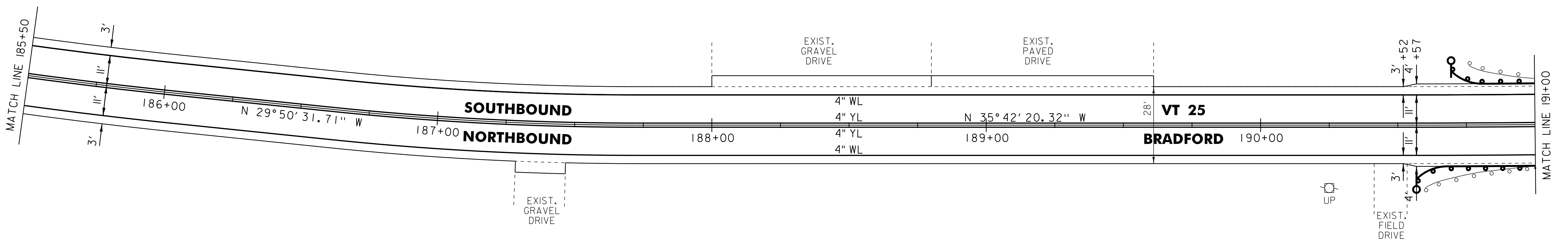
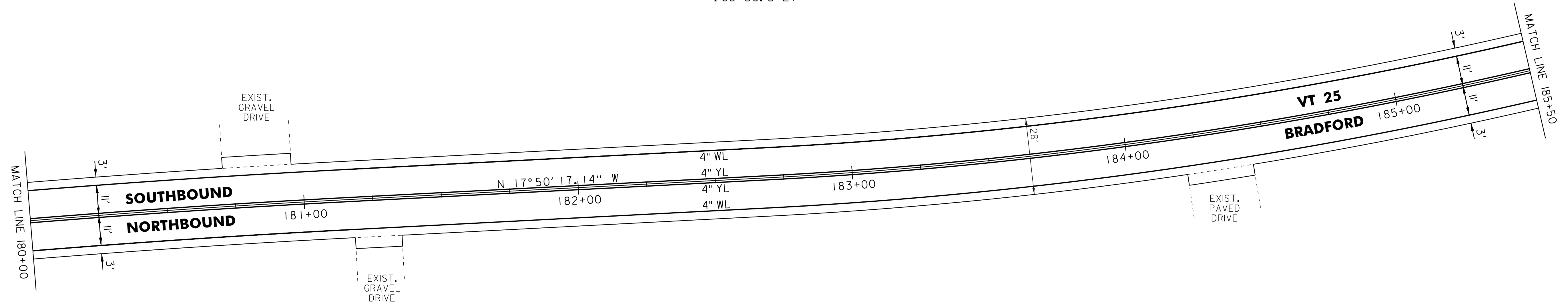

LEGEND

- R = REMOVE EXISTING
- S = SALVAGED
- R&S = REMOVE AND SALVAGE
- N = NEW
- RET = RETAIN
- B-B = BACK TO BACK
- = EXISTING GUARDRAIL
- = PROPOSED GUARDRAIL
- = YELLOW LINE
- = WHITE LINE
- = DELINEATOR
- = RUMBLE STRIP

ROADWAY LAYOUT 23 VT 25

PROJECT NAME: BRADFORD

PROJECT NUMBER: STP 2917(I)

FILE NAME: p10b236.dgn

PROJECT LEADER: PTS

DESIGNED BY: NULL

IPARM FILE NAME: p10b236_64

PLOT DATE: 03-SEP-2014 12:51

DRAWN BY: SNG

CHECKED BY: PTS

SHEET 64 OF 105

NOT TO SCALE