

TEMPORARY 4 INCH WHITE LINE, PAINT
 DURABLE 4 INCH WHITE LINE
 169+00 TO 180+00 SOLID LT & RT

TEMPORARY 4 INCH YELLOW LINE, PAINT
 DURABLE 4 INCH YELLOW LINE
 169+00 TO 180+00 SOLID LT & RT

STEEL BEAM GUARDRAIL, GALVANIZED
 169+00 TO 178+65 RT

ANCHOR FOR STEEL BEAM RAIL
 178+65 RT

REMOVAL AND DISPOSAL OF GUARDRAIL
 169+00 TO 178+69 RT

DELINEATOR WITH STEEL POST
 178+65 RT

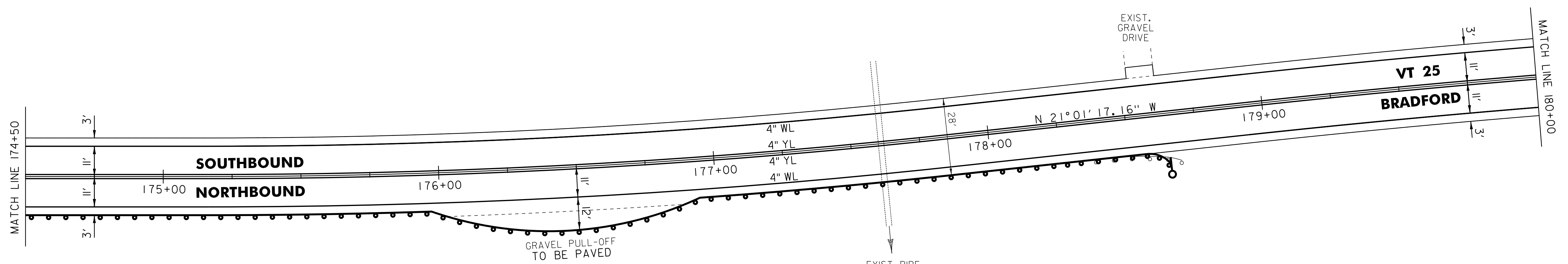
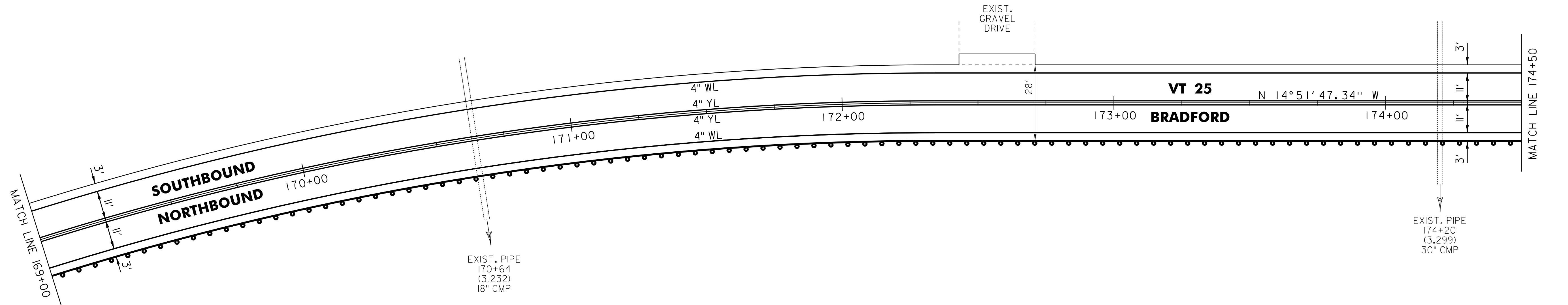

LEGEND

- R = REMOVE EXISTING
- S = SALVAGED
- R&S = REMOVE AND SALVAGE
- N = NEW
- RET = RETAIN
- B-B = BACK TO BACK
- = EXISTING GUARDRAIL
- = PROPOSED GUARDRAIL
- YL = YELLOW LINE
- WL = WHITE LINE
- = DELINEATOR
- ||||||| = RUMBLE STRIP

ROADWAY LAYOUT 22 VT 25

PROJECT NAME: BRADFORD

PROJECT NUMBER: STP 2917(I)

FILE NAME: p10b236.dgn

PROJECT LEADER: PTS

DESIGNED BY: NLL

IPARM FILE NAME: p10b236_63

PLOT DATE: 03-SEP-2014 12:50

DRAWN BY: SNG

CHECKED BY: PTS

SHEET 63 OF 105

NOT TO SCALE