

TEMPORARY 4 INCH WHITE LINE, PAINT
 DURABLE 4 INCH WHITE LINE
 92+75 TO 104+00 SOLID LT & RT

TEMPORARY 4 INCH YELLOW LINE, PAINT
 DURABLE 4 INCH YELLOW LINE
 92+75 TO 104+00 SOLID LT & RT

**END COLD PLANE
 AND OVERLAY** **BEGIN LEVEL
 AND OVERLAY**

STEEL BEAM GUARDRAIL, GALVANIZED
 95+55 TO 99+55 LT

STEEL BEAM GUARDRAIL,
 GALVANIZED W/8 FEET POSTS
 95+49 TO 100+24 RT

ANCHOR FOR STEEL BEAM RAIL
 95+49 RT
 95+55 LT
 99+55 LT
 100+24 RT

REMOVAL AND DISPOSAL OF GUARDRAIL

95+49 TO 99+88 RT
 95+55 TO 99+55 LT

DELINEATOR WITH STEEL POST

95+49 RT
 95+55 LT
 99+55 LT
 100+24 RT

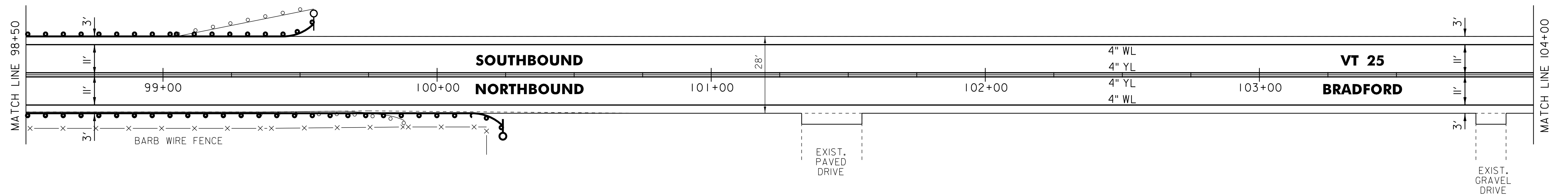
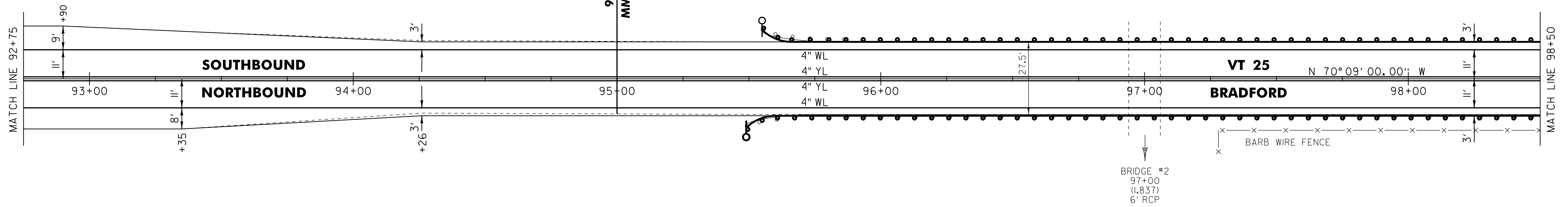

LEGEND

- R = REMOVE EXISTING
- S = SALVAGED
- R&S = REMOVE AND SALVAGE
- N = NEW
- RET = RETAIN
- B-B = BACK TO BACK
- = EXISTING GUARDRAIL
- = PROPOSED GUARDRAIL
- YL = YELLOW LINE
- WL = WHITE LINE
- = DELINEATOR
- ||||||| = RUMBLE STRIP

ROADWAY LAYOUT 14 VT 25

PROJECT NAME: BRADFORD

PROJECT NUMBER: STP 2917(I)

FILE NAME: p10b236.dgn

PROJECT LEADER: PTS

DESIGNED BY: NULL

IPARM FILE NAME: p10b236_55

PLOT DATE: 03-SEP-2014 12:50

DRAWN BY: SNG

CHECKED BY: PTS

SHEET 55 OF 105

NOT TO SCALE