

TEMPORARY 4 INCH WHITE LINE, PAINT
 DURABLE 4 INCH WHITE LINE
 87+50 TO 91+59 SOLID LT
 87+50 TO 89+22 SOLID RT
 89+61 TO 92+75 SOLID RT
 91+59 TO 91+90 SOLID LT (TH 2)
 92+12 TO 92+42 SOLID LT (TH 2)
 92+42 TO 92+75 SOLID LT

TEMPORARY 4 INCH YELLOW LINE, PAINT
 DURABLE 4 INCH YELLOW LINE
 87+50 TO 89+23 SOLID LT & RT
 89+63 TO 91+80 SOLID LT & RT
 92+00 TO 92+01 DOUBLE SOLID LT (TH 2)
 92+20 TO 92+75 SOLID LT & RT

TEMPORARY 24 INCH STOP BAR, PAINT
 DURABLE 24 INCH STOP BAR
 91+84 TO 92+00 LT (TH 2)
 TEMPORARY LETTER OR SYMBOL, PAINT
 DURABLE LETTER OR SYMBOL
 91+94 LT - "STOP" (TH 2)

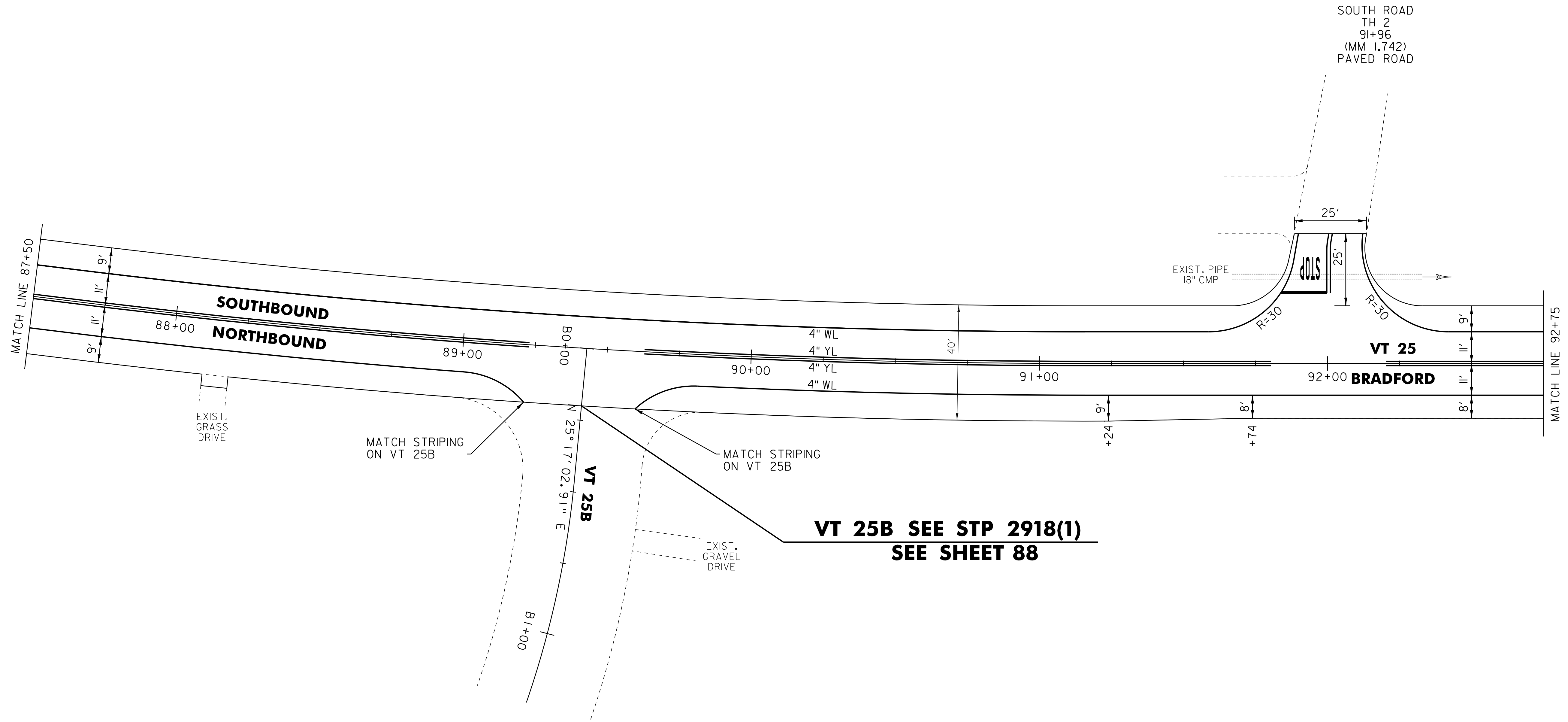

**VT 25B SEE STP 2918(1)
 SEE SHEET 88**

NOT TO SCALE

LEGEND

- R = REMOVE EXISTING
- S = SALVAGED
- R&S = REMOVE AND SALVAGE
- N = NEW
- RET = RETAIN
- B-B = BACK TO BACK
- = EXISTING GUARDRAIL
- = PROPOSED GUARDRAIL
- YL = YELLOW LINE
- WL = WHITE LINE
- = DELINEATOR
- ||||||| = RUMBLE STRIP

ROADWAY LAYOUT 13 VT 25

PROJECT NAME: BRADFORD	PLOT DATE: 03-SEP-2014 12:50
PROJECT NUMBER: STP 2917(1)	DRAWN BY: SNG
FILE NAME: p10b236.dgn	CHECKED BY: PTS
PROJECT LEADER: PTS	SHEET 54 OF 105
DESIGNED BY: NULL	
IPARM FILE NAME: p10b236_54	