

TEMPORARY 4 INCH WHITE LINE, PAINT
 DURABLE 4 INCH WHITE LINE
 5+00 TO 9+00 SOLID LT
 5+00 TO 15+50 SOLID RT
 10+25 TO 15+50 SOLID LT

TEMPORARY 4 INCH YELLOW LINE, PAINT
 DURABLE 4 INCH YELLOW LINE
 5+00 TO 9+30 SOLID LT & RT
 9+70 TO 15+50 SOLID LT & RT

TEMPORARY RAILROAD CROSSING SYMBOL, PAINT
 DURABLE RAILROAD CROSSING SYMBOL
 12+66 RT

CHANGING ELEVATION OF DROP
 INLETS, CATCH BASINS, OR MANHOLES
 (TO BE ADJUSTED BY OTHERS)
 13+77 LT (TMH)

REMOVING SIGNS
 AS SHOWN - 1

INDUSTRIAL DRIVE
 TH 47
 9+65
 (MM 0.183)
 PAVED ROAD

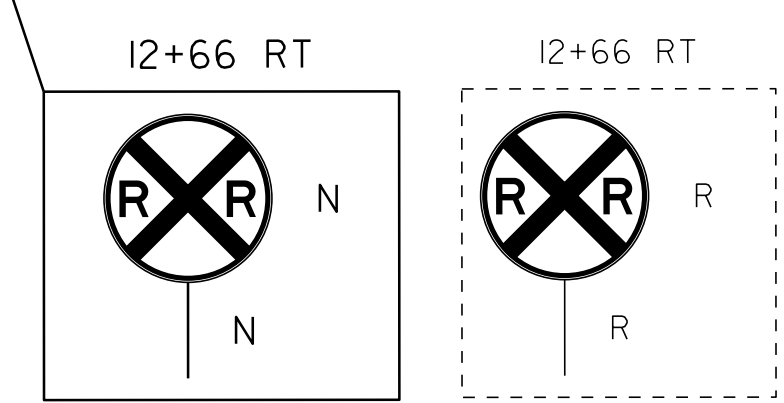
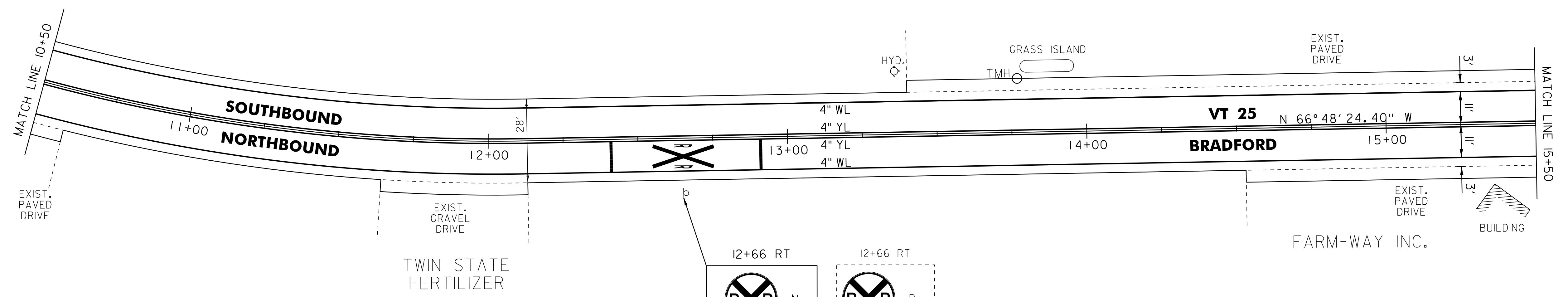
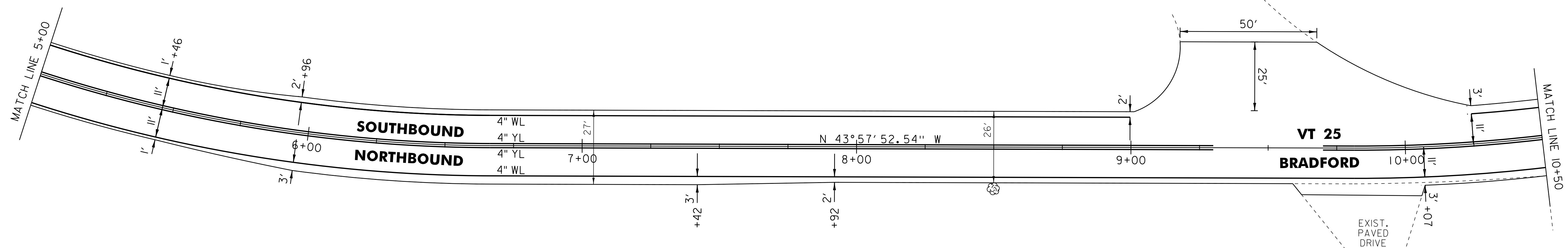

- LEGEND**
- R = REMOVE EXISTING
 - S = SALVAGED
 - R&S = REMOVE AND SALVAGE
 - N = NEW
 - RET = RETAIN
 - B-B = BACK TO BACK
 - = EXISTING GUARDRAIL
 - = PROPOSED GUARDRAIL
 - YL = YELLOW LINE
 - WL = WHITE LINE
 - = DELINEATOR
 - = RUMBLE STRIP

ROADWAY LAYOUT 2 VT 25

PROJECT NAME:	BRADFORD	FILE NAME:	pl0b236.dgn	PLOT DATE:	03-SEP-2014 12:50
PROJECT NUMBER:	STP 2917(I)	PROJECT LEADER:	PTS	DRAWN BY:	SNG
		DESIGNED BY:	NLL	CHECKED BY:	PTS
		IPARM FILE NAME:	pl0b236_41	SHEET	41 OF 105

NOT TO SCALE