

~~646.402 DURABLE 4 INCH WHITE LINE, THERMOPLASTIC OR  
646.404 DURABLE 4 INCH WHITE LINE, POLYUREA  
(ALL LINES WILL INCLUDE EDGE LINE BREAKS AND  
RADIUS FOR TOWN HIGHWAYS)  
STOCKBRIDGE:  
STA 335+50.00 - STA 341+50.00 LT & RT~~

646.602 TEMPORARY 4 INCH WHITE LINE, PAINT  
(ALL LINES WILL INCLUDE EDGE LINE BREAKS AND  
RADIUS FOR TOWN HIGHWAYS)  
STOCKBRIDGE:  
STA 335+50.00 - STA 341+50.00 LT & RT

213.10 MILLED RUMBLE STRIPS  
(ALL CLRS WILL INCLUDE C/L  
BREAKS FOR TOWN HIGHWAYS)  
STOCKBRIDGE:  
STA 335+50.0 - STA ~~341+50.0~~ C/L (600.0 LF)  
340+75.0

646.414 DURABLE 4 INCH YELLOW LINE, POLYUREA  
(ALL LINES WILL INCLUDE C/L BREAKS FOR  
TOWN HIGHWAYS) S=SOLID, D=DASHED  
STOCKBRIDGE:  
STA 335+50.00 - STA 341+50.00

646.612 TEMPORARY 4 INCH YELLOW LINE, PAINT  
(ALL LINES WILL INCLUDE C/L BREAKS FOR  
TOWN HIGHWAYS) S=SOLID, D=DASHED  
STOCKBRIDGE:  
STA 335+50.00 - STA 341+50.00

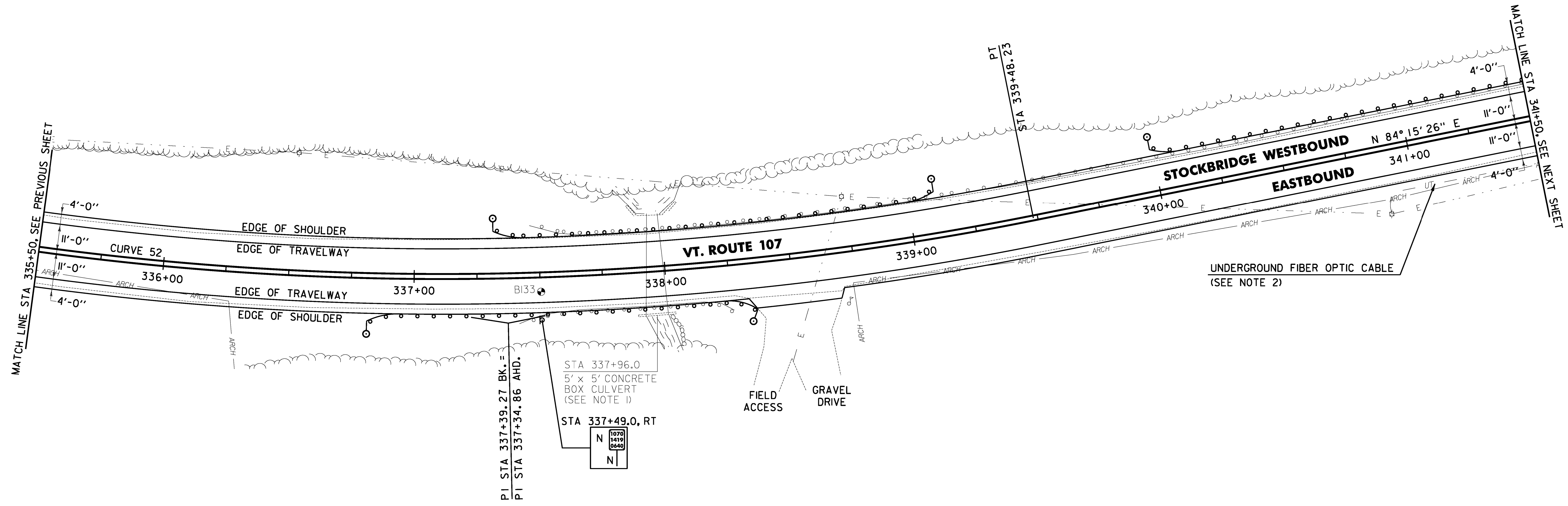
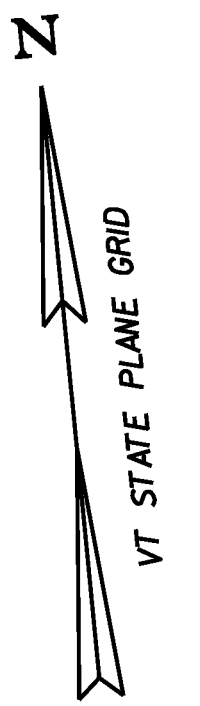

621.217 HD STEEL BEAM GUARDRAIL, GALVANIZED/NESTED W/8 FEET POSTS  
STOCKBRIDGE:  
~~STA 337+83.5 - STA 338+08.5 LT (25.0 LF)  
STA 337+83.5 - STA 338+08.5 RT (25.0 LF)~~

621.205 STEEL BEAM GUARDRAIL, GALVANIZED W/8 FEET POSTS  
STOCKBRIDGE:  
~~STA 336+81.5 - STA 337+83.5 RT (102.0 LF)  
STA 337+31.5 - STA 337+83.5 LT (39.5 LF)  
STA 338+08.5 - STA 338+35.5 RT (27.0 LF)  
STA 338+08.5 - STA 339+10.5 LT (102.0 LF)  
STA 339+99.0 - STA 341+50.0 LT (151.0 LF)  
340+10.0~~

621.60 ANCHOR FOR STEEL BEAM RAIL  
STOCKBRIDGE:  
STA 336+88.0 RT  
STA 337+38.0 LT  
STA 338+29.0 RT  
STA 339+04.0 LT  
STA 340+05.5 LT

621.80 REMOVAL AND DISPOSAL OF GUARDRAIL  
STOCKBRIDGE:  
STA 337+42.0 - STA 338+26.0 RT (84.0 LF)  
STA 337+46.5 - STA 341+50.0 LT (403.5 LF)

621.20 STEEL BEAM GUARDRAIL  
STA 336+78.0 - STA 338+30.0 RT  
STA 337+34.0 - STA 339+12.0 LT  
STA 339+98.0 - STA 340+10.0 LT

~~653.20 TEMPORARY EROSION MATTING  
STOCKBRIDGE:  
STA 340+50.0 - STA 341+50.0 LT (53.3 SY)~~

676.10 DELINEATOR WITH STEEL POST  
STOCKBRIDGE:  
STA 336+81.5 RT  
STA 337+31.5 LT  
STA 338+35.5 RT  
STA 339+10.5 LT  
STA 339+99.0 LT

SOIL BORING DATA			
BORING #	DEPTH (FT.)	PCC	COMMENTS
BI33	1.5	NO	REFUSAL AT 1.5'

CURVE 52  
Δ = 20° 09' 51"  
D = 4° 46' 29"  
R = 1200.00'  
T = 213.37'  
L = 422.32'  
E = 18.82'  
e = 0.070 FT/FT

SIGN LEGEND  
R = REMOVE  
S = SALVAGE  
N = NEW  
RET = RETAIN  
B-B = BACK TO BACK  
EXISTING = -----  
NEW = \_\_\_\_\_

NOTES:

- SEE SHEET 391 FOR NESTED GUARDRAIL SYSTEM DETAIL.
- THE CONTRACTOR SHALL BE AWARE THAT AN UNDERGROUND FIBER OPTIC FACILITY EXISTS ALONG VT 107. THE LOCATION SHOWN ON THE PLANS IS APPROXIMATE, AND THE POTENTIAL EXISTS FOR CONFLICTS WITH THE FIBER OPTIC AND THE PROPOSED UNDERDRAIN AT VARIOUS LOCATIONS THROUGHOUT THE PROJECT. THE CONTRACTOR IS ADVISED THAT, PRIOR TO CONSTRUCTION, ALL PROPOSED UNDERDRAIN LOCATIONS SHALL BE FIELD VERIFIED WITH THE ENGINEER AND RELOCATED AS NECESSARY TO ELIMINATE ANY CONFLICTS WITH THE FIBER OPTIC FACILITY.

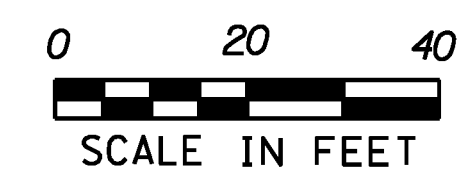

<b>PROJECT LAYOUT SHEET #57</b>	PROJECT NAME: STOCKBRIDGE-BETHEL	PLOT DATE: 3/17/2014
	PROJECT NUMBER: STP 2910(1)	DRAWN BY: W.G.P.
	FILE NAME: z10b214_bdr_nul_57.dgn	CHECKED BY: J.P.S.
	PROJECT LEADER: D.E.G.	SHEET 90 OF 397
	DESIGNED BY: L.M.B.	
	IPARM FILE: z10b214157.1	

FILE NAME: \\172\projects\1722426\1000\1\10b214\_bdr\_nul\_57.dgn  
DATE: 3/17/2014  
USER: L.M.B.