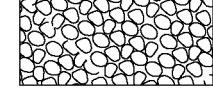

LEGEND
 ITEM 613.10 STONE FILL, TYPE I

~~646.402 DURABLE 4 INCH WHITE LINE, THERMOPLASTIC OR~~
~~646.404 DURABLE 4 INCH WHITE LINE, POLYUREA~~
 (ALL LINES WILL INCLUDE EDGE LINE BREAKS AND RADIUS FOR TOWN HIGHWAYS)
 STOCKBRIDGE:
 STA 305+50.00 - STA 311+50.00 LT & RT

646.602 TEMPORARY 4 INCH WHITE LINE, PAINT
 (ALL LINES WILL INCLUDE EDGE LINE BREAKS AND RADIUS FOR TOWN HIGHWAYS)
 STOCKBRIDGE:
 STA 305+50.00 - STA 311+50.00 LT & RT

213.10 MILLED RUMBLE STRIPS
 (ALL CLRS WILL INCLUDE C/L BREAKS FOR TOWN HIGHWAYS)
 STOCKBRIDGE:
 STA 305+50.00 - STA 311+50.00 C/L (600.0 LF)

646.414 DURABLE 4 INCH YELLOW LINE, POLYUREA
 (ALL LINES WILL INCLUDE C/L BREAKS FOR TOWN HIGHWAYS) S=SOLID, D=DASHED
 STOCKBRIDGE: LT C RT
 S - S

646.612 TEMPORARY 4 INCH YELLOW LINE, PAINT
 (ALL LINES WILL INCLUDE C/L BREAKS FOR TOWN HIGHWAYS) S=SOLID, D=DASHED
 STOCKBRIDGE: LT C RT
 S - S

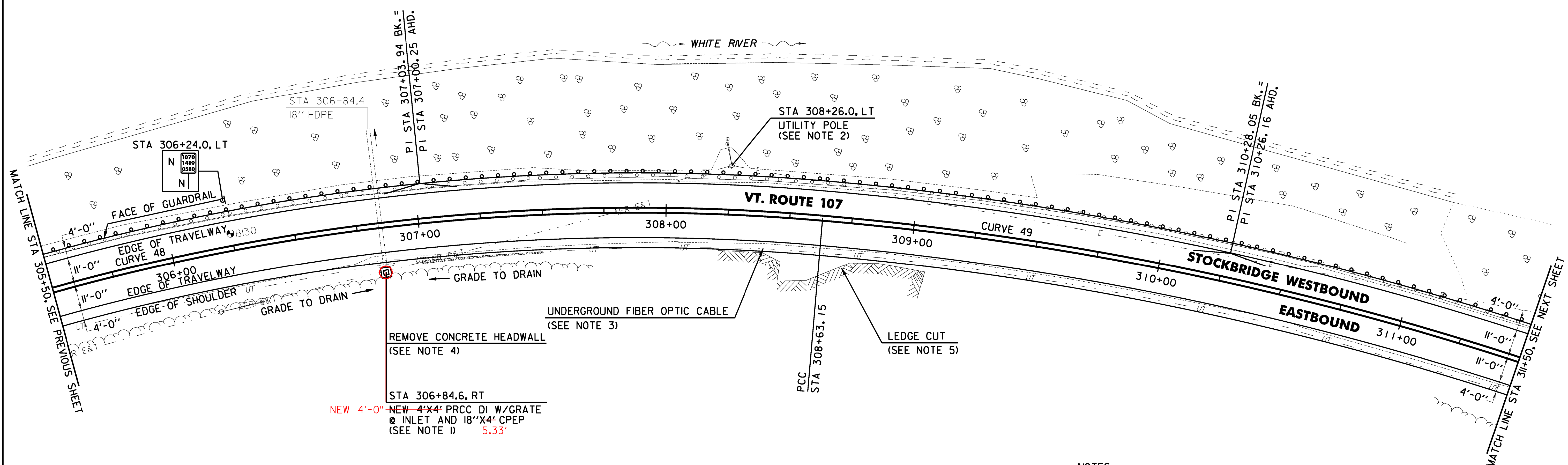
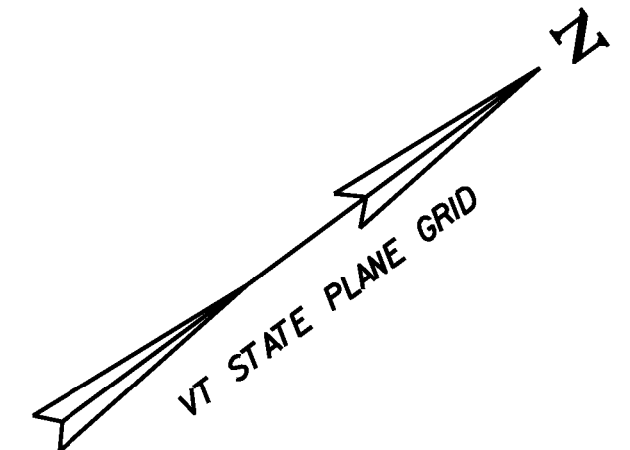

NOTES:

1. THE CONTRACTOR SHALL ADJUST THE PROPOSED SIDE SLOPE IN ORDER TO PLACE DROP INLET IN PROPOSED LOCATION AS DIRECTED BY THE ENGINEER.
2. SEE SHEET 25 FOR REDUCED STEEL BEAM GUARDRAIL POST SPACING AT UTILITY POLE DETAIL.
3. THE CONTRACTOR SHALL BE AWARE THAT AN UNDERGROUND FIBER OPTIC FACILITY EXISTS ALONG VT 107. THE LOCATION SHOWN ON THE PLANS IS APPROXIMATE, AND THE POTENTIAL EXISTS FOR CONFLICTS WITH THE FIBER OPTIC AND THE PROPOSED UNDERDRAIN AT VARIOUS LOCATIONS THROUGHOUT THE PROJECT. THE CONTRACTOR IS ADVISED THAT, PRIOR TO CONSTRUCTION, ALL PROPOSED UNDERDRAIN LOCATIONS SHALL BE FIELD VERIFIED WITH THE ENGINEER AND RELOCATED AS NECESSARY TO ELIMINATE ANY CONFLICTS WITH THE FIBER OPTIC FACILITY.
4. THE CONTRACTOR SHALL REMOVE THE EXISTING CONCRETE HEADWALL UNDER ITEM 204.21 TRENCH EXCAVATION OF ROCK PRIOR TO THE INSTALLATION OF THE PROPOSED DRAINAGE STRUCTURE AS DIRECTED BY THE ENGINEER.
5. SEE SHEET 26 FOR LEDGE CUT DETAILS.

~~613.10 STONE FILL, TYPE I~~
~~STOCKBRIDGE:~~
~~STA 307+00.0 - STA 307+50.0 RT (4.9 CY)~~
 621.205 STEEL BEAM GUARDRAIL, GALVANIZED W/8 FEET POSTS
 STOCKBRIDGE:
 STA 308+04.0 - STA 310+66.5 LT (282.5 LF)
 307+38.0 311+50.0
 621.75 REMOVE AND RESET GUARDRAIL
 STOCKBRIDGE:
 STA 305+50.0 - STA 308+04.0 LT (254.0 LF)
 STA 310+66.5 - STA 311+50.0 LT (83.5 LF)
 621.80 REMOVAL AND DISPOSAL OF GUARDRAIL
 STOCKBRIDGE:
 STA 308+04.0 - STA 310+66.5 LT (262.5 LF)
 307+38.0 311+50.0
~~651.40 GRUBBING MATERIAL (6")~~
~~STOCKBRIDGE:~~
~~STA 307+00.0 - STA 307+50.0 RT (5.6 SY)~~
 653.20 TEMPORARY EROSION MATTING
~~STOCKBRIDGE:~~
~~STA 307+00.0 - STA 307+50.0 RT (5.6 SY)~~

SOIL BORING DATA			
BORING #	DEPTH (FT.)	PCC	COMMENTS
B130	5.0	NO	

CURVE 48	CURVE 49
Δ = 21° 05' 32"	Δ = 15° 01' 47"
D = 6° 32' 53"	D = 4° 35' 01"
R = 875.00'	R = 1250.00'
T = 162.90'	T = 164.89'
L = 322.11'	L = 327.89'
E = 15.03'	E = 10.83'
e = 0.080 FT/FT	e = 0.070 FT/FT



SIGN LEGEND
 R = REMOVE
 S = SALVAGE
 N = NEW
 RET = RETAIN
 B-B = BACK TO BACK
 EXISTING = -----
 NEW = _____

PROJECT LAYOUT SHEET #52	PROJECT NAME: STOCKBRIDGE-BETHEL	PLOT DATE: 3/17/2014
	PROJECT NUMBER: STP 2910(1)	DRAWN BY: W.G.P.
	FILE NAME: z10b214_bdr_nul.52.dgn	CHECKED BY: J.P.S.
	PROJECT LEADER: D.E.G.	SHEET 85 OF 397
	DESIGNED BY: L.M.B.	
	IPARM FILE: z10b214152.1	

FILE NAME: V:\17208\10\10222426\CADD\10\10222426\10b214_bdr_nul.52.dgn
 DATE: 3/17/2014
 USER: J.P.S.