

~~646.402 DURABLE 4 INCH WHITE LINE, THERMOPLASTIC OR~~
~~646.404 DURABLE 4 INCH WHITE LINE, POLYUREA~~
 (ALL LINES WILL INCLUDE EDGE LINE BREAKS AND
 RADIUS FOR TOWN HIGHWAYS)
 STOCKBRIDGE:
 STA 299+50.00 - STA 305+50.00 LT & RT

646.602 TEMPORARY 4 INCH WHITE LINE, PAINT
 (ALL LINES WILL INCLUDE EDGE LINE BREAKS AND
 RADIUS FOR TOWN HIGHWAYS)
 STOCKBRIDGE:
 STA 299+50.00 - STA 305+50.00 LT & RT

213.10 MILLED RUMBLE STRIPS
 (ALL CLRS WILL INCLUDE C/L
 BREAKS FOR TOWN HIGHWAYS)
 STOCKBRIDGE:
 STA 299+50.0 - STA 305+50.0 C/L (600.0 LF)

646.414 DURABLE 4 INCH YELLOW LINE, POLYUREA
 (ALL LINES WILL INCLUDE C/L BREAKS FOR
 TOWN HIGHWAYS) S=SOLID, D=DASHED
 STOCKBRIDGE:
 STA 299+50.00 - STA 305+50.00 LT C RT
 S - S

646.612 TEMPORARY 4 INCH YELLOW LINE, PAINT
 (ALL LINES WILL INCLUDE C/L BREAKS FOR
 TOWN HIGHWAYS) S=SOLID, D=DASHED
 STOCKBRIDGE:
 STA 299+50.00 - STA 305+50.00 LT C RT
 S - S

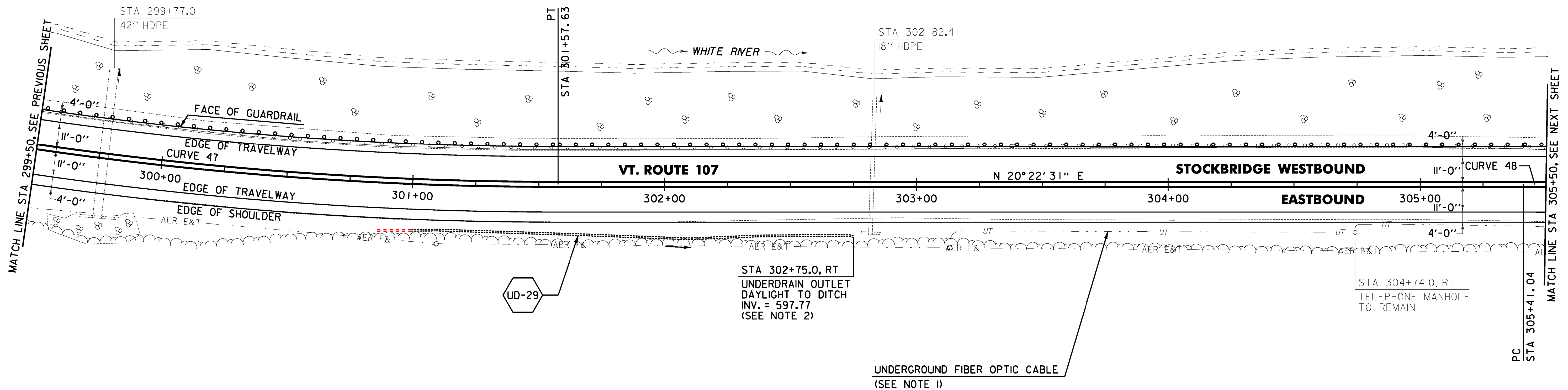
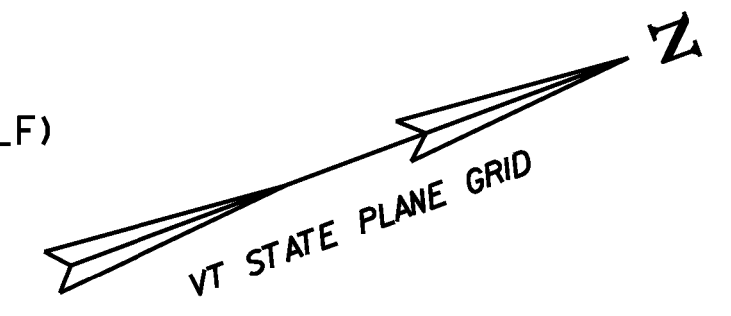

NOTES:

1. THE CONTRACTOR SHALL BE AWARE THAT AN UNDERGROUND FIBER OPTIC FACILITY EXISTS ALONG VT 107. THE LOCATION SHOWN ON THE PLANS IS APPROXIMATE, AND THE POTENTIAL EXISTS FOR CONFLICTS WITH THE FIBER OPTIC AND THE PROPOSED UNDERDRAIN AT VARIOUS LOCATIONS THROUGHOUT THE PROJECT. THE CONTRACTOR IS ADVISED THAT, PRIOR TO CONSTRUCTION, ALL PROPOSED UNDERDRAIN LOCATIONS SHALL BE FIELD VERIFIED WITH THE ENGINEER AND RELOCATED AS NECESSARY TO ELIMINATE ANY CONFLICTS WITH THE FIBER OPTIC FACILITY.
2. SEE SHEET 28 FOR UNDERDRAIN DETAILS.

313.10 STONE FILL, TYPE I
 STA 302+75.0 - STA 303+05.0 RT (RPE OUTLET)

621.75 REMOVE AND RESET GUARDRAIL
 STOCKBRIDGE:
 STA 299+50.0 - STA 305+50.0 LT (600.0 LF)

~~653.20 TEMPORARY EROSION MATTING~~
~~STOCKBRIDGE:~~
~~STA 300+50.0 - STA 303+50.0 RT (106.4 SY)~~

	CURVE 47	CURVE 48
Δ	44° 34' 56"	21° 05' 32"
D	3° 57' 54"	6° 32' 53"
R	1445.00'	875.00'
T	592.38'	162.90'
L	1124.36'	322.11'
E	116.71'	15.03'
e	0.064 FT/FT	0.080 FT/FT

SIGN LEGEND
 R = REMOVE
 S = SALVAGE
 N = NEW
 RET = RETAIN
 B-B = BACK TO BACK
 EXISTING = -----
 NEW = _____

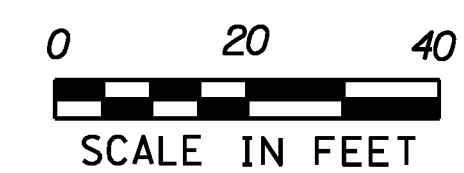

PROJECT LAYOUT SHEET #51	PROJECT NAME: STOCKBRIDGE-BETHEL	PLOT DATE: 3/17/2014
	PROJECT NUMBER: STP 2910(1)	DRAWN BY: W.G.P.
	FILE NAME: z10b214_bdr_nul.51.dgn	CHECKED BY: J.P.S.
	PROJECT LEADER: D.E.G. DESIGNED BY: L.M.B. IPARM FILE: z10b214i51.i	SHEET 84 OF 397

FILE NAME: V:\Projects\10022426\CADD\10022426\MSTN\z10b214_bdr_nul.51.dgn
DATE: 3/17/2014
USER: J.496