

LEGEND	
	ITEM 613.10 STONE FILL, TYPE I
	EXISTING PAVEMENT TO BE REMOVED (SEE NOTE 1)

~~646.402 DURABLE 4 INCH WHITE LINE, THERMOPLASTIC OR~~
~~646.404 DURABLE 4 INCH WHITE LINE, POLYUREA~~
 (ALL LINES WILL INCLUDE EDGE LINE BREAKS AND RADIUS FOR TOWN HIGHWAYS)
 STOCKBRIDGE:
 STA 107+50.00 - STA 113+50.00 LT & RT

646.602 TEMPORARY 4 INCH WHITE LINE, PAINT
 (ALL LINES WILL INCLUDE EDGE LINE BREAKS AND RADIUS FOR TOWN HIGHWAYS)
 STOCKBRIDGE:
 STA 107+50.00 - STA 113+50.00 LT & RT

213.10 MILLED RUMBLE STRIPS
 (ALL CLRS WILL INCLUDE C/L BREAKS FOR TOWN HIGHWAYS)
 STOCKBRIDGE:
 STA 107+50.0 - STA 113+50.0 C/L (600.0 LF)

646.414 DURABLE 4 INCH YELLOW LINE, POLYUREA
 (ALL LINES WILL INCLUDE C/L BREAKS FOR TOWN HIGHWAYS) S=SOLID, D=DASHED
 STOCKBRIDGE:
 STA 107+50.00 - STA 113+50.00 LT C RT S - S

646.612 TEMPORARY 4 INCH YELLOW LINE, PAINT
 (ALL LINES WILL INCLUDE C/L BREAKS FOR TOWN HIGHWAYS) S=SOLID, D=DASHED
 STOCKBRIDGE:
 STA 107+50.00 - STA 113+50.00 LT C RT S - S

604.40 CHANGE ELEVATION OF DI
 STA 108+19.5 RT
 STA 111+22.6 RT
 STA 113+29.5 RT

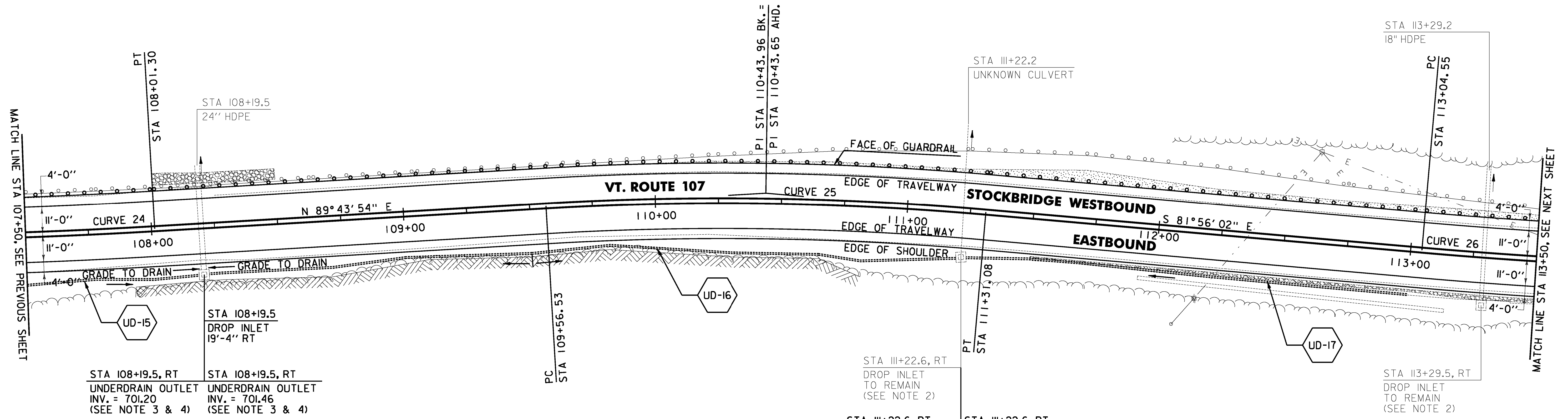

604.412, 604.415, 604.418 REHAB. DROP INLETS, CATCH BASINS, OR MANHOLES CLASS I, II, OR III (SEE NOTE 5)
 STOCKBRIDGE:
 STA 108+19.5 RT

STA 111+22.6, RT
 DROP INLET TO REMAIN (SEE NOTE 2)
 STA 113+29.5, RT
 DROP INLET TO REMAIN (SEE NOTE 2)

NOTES:

1. THE CONTRACTOR SHALL COLD PLANE THE TOP 4" OF EXISTING ROAD SURFACE, AND RECLAIM THE NEXT 8" OF THE EXISTING ROAD SURFACE AT FULL WIDTH. THE CONTRACTOR SHALL THEN PLACE 2" OF ITEM 651.35 TOPSOIL AND ITEM 651.15 SEED AS DIRECTED BY THE ENGINEER.
2. THE CONTRACTOR SHALL ADJUST THE PROPOSED SIDE SLOPE TO AVOID FILLING IN THE EXISTING DROP INLET AS DIRECTED BY THE ENGINEER.
3. THE CONTRACTOR SHALL FIELD VERIFY THE INVERT OF THE EXISTING DROP INLET PRIOR TO INSTALLING UNDERDRAIN.
4. SEE SHEET 28 FOR UNDERDRAIN DETAILS.
5. THE CONTRACTOR SHALL REHABILITATE THE EXISTING DROP INLETS, CATCH BASINS OR MANHOLES TO A DEPTH AS DIRECTED BY THE ENGINEER. ALL REHABILITATION WORK WILL BE PAID FOR UNDER THE APPLICABLE REHABILITATION ITEM AS DIRECTED BY THE ENGINEER. ALL EXISTING UTILITIES MARKED "TO REMAIN" SHALL NOT BE ALTERED OR REHABILITATED UNLESS DIRECTED OTHERWISE BY THE ENGINEER.
6. THE CONTRACTOR SHALL BE AWARE THAT AN UNDERGROUND FIBER OPTIC FACILITY EXISTS ALONG VT 107. THE LOCATION SHOWN ON THE PLANS IS APPROXIMATE, AND THE POTENTIAL EXISTS FOR CONFLICTS WITH THE FIBER OPTIC AND THE PROPOSED UNDERDRAIN AT VARIOUS LOCATIONS THROUGHOUT THE PROJECT. THE CONTRACTOR IS ADVISED THAT, PRIOR TO CONSTRUCTION, ALL PROPOSED UNDERDRAIN LOCATIONS SHALL BE FIELD VERIFIED WITH THE ENGINEER AND RELOCATED AS NECESSARY TO ELIMINATE ANY CONFLICTS WITH THE FIBER OPTIC FACILITY.

CURVE 24	CURVE 25	CURVE 26
$\Delta = 12^\circ 44' 17''$	$\Delta = 8^\circ 20' 03''$	$\Delta = 7^\circ 58' 19''$
$D = 2^\circ 29' 28''$	$D = 4^\circ 46' 29''$	$D = 2^\circ 51' 53''$
$R = 2300.00'$	$R = 1200.00'$	$R = 2000.00'$
$T = 256.72'$	$T = 87.43'$	$T = 139.36'$
$L = 511.33'$	$L = 174.55'$	$L = 278.27'$
$E = 14.28'$	$E = 3.18'$	$E = 4.85'$
$e = 0.046 \text{ FT/FT}$	$e = 0.070 \text{ FT/FT}$	$e = 0.052 \text{ FT/FT}$

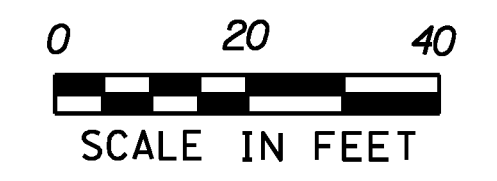

- ~~613.10 STONE FILL, TYPE I~~
- ~~STOCKBRIDGE:~~
- ~~STA 108+00.0 - STA 108+50.0 LT (5.5 CY)~~
- ~~STA 111+50.0 - STA 113+50.0 RT (11.0 CY)~~
- 621.20 STEEL BEAM GUARDRAIL, GALVANIZED
- STOCKBRIDGE:
- STA 108+28.0 - STA 113+50.0 LT (522.0 LF)
- 108+00.0
- 621.75 REMOVE AND RESET GUARDRAIL
- STOCKBRIDGE:
- STA 107+50.0 - STA 108+28.0 LT (78.0 LF)
- 108+00.0
- 621.80 REMOVAL AND DISPOSAL OF GUARDRAIL
- STOCKBRIDGE:
- STA 108+28.0 - STA 113+50.0 LT (522.0 LF)
- 109+50.0
- ~~651.40 GRUBBING MATERIAL (6")~~
- ~~STOCKBRIDGE:~~
- ~~STA 108+00.0 - STA 108+50.0 LT (12.5 SY)~~
- ~~STA 111+50.0 - STA 113+50.0 RT (31.2 SY)~~
- ~~653.20 TEMPORARY EROSION MATTING~~
- ~~STOCKBRIDGE:~~
- ~~STA 107+50.0 - STA 110+00.0 RT (83.0 SY)~~
- ~~STA 107+50.0 - STA 108+50.0 LT (28.9 SY)~~
- ~~STA 111+50.0 - STA 113+50.0 RT (31.2 SY)~~

SIGN LEGEND
 R = REMOVE
 S = SALVAGE
 N = NEW
 RET = RETAIN
 B-B = BACK TO BACK
 EXISTING = -----
 NEW = _____

PROJECT LAYOUT SHEET #19	PROJECT NAME: STOCKBRIDGE-BETHEL	PLOT DATE: 3/17/2014
	PROJECT NUMBER: STP 2910(1)	DRAWN BY: W.G.P.
	FILE NAME: z10b214_bdr_nul.19.dgn	CHECKED BY: J.P.S.
	PROJECT LEADER: D.E.G. DESIGNED BY: L.M.B. IPARM FILE: z10b214119.i	SHEET 52 OF 397

FILE NAME: \\1720\projects\10b214\10b214_bdr_nul.19.dgn
 DATE: 3/17/2014
 USER: j.p.s.