

**LEGEND**

	ITEM 613.10 STONE FILL, TYPE I
	EXISTING PAVEMENT TO BE REMOVED (SEE NOTE 3)

~~646.402 DURABLE 4 INCH WHITE LINE, THERMOPLASTIC OR~~  
~~646.404 DURABLE 4 INCH WHITE LINE, POLYUREA~~  
 (ALL LINES WILL INCLUDE EDGE LINE BREAKS AND RADIUS FOR TOWN HIGHWAYS)  
 STOCKBRIDGE:  
 STA 95+50.00 - STA 101+50.00 LT & RT

646.602 TEMPORARY 4 INCH WHITE LINE, PAINT  
 (ALL LINES WILL INCLUDE EDGE LINE BREAKS AND RADIUS FOR TOWN HIGHWAYS)  
 STOCKBRIDGE:  
 STA 95+50.00 - STA 101+50.00 LT & RT

213.10 MILLED RUMBLE STRIPS  
 (ALL CLRS WILL INCLUDE C/L BREAKS FOR TOWN HIGHWAYS)  
 STOCKBRIDGE:  
 STA 95+50.0 - STA 101+50.0 C/L (600.0 LF)

646.414 DURABLE 4 INCH YELLOW LINE, POLYUREA  
 (ALL LINES WILL INCLUDE C/L BREAKS FOR TOWN HIGHWAYS) S=SOLID, D=DASHED  
 STOCKBRIDGE:  
 STA 95+50.00 - STA 101+50.00 LT C RT S - S

646.612 TEMPORARY 4 INCH YELLOW LINE, PAINT  
 (ALL LINES WILL INCLUDE C/L BREAKS FOR TOWN HIGHWAYS) S=SOLID, D=DASHED  
 STOCKBRIDGE:  
 STA 95+50.00 - STA 101+50.00 LT C RT S - S

604.40 CHANGE ELEVATION OF DI  
 STA 97+20.2 RT

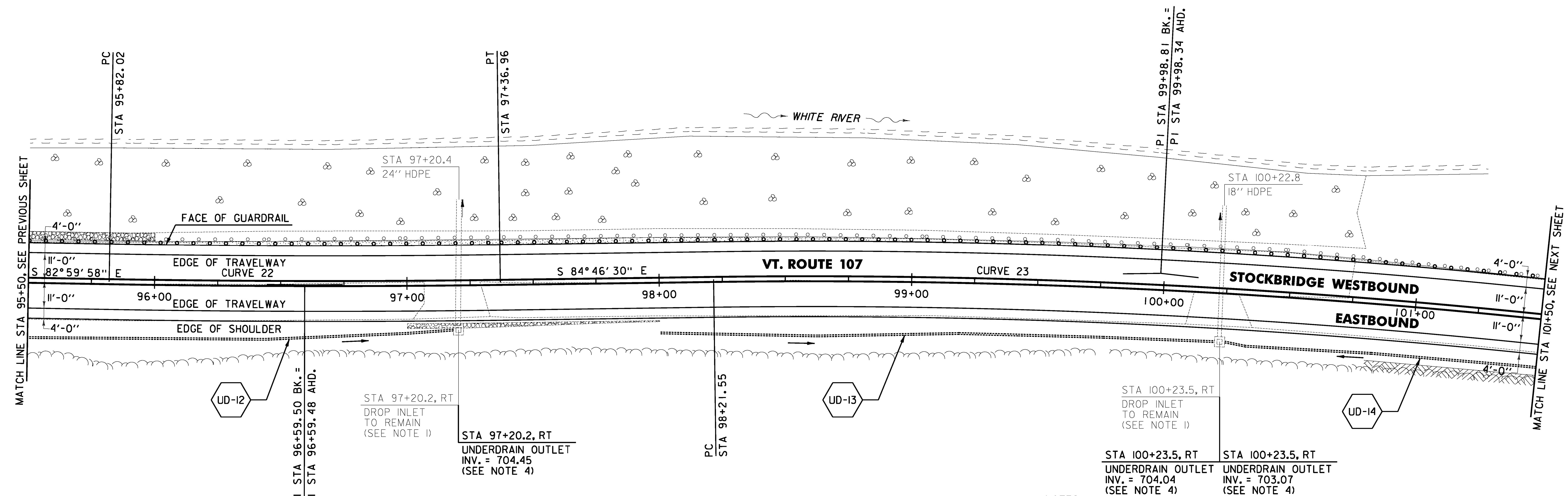

**NOTES:**

1. THE CONTRACTOR SHALL ADJUST THE PROPOSED SIDE SLOPE TO AVOID FILLING IN THE EXISTING DROP INLET AS DIRECTED BY THE ENGINEER.
2. THE CONTRACTOR SHALL BE AWARE THAT AN UNDERGROUND FIBER OPTIC FACILITY EXISTS ALONG VT 107. THE LOCATION SHOWN ON THE PLANS IS APPROXIMATE, AND THE POTENTIAL EXISTS FOR CONFLICTS WITH THE FIBER OPTIC AND THE PROPOSED UNDERDRAIN AT VARIOUS LOCATIONS THROUGHOUT THE PROJECT. THE CONTRACTOR IS ADVISED THAT, PRIOR TO CONSTRUCTION, ALL PROPOSED UNDERDRAIN LOCATIONS SHALL BE FIELD VERIFIED WITH THE ENGINEER AND RELOCATED AS NECESSARY TO ELIMINATE ANY CONFLICTS WITH THE FIBER OPTIC FACILITY.
3. THE CONTRACTOR SHALL COLD PLANE THE TOP 4" OF EXISTING ROAD SURFACE, AND RECLAIM THE NEXT 8" OF THE EXISTING ROAD SURFACE AT FULL WIDTH. THE CONTRACTOR SHALL THEN PLACE 2" OF ITEM 651.35 TOPSOIL AND ITEM 651.15 SEED AS DIRECTED BY THE ENGINEER.
4. SEE SHEET 28 FOR UNDERDRAIN DETAILS.

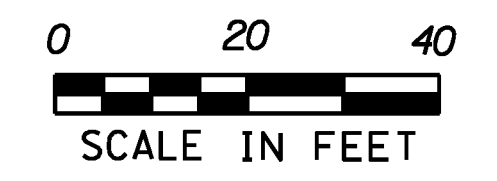

FILE NAME = V:\Projects\10b214\10b214.dgn  
 USER = JLR  
 DATE = 3/17/2014

~~613.10 STONE FILL, TYPE I~~  
~~STOCKBRIDGE:~~  
~~STA 95+50.0 - STA 96+00.0 LT (2.6 CY)~~  
~~STA 97+00.0 - STA 98+00.0 RT (8.3 CY)~~

621.75 REMOVE AND RESET GUARDRAIL  
 STOCKBRIDGE:  
 STA 95+50.0 - STA 101+50.0 LT (600.0 LF)

~~651.40 GRUBBING MATERIAL (6")~~  
~~STOCKBRIDGE:~~  
~~STA 95+50.0 - STA 96+00.0 LT (7.2 SY)~~  
~~STA 97+00.0 - STA 98+00.0 RT (20.0 SY)~~

~~653.20 TEMPORARY EROSION MATTING~~  
~~STOCKBRIDGE:~~  
~~STA 95+50.0 - STA 96+00.0 LT (7.2 SY)~~  
~~STA 97+00.0 - STA 98+00.0 RT (20.0 SY)~~  
~~STA 99+00.0 - STA 100+50.0 LT (51.1 SY)~~

676.12 REMOVAL OF EXISTING DELINEATOR  
 STOCKBRIDGE:  
 STA 95+50.0 - STA 101+50.0 RT (1EA)

**CURVE 22**  
 $\Delta = 1^{\circ}46'32''$   
 $D = 1^{\circ}08'45''$   
 $R = 5000.00'$   
 $T = 77.48'$   
 $L = 154.94'$   
 $E = 0.60'$   
 $e = 0.024 \text{ FT/FT}$

**CURVE 23**  
 $\Delta = 7^{\circ}14'41''$   
 $D = 2^{\circ}02'47''$   
 $R = 2800.00'$   
 $T = 177.26'$   
 $L = 354.05'$   
 $E = 5.61'$   
 $e = 0.040 \text{ FT/FT}$

**SIGN LEGEND**  
 R = REMOVE  
 S = SALVAGE  
 N = NEW  
 RET = RETAIN  
 B-B = BACK TO BACK  
 EXISTING = -----  
 NEW = \_\_\_\_\_

<b>PROJECT LAYOUT SHEET #17</b>	PROJECT NAME: STOCKBRIDGE-BETHEL	PLOT DATE: 3/17/2014
	PROJECT NUMBER: STP 2910(1)	DRAWN BY: W.G.P.
	FILE NAME: z10b214_bdr_nul.17.dgn	CHECKED BY: J.P.S.
	DESIGNED BY: L.M.B.	SHEET 50 OF 397
	IPARM FILE: z10b214i17.i	