

~~646.402 DURABLE 4 INCH WHITE LINE, THERMOPLASTIC OR~~
~~646.404 DURABLE 4 INCH WHITE LINE, POLYUREA~~
 (ALL LINES WILL INCLUDE EDGE LINE BREAKS AND
 RADIUS FOR TOWN HIGHWAYS)
 STOCKBRIDGE:
 STA 53+50.00 - STA 59+50.00 LT & RT

646.602 TEMPORARY 4 INCH WHITE LINE, PAINT
 (ALL LINES WILL INCLUDE EDGE LINE BREAKS AND
 RADIUS FOR TOWN HIGHWAYS)
 STOCKBRIDGE:
 STA 53+50.00 - STA 59+50.00 LT & RT

213.10 MILLED RUMBLE STRIPS
 (ALL CLRS WILL INCLUDE C/L
 BREAKS FOR TOWN HIGHWAYS)
 STOCKBRIDGE:
 STA 53+50.0 - STA 59+50.0 C/L (600.0 LF)

675.50 REMOVING SIGNS
 AS SHOWN - 1

646.414 DURABLE 4 INCH YELLOW LINE, POLYUREA
 (ALL LINES WILL INCLUDE C/L BREAKS FOR
 TOWN HIGHWAYS) S=SOLID, D=DASHED
 STOCKBRIDGE:
 STA 53+50.00 - STA 59+50.00

LT C RT
 S - S

646.612 TEMPORARY 4 INCH YELLOW LINE, PAINT
 (ALL LINES WILL INCLUDE C/L BREAKS FOR
 TOWN HIGHWAYS) S=SOLID, D=DASHED
 STOCKBRIDGE:
 STA 53+50.00 - STA 59+50.00

LT C RT
 S - S

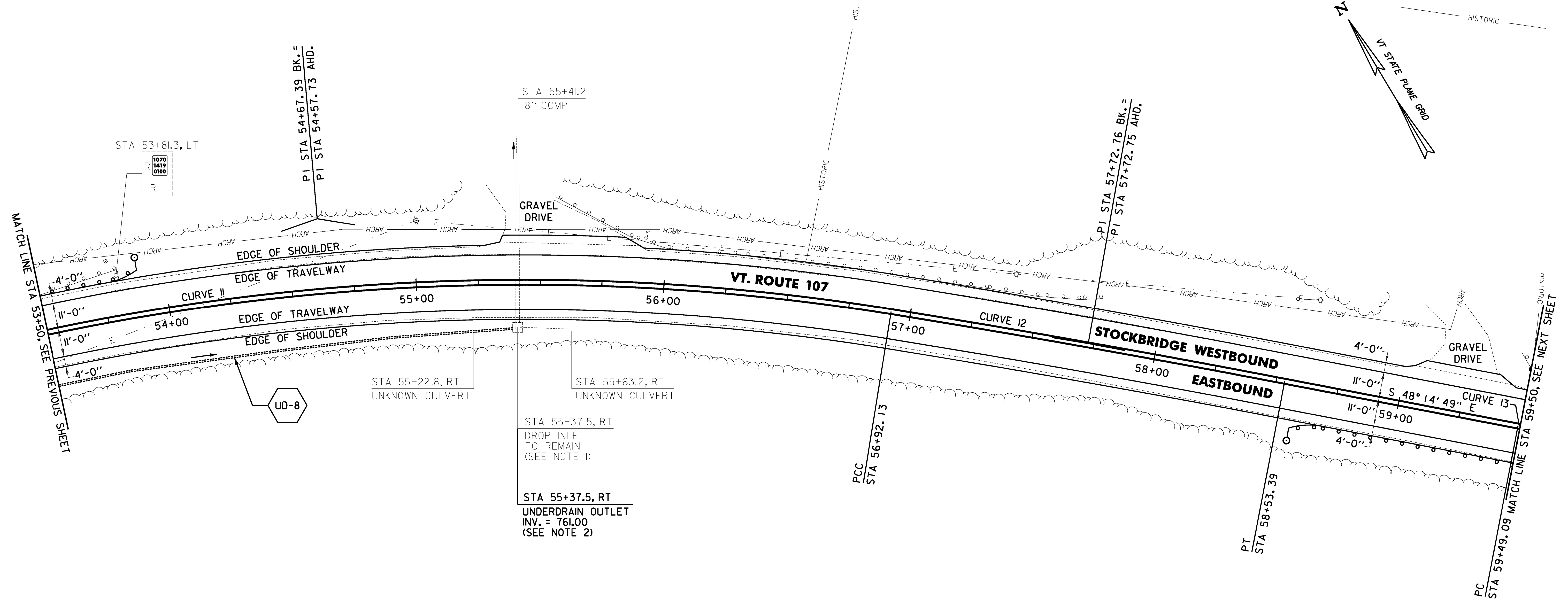

NOTES:

1. THE CONTRACTOR SHALL ADJUST THE PROPOSED SIDE SLOPE TO AVOID FILLING IN THE EXISTING DROP INLET AS DIRECTED BY THE ENGINEER.
2. SEE SHEET 28 FOR UNDERDRAIN DETAILS.
3. THE CONTRACTOR SHALL BE AWARE THAT AN UNDERGROUND FIBER OPTIC FACILITY EXISTS ALONG VT 107. THE LOCATION SHOWN ON THE PLANS IS APPROXIMATE, AND THE POTENTIAL EXISTS FOR CONFLICTS WITH THE FIBER OPTIC AND THE PROPOSED UNDERDRAIN AT VARIOUS LOCATIONS THROUGHOUT THE PROJECT. THE CONTRACTOR IS ADVISED THAT, PRIOR TO CONSTRUCTION, ALL PROPOSED UNDERDRAIN LOCATIONS SHALL BE FIELD VERIFIED WITH THE ENGINEER AND RELOCATED AS NECESSARY TO ELIMINATE ANY CONFLICTS WITH THE FIBER OPTIC FACILITY.

621.205 STEEL BEAM GUARDRAIL, GALVANIZED W/8 FEET POSTS
 STOCKBRIDGE: 53+94.0
 STA 53+50.0 - STA 53+89.5 LT (39.5 LF)
 STA 58+58.5 - STA 59+50.0 RT (91.5 LF) 621.20

621.60 ANCHOR FOR STEEL BEAM RAIL
 STOCKBRIDGE:
 STA 53+83.0 LT
 STA 58+65.0 RT

621.80 REMOVAL AND DISPOSAL OF GUARDRAIL
 STOCKBRIDGE:
 STA 53+50.0 - STA 53+82.0 LT (32.0 LF)
 STA 55+56.0 - STA 57+75.0 LT (226.0 LF)
 STA 59+45.0 - STA 59+50.0 LT (5.0 LF)

~~653.20 TEMPORARY EROSION MATTING~~
~~STOCKBRIDGE:~~
~~STA 58+00.0 - STA 58+50.0 RT (15.3 SY)~~

676.10 DELINEATOR WITH STEEL POST
 STOCKBRIDGE:
 STA 53+89.5 LT
 STA 58+58.5 RT

CURVE 11
 $\Delta = 28^\circ 26' 21''$
 $D = 6^\circ 11' 39''$
 $R = 925.00'$
 $T = 234.40'$
 $L = 459.13'$
 $E = 29.24'$
 $e = 0.078 \text{ FT/FT}$

CURVE 12
 $\Delta = 1^\circ 40' 48''$
 $D = 1^\circ 02' 30''$
 $R = 5500.00'$
 $T = 80.64'$
 $L = 161.26'$
 $E = 29.24'$
 $e = 0.022 \text{ FT/FT}$

CURVE 13
 $\Delta = 2^\circ 32' 58''$
 $D = 1^\circ 47' 26''$
 $R = 3200.00'$
 $T = 71.20'$
 $L = 142.38'$
 $E = 0.79'$
 $e = 0.036 \text{ FT/FT}$

SIGN LEGEND
 R = REMOVE
 S = SALVAGE
 N = NEW
 RET = RETAIN
 B-B = BACK TO BACK
 EXISTING = -----
 NEW = _____

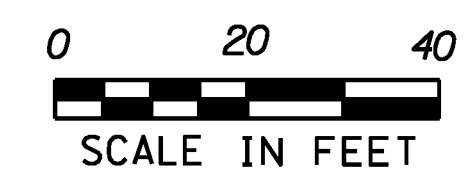

PROJECT LAYOUT SHEET #10

PROJECT NAME: STOCKBRIDGE-BETHEL

PROJECT NUMBER: STP 2910(1)

FILE NAME: z10b214_bdr_nul.10.dgn

PROJECT LEADER: D.E.G.

DESIGNED BY: L.M.B.

IPARM FILE: z10b214i10.i

PLOT DATE: 3/17/2014

DRAWN BY: W.G.P.

CHECKED BY: J.P.S.

SHEET 43 OF 397