

~~646.402 DURABLE 4 INCH WHITE LINE, THERMOPLASTIC OR~~  
~~646.404 DURABLE 4 INCH WHITE LINE, POLYUREA~~  
 (ALL LINES WILL INCLUDE EDGE LINE BREAKS AND  
 RADIUS FOR TOWN HIGHWAYS)  
 STOCKBRIDGE:  
 STA 47+50.00 - STA 53+50.00 LT & RT

646.602 TEMPORARY 4 INCH WHITE LINE, PAINT  
 (ALL LINES WILL INCLUDE EDGE LINE BREAKS AND  
 RADIUS FOR TOWN HIGHWAYS)  
 STOCKBRIDGE:  
 STA 47+50.00 - STA 53+50.00 LT & RT

213.10 MILLED RUMBLE STRIPS  
 (ALL CLRS WILL INCLUDE C/L  
 BREAKS FOR TOWN HIGHWAYS)  
 STOCKBRIDGE:  
 STA 47+50.0 - STA 53+50.0 C/L (600.0 LF)

646.414 DURABLE 4 INCH YELLOW LINE, POLYUREA  
 (ALL LINES WILL INCLUDE C/L BREAKS FOR  
 TOWN HIGHWAYS) S=SOLID, D=DASHED  
 STOCKBRIDGE:  
 STA 47+50.00 - STA 53+50.00 LT S RT S

646.612 TEMPORARY 4 INCH YELLOW LINE, PAINT  
 (ALL LINES WILL INCLUDE C/L BREAKS FOR  
 TOWN HIGHWAYS) S=SOLID, D=DASHED  
 STOCKBRIDGE:  
 STA 47+50.00 - STA 53+50.00 LT S RT S

CHANGE ELEVATION OF DI  
 STA 49+79.0 RT  
 STA 51+00.0 RT

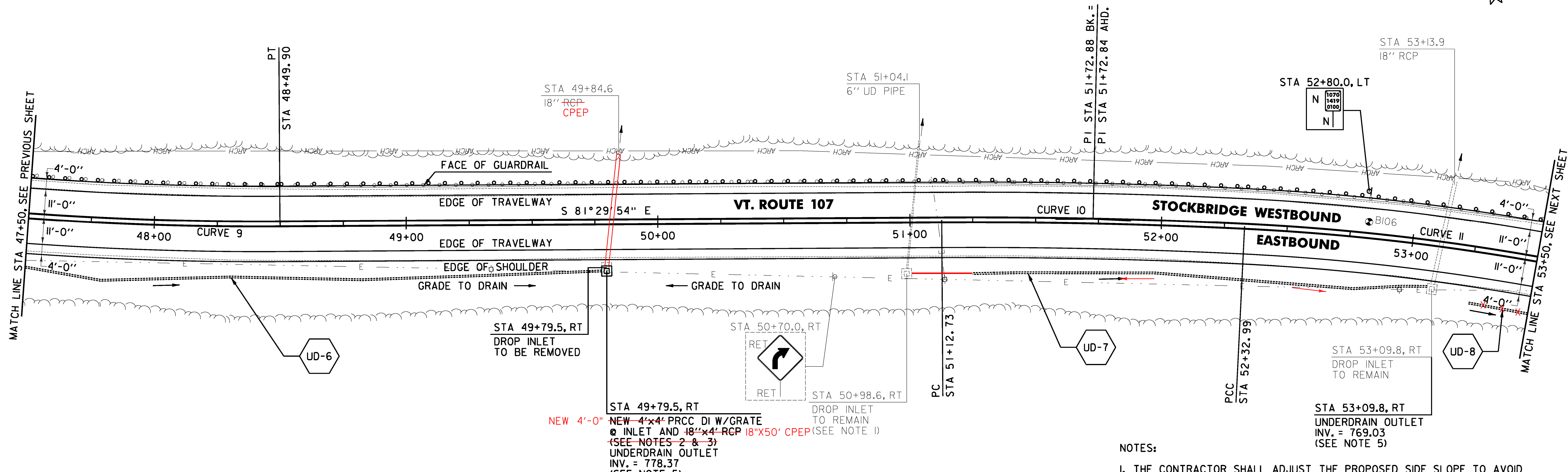
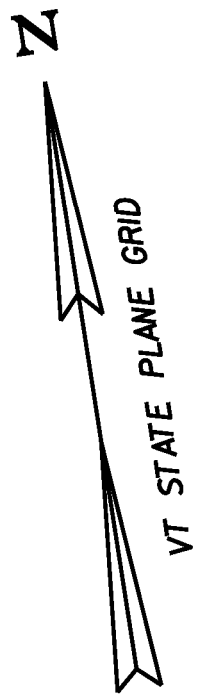

NEW 4'-0" ~~NEW 4'x4' PRCC DI W/GRATE~~  
~~@ INLET AND 18"x4' RCP 18"x50' CPEP~~ (SEE NOTE 1)  
 UNDERDRAIN OUTLET  
 INV. = 778.37  
 (SEE NOTE 5)

SOIL BORING DATA			
BORING #	DEPTH (FT.)	PCC	COMMENTS
BIO6	2.6	NO	REFUSAL AT 2.6'

CURVE 9		CURVE 10	
Δ = 15° 44' 15"	D = 4° 24' 27"	Δ = 3° 07' 55"	D = 2° 36' 16"
R = 1300.00'	T = 179.67'	R = 2200.00'	T = 60.15'
L = 357.07'	E = 12.36'	L = 120.26'	E = 0.82'
e = 0.068 FT/FT		e = 0.048 FT/FT	

CURVE 11	
Δ = 28° 26' 21"	D = 6° 11' 39"
R = 925.00'	T = 234.40'
L = 459.13'	E = 29.24'
e = 0.078 FT/FT	

- NOTES:
- THE CONTRACTOR SHALL ADJUST THE PROPOSED SIDE SLOPE TO AVOID FILLING IN THE EXISTING DROP INLET AS DIRECTED BY THE ENGINEER.
  - THE CONTRACTOR SHALL FIELD VERIFY THE INVERT OF EXISTING PIPE PRIOR TO ORDERING PROPOSED DRAINAGE STRUCTURE.
  - THE CONTRACTOR SHALL ADJUST THE PROPOSED SIDE SLOPE IN ORDER TO PLACE DROP INLET IN PROPOSED LOCATION AS DIRECTED BY THE ENGINEER.
  - THE CONTRACTOR SHALL BE AWARE THAT AN UNDERGROUND FIBER OPTIC FACILITY EXISTS ALONG VT 107. THE LOCATION SHOWN ON THE PLANS IS APPROXIMATE, AND THE POTENTIAL EXISTS FOR CONFLICTS WITH THE FIBER OPTIC AND THE PROPOSED UNDERDRAIN AT VARIOUS LOCATIONS THROUGHOUT THE PROJECT. THE CONTRACTOR IS ADVISED THAT, PRIOR TO CONSTRUCTION, ALL PROPOSED UNDERDRAIN LOCATIONS SHALL BE FIELD VERIFIED WITH THE ENGINEER AND RELOCATED AS NECESSARY TO ELIMINATE ANY CONFLICTS WITH THE FIBER OPTIC FACILITY.
  - SEE SHEET 28 FOR UNDERDRAIN DETAILS.



313.10 STONE FILL, TYPE II  
 STA 49+72.0 - 49.85.0 LT  
 (PIPE OUTLET)

621.205 STEEL BEAM GUARDRAIL, GALVANIZED W/8 FEET POSTS  
 STOCKBRIDGE:  
 STA 47+50.0 - STA 53+50.0 LT (600.0 LF)

621.80 REMOVAL AND DISPOSAL OF GUARDRAIL  
 STOCKBRIDGE:  
 STA 47+50.0 - STA 53+50.0 LT (600.0 LF)

~~653.20 TEMPORARY EROSION MATTING~~  
 STOCKBRIDGE:  
~~STA 47+50.0 - STA 48+00.0 LT (8.3 SY)~~  
~~STA 49+50.0 - STA 50+00.0 LT (7.2 SY)~~  
~~STA 51+00.0 - STA 52+50.0 RT (38.3 SY)~~  
~~STA 52+50.0 - STA 53+00.0 LT (18.1 SY)~~

SIGN LEGEND  
 R = REMOVE  
 S = SALVAGE  
 N = NEW  
 RET = RETAIN  
 B-B = BACK TO BACK  
 EXISTING = -----  
 NEW = \_\_\_\_\_

<b>PROJECT LAYOUT SHEET #9</b>	PROJECT NAME: STOCKBRIDGE-BETHEL	PLOT DATE: 3/17/2014
	PROJECT NUMBER: STP 2910(1)	DRAWN BY: W.G.P.
	FILE NAME: z10b214_bdr_nul.09.dgn PROJECT LEADER: D.E.G. DESIGNED BY: L.M.B. IPARM FILE: z10b214109.i	CHECKED BY: J.P.S. SHEET 42 OF 397

FILE NAME: V:\1720\stb\10b214\10b214\_bdr\_nul.09.dgn  
 DATE: 3/17/2014  
 USER: J.4916