

~~646.402 DURABLE 4 INCH WHITE LINE, THERMOPLASTIC OR~~
 646.404 DURABLE 4 INCH WHITE LINE, POLYUREA
 (ALL LINES WILL INCLUDE EDGE LINE BREAKS AND
 RADIUS FOR TOWN HIGHWAYS)
 STOCKBRIDGE:
 STA 35+50.00 - STA 41+50.00 LT & RT

646.602 TEMPORARY 4 INCH WHITE LINE, PAINT
 (ALL LINES WILL INCLUDE EDGE LINE BREAKS AND
 RADIUS FOR TOWN HIGHWAYS)
 STOCKBRIDGE:
 STA 35+50.00 - STA 41+50.00 LT & RT

213.10 MILLED RUMBLE STRIPS
 (ALL CLRS WILL INCLUDE C/L
 BREAKS FOR TOWN HIGHWAYS)
 STOCKBRIDGE:
 STA 35+50.0 - STA 41+50.0 C/L (600.0 LF)

675.50 REMOVING SIGNS
 AS SHOWN - 1

646.414 DURABLE 4 INCH YELLOW LINE, POLYUREA
 (ALL LINES WILL INCLUDE C/L BREAKS FOR
 TOWN HIGHWAYS) S=SOLID, D=DASHED
 STOCKBRIDGE:
 STA 35+50.00 - STA 41+50.00

LT C RT
 D - S

646.612 TEMPORARY 4 INCH YELLOW LINE, PAINT
 (ALL LINES WILL INCLUDE C/L BREAKS FOR
 TOWN HIGHWAYS) S=SOLID, D=DASHED
 STOCKBRIDGE:
 STA 35+50.00 - STA 41+50.00

LT C RT
 D - S

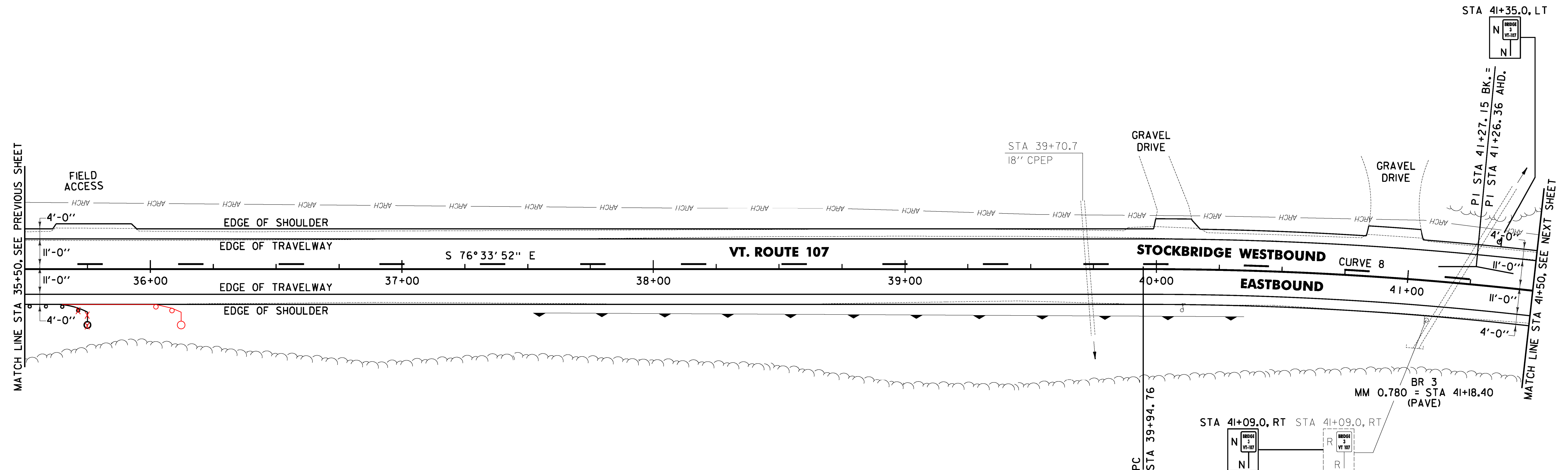
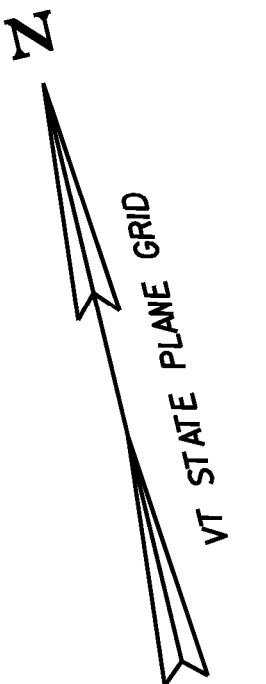

NOTE:

1. THE CONTRACTOR SHALL BE AWARE THAT AN UNDERGROUND FIBER OPTIC FACILITY EXISTS ALONG VT 107. THE LOCATION SHOWN ON THE PLANS IS APPROXIMATE, AND THE POTENTIAL EXISTS FOR CONFLICTS WITH THE FIBER OPTIC AND THE PROPOSED UNDERDRAIN AT VARIOUS LOCATIONS THROUGHOUT THE PROJECT. THE CONTRACTOR IS ADVISED THAT, PRIOR TO CONSTRUCTION, ALL PROPOSED UNDERDRAIN LOCATIONS SHALL BE FIELD VERIFIED WITH THE ENGINEER AND RELOCATED AS NECESSARY TO ELIMINATE ANY CONFLICTS WITH THE FIBER OPTIC FACILITY.

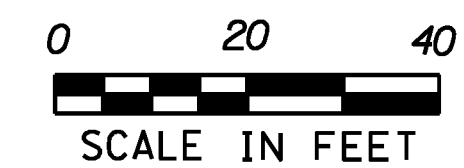

621.205 STEEL BEAM GUARDRAIL, GALVANIZED W/8 FEET POSTS
 STOCKBRIDGE:
 STA 35+50.0 - STA 36+08.0 RT (16.9 SY)
 STA 35+50.0 - STA 35+79.0 RT (29.0 LF)

621.60 ANCHOR FOR STEEL BEAM RAIL
 STOCKBRIDGE:
 STA 35+72.5 RT
 STA 36+00.0

653.20 TEMPORARY EROSION MATTING
 STOCKBRIDGE:
 STA 35+50.0 - STA 36+00.0 RT (16.9 SY)
 STA 37+50.0 - STA 38+50.0 RT (25.3 SY)

676.10 DELINEATOR WITH STEEL POST
 STOCKBRIDGE:
 STA 35+79.0 RT

CURVE 8
 $\Delta = 10^{\circ} 48' 14''$
 $D = 4^{\circ} 05' 33''$
 $R = 1400.00'$
 $T = 132.39'$
 $L = 263.99'$
 $E = 6.25'$
 $e = 0.064 \text{ FT/FT}$

SIGN LEGEND
 R = REMOVE
 S = SALVAGE
 N = NEW
 RET = RETAIN
 B-B = BACK TO BACK
 EXISTING = -----
 NEW = _____

PROJECT LAYOUT SHEET #7	PROJECT NAME: STOCKBRIDGE-BETHEL
	PROJECT NUMBER: STP 2910(1)
	FILE NAME: z10b214_bdr_nul.07.dgn
	IPARM FILE: z10b214107.i
	PLOT DATE: 3/17/2014
	DRAWN BY: W.G.P.
	CHECKED BY: J.P.S.
	SHEET 40 OF 397

FILE NAME: V:\Projects\107\107_2014\107_2014.dwg
 DATE: 3/17/2014
 USER: J.P.S.