

~~646.402 DURABLE 4 INCH WHITE LINE, THERMOPLASTIC OR~~  
 646.404 DURABLE 4 INCH WHITE LINE, POLYUREA  
 (ALL LINES WILL INCLUDE EDGE LINE BREAKS AND  
 RADIUS FOR TOWN HIGHWAYS)  
 STOCKBRIDGE:  
 STA 5+50.00 - STA 11+50.00 LT & RT

646.602 TEMPORARY 4 INCH WHITE LINE, PAINT  
 (ALL LINES WILL INCLUDE EDGE LINE BREAKS AND  
 RADIUS FOR TOWN HIGHWAYS)  
 STOCKBRIDGE:  
 STA 5+50.00 - STA 11+50.00 LT & RT

~~213.10 MILLED RUMBLE STRIPS~~  
 (ALL CLRS WILL INCLUDE C/L  
 BREAKS FOR TOWN HIGHWAYS)  
 STOCKBRIDGE:  
 STA 5+50.00 - STA 11+50.00 C/L (600.0 LF)

675.50 REMOVING SIGNS  
 AS SHOWN - 9

646.414 DURABLE 4 INCH YELLOW LINE, POLYUREA  
 (ALL LINES WILL INCLUDE C/L BREAKS FOR  
 TOWN HIGHWAYS) S=SOLID, D=DASHED  
 STOCKBRIDGE:  
 STA 5+50.00 - STA 11+50.00

646.612 TEMPORARY 4 INCH YELLOW LINE, PAINT  
 (ALL LINES WILL INCLUDE C/L BREAKS FOR  
 TOWN HIGHWAYS) S=SOLID, D=DASHED  
 STOCKBRIDGE:  
 STA 5+50.00 - STA 11+50.00

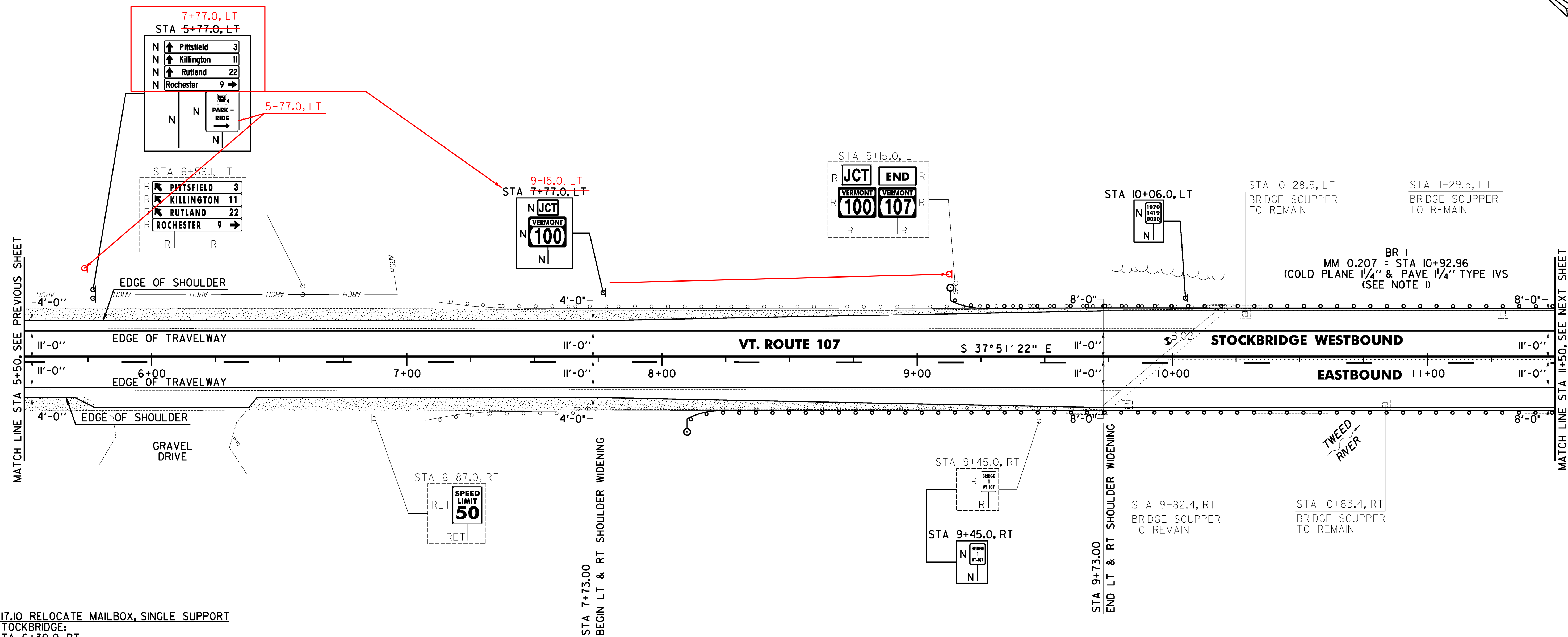
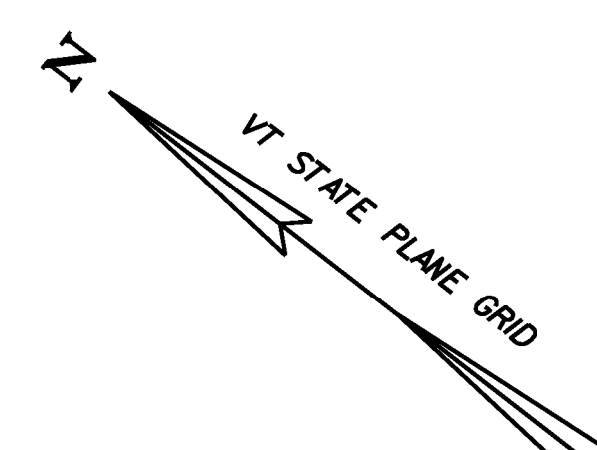

617.10 RELOCATE MAILBOX, SINGLE SUPPORT  
 STOCKBRIDGE:  
 STA 6+30.0 RT

621.20 STEEL BEAM GUARDRAIL, GALVANIZED  
 STOCKBRIDGE:  
~~STA 8+10.0 - STA 9+12.0 RT (102.0 LF)~~ STA 8+05.0 - 9+07.0 RT (102.0 LF)  
 STA 9+13.0 - STA 9+65.0 LT (52.0 LF)

621.60 ANCHOR FOR STEEL BEAM RAIL  
 STOCKBRIDGE:  
 STA 8+16.5 RT  
 STA 9+19.5 LT

621.70 GUARDRAIL APPROACH SECTION, GALVANIZED TYPE I  
 STOCKBRIDGE:  
~~STA 9+12.0 - STA 9+62.0 RT~~ STA 9+07.0 - 9+57.0 RT  
 STA 9+65.0 - STA 10+15.0 LT

621.80 REMOVAL AND DISPOSAL OF GUARDRAIL  
 STOCKBRIDGE:  
 STA 7+07.0 - STA 9+62.0 RT (255.0 LF)  
 STA 7+12.0 - STA 10+15.0 LT (303.0 LF)

676.10 DELINEATOR WITH STEEL POST  
 STOCKBRIDGE:  
 STA 8+10.0 RT  
 STA 9+13.0 LT

SOIL BORING DATA			
BORING #	DEPTH (FT.)	PCC	COMMENTS
BIO2	5.0	NO	

- NOTES:
- SEE SHEET 395 FOR BR I DETAILS.
  - THE CONTRACTOR SHALL COLD PLANE THE TOP 4" OF EXISTING ROAD SURFACE, AND RECLAIM THE NEXT 8" OF THE EXISTING ROAD SURFACE AT FULL WIDTH. THE CONTRACTOR SHALL THEN PLACE 2" OF ITEM 651.35 TOPSOIL AND ITEM 651.15 SEED AS DIRECTED BY THE ENGINEER.
  - THE CONTRACTOR SHALL BE AWARE THAT AN UNDERGROUND FIBER OPTIC FACILITY EXISTS ALONG VT 107. THE LOCATION SHOWN ON THE PLANS IS APPROXIMATE, AND THE POTENTIAL EXISTS FOR CONFLICTS WITH THE FIBER OPTIC AND THE PROPOSED UNDERDRAIN AT VARIOUS LOCATIONS THROUGHOUT THE PROJECT. THE CONTRACTOR IS ADVISED THAT, PRIOR TO CONSTRUCTION, ALL PROPOSED UNDERDRAIN LOCATIONS SHALL BE FIELD VERIFIED WITH THE ENGINEER AND RELOCATED AS NECESSARY TO ELIMINATE ANY CONFLICTS WITH THE FIBER OPTIC FACILITY.

SIGN LEGEND  
 R = REMOVE  
 S = SALVAGE  
 N = NEW  
 RET = RETAIN  
 B-B = BACK TO BACK  
 EXISTING = -----  
 NEW = \_\_\_\_\_

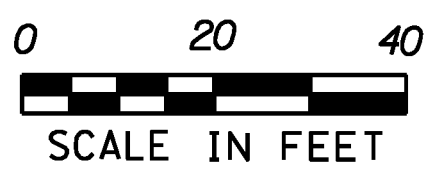

LEGEND  
 EXISTING PAVEMENT TO BE REMOVED (SEE NOTE 2)

<b>PROJECT LAYOUT SHEET #2</b>	PROJECT NAME: STOCKBRIDGE-BETHEL
	PROJECT NUMBER: STP 2910(1)
	FILE NAME: z10b214_bdr_nul.02.dgn PROJECT LEADER: D.E.G. DESIGNED BY: L.M.B. IPARM FILE: z10b214102.1
	PLOT DATE: 3/17/2014 DRAWN BY: W.G.P. CHECKED BY: J.P.S. SHEET 35 OF 397

FILE NAME: \\1720\projects\1720\22426\10400\1.MST\1720\10b214\_bdr\_nul.02.dgn  
 DATE: 3/17/2014  
 USER: J.4916