

**CONSTRUCTION APPROACH SIGNING**

NOT TO SCALE  
SEE STD E-100 AND E-100A FOR SIGN PLACEMENT

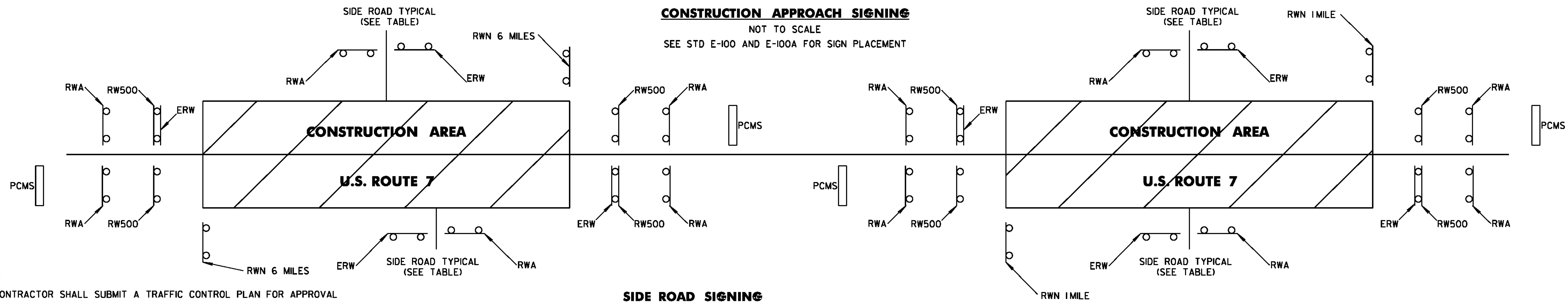

**NOTES:**

- THE CONTRACTOR SHALL SUBMIT A TRAFFIC CONTROL PLAN FOR APPROVAL PRIOR TO THE START OF CONSTRUCTION. THE COST OF PREPARING THIS PLAN (AND MAKING CHANGES IF NECESSARY) SHALL NOT BE PAID SEPARATELY BUT SHALL BE INCIDENTAL TO ITEM 641J0, "TRAFFIC CONTROL".
- THE CONTRACTOR SHALL INCLUDE A CONSTRUCTION SIGN APPROACH PACKAGE FOR EXPECTED LANE CLOSURES AND WORK ZONE SPEED REDUCTIONS IN COMPLIANCE WITH THE TRAFFIC CONTROL DETAILS AND NOTES SHEET (SHEETS 100-104) AND PART 6 OF THE MUTCD. PAYMENT FOR PROVIDING THIS PACKAGE SHALL BE INCIDENTAL TO ITEM 641J0, "TRAFFIC CONTROL".
- THE BID PRICE FOR ITEM 641J0 "TRAFFIC CONTROL", SHALL INCLUDE ALL OF THE FOLLOWING, AS NEEDED: APPROACH AND ON-PROJECT CONSTRUCTION SIGNING, PORTABLE ARROW BOARDS, BARRIERS, BARRELS, CONES, BARRICADES, TRUCK-MOUNTED ATTENUATOR(S), TEMPORARY REGULATORY AND WARNING SIGNS, AND POSTS AS DETAILED IN VTRANS STANDARDS. ALL ADJUSTING, RELOCATING, AND REMOVING OF THESE DEVICES AS DIRECTED BY THE ENGINEER SHALL ALSO BE INCLUDED.
- FOUR (4) PORTABLE CHANGEABLE MESSAGE SIGNS (PCMS) WILL BE PROVIDED FOR USE ON THIS PROJECT. THE PLACEMENT OF THESE UNITS AS WELL AS THE MESSAGE WILL BE APPROVED BY THE ENGINEER. THESE SIGNS WILL BE PAID FOR UNDER ITEM 641J5, "PORTABLE CHANGEABLE MESSAGE SIGN".
- PCMS SHOULD NOT REPLACE ANY OF THE SIGNING DETAILED IN THE MUTCD AND SHOULD NOT BE USED IF STANDARD TRAFFIC CONTROL DEVICES ADEQUATELY PROVIDE THE INFORMATION THE MOTORISTS NEED TO TRAVEL SAFELY.  
  
THE PCMS SHALL CONSIST OF EITHER ONE OR TWO PHASES. TYPICALLY, A PHASE SHALL CONSIST OF UP TO THREE LINES OF EIGHT CHARACTERS PER LINE. THE PCMS SHOULD BE USED AS A SUPPLEMENT AND NOT AS A SUBSTITUTE FOR CONVENTIONAL SIGNS AND PAVEMENT MARKINGS.  
  
THE PCMS SHOULD COMMUNICATE WHAT INFORMATION MOTORISTS NEED TO KNOW. UNNECESSARY INFORMATION SHOULD BE AVOIDED. MESSAGES SHOULD BE UPDATED PERIODICALLY TO DESCRIBE THE WORK ACTIVITY OCCURRING SO THAT THE PCMS CONTINUES TO COMMAND THE ATTENTION OF MOTORISTS.
- THE MUTCD 2009 SHALL BE THE STANDARD FOR ALL TRAFFIC CONTROL DEVICES. EXISTING SIGNS, SIGNALS AND MARKINGS SHALL BE VALID UNTIL SUCH TIME AS THEY ARE REPLACED OR RECONSTRUCTED. WHEN NEW TRAFFIC CONTROL DEVICES ARE ERECTED OR PLACED OR EXISTING TRAFFIC CONTROL DEVICES ARE REPLACED OR REPAIRED THE EQUIPMENT, DESIGN, METHOD OF INSTALLATION, PLACEMENT OR REPAIR SHALL CONFORM WITH THE MUTCD.
- NO CONSTRUCTION SIGNS SHALL BE INSTALLED AS TO INTERFERE OR OBSTRUCT THE VIEW OF EXISTING TRAFFIC CONTROL DEVICES, STOPPING SIGHT DISTANCE, AND CORNER SIGHT DISTANCE FROM DRIVES AND TOWN HIGHWAYS.
- SEE THE TRAFFIC CONTROL SHEETS FOR ADDITIONAL INFORMATION REGARDING IMPLEMENTATION OF THE TEMPORARY TRAFFIC CONTROL DEVICES.
- CONES SHALL BE USED TO CLEARLY DEFINE THE TRAVEL SPACE AND PROVIDE SEPARATION FROM THE WORK SPACE ALONG ITS ENTIRE LENGTH.
- AS THE PAVING OPERATION MOVES, THE FLAGGER SIGNS SHALL BE MOVED ACCORDINGLY. AT NO TIME SHOULD THE FLAGGER SYMBOL SIGN BE MORE THAN 1000 FT FROM THE FLAGGER STATION. FLAGGER SIGNS SHALL BE COVERED OR TURNED AWAY IF FLAGGING OPERATIONS CEASE FOR MORE THAN 15 MINUTES.

**SIDE ROAD SIGNING**

| SIDE ROAD NAME               | ROAD WORK AHEAD | SIDE ROAD WORK AHEAD | END ROAD WORK | ROAD WORK 500 FT | ROAD WORK NEXT 1 MILE | ROAD WORK NEXT 6 MILES | PCMS |
|------------------------------|-----------------|----------------------|---------------|------------------|-----------------------|------------------------|------|
| <b>CHARLOTTE</b>             |                 |                      |               |                  |                       |                        |      |
| BEGIN PROJECT (U.S. ROUTE 7) | 2               |                      | 1             | 2                |                       | 1                      | 1    |
| FERRY ROAD                   | 1               |                      | 1             |                  |                       |                        |      |
| CHURCH HILL ROAD             | 1               |                      | 1             |                  |                       |                        |      |
| CHURCH HILL ROAD             | 1               |                      | 1             |                  |                       |                        |      |
| LIME KILN ROAD               | 1               |                      | 1             |                  |                       |                        |      |
| <b>SHELBURNE</b>             |                 |                      |               |                  |                       |                        |      |
| RIDGEFIELD ROAD              | 1               |                      | 1             |                  |                       |                        |      |
| BOSTWICK ROAD                | 1               |                      | 1             |                  |                       |                        |      |
| MARSETT ROAD                 | 1               |                      | 1             |                  |                       |                        |      |
| MEADOW LANE                  | 1               |                      | 1             |                  |                       |                        |      |
| CHURCH STREET                | 1               |                      | 1             |                  |                       |                        |      |
| HARBOR ROAD                  | 1               |                      | 1             |                  |                       |                        |      |
| FALLS ROAD                   | 1               |                      | 1             |                  |                       |                        |      |
| WEBSTER ROAD                 | 1               |                      | 1             |                  |                       |                        |      |
| END PROJECT (U.S. ROUTE 7)   | 2               |                      | 1             | 2                |                       | 1                      | 1    |
| WEBSTER ROAD                 |                 | 1                    |               |                  |                       |                        |      |

| SIDE ROAD NAME               | ROAD WORK AHEAD | SIDE ROAD WORK AHEAD | END ROAD WORK | ROAD WORK 500 FT | ROAD WORK NEXT 1 MILE | ROAD WORK NEXT 6 MILES | PCMS     |
|------------------------------|-----------------|----------------------|---------------|------------------|-----------------------|------------------------|----------|
| <b>SOUTH BURLINGTON</b>      |                 |                      |               |                  |                       |                        |          |
| BEGIN PROJECT (U.S. ROUTE 7) | 2               |                      | 1             | 2                | 1                     |                        | 1        |
| HOLMES ROAD                  | 1               |                      | 1             |                  |                       |                        | 1        |
| IDX DRIVE                    | 1               |                      | 1             |                  |                       |                        |          |
| IMPERIAL DRIVE               | 1               |                      | 1             |                  |                       |                        |          |
| MACINTOSH AVENUE             | 1               |                      | 1             |                  |                       |                        |          |
| BALDWIN AVENUE               | 1               |                      | 1             |                  |                       |                        |          |
| QUEEN CITY PARK ROAD         | 1               |                      | 1             |                  |                       |                        |          |
| END PROJECT (U.S. ROUTE 7)   | 2               |                      | 1             | 2                | 1                     |                        | 1        |
| SWIFT STREET                 |                 | 1                    |               |                  |                       |                        | 1        |
| <b>TOTAL</b>                 | <b>27</b>       | <b>2</b>             | <b>23</b>     | <b>8</b>         | <b>2</b>              | <b>2</b>               | <b>6</b> |

- ALL PERMANENT SIGNS THAT CONFLICT WITH TEMPORARY TRAFFIC CONTROL SHALL BE COMPLETELY COVERED. THE PAYMENT FOR WHICH SHALL BE INCLUDED IN THE UNIT PRICE BID FOR ITEM 641J0 TRAFFIC CONTROL.
- CONSTRUCTION ZONE SIGN LAYOUT SHALL BE IN ACCORDANCE WITH SECTION 6 OF THE LATEST EDITION OF THE MUTCD.
- CONSTRUCTION SIGNS SHALL BE IN NEW OR LIKE NEW CONDITION PER VAOT STANDARDS.
- DIAMOND SHAPED SIGNS SHALL BE 4'X4' WITH BLACK TEXT AND BORDER ON A RETROREFLECTIVE FLUORESCENT ORANGE BACKGROUND.
- RETROREFLECTIVE SHEETING SHALL BE AS NOTED IN THE SPECIAL PROVISIONS.
- CONSTRUCTION ZONE SIGNS SHALL BE INSTALLED AS OUTLINED IN THE SPECIAL PROVISIONS.
- WHERE TEMPORARY SIGNS ARE PLACED BEHIND GUARDRAIL, THEY SHALL BE ADJUSTED SUCH THAT THE BOTTOM OF THE SIGNS ARE ABOVE THE TOP OF GUARDRAIL.

**LEGEND**

- RWA = ROAD WORK AHEAD
- RW500 = ROAD WORK 500 FT
- SRWA = SIDE ROAD WORK AHEAD
- SRW500 = SIDE ROAD WORK 500 FT
- ERW = END ROAD WORK
- RWN = ROAD WORK NEXT XX MILES
- PCMS = PORTABLE CHANGABLE MESSAGE SIGN

**CONSTRUCTION APPROACH SIGNING SHEET**

PROJECT NAME: CHARLOTTE - SOUTH BURLINGTON  
PROJECT NUMBER: NH 2907(1)

FILE NAME: p10B206.dgn  
PROJECT LEADER: CDL  
DESIGNED BY: BMB  
PLOT FILE: p10B206\_104.1

PLOT DATE: 4/19/12  
DRAWN BY: BMB  
CHECKED BY: EPD  
SHEET 104 OF 107