

INT DIAPHRAGM TYPE D4

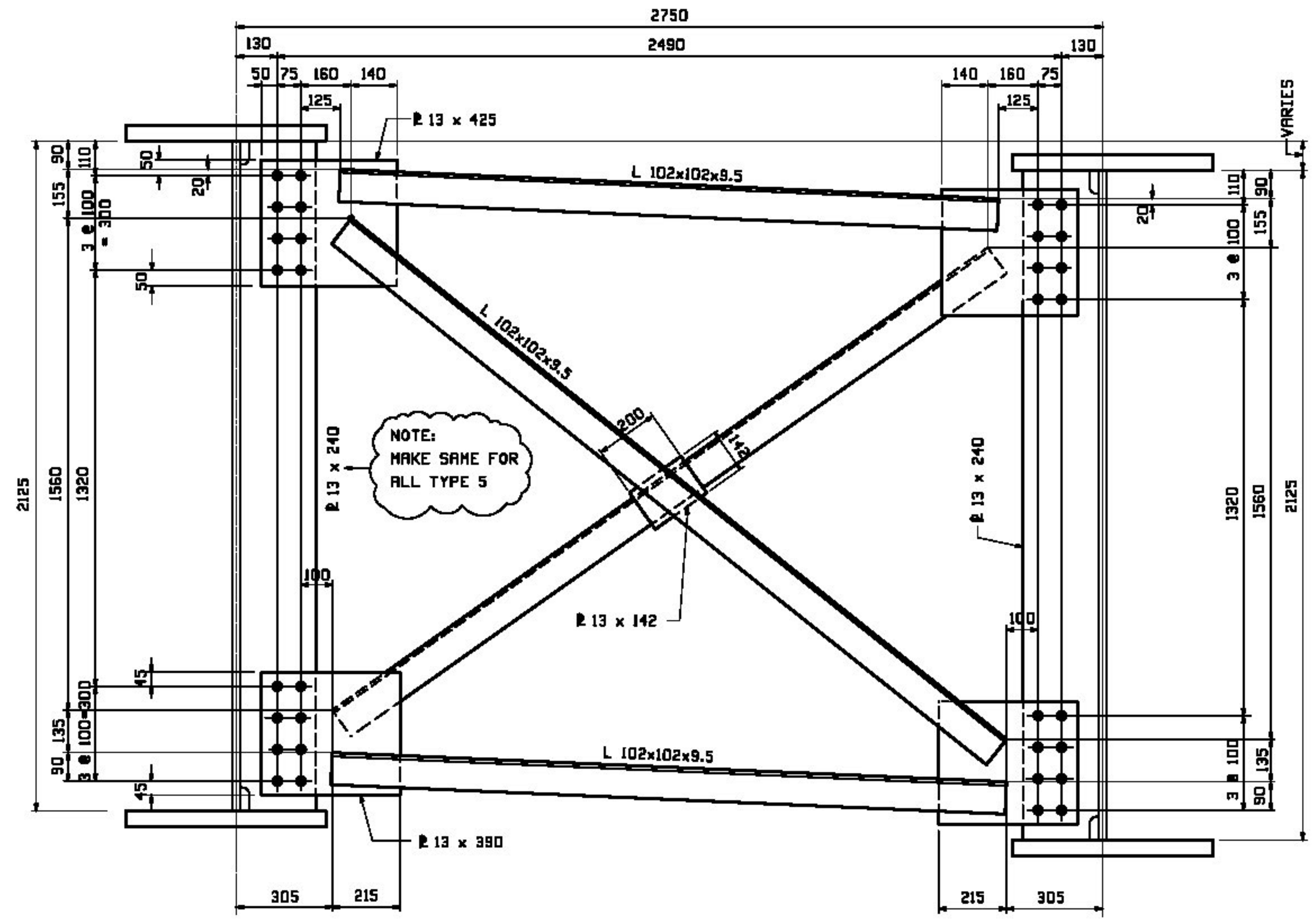

INT DIAPHRAGM TYPE D5

NOTE
 THE PURPOSE OF THIS DRAWING IS TO COORDINATE GEOMETRIC CONTROL INFORMATION AND CONNECTION SPACING. THIS DWG IS SUBMITTED FOR INFORMATION ONLY & IS NOT INTENDED FOR SHOP FABRICATION. DETAIL DWGS WILL SHOW ALL WELDING AND DIMENSIONS REQ'D FOR FABRICATION.

REV.	DATE	REMARKS	DWN	CHK	APVL	SHOP
MATERIAL:		SURFACE PREP. & PAINT:	HOLES:		BOLTS:	
M270-GR 345M			15 DIA		7/8 A325-TYPE 3	
DESCRIPTION: TYPICAL LAYOUTS						
CASCO BAY STEEL STRUCTURES, INC.						
1 WALLACE AVE.			PHONE (207) 780-6722			
SOUTH PORTLAND, ME 04106			FAX: (207) 780-6726			
STRUCTURE:	VT 100 OVER LAHOILLE RIVER		DRAWN:	DATE:		
	MORRISTOWN, VT LAHOILLE COUNTY		HJG	07/29		
	STP F 029-1 (2) C/1		CHKD:	DATE:		
			50B	08/03		
LOCATION:	MORRISTOWN, VT		JOB NO.	DWG NO.		
PROJ NO.	STP F 029-1(2)C/1		521	TD2		
CUSTOMER:	MINTERSET, INC.		REV.			

VERMONT
 Agency of Transportation
 X Approved
 Furnish as Corrected
 Douglas E. Bonneau, P.E.
 Structures Project Manager
 Rejected
 Revise & Resubmit
 Date 12/10/12

McFarland Johnson
 Reviewed
 Rejected
 Furnish As Corrected
 Revise and Resubmit
 This review is only for general conformance with the design concept and the information given in the Construction Documents. Corrections or comments made on the shop drawings during the review do not relieve the Contractor from compliance with the requirements of the Plans and Specifications. Review of a specific item shall not include review of an assembly of which an item is a component. The Contractor is responsible for dimensions to be confirmed and corrected at the job site; information that pertains solely to the fabrication process or to the means, methods, techniques, sequences and procedures of construction; coordination of the Work with that of other trades and performing all Work in a safe and satisfactory manner.
 Date: October 24, 2012
 By: D. Hull