

TEMPORARY 4" WHITE LINE, PAINT
 DURABLE 4" WHITE LINE (OPTION BID ITEM)
 391+50 TO 400+23 SOLID LT
 391+50 TO 392+14 SOLID RT
 392+94 TO 403+50 SOLID RT
 400+23 TO 400+41 SOLID LT (TH 88)
 400+58 TO 401+09 SOLID LT (TH 88)
 401+09 TO 403+50 SOLID LT

TEMPORARY 4" YELLOW LINE, PAINT
 DURABLE 4" YELLOW LINE (OPTION BID ITEM)
 391+50 TO 392+34 SOLID LT & RT
 392+74 TO 400+41 SOLID LT & RT
 400+51 TO 400+61 DOUBLE SOLID LT (TH 88)
 400+81 TO 403+50 SOLID LT & RT

TEMPORARY 24" STOP BAR, PAINT
 DURABLE 24" STOP BAR (OPTION BID ITEM)
 400+38 TO 400+60 LT (TH 88)

TEMPORARY LETTER OR SYMBOL, PAINT
 DURABLE LETTER OR SYMBOL (OPTION BID ITEM)
 400+51 LT - "STOP" (TH 88)

CURVE (38)
 DELTA = 4°49'39" LT
 D = 3°05'49"
 R = 1850.00'
 T = 77.98'
 L = 155.87'
 E = 1.64'
 BANK = 0.032

6 INCH UNDERDRAIN PIPE
 391+50 TO 393+50 LT
 394+00 TO 396+00 LT
 396+20 TO 397+60 LT
 STONE FILL, TYPE I
 GEOTEXTILE UNDER STONE FILL
 391+50 TO 392+25 RT
 REMOVAL OF EXISTING FENCE
 401+14 TO 402+06 RT
 402+45 TO 402+55 RT

STEEL BEAM GUARDRAIL, GALVANIZED
 W/8 FEET POSTS
 391+50 TO 392+44 RT
 392+58 TO 399+17.5 RT
 ANCHOR FOR STEEL BEAM RAIL
 399+17.5 RT
 REMOVAL AND DISPOSAL OF GUARDRAIL
 391+50 TO 392+44 RT
 392+57 TO 399+17 RT

DELINEATOR WITH STEEL POST
 399+17.5 RT
 RELOCATE MAILBOX, SINGLE SUPPORT
 392+42 LT
 392+44 LT
 392+46 LT
 392+48 LT
 REMOVING SIGNS
 AS SHOWN - 6
 ERECTING SALVAGED SIGNS
 AS SHOWN - 6

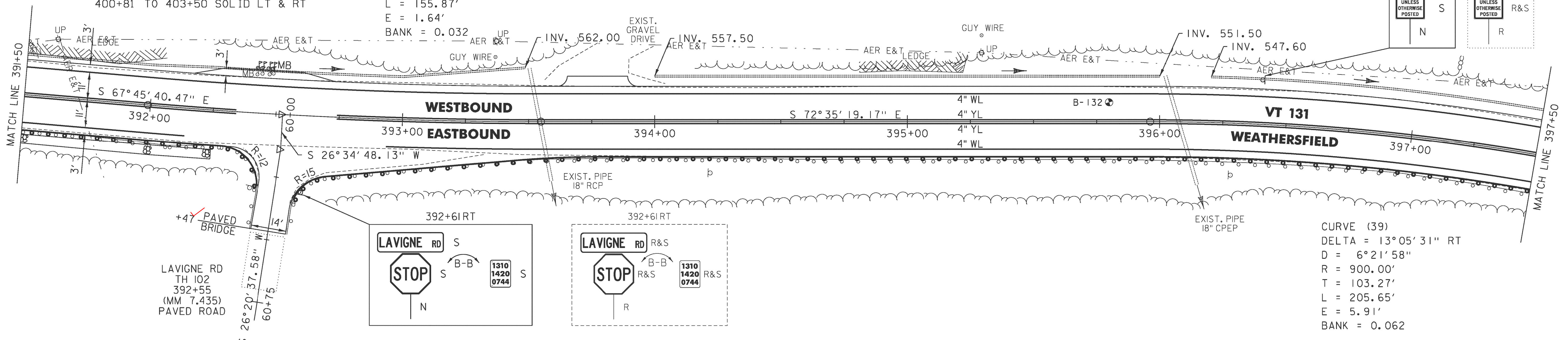
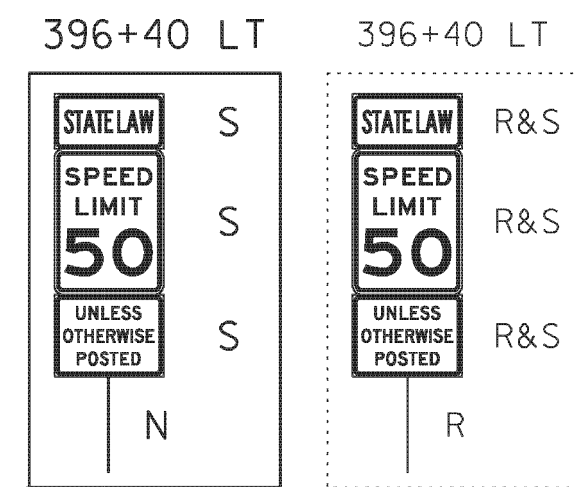

CURVE (39)
 DELTA = 13°05'31" RT
 D = 6°21'58"
 R = 900.00'
 T = 103.27'
 L = 205.65'
 E = 5.91'
 BANK = 0.062

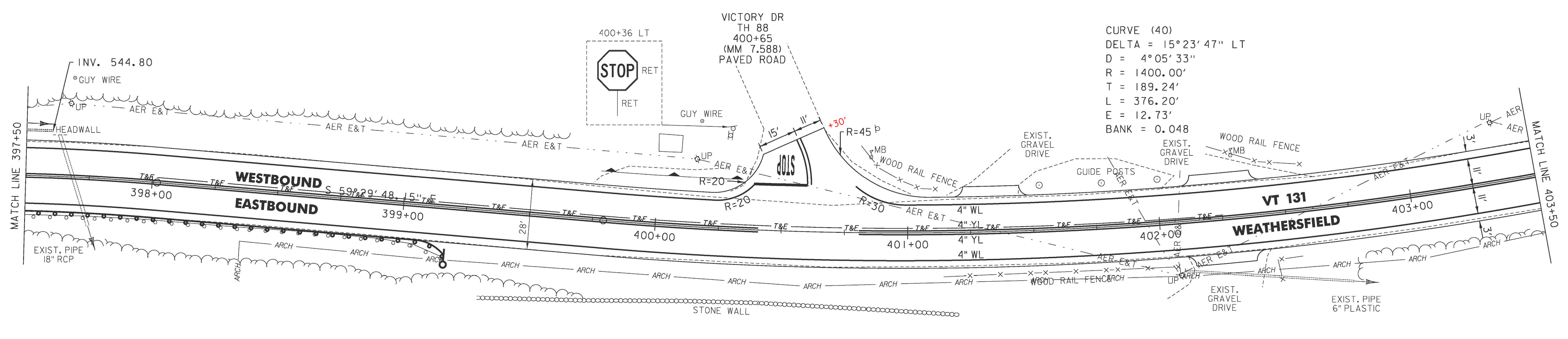

CURVE (40)
 DELTA = 15°23'47" LT
 D = 4°05'33"
 R = 1400.00'
 T = 189.24'
 L = 376.20'
 E = 12.73'
 BANK = 0.048

LEGEND

- R = REMOVE EXISTING
- S = SALVAGE
- R&S = REMOVE AND SALVAGE
- N = NEW
- RET = RETAIN
- B-B = BACK TO BACK
- = EXISTING GUARDRAIL
- ⊕ = PROPOSED GUARDRAIL
- YL = YELLOW LINE
- WL = WHITE LINE
- = DELINEATOR
- ⋯ = UNDERDRAIN
- ⊙ = BORING

ROADWAY LAYOUT SHEET 30

PROJECT NAME: WEATHERSFIELD
 PROJECT NUMBER: STP 2913(1)
 FILE NAME: I0c228.dgn
 PROJECT LEADER: PTS
 DESIGNED BY: NLL
 IPARM FILE NAME: pI0c228.63
 PLOT DATE: 3/7/2013
 DRAWN BY: WWG
 CHECKED BY: PTS
 SHEET 63 OF 234

NOT TO SCALE