

TEMPORARY 4" WHITE LINE, PAINT
 DURABLE 4" WHITE LINE (OPTION BID ITEM)
 98+50 TO 106+35 SOLID LT
 98+50 TO 104+29 SOLID RT
 105+09 TO 109+50 SOLID RT
 106+35 TO 106+61 SOLID LT (TH 10)
 106+81 TO 106+94 SOLID LT (TH 10)
 106+94 TO 109+50 SOLID LT

TEMPORARY 4" YELLOW LINE, PAINT
 DURABLE 4" YELLOW LINE (OPTION BID ITEM)
 98+50 TO 104+49 SOLID LT & RT
 104+89 TO 106+47 SOLID LT & RT
 106+67 TO 106+71 DOUBLE SOLID LT (TH 10)
 106+87 TO 109+50 SOLID LT & RT

TEMPORARY 24" STOP BAR, PAINT
 DURABLE 24" STOP BAR (OPTION BID ITEM)
 106+47 TO 106+66 LT (TH 10)

TEMPORARY LETTER OR SYMBOL, PAINT
 DURABLE LETTER OR SYMBOL (OPTION BID ITEM)
 106+62 LT - "STOP" (TH 10)

REHAB. DROP INLETS, CATCH BASINS,
 OR MANHOLES, CLASS I
 104+09 LT

STONE FILL, TYPE I
 GEOTEXTILE UNDER STONE FILL

98+50 TO 99+75 LT
 98+50 TO 102+50 RT
 103+50 TO 104+00 RT

STEEL BEAM GUARDRAIL, GALVANIZED
 107+99 TO 108+49 LT

STEEL BEAM GUARDRAIL, GALVANIZED
 W/8 FEET POSTS
 98+50 TO 103+37 RT

REMOVE AND RESET GUARDRAIL
 103+37 TO 104+37 RT

H.D. STEEL BEAM
 GUARDRAIL, GALVANIZED
 106+83 TO 107+02 LT
 107+74 TO 107+99 LT

ANCHOR FOR STEEL BEAM RAIL

106+83 LT
 108+49 LT

CURVE (6)
 DELTA = 24°25'10" RT
 D = 10°25'03"
 R = 550.00'
 T = 119.01'
 L = 234.41'
 E = 12.73'
 BANK = 0.060

REMOVAL AND DISPOSAL OF GUARDRAIL
 98+50 TO 103+37 RT
 106+83 TO 107+02 LT
 107+74 TO 108+49 LT

DELINEATOR WITH STEEL POST

106+17 RT
 106+83 LT
 107+83 RT
 108+49 LT

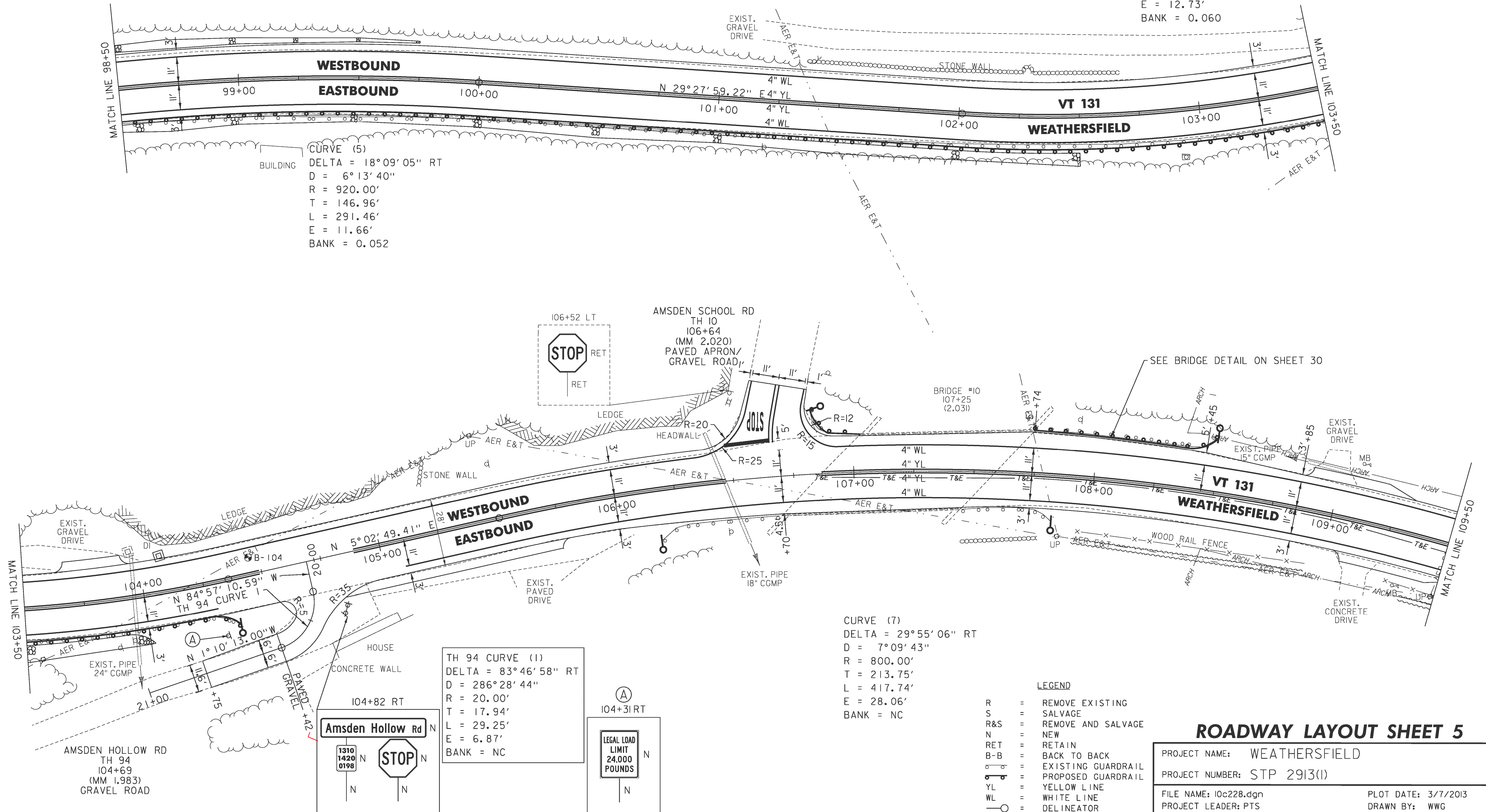

CURVE (5)
 DELTA = 18°09'05" RT
 D = 6°13'40"
 R = 920.00'
 T = 146.96'
 L = 291.46'
 E = 11.66'
 BANK = 0.052

TH 94 CURVE (1)
 DELTA = 83°46'58" RT
 D = 286°28'44"
 R = 20.00'
 T = 17.94'
 L = 29.25'
 E = 6.87'
 BANK = NC

CURVE (7)
 DELTA = 29°55'06" RT
 D = 7°09'43"
 R = 800.00'
 T = 213.75'
 L = 417.74'
 E = 28.06'
 BANK = NC

LEGEND

- R = REMOVE EXISTING
- S = SALVAGE
- R&S = REMOVE AND SALVAGE
- N = NEW
- RET = RETAIN
- B-B = BACK TO BACK
- = EXISTING GUARDRAIL
- = PROPOSED GUARDRAIL
- YL = YELLOW LINE
- WL = WHITE LINE
- = DELINEATOR
- = UNDERDRAIN
- ⊙ = BORING

ROADWAY LAYOUT SHEET 5

| | |
|-----------------------------|---------------------|
| PROJECT NAME: WEATHERSFIELD | PLOT DATE: 3/7/2013 |
| PROJECT NUMBER: STP 2913(1) | DRAWN BY: WWG |
| FILE NAME: 10c228.dgn | CHECKED BY: PTS |
| PROJECT LEADER: PTS | SHEET 38 OF 234 |
| DESIGNED BY: NLL | |
| IPARM FILE NAME: pi0c228_38 | |

NOT TO SCALE