

TEMPORARY 4" WHITE LINE, PAINT  
 DURABLE 4" WHITE LINE (OPTION BID ITEM)  
 239+50 TO 251+50 SOLID LT  
 239+50 TO 251+50 SOLID RT

TEMPORARY 4" YELLOW LINE, PAINT  
 DURABLE 4" YELLOW LINE (OPTION BID ITEM)  
 239+50 TO 251+50 SOLID LT & RT

STEEL BEAM GUARDRAIL, GALVANIZED  
 W/8 FEET POSTS  
 246+20 TO 249+45 RT

ANCHOR FOR STEEL BEAM RAIL  
 246+20 RT  
 249+45 RT

REMOVAL AND DISPOSAL OF GUARDRAIL  
 246+21 TO 249+45 RT

DELINEATOR WITH STEEL POST  
 246+20 RT  
 249+45 RT

CURVE (17)  
 DELTA = 35° 16' 57" LT  
 D = 4° 52' 34"  
 R = 1175.00'  
 T = 373.66'  
 L = 723.56'  
 E = 57.98'  
 BANK = 0.071

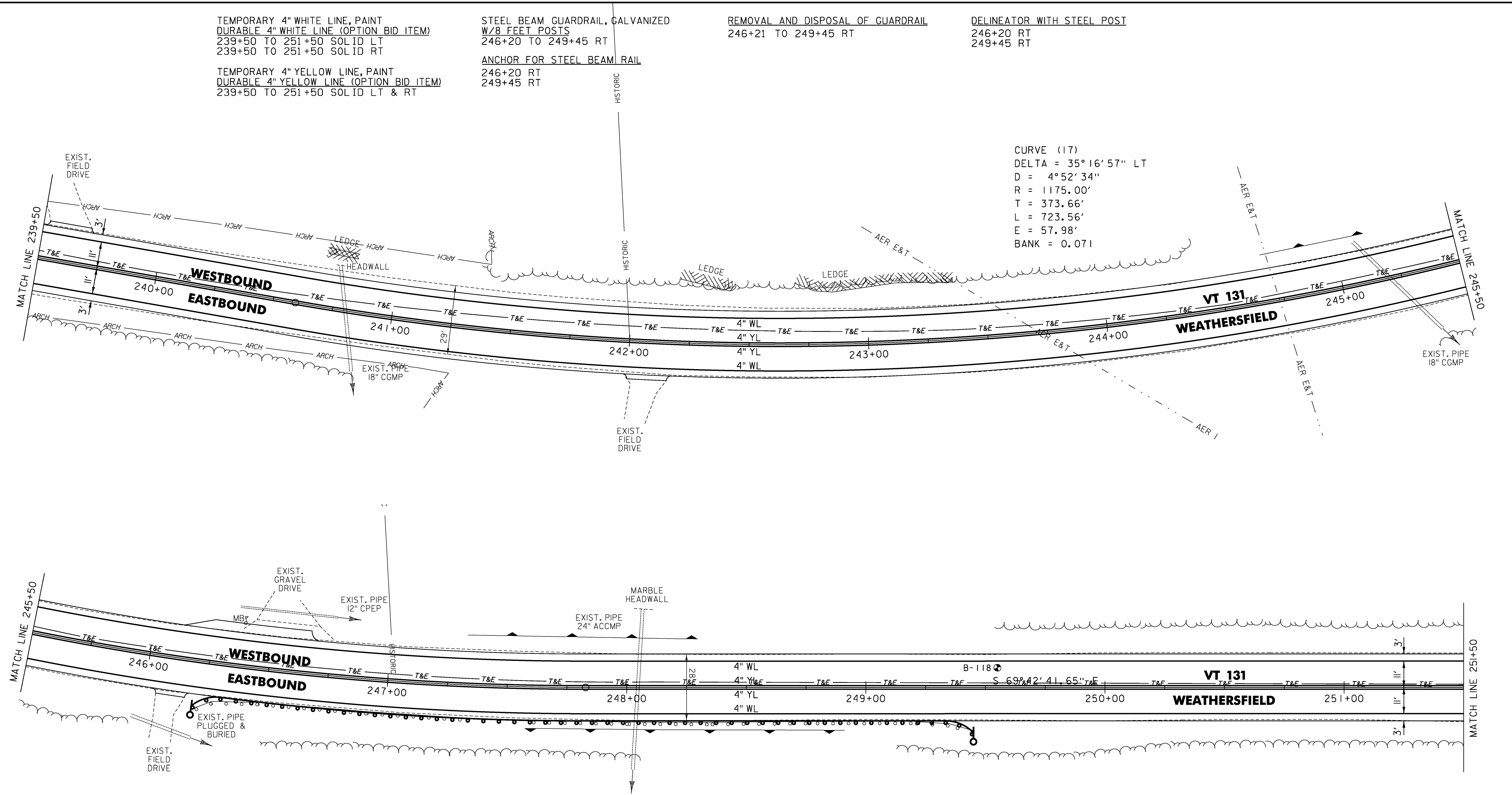

LEGEND

- R = REMOVE EXISTING
- S = SALVAGE
- R&S = REMOVE AND SALVAGE
- N = NEW
- RET = RETAIN
- B-B = BACK TO BACK
- = EXISTING GUARDRAIL
- = PROPOSED GUARDRAIL
- YL = YELLOW LINE
- WL = WHITE LINE
- = DELINEATOR
- = UNDERDRAIN
- ⊙ = BORING

ROADWAY LAYOUT SHEET 17

PROJECT NAME: WEATHERSFIELD

PROJECT NUMBER: STP 2913(I)

FILE NAME: I0c228.dgn

PROJECT LEADER: PTS

DESIGNED BY: NLL

IPARM FILE NAME: p10c228\_50

PLOT DATE: 3/7/2013

DRAWN BY: WWG

CHECKED BY: PTS

SHEET 50 OF 234

NOT TO SCALE