

PLAN
SCALE: 1" = 1'-0"

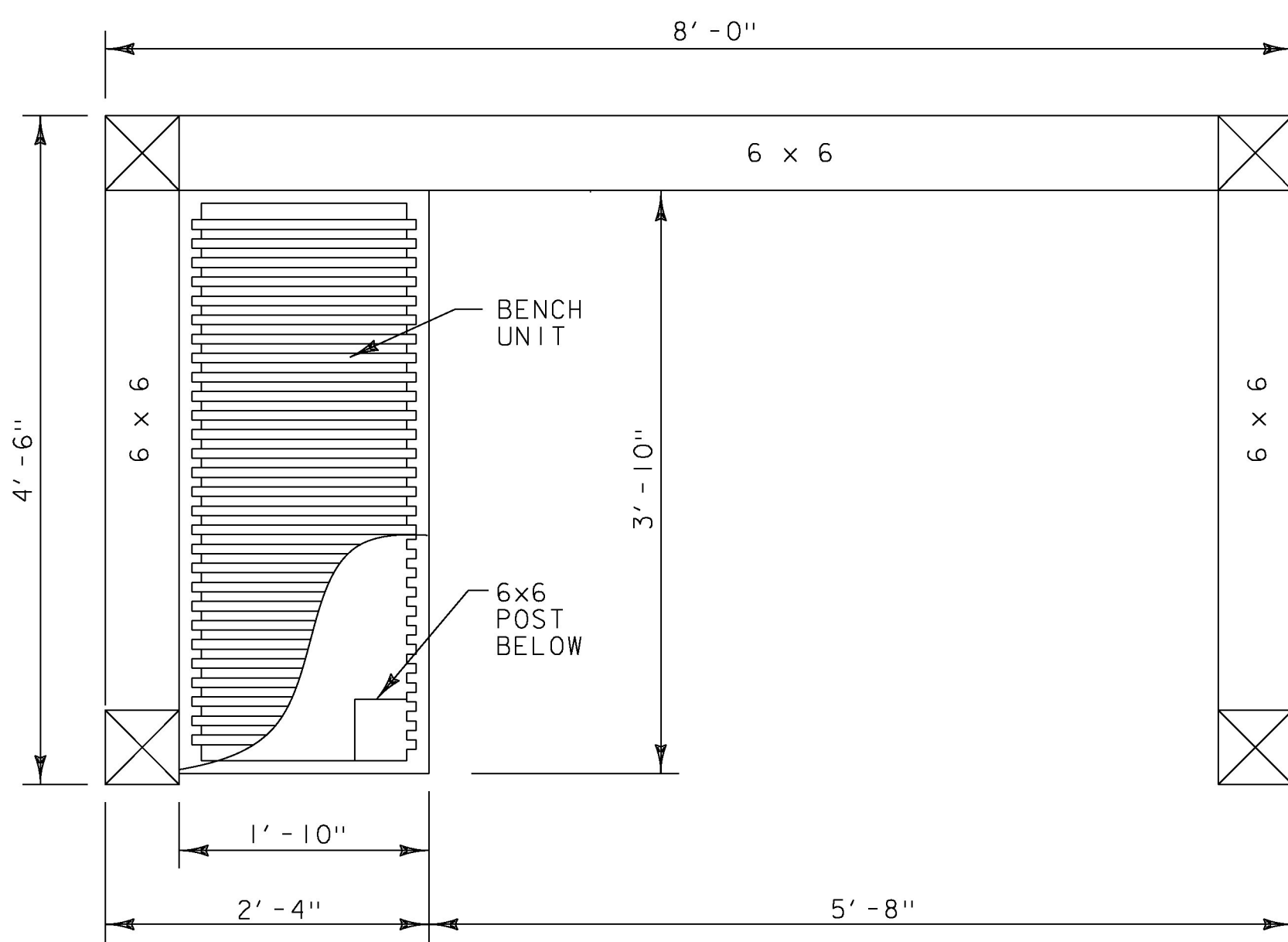

PLAN VIEW
SCALE: 1" = 1'-0"

REINFORCING SCHEDULE

NO. PIECES	SIZE	LENGTH	MARK	TYPE
7	5	8'-6"	S501	STR.
11	5	5'-0"	S502	STR.

NOTES:
REINFORCING STEEL SHALL BE PAID UNDER ITEM 507.11 REINFORCING STEEL, LEVEL 1.

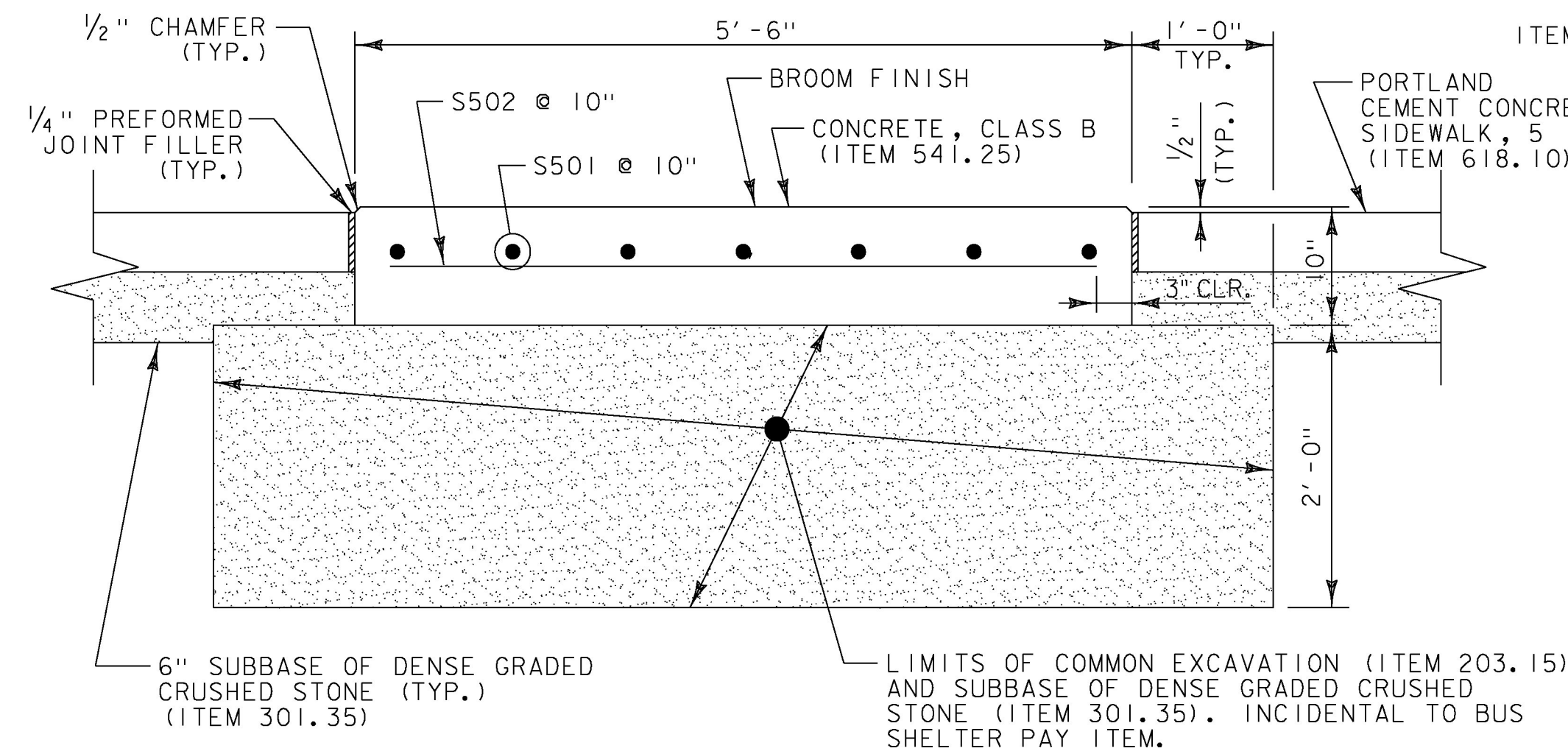

SECTION A-A
SCALE: 1" = 1'-0"

BUS SHELTER SLAB DETAIL

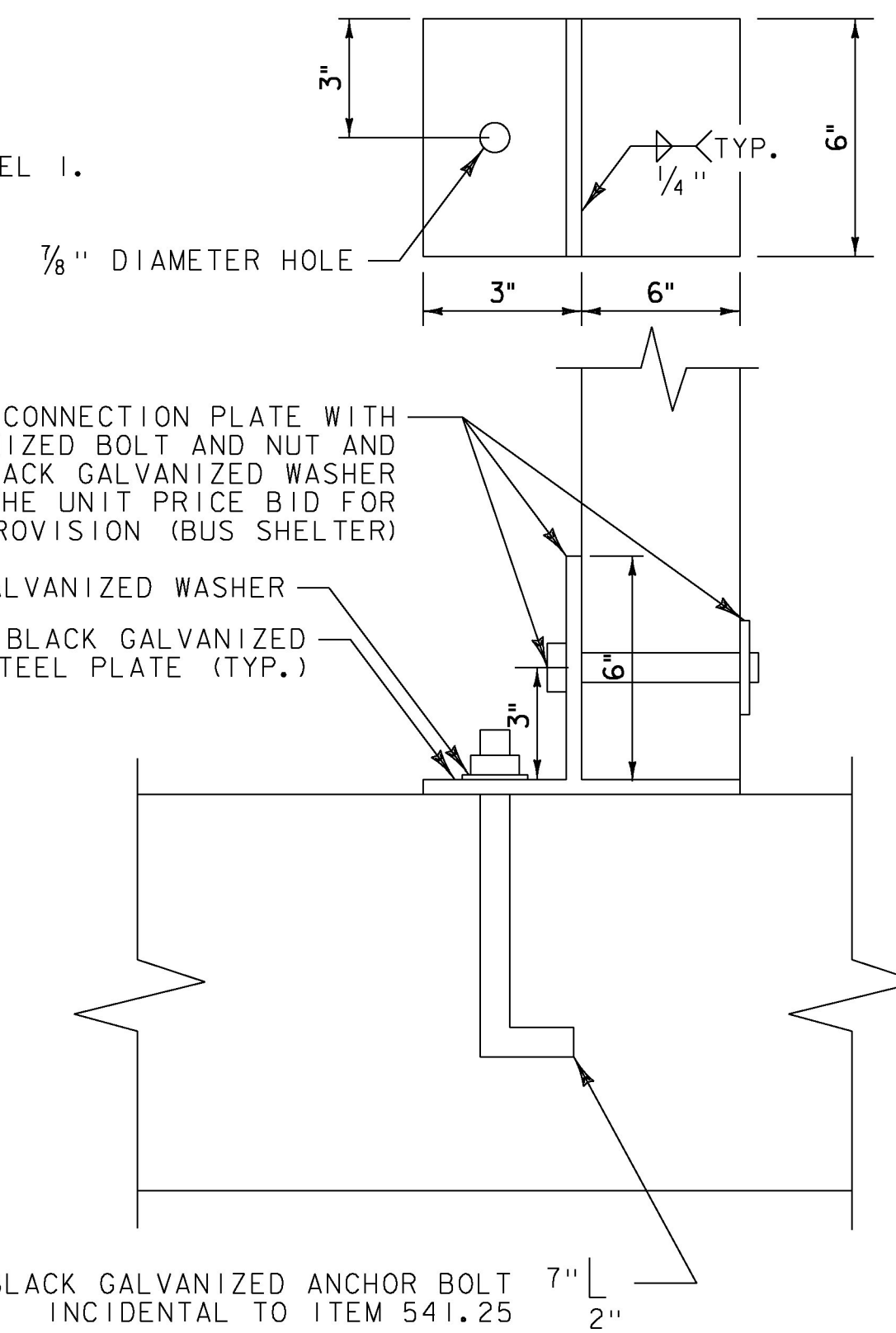

DETAIL A
NOT TO SCALE

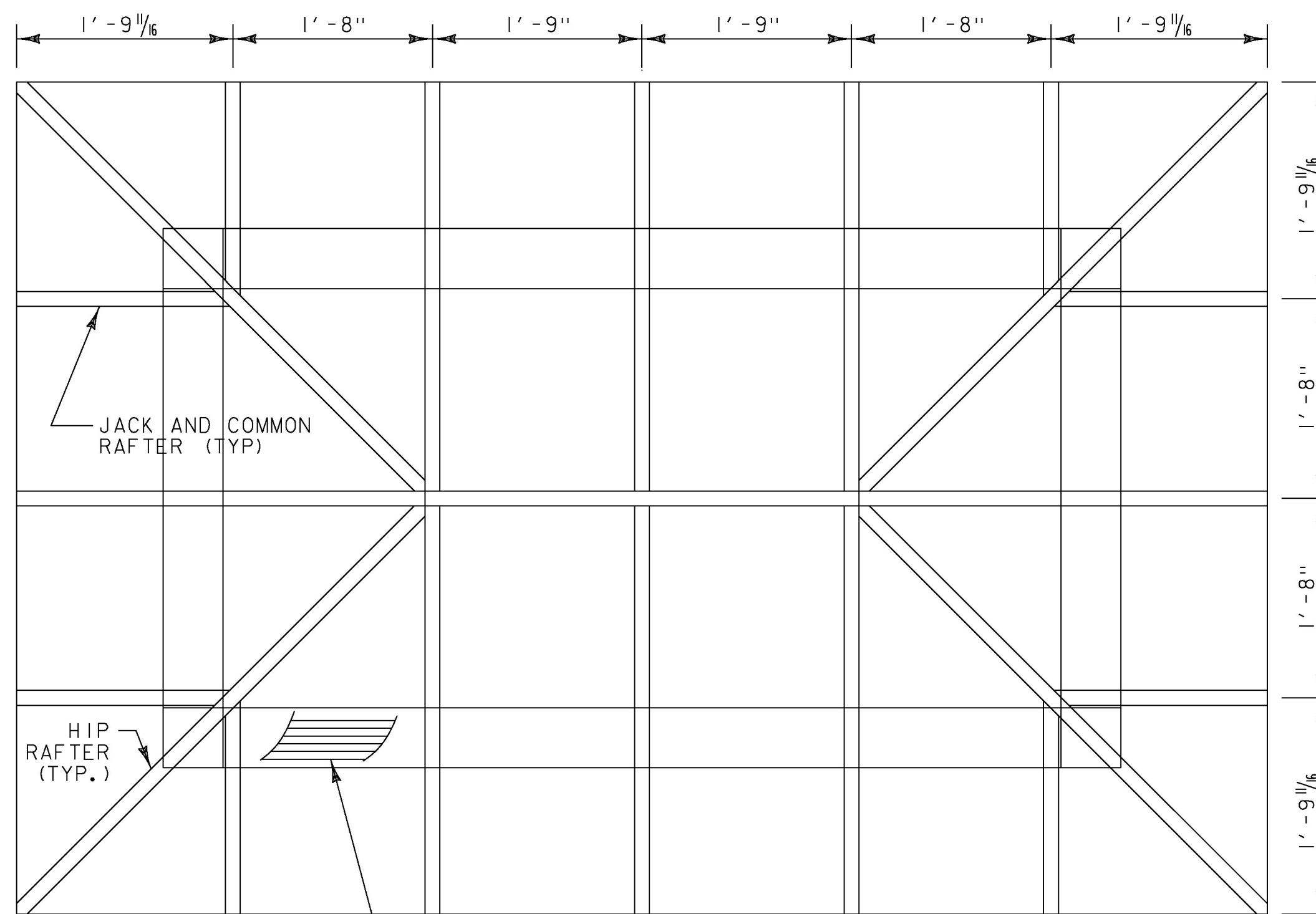

ROOF DECKING TO BE NOMINAL 2x6 V-GROOVE, T&G ROOF DECK.

NOTES:
1. JACK AND COMMON RAFTERS ARE 2x6.
2. HIP RAFTERS ARE 2x7
3. RIDGE BEAM IS 2x8

ROOF FRAMING
SCALE: 1" = 1'-0"

- NOTES:
- ALL MATERIALS AND CONSTRUCTION SHALL CONFORM TO STATE OF VERMONT AGENCY OF TRANSPORTATION, 2011 STANDARD SPECIFICATIONS FOR HIGHWAY AND BRIDGE CONSTRUCTION, ITS LATEST REVISIONS, AND THE AASHTO LRFD BRIDGE DESIGN SPECIFICATIONS, DATED 2010, AND ITS LATEST REVISIONS.
 - REINFORCING PLACEMENT TOLERANCES SHALL BE:
SPACING +/- 1"
CLEARANCE +/- 1/4"
 - ALL EXPOSED EDGES OF CONCRETE SHALL BE CHAMFERED 1/2" BY 1/2"
 - WATER REPELLENT SILANE (ITEM 514.10) SHALL BE APPLIED TO ALL EXPOSED CONCRETE.
 - ALL MATERIALS AND WORK DETAILED ON THIS SHEET SHALL BE INCLUDED UNDER ITEM 900.645 SPECIAL PROVISION (BUS SHELTER) UNLESS OTHERWISE NOTED.
 - ALL WOODEN PEGS SHALL BE 1" DIAMETER OAK.
 - THE STRUCTURE WAS DESIGNED FOR THE FOLLOWING LOADS:
GROUND SNOW LOAD = 100 psf
BASIC WIND SPEED = 90 mph
CATEGORY I
 - ALL DIMENSIONS ARE NOMINAL. MEMBERS SHALL BE SURFACED ON FOUR SIDES.
 - TIMBER FRAMING SHALL BE APPEARANCE GRADE WHITE OAK (NO. 1).
ROOF SHEATHING SHALL BE NO. 1 OR NO. 2 SPF.
BENCH FRAMING SHALL BE APPEARANCE GRADE WHITE OAK (NO. 1).
 - SEE BUS SHELTER SPECIAL PROVISION IN CONTRACT DOCUMENTS FOR ADDITIONAL REQUIREMENTS.

PROJECT NAME: BRADFORD
PROJECT NUMBER: CMG PARK (33)

FILE NAME: z09k252shitr_def.dgn
PROJECT LEADER: M. FOISY
DESIGNED BY: J. HUNGERFORD
BUS SHELTER DETAILS I

PLOT DATE: 5/22/2014
DRAWN BY: L. BUXTON
CHECKED BY: G. BOGUE
SHEET 19 OF 33

