

INDEX OF SHEETS

1	TITLE SHEET
2-3	TYPICAL SECTIONS SHEETS
4-6	QUANTITY SHEETS
7	EARTHWORK SHEET
8	SURVEY CONTROL AND TIES
9	CONVENTIONAL SYMBOLS & LEGEND SHEET
10	LAYOUT PLAN
11	PROFILE
12	GRADING AND DRAINAGE PLAN
13	SIGNING AND PAVEMENT MARKING PLAN
14	TRAFFIC SIGN SUMMARY SHEET
15	LIGHTING AND LANDSCAPE PLAN
16-17	LIGHTING DETAILS
18	LIGHTING AND LANDSCAPING DETAILS
19-22	BUS SHELTER DETAILS
23	CONSTRUCTION APPROACH SIGNING
24-27	CROSS SECTIONS
28	EPSC NARRATIVE
29	EPSC CONSTRUCTION SITE PLAN
30	EPSC EXISTING CONDITIONS PLAN
31	EPSC FINAL CONDITIONS SITE PLAN
32-33	EPSC DETAILS

INDEX OF STANDARDS

B-5	SLOPE GRADING, EMBANKMENTS, MUCK	06-01-1994
B-71	STANDARDS FOR RESIDENTIAL AND COMMERCIAL DRIVES	07-08-2005
D-20	HIGHWAY CROSSING FOR UNDERGROUND UTILITIES	03-03-2003
E-121	STANDARD SIGN PLACEMENT - CONVENTIONAL ROAD	08-08-1995
E-132	GENERAL MOTORIST SERVICE SIGN DETAILS	08-18-1995
E-143	REGULATORY SIGN DETAILS	06-15-2004
E-144	REGULATORY SIGN DETAILS	03-29-1999
E-146	REGULATORY SIGN DETAILS	09-20-1995
E-173	PULLBOXES AND JUNCTION BOXES	08-09-1995
E-175	POWER DROP STANCHIONS	06-08-2009
E-180A	STREET LIGHTING DETAILS	08-09-1995
E-180B	STREET LIGHTING DETAILS	08-09-1995
E-191	PAVEMENT MARKING DETAILS	02-01-1999
E-192	PAVEMENT MARKING DETAILS	10-12-2000
E-193	PAVEMENT MARKING DETAILS	08-18-1995
T-1	TRAFFIC CONTROL GENERAL NOTES	08-06-2012
T-10	CONVENTIONAL ROADS CONSTRUCTION APPROACH SIGNING	08-06-2012
T-28	CONSTRUCTION SIGN DETAILS	08-06-2012
T-29	CONSTRUCTION SIGN DETAILS	08-06-2012
T-30	CONSTRUCTION SIGN DETAILS	08-06-2012
T-45	SQUARE TUBE SIGN POST AND ANCHOR	01-02-2013

STATE OF VERMONT
AGENCY OF TRANSPORTATION



PROPOSED IMPROVEMENT
TOWN OF BRADFORD
COUNTY OF ORANGE
PARK AND RIDE LOT

THIS PROJECT IS LOCATED ON THE NORTH SIDE OF VT ROUTE 25 IN THE TOWN OF BRADFORD, VT AT THE INTERSECTION OF ROUTE 25 AND OLD CREAMERY RD (TH27)

WORK TO BE PERFORMED UNDER THIS PROJECT INCLUDES RECONSTRUCTION OF THE EXISTING PARK-AND-RIDE LOT, CONSTRUCTING A BUS SHELTER, PAVEMENT MARKINGS, LED LIGHTING, EV OUTLETS, LEVEL 1 AND OTHER HIGHWAY RELATED ITEMS.

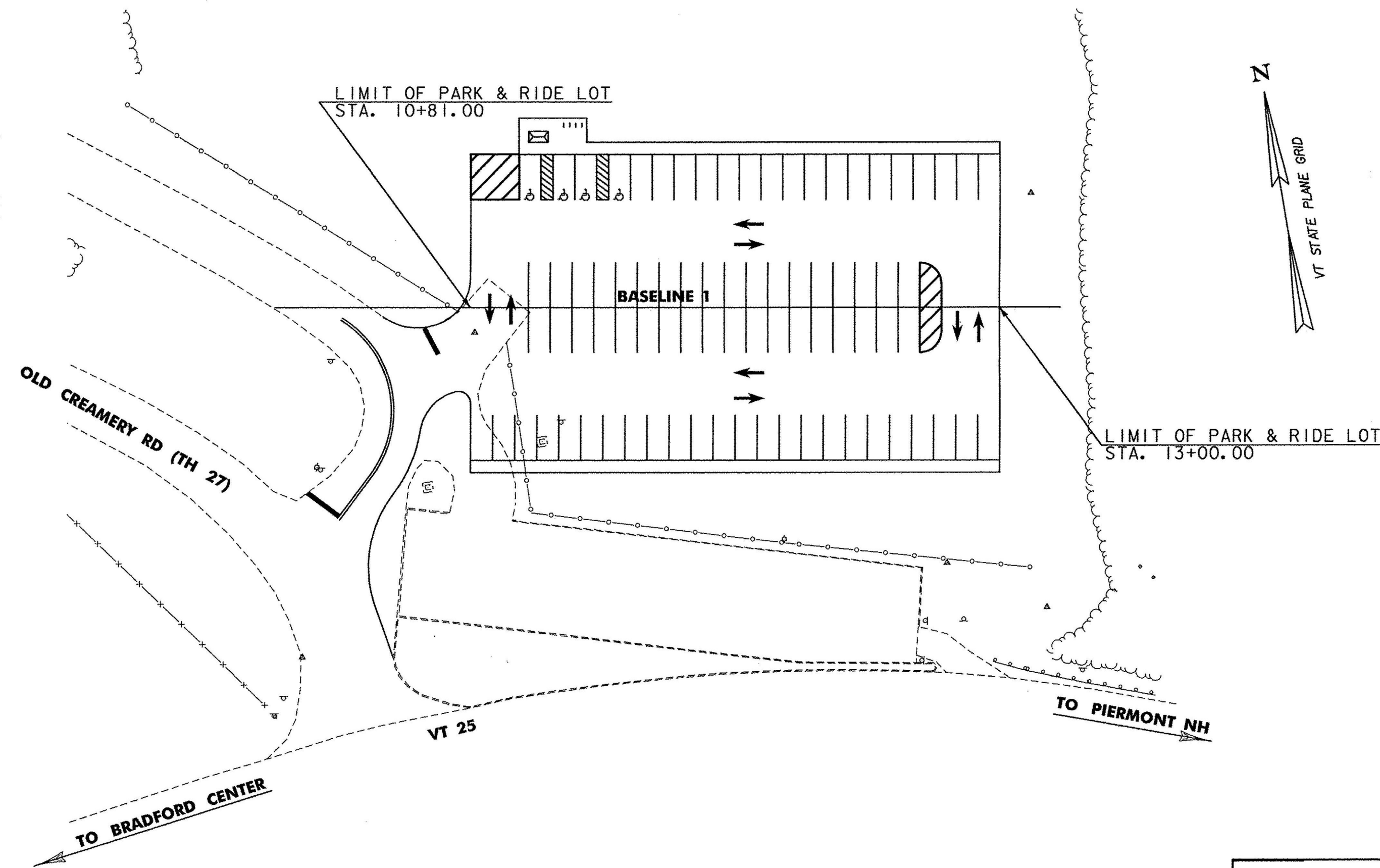
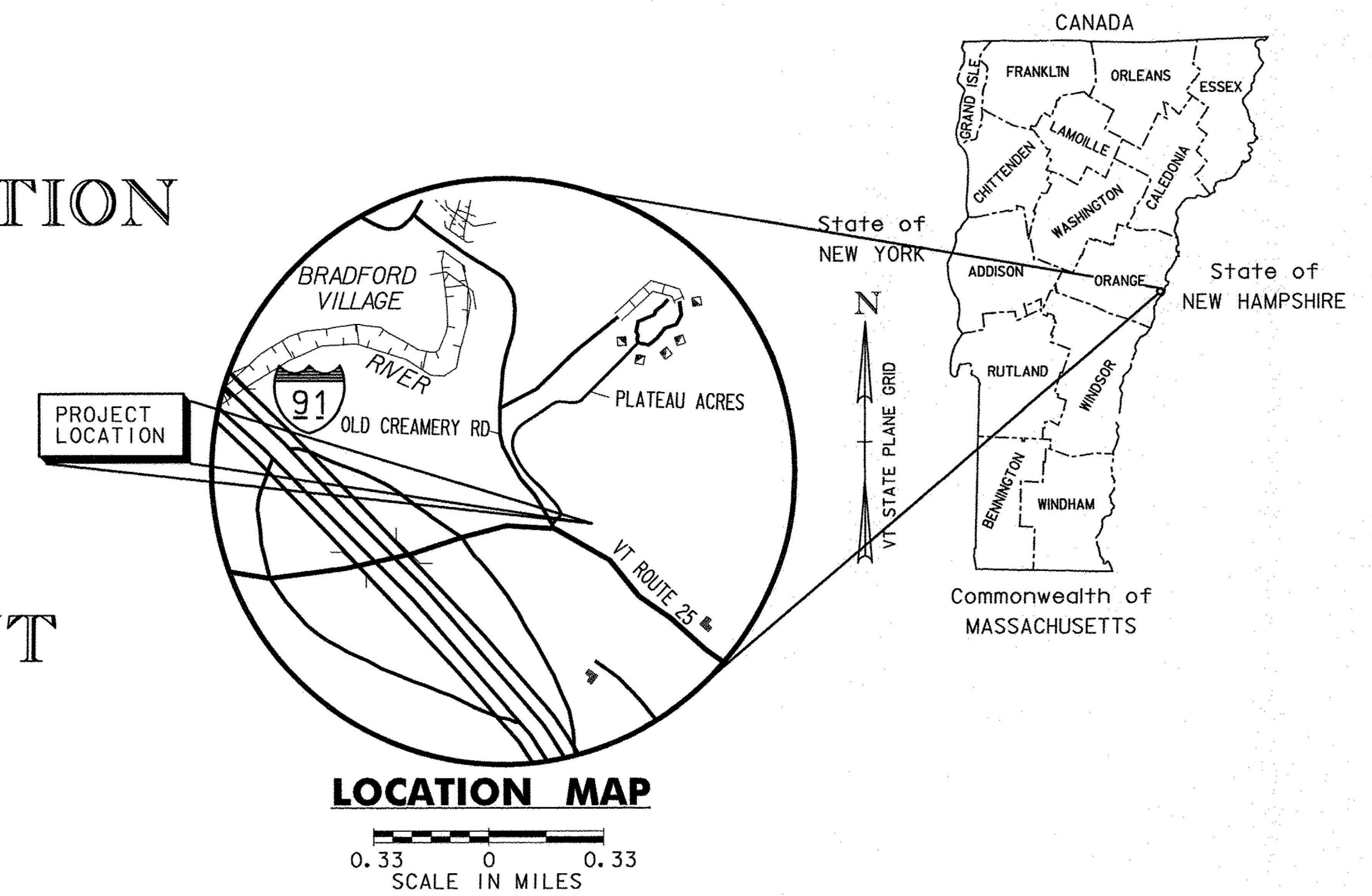

RECORD PLANS	
CONTRACTOR:	L&M SERVICE CONTRACTORS, LLC-ORFORD, NH
RESIDENT ENGINEER:	PETE HODGSON
CONSTRUCTION BEGAN:	MAY 14, 2015
CONSTRUCTION COMPLETE:	SEPTEMBER 03, 2015
RECORD PLANS BY:	PETE HODGSON & JESSE IVES
I HEREBY CERTIFY THAT ALL THE CONSTRUCTION REQUIRED BY THIS SET OF DRAWINGS HAS BEEN ACCOMPLISHED AS INDICATED HEREIN.	
BY:	<i>Pete Hodgson</i> RESIDENT ENGINEER
DATE:	10/31/18
NOTE: Any further information concerning final quantities, amounts or other details relative to this project may be found at Central Files in the electronic archives.	

THESE PLANS ARE SUBJECT TO SUCH ENGINEERING CHANGES AS MAY BE REQUIRED BY THE FEDERAL HIGHWAY ADMINISTRATION OR THE DIRECTOR OF PROGRAM DEVELOPMENT.

CONSTRUCTION IS TO BE CARRIED ON IN ACCORDANCE WITH THESE PLANS AND THE STANDARD SPECIFICATIONS FOR CONSTRUCTION DATED 2011, AS APPROVED BY THE FEDERAL HIGHWAY ADMINISTRATION ON JULY 20, 2011 FOR USE ON THIS PROJECT, INCLUDING ALL SUBSEQUENT REVISIONS AND SUCH REVISED SPECIFICATIONS AND SPECIAL PROVISIONS AS ARE INCORPORATED IN THESE PLANS.

QUALITY ASSURANCE PROGRAM : LEVEL 3
SURVEYED BY : VAOT
SURVEYED DATE : 8/09
DATUM
VERTICAL NAVD 88
HORIZONTAL NAD 83

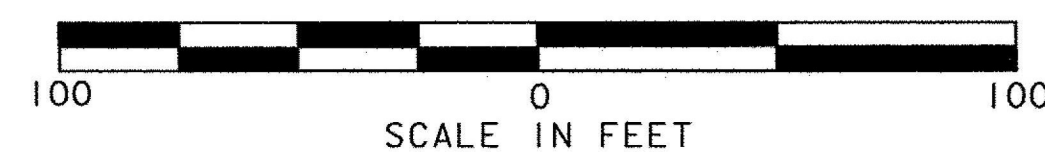

<p>Stantec Consulting Services Inc. 55 Green Mountain Drive South Burlington VT U.S.A. 05403 Phone: (802) 864-0223 Fax: (802) 864-0165 www.stantec.com</p>	DIRECTOR OF PROGRAM DEVELOPMENT
	APPROVED _____ DATE _____
	PROJECT MANAGER : WAYNE L. DAVIS
	PROJECT NAME : BRADFORD PROJECT NUMBER : CMG PARK (33)
SHEET 1 OF 33 SHEETS	