

PORTLAND CEMENT CONCRETE SIDEWALK, 8 INCH
 STA. 103+69.0, 104.8', LT - 103+74.0, 16.8' LT
 STA. 103+69.0, 97.0', RT - 103+74.0, 16.9' RT
 STA. 204+86.4, @

DETECTABLE WARNING SURFACE
 STA. 204+86.4, @

CHAIN-LINK FENCE, 4 FT
 STA. 100+73.2, 7.0' RT - 102+89.1, 128.0' RT

REMOVAL AND DISPOSAL OF GUARDRAIL
 STA. 100+68.2, 8.4' RT - 101+83.9, 127.2' RT
 STA. 101+21.1, 30.2' LT - 103+81.4, 67.8' LT

BOLLARDS
 STA. 204+77.4, 6.3' RT
 STA. 204+77.4, 6.3' LT
 STA. 204+77.4, @

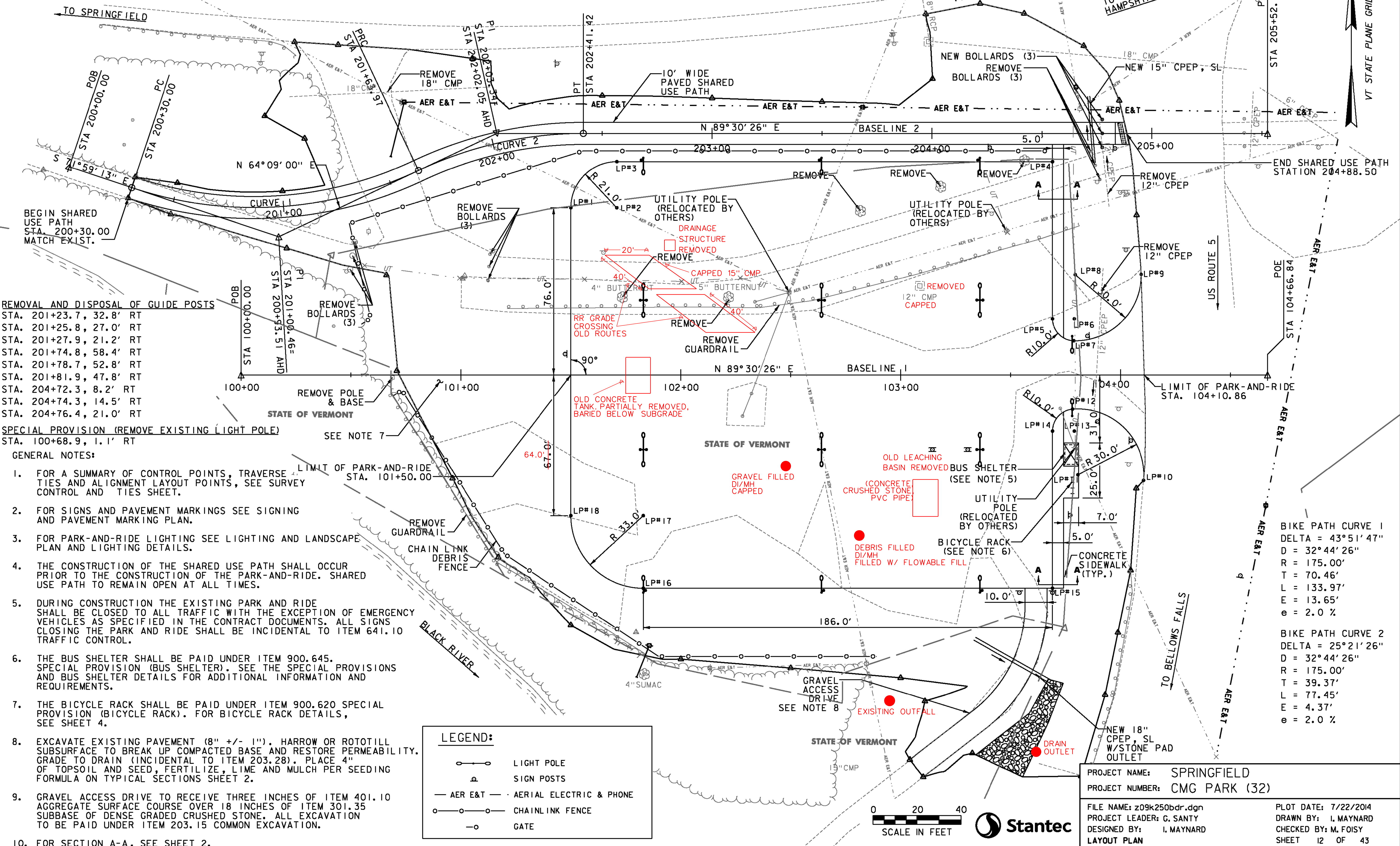

REMOVAL AND DISPOSAL OF GUIDE POSTS
 STA. 201+23.7, 32.8' RT
 STA. 201+25.8, 27.0' RT
 STA. 201+27.9, 21.2' RT
 STA. 201+74.8, 58.4' RT
 STA. 201+78.7, 52.8' RT
 STA. 201+81.9, 47.8' RT
 STA. 204+72.3, 8.2' RT
 STA. 204+74.3, 14.5' RT
 STA. 204+76.4, 21.0' RT

SPECIAL PROVISION (REMOVE EXISTING LIGHT POLE)
 STA. 100+68.9, 1.1' RT

GENERAL NOTES:

- FOR A SUMMARY OF CONTROL POINTS, TRAVERSE TIES AND ALIGNMENT LAYOUT POINTS, SEE SURVEY CONTROL AND TIES SHEET.
- FOR SIGNS AND PAVEMENT MARKINGS SEE SIGNING AND PAVEMENT MARKING PLAN.
- FOR PARK-AND-RIDE LIGHTING SEE LIGHTING AND LANDSCAPE PLAN AND LIGHTING DETAILS.
- THE CONSTRUCTION OF THE SHARED USE PATH SHALL OCCUR PRIOR TO THE CONSTRUCTION OF THE PARK-AND-RIDE. SHARED USE PATH TO REMAIN OPEN AT ALL TIMES.
- DURING CONSTRUCTION THE EXISTING PARK AND RIDE SHALL BE CLOSED TO ALL TRAFFIC WITH THE EXCEPTION OF EMERGENCY VEHICLES AS SPECIFIED IN THE CONTRACT DOCUMENTS. ALL SIGNS CLOSING THE PARK AND RIDE SHALL BE INCIDENTAL TO ITEM 641.10 TRAFFIC CONTROL.
- THE BUS SHELTER SHALL BE PAID UNDER ITEM 900.645. SPECIAL PROVISION (BUS SHELTER). SEE THE SPECIAL PROVISIONS AND BUS SHELTER DETAILS FOR ADDITIONAL INFORMATION AND REQUIREMENTS.
- THE BICYCLE RACK SHALL BE PAID UNDER ITEM 900.620 SPECIAL PROVISION (BICYCLE RACK). FOR BICYCLE RACK DETAILS, SEE SHEET 4.
- EXCAVATE EXISTING PAVEMENT (8" +/- 1"). HARROW OR ROTOTILL SUBSURFACE TO BREAK UP COMPACTED BASE AND RESTORE PERMEABILITY. GRADE TO DRAIN (INCIDENTAL TO ITEM 203.28). PLACE 4" OF TOPSOIL AND SEED, FERTILIZE, LIME AND MULCH PER SEEDING FORMULA ON TYPICAL SECTIONS SHEET 2.
- GRAVEL ACCESS DRIVE TO RECEIVE THREE INCHES OF ITEM 401.10 AGGREGATE SURFACE COURSE OVER 18 INCHES OF ITEM 301.35 SUBBASE OF DENSE GRADED CRUSHED STONE. ALL EXCAVATION TO BE PAID UNDER ITEM 203.15 COMMON EXCAVATION.
- FOR SECTION A-A, SEE SHEET 2.

LEGEND:

	LIGHT POLE
	SIGN POSTS
	AERIAL ELECTRIC & PHONE
	CHAIN LINK FENCE
	GATE

PROJECT NAME: SPRINGFIELD
 PROJECT NUMBER: CMG PARK (32)

FILE NAME: z09k250bdr.dgn
 PROJECT LEADER: G. SANTY
 DESIGNED BY: I. MAYNARD
 LAYOUT PLAN

PLOT DATE: 7/22/2014
 DRAWN BY: I. MAYNARD
 CHECKED BY: M. FOISY
 SHEET 12 OF 43

BIKE PATH CURVE 1
 DELTA = 43°51'47"
 D = 32°44'26"
 R = 175.00'
 T = 70.46'
 L = 133.97'
 E = 13.65'
 e = 2.0 %

BIKE PATH CURVE 2
 DELTA = 25°21'26"
 D = 32°44'26"
 R = 175.00'
 T = 39.37'
 L = 77.45'
 E = 4.37'
 e = 2.0 %