

INDEX OF SHEETS

1. TITLE SHEET
2. QUANTITY SHEET
- 3-8. TRAFFIC SIGNAL SHEETS

STANDARDS

E-100	CONSTRUCTION APPROACH SIGNS	01/02/2004
E-100A	SIDE ROAD CONSTRUCTION APPROACH SIGNS	01/02/2004
E-101	CONSTRUCTION SIGN DETAILS	05/30/2003
E-102	CONSTRUCTION SIGN DETAILS	06/30/2003
E-110	MAJOR MAINTENANCE OPERATION LANE CLOSURE	08/08/1995
E-111	MINOR MAINTENANCE OPERATIONS	03/11/1997
E-171A	TRAFFIC CONTROL SIGNALS GENERAL NOTES AND DETAILS	08/09/1995
E-171B	TRAFFIC CONTROL SIGNALS MISC. DETAILS	08/09/1995
E-171C	TRAFFIC CONTROL SIGNALS CANTILEVER MOUNTING DETAILS	08/09/1995

STATE OF VERMONT AGENCY OF TRANSPORTATION



PROPOSED IMPROVEMENT TOWN OF COLCHESTER COUNTY OF CHITTENDEN US ROUTE 7 - PRINCIPAL ARTERIAL

TOWN OF COLCHESTER, US 7 AT THE INTERSECTIONS OF SOUTH PARK DRIVE (MM 0.146), I-89 EXIT 16 SB RAMP (MM 0.211), I-89 EXIT 16 NB RAMP (MM 0.225), MOUNTAIN VIEW DRIVE (MM 0.397), HERCULES DRIVE (MM 0.669), AND RATHE ROAD (MM 0.892).

LENGTH OF ROADWAY - US 7 & SOUTH PARK DRIVE	500 FT	.09 MILES
LENGTH OF ROADWAY - US 7 & I-89 EXIT 16 SB RAMP	500 FT	.09 MILES
LENGTH OF ROADWAY - US 7 & I-89 EXIT 16 NB RAMP	500 FT	.09 MILES
LENGTH OF ROADWAY - US 7 & MOUNTAIN VIEW DRIVE	500 FT	.09 MILES
LENGTH OF ROADWAY - US 7 & HERCULES DRIVE	500 FT	.09 MILES
LENGTH OF ROADWAY - US 7 & RATHE ROAD	500 FT	.09 MILES
TOTAL LENGTH OF ROADWAY	3000 FT	.57 MILES

THIS PROJECT SHALL CONSIST OF ALL WORK ASSOCIATED WITH THE INSTALLATION OF PREEMPTION & VIDEO DETECTION EQUIPMENT AT SIX SIGNALIZED INTERSECTIONS.

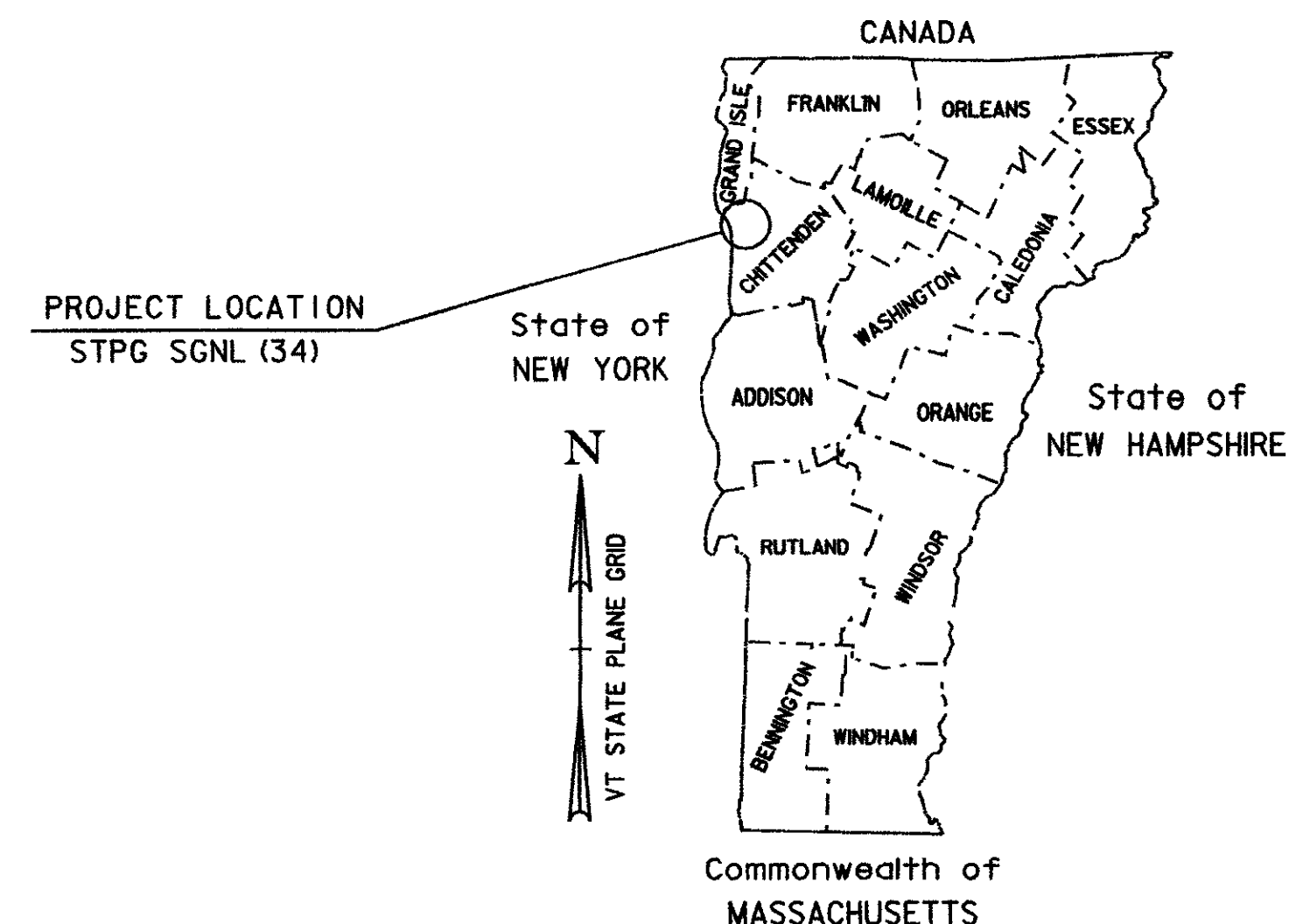

RECORD PLANS	
CONTRACTOR	EAST COAST SIGNALS, INC - DEERFIELD, NH
RESIDENT ENGINEER	DALE NORTON
CONSTRUCTION BEGAN	OCTOBER 8, 2009
CONSTRUCTION COMPLETE	NOVEMBER 16, 2009
RECORD PLANS BY	DALE NORTON
I HEREBY CERTIFY THAT ALL THE CONSTRUCTION REQUIRED BY THIS SET OF DRAWINGS HAS BEEN ACCOMPLISHED AS INDICATED HEREIN	
BY	<i>Dale R. Norton</i> RESIDENT ENGINEER
DATE	28 June 2010
NOTE: Any further information concerning final quantities, amounts or other details relative to this project may be found at Central Files in the electronic archives	

CONVENTIONAL SYMBOLS	
COUNTY LINE	
TOWN LINE	
LIMITS OF ACCESS	
POINT OF ACCESS	
FENCE LINE	
STONE WALL	
TRAVELED WAY	
GUARD RAIL	
RAILROAD	
SURVEY LINE	
CULVERT	
POWER POLE	
TELEPHONE POLE	
TREES	
CONTROL OF ACCESS	
PROPERTY LINE	
R.O.W. TAKING LINE	
SLOPE RIGHTS	
TOP OF CUT	
TOE OF SLOPE	

SURVEYED BY : N/A
 SURVEYED DATE : N/A
 DATUM
 VERTICAL N/A
 HORIZONTAL N/A

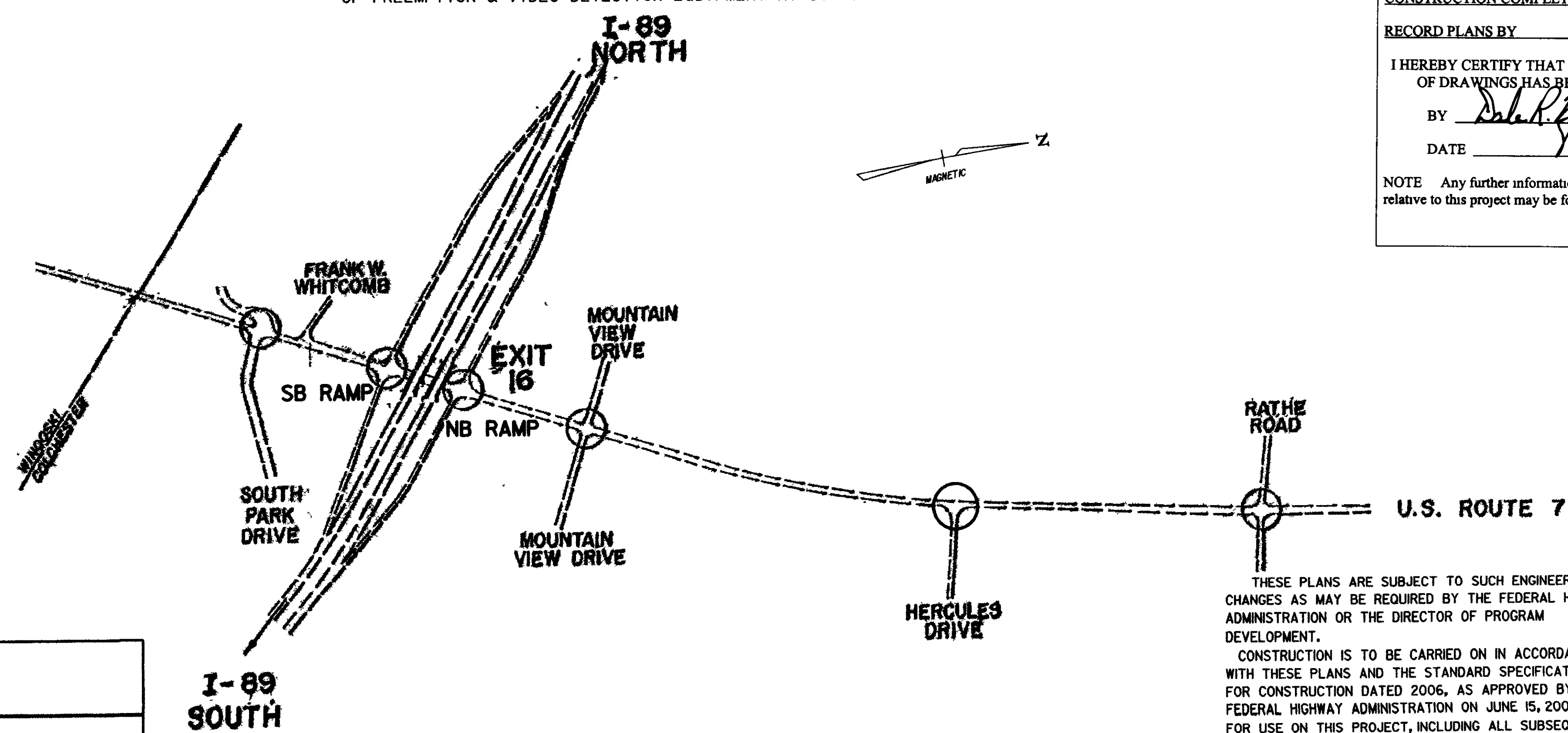

N.T.S.

BUILT AS DESIGNED

THESE PLANS ARE SUBJECT TO SUCH ENGINEERING CHANGES AS MAY BE REQUIRED BY THE FEDERAL HIGHWAY ADMINISTRATION OR THE DIRECTOR OF PROGRAM DEVELOPMENT.
 CONSTRUCTION IS TO BE CARRIED ON IN ACCORDANCE WITH THESE PLANS AND THE STANDARD SPECIFICATIONS FOR CONSTRUCTION DATED 2006, AS APPROVED BY THE FEDERAL HIGHWAY ADMINISTRATION ON JUNE 15, 2006 FOR USE ON THIS PROJECT, INCLUDING ALL SUBSEQUENT REVISIONS AND SUCH REVISED SPECIFICATIONS AND SPECIAL PROVISIONS AS ARE INCORPORATED IN THESE PLANS.

DIRECTOR OF PROGRAM DEVELOPMENT	
APPROVED <i>[Signature]</i>	DATE 5-27-09
PROJECT MANAGER : B. NYQUIST	
PROJECT NAME : COLCHESTER	
PROJECT NUMBER : STPG SGNL (34)	
SHEET 1 OF 8 SHEETS	

QUANTITY SHEET 1

SUMMARY OF ESTIMATED QUANTITIES

TOTALS

DESCRIPTIONS

DETAILED SUMMARY OF QUANTITIES

SUMMARY OF ESTIMATED QUANTITIES										TOTALS		DESCRIPTIONS				DETAILED SUMMARY OF QUANTITIES		
									ROADWAY	GRAND TOTAL	FINAL	UNIT	ITEMS	ITEM NUMBER	ROUND	QUANTITIES	UNIT	ITEMS
									1	1		CY	TRENCH EXCAVATION OF EARTH, EXPLORATORY (N.A.B.I.)	204.22				
									80	80		HR	UNIFORMED TRAFFIC OFFICERS	630.10				
									80	80		HR	FLAGGERS	630.15				
									1	1		LS	MOBILIZATION/DEMOBILIZATION	635.11				
									1	1		LS	TRAFFIC CONTROL	641.10	-			
									1	1		EACH	SPECIAL PROVISION (VEHICLE PREEMPTION/VIDEO VEHICLE DETECTION SYSTEM) (US 7 @ HERCULES DRIVE)	900.620				
									1	1		EACH	SPECIAL PROVISION (VEHICLE PREEMPTION/VIDEO VEHICLE DETECTION SYSTEM) (US 7 @ I-89 NB RAMP)	900.620				
									1	1		EACH	SPECIAL PROVISION (VEHICLE PREEMPTION/VIDEO VEHICLE DETECTION SYSTEM) (US 7 @ I-89 SB RAMP)	900.620				
									1	1		EACH	SPECIAL PROVISION (VEHICLE PREEMPTION/VIDEO VEHICLE DETECTION SYSTEM) (US 7 @ MOUNTAIN VIEW DRIVE)	900.620				
									1	1		EACH	SPECIAL PROVISION (VEHICLE PREEMPTION/VIDEO VEHICLE DETECTION SYSTEM) (US 7 @ RATHE ROAD)	900.620				
									1	1		EACH	SPECIAL PROVISION (VEHICLE PREEMPTION/VIDEO VEHICLE DETECTION SYSTEM) (US 7 @ SOUTH PARK DRIVE)	900.620				

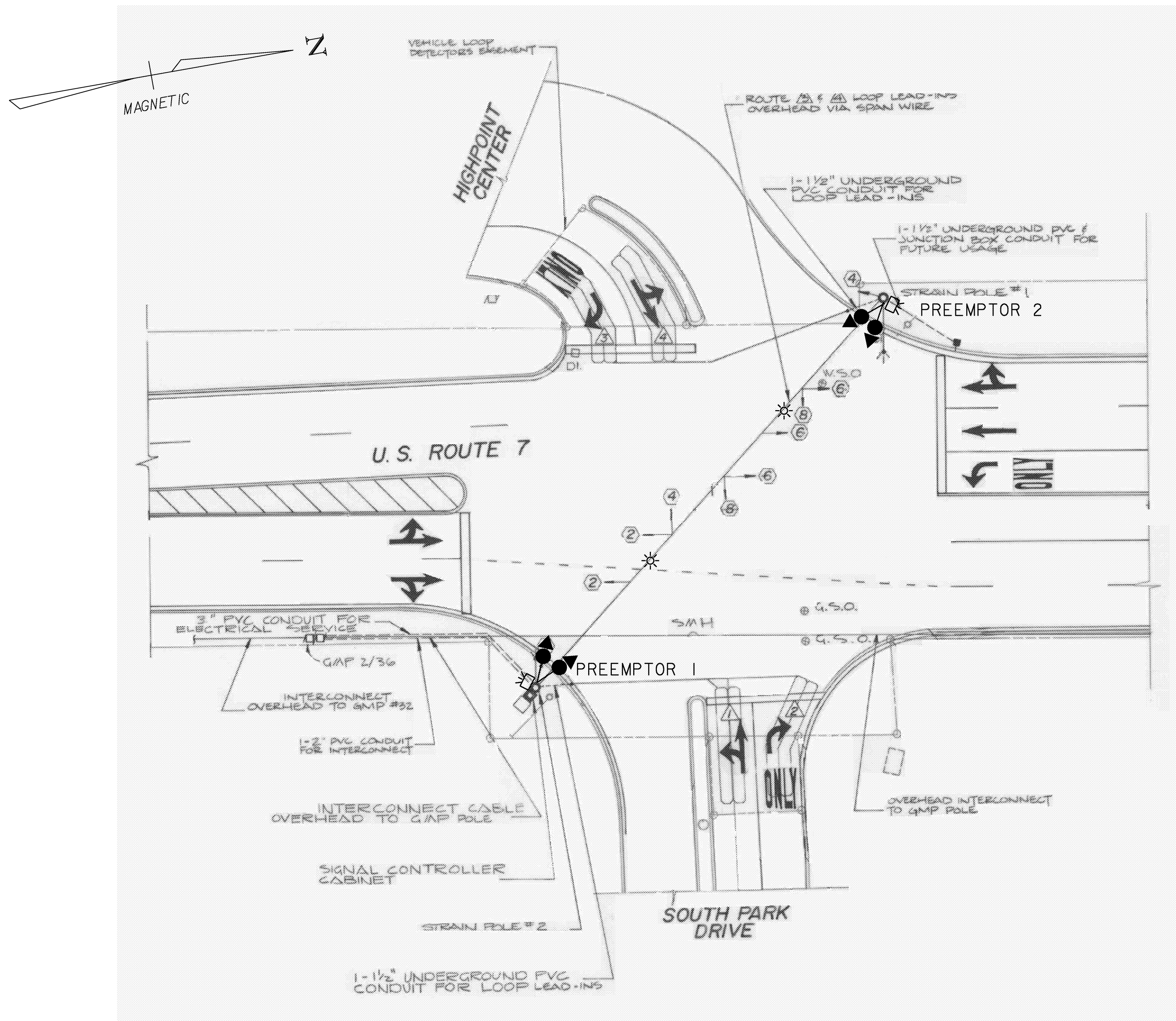

US ROUTE 7

LIST OF MAJOR EQUIPMENT

ITEM # 900.620 SPECIAL PROVISION (VEHICLE PREEMPTION / VIDEO VEHICLE DETECTION SYSTEM) (US 7 @ SOUTH PARK DRIVE)	QUANTITY
OPTICAL PREEMPTION DETECTORS	2 EA
OPTICAL SIGNAL PROCESSOR CARD & CARD CAGE	1 EA
AC STROBE - RED	2 EA
ECONOLITE ASC/3-2100 CONTROLLER	1 EA
VIDEO VEHICLE DETECTION	4 EA

NOTES:

- EXISTING CONTROLLER TIMINGS SHALL BE RETAINED.
- EXISTING CONDUIT SHALL BE UTILIZED FOR NECESSARY WIRING.
- ANY OTHER MISCELLANEOUS EQUIPMENT AND LABOR NECESSARY TO PROVIDE FULLY FUNCTIONAL PREEMPTION & VIDEO DETECTION SYSTEMS SHALL BE INCIDENTAL TO ITEM #900.620 SPECIAL PROVISION (VEHICLE PREEMPTION/VIDEO VEHICLE DETECTION SYSTEM) (US 7 @ SOUTH PARK DRIVE).
- THE EMERGENCY VEHICLE PREEMPTION SYSTEM SHALL BE AN OPTICALLY ACTIVATED SYSTEM. THE SYSTEM WILL INCLUDE ALL NECESSARY INTERFACE BOARDS, WIRING, DETECTORS, AND CONFIRMATION LIGHTS. EMITTERS AND OTHER VEHICLE MOUNTED EQUIPMENT TO BE PURCHASED SEPERATELY BY THE TOWN.
- THE NEW CONTROLLER TO REPLACE EXISTING ECONOLITE BRAND MODEL 8000 CONTROLLER. EXISTING CONTROLLER SHALL BE REMOVED AND RETURNED BY THE CONTRACTOR TO THE DISTRICT 5 GARAGE AT 5 BARNES AVE. IN COLCHESTER WITHIN 48 HOURS OF REMOVAL. CONTACT STEVE GUYETTE AT 655-1580 WITH ANY QUESTIONS.
- VIDEO VEHICLE DETECTORS SHALL BE PLACED SO THAT OCCLUSION IS MINIMIZED AND PHASING IS NOT AFFECTED.
- VIDEO VEHICLE DETECTION AREAS SHALL EXTEND 5 FT PAST THE STOP BAR.
- VEHICLE DETECTOR LOOPS TO BE DISCONNECTED AT THE EXISTING PULLBOX LOCATIONS. EXISTING LOOP SENSOR AMPS TO BE SALVAGED (SEE NOTE #5).
- VIDEO VEHICLE DETECTION SYSTEM SHALL BE ECONOLITE AUTOSCOPE SOLO TERRA OR ITERIS VERSICAM OR TRAFICON VIP SERIES OR APPROVED EQUAL.

PREEMPTION TIMINGS

	PREEMPTOR	
	1	2
DIRECTION	US7 NB	US7 SB
HOLD PHASE	2	6
DET. LOCK	NO	NO
DURATION TIME	10	10
MIN. GREEN	4.0	4.0
HOLD GREEN	12.0	12.0
HOLD YELLOW	4.0	4.0
HOLD RED	2.0	2.0
RELEASE PHASE	2&6	2&6

CONSTRUCTION ACTIVITIES WILL BE SHORT DURATION AND WILL LIKELY RESULT IN MINIMAL IMPACT TO THE TRAVELING PUBLIC. ALL WORK SHALL BE PERFORMED DURING DAYTIME, OFF-PEAK HOURS. REFER TO THE VERMONT AGENCY OF TRANSPORTATION STANDARD DRAWINGS E-110 AND E-111 FOR ADDITIONAL TRAFFIC CONTROL INFORMATION. TRAFFIC CONTROL WARNING SIGNS SHALL BE PROVIDED AS NECESSARY ON EACH APPROACH PER THE MANUAL ON UNIFORM TRAFFIC CONTROL DEVICES (MUTCD). PAYMENT FOR THESE SIGNS, REFLECTORIZED PLASTIC DRUMS, ECT. SHALL BE PAID UNDER CONTRACT ITEM 641.10.

- * - PREEMPTION STROBE
- ☒ - OPTICAL PREEMPTION DETECTOR
- ◐ - VIDEO DETECTION CAMERA

US 7 & SOUTH PARK DRIVE

PROJECT NAME: COLCHESTER	PLOT DATE: 27-MAY-2009
PROJECT NUMBER: STPG S6NL (34)	DRAWN BY: B. MCAVOY
FILE NAME: 09d010/Traffic/td010n1.dg	CHECKED BY: B. NYQUIST
PROJECT LEADER: B. NYQUIST	SHEET 3 OF 8
DESIGNED BY: B. MCAVOY	
TRAFFIC SIGNAL SHEET 1	

N.T.S.

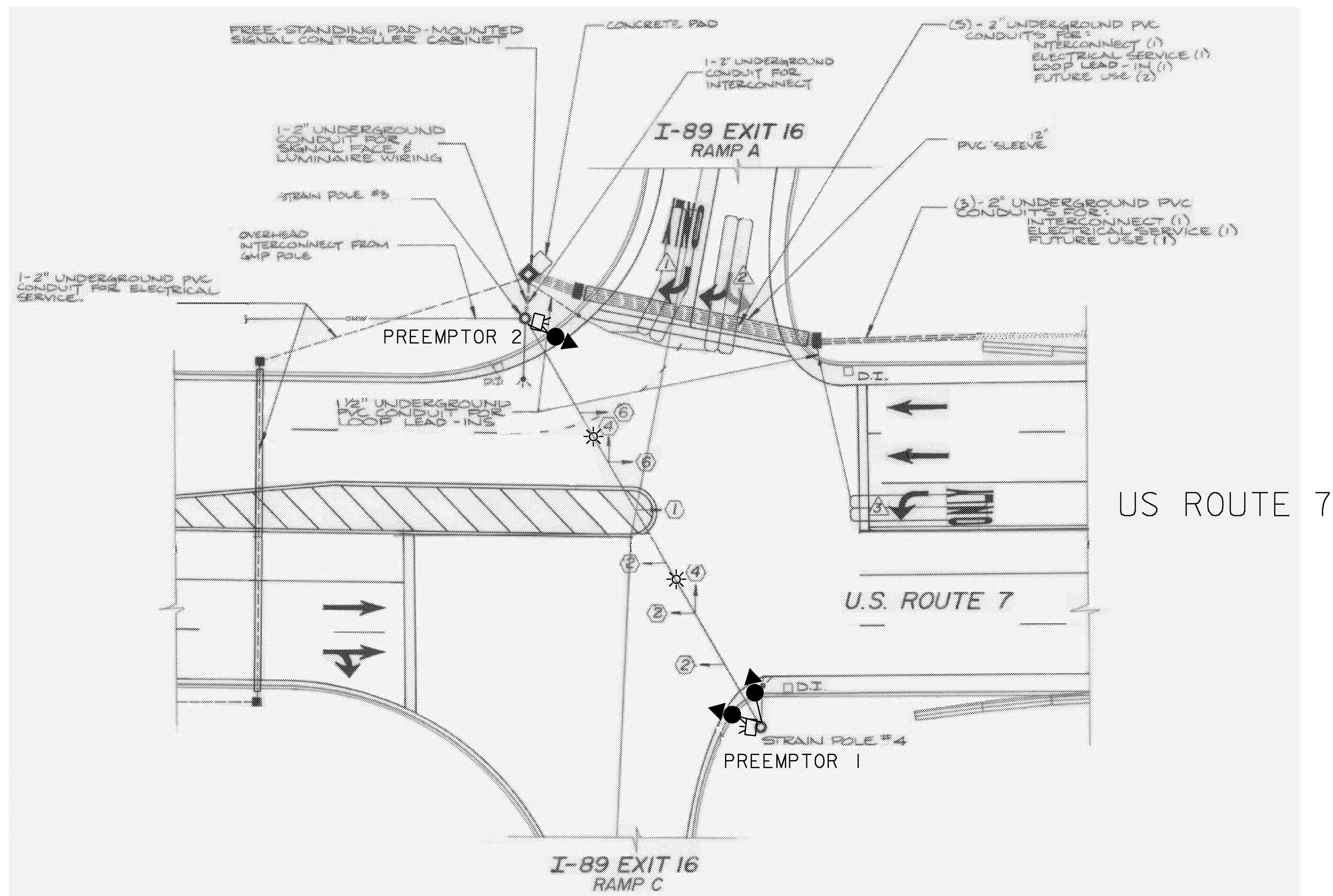
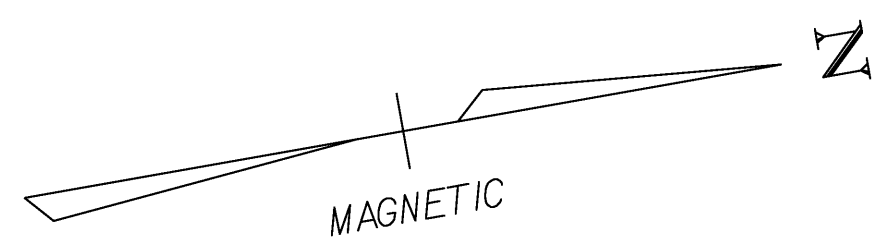

LIST OF MAJOR EQUIPMENT	
ITEM # 900.620 SPECIAL PROVISION (VEHICLE PREEMPTION / VIDEO VEHICLE DETECTION SYSTEM) (US 7 @ I-89 SB RAMP)	QUANTITY
OPTICAL PREEMPTION DETECTORS	2 EA
OPTICAL SIGNAL PROCESSOR CARD & CARD CAGE	1 EA
AC STROBE - RED	2 EA
ECONOLITE ASC/3-2100 CONTROLLER	1 EA
VIDEO VEHICLE DETECTION	3 EA

- NOTES:
- EXISTING CONTROLLER TIMINGS SHALL BE RETAINED.
 - EXISTING CONDUIT SHALL BE UTILIZED FOR NECESSARY WIRING.
 - ANY OTHER MISCELLANEOUS EQUIPMENT AND LABOR NECESSARY TO PROVIDE FULLY FUNCTIONAL PREEMPTION & VIDEO DETECTION SYSTEMS SHALL BE INCIDENTAL TO ITEM #900.620 SPECIAL PROVISION (VEHICLE PREEMPTION/VIDEO VEHICLE DETECTION SYSTEM) (US 7 @ I-89 SB RAMP).
 - THE EMERGENCY VEHICLE PREEMPTION SYSTEM SHALL BE AN OPTICALLY ACTIVATED SYSTEM. THE SYSTEM WILL INCLUDE ALL NECESSARY INTERFACE BOARDS, WIRING, DETECTORS, AND CONFIRMATION LIGHTS. EMITTERS AND OTHER VEHICLE MOUNTED EQUIPMENT TO BE PURCHASED SEPERATELY BY THE TOWN.
 - THE NEW CONTROLLER TO REPLACE EXISTING ECONOLITE BRAND MODEL 8000 CONTROLLER. EXISTING CONTROLLER SHALL BE REMOVED AND RETURNED BY THE CONTRACTOR TO THE DISTRICT 5 GARAGE AT 5 BARNES AVE. IN COLCHESTER WITHIN 48 HOURS OF REMOVAL. CONTACT STEVE GUYETTE AT 655-1580 WITH ANY QUESTIONS.
 - VIDEO VEHICLE DETECTORS SHALL BE PLACED SO THAT OCCLUSION IS MINIMIZED AND PHASING IS NOT AFFECTED.
 - VIDEO VEHICLE DETECTION AREAS SHALL EXTEND 5 FT PAST THE STOP BAR.
 - VEHICLE DETECTOR LOOPS TO BE DISCONNECTED AT THE EXISTING PULLBOX LOCATIONS. EXISTING LOOP SENSOR AMPS TO BE SALVAGED (SEE NOTE #5).
 - VIDEO VEHICLE DETECTION SYSTEM SHALL BE ECONOLITE AUTOSCOPE SOLO TERRA OR ITERIS VERSICAM OR TRAFICON VIP SERIES OR APPROVED EQUAL.

	PREEMPTION TIMINGS	
	PREEMPTOR	
	1	2
DIRECTION	US7 NB	US7 SB
HOLD PHASE	2	6
DET. LOCK	NO	NO
DURATION TIME	10	10
MIN. GREEN	4.0	4.0
HOLD GREEN	12.0	12.0
HOLD YELLOW	4.0	4.0
HOLD RED	2.0	2.0
RELEASE PHASE	2&6	2&6

CONSTRUCTION ACTIVITIES WILL BE SHORT DURATION AND WILL LIKELY RESULT IN MINIMAL IMPACT TO THE TRAVELING PUBLIC. ALL WORK SHALL BE PERFORMED DURING DAYTIME, OFF-PEAK HOURS. REFER TO THE VERMONT AGENCY OF TRANSPORTATION STANDARD DRAWINGS E-110 AND E-111 FOR ADDITIONAL TRAFFIC CONTROL INFORMATION. TRAFFIC CONTROL WARNING SIGNS SHALL BE PROVIDED AS NECESSARY ON EACH APPROACH PER THE MANUAL ON UNIFORM TRAFFIC CONTROL DEVICES (MUTCD). PAYMENT FOR THESE SIGNS, REFLECTORIZED PLASTIC DRUMS, ECT. SHALL BE PAID UNDER CONTRACT ITEM 641.10.

- * - PREEMPTION STROBE
- ☒ - OPTICAL PREEMPTION DETECTOR
- ◀ - VIDEO DETECTION CAMERA

N.T.S.

US 7 & I-89 EXIT 16 SB RAMP

PROJECT NAME: COLCHESTER	PLOT DATE: 27-MAY-2009
PROJECT NUMBER: STPG S6NL (34)	DRAWN BY: B. MCAVOY
FILE NAME: 09d010/Traffic/td010n01.dg	CHECKED BY: B. NYQUIST
PROJECT LEADER: B. NYQUIST	SHEET 4 OF 8
DESIGNED BY: B. MCAVOY	
TRAFFIC SIGNAL SHEET 2	

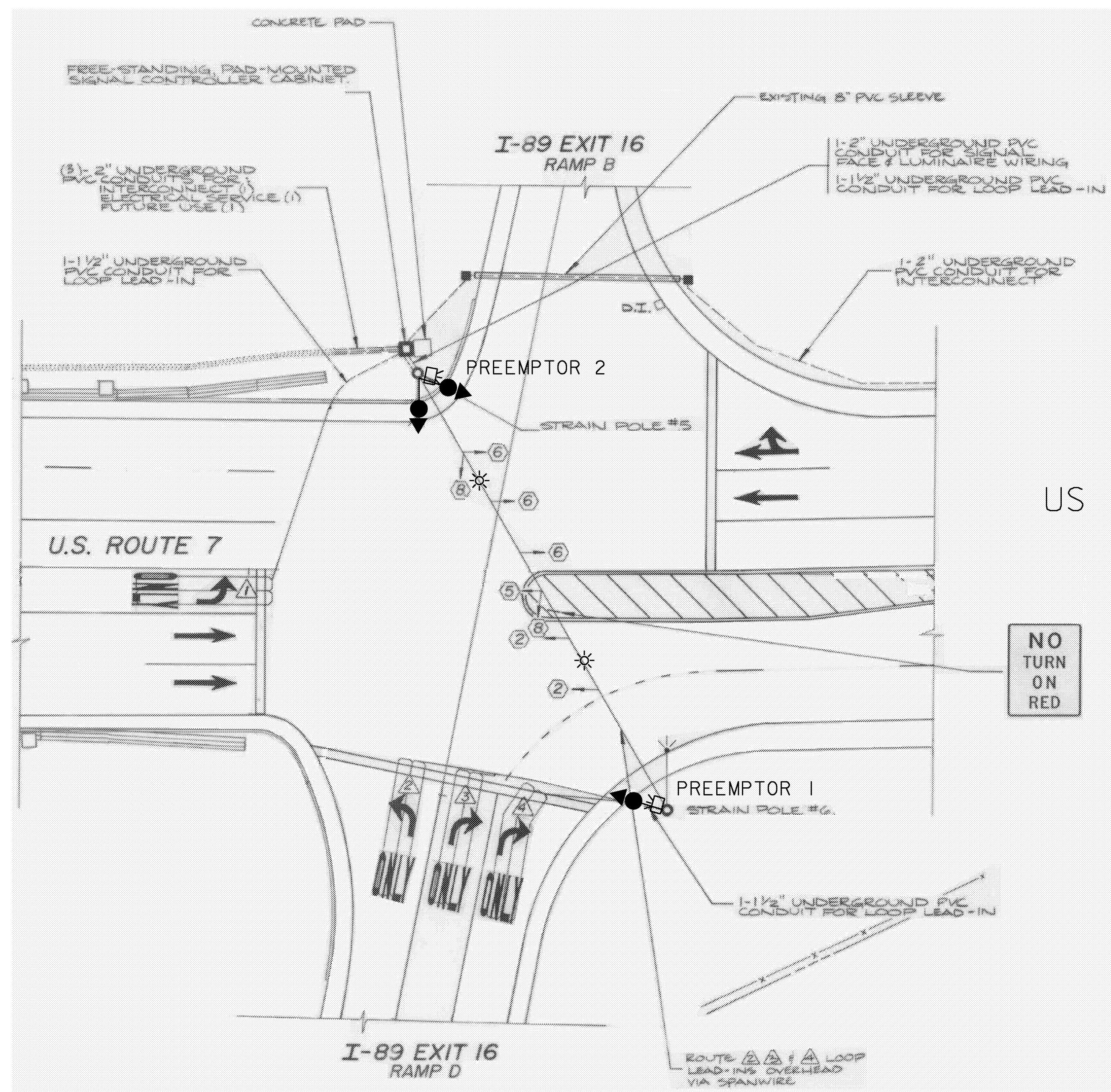
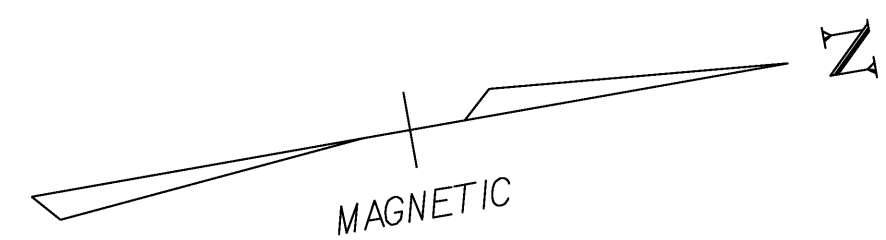

LIST OF MAJOR EQUIPMENT	
ITEM # 900.620 SPECIAL PROVISION (VEHICLE PREEMPTION / VIDEO VEHICLE DETECTION SYSTEM) (US 7 @ I-89 NB RAMP)	QUANTITY
OPTICAL PREEMPTION DETECTORS	2 EA
OPTICAL SIGNAL PROCESSOR CARD & CARD CAGE	1 EA
AC STROBE - RED	2 EA
ECONOLITE ASC/3-2100 CONTROLLER	1 EA
VIDEO VEHICLE DETECTION	3 EA

NOTES:

- EXISTING CONTROLLER TIMINGS SHALL BE RETAINED.
- EXISTING CONDUIT SHALL BE UTILIZED FOR NECESSARY WIRING.
- ANY OTHER MISCELLANEOUS EQUIPMENT AND LABOR NECESSARY TO PROVIDE FULLY FUNCTIONAL PREEMPTION & VIDEO DETECTION SYSTEMS SHALL BE INCIDENTAL TO ITEM #900.620 SPECIAL PROVISION (VEHICLE PREEMPTION/VIDEO VEHICLE DETECTION SYSTEM) (US 7 @ I-89 NB RAMP).
- THE EMERGENCY VEHICLE PREEMPTION SYSTEM SHALL BE AN OPTICALLY ACTIVATED SYSTEM. THE SYSTEM WILL INCLUDE ALL NECESSARY INTERFACE BOARDS, WIRING, DETECTORS, AND CONFIRMATION LIGHTS. EMITTERS AND OTHER VEHICLE MOUNTED EQUIPMENT TO BE PURCHASED SEPERATELY BY THE TOWN.
- THE NEW CONTROLLER TO REPLACE EXISTING ECONOLITE BRAND MODEL 8000 CONTROLLER. EXISTING CONTROLLER SHALL BE REMOVED AND RETURNED BY THE CONTRACTOR TO THE DISTRICT 5 GARAGE AT 5 BARNES AVE. IN COLCHESTER WITHIN 48 HOURS OF REMOVAL. CONTACT STEVE GUYETTE AT 655-1580 WITH ANY QUESTIONS.
- VIDEO VEHICLE DETECTORS SHALL BE PLACED SO THAT OCCLUSION IS MINIMIZED AND PHASING IS NOT AFFECTED.
- VIDEO VEHICLE DETECTION AREAS SHALL EXTEND 5 FT PAST THE STOP BAR.
- VEHICLE DETECTOR LOOPS TO BE DISCONNECTED AT THE EXISTING PULLBOX LOCATIONS. EXISTING LOOP SENSOR AMPS TO BE SALVAGED (SEE NOTE #5).
- VIDEO VEHICLE DETECTION SYSTEM SHALL BE ECONOLITE AUTOSCOPE SOLO TERRA OR ITERIS VERSICAM OR TRAFICON VIP SERIES OR APPROVED EQUAL.

	PREEMPTION TIMINGS	
	PREEMPTOR	
	1	2
DIRECTION	US7 NB	US7 SB
HOLD PHASE	2	6
DET. LOCK	NO	NO
DURATION TIME	10	10
MIN. GREEN	4.0	4.0
HOLD GREEN	12.0	12.0
HOLD YELLOW	4.0	4.0
HOLD RED	2.0	2.0
RELEASE PHASE	2&6	2&6

CONSTRUCTION ACTIVITIES WILL BE SHORT DURATION AND WILL LIKELY RESULT IN MINIMAL IMPACT TO THE TRAVELING PUBLIC. ALL WORK SHALL BE PERFORMED DURING DAYTIME, OFF-PEAK HOURS. REFER TO THE VERMONT AGENCY OF TRANSPORTATION STANDARD DRAWINGS E-110 AND E-111 FOR ADDITIONAL TRAFFIC CONTROL INFORMATION. TRAFFIC CONTROL WARNING SIGNS SHALL BE PROVIDED AS NECESSARY ON EACH APPROACH PER THE MANUAL ON UNIFORM TRAFFIC CONTROL DEVICES (MUTCD). PAYMENT FOR THESE SIGNS, REFLECTORIZED PLASTIC DRUMS, ECT. SHALL BE PAID UNDER CONTRACT ITEM 641.10.

- * - PREEMPTION STROBE
- ☐ - OPTICAL PREEMPTION DETECTOR
- - VIDEO DETECTION CAMERA

US 7 & I-89 EXIT 16 NB RAMP

PROJECT NAME: COLCHESTER	PLOT DATE: 27-MAY-2009
PROJECT NUMBER: STPG S6NL (34)	DRAWN BY: B. MCAVOY
FILE NAME: 09d010/Traffic/td010n01.dg	CHECKED BY: B. NYQUIST
PROJECT LEADER: B. NYQUIST	SHEET 5 OF 8
DESIGNED BY: B. MCAVOY	
TRAFFIC SIGNAL SHEET 3	

N.T.S.

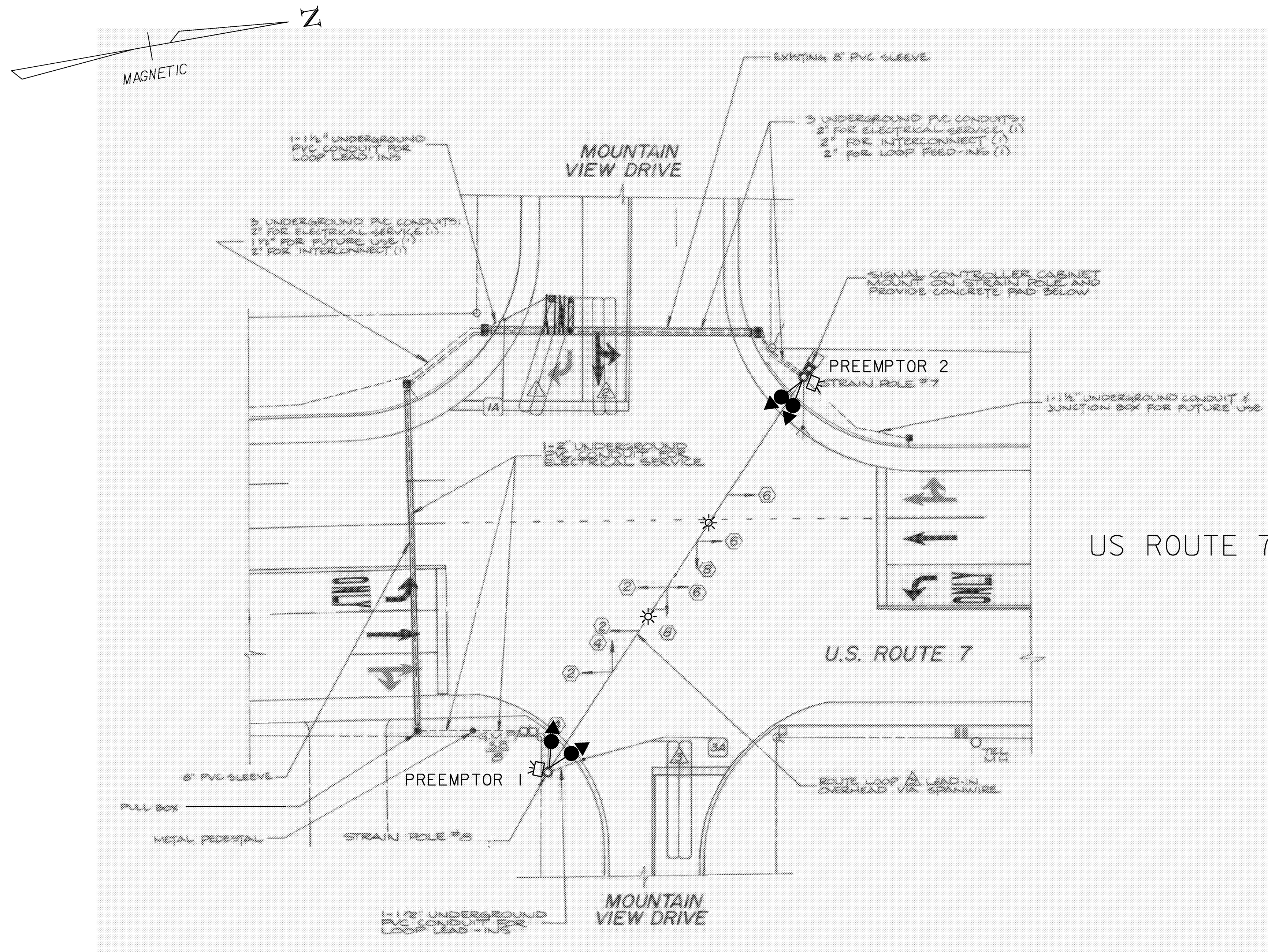

LIST OF MAJOR EQUIPMENT	
ITEM # 900.620 SPECIAL PROVISION (VEHICLE PREEMPTION / VIDEO VEHICLE DETECTION SYSTEM) (US 7 @ MOUNTAIN VIEW DR.)	QUANTITY
OPTICAL PREEMPTION DETECTORS	2 EA
OPTICAL SIGNAL PROCESSOR CARD & CARD CAGE	1 EA
AC STROBE - RED	2 EA
ECONOLITE ASC/3-2100 CONTROLLER	1 EA
VIDEO VEHICLE DETECTION	4 EA

- NOTES:
- EXISTING CONTROLLER TIMINGS SHALL BE RETAINED.
 - EXISTING CONDUIT SHALL BE UTILIZED FOR NECESSARY WIRING.
 - ANY OTHER MISCELLANEOUS EQUIPMENT AND LABOR NECESSARY TO PROVIDE FULLY FUNCTIONAL PREEMPTION & VIDEO DETECTION SYSTEMS SHALL BE INCIDENTAL TO ITEM #900.620 SPECIAL PROVISION (VEHICLE PREEMPTION/VIDEO VEHICLE DETECTION SYSTEM) (US 7 @ MOUNTAIN VIEW DRIVE).
 - THE EMERGENCY VEHICLE PREEMPTION SYSTEM SHALL BE AN OPTICALLY ACTIVATED SYSTEM. THE SYSTEM WILL INCLUDE ALL NECESSARY INTERFACE BOARDS, WIRING, DETECTORS, AND CONFIRMATION LIGHTS. EMITTERS AND OTHER VEHICLE MOUNTED EQUIPMENT TO BE PURCHASED SEPARATELY BY THE TOWN.
 - THE NEW CONTROLLER TO REPLACE EXISTING ECONOLITE BRAND MODEL 8000 CONTROLLER. EXISTING CONTROLLER SHALL BE REMOVED AND RETURNED BY THE CONTRACTOR TO THE DISTRICT 5 GARAGE AT 5 BARNES AVE. IN COLCHESTER WITHIN 48 HOURS OF REMOVAL. CONTACT STEVE GUYETTE AT 655-1580 WITH ANY QUESTIONS.
 - VIDEO VEHICLE DETECTORS SHALL BE PLACED SO THAT OCCLUSION IS MINIMIZED AND PHASING IS NOT AFFECTED.
 - VIDEO VEHICLE DETECTION AREAS SHALL EXTEND 5 FT PAST THE STOP BAR.
 - VEHICLE DETECTOR LOOPS TO BE DISCONNECTED AT THE EXISTING PULLBOX LOCATIONS. EXISTING LOOP SENSOR AMPS TO BE SALVAGED (SEE NOTE #5).
 - VIDEO VEHICLE DETECTION SYSTEM SHALL BE ECONOLITE AUTOSCOPE SOLO TERRA OR ITERIS VERSICAM OR TRAFICON VIP SERIES OR APPROVED EQUAL.

	PREEMPTION TIMINGS	
	PREEMPTOR	
DIRECTION	1	2
	US7 NB	US7 SB
HOLD PHASE	2	6
DET. LOCK	NO	NO
DURATION TIME	10	10
MIN. GREEN	4.0	4.0
HOLD GREEN	12.0	12.0
HOLD YELLOW	4.0	4.0
HOLD RED	2.0	2.0
RELEASE PHASE	2&6	2&6

CONSTRUCTION ACTIVITIES WILL BE SHORT DURATION AND WILL LIKELY RESULT IN MINIMAL IMPACT TO THE TRAVELING PUBLIC. ALL WORK SHALL BE PERFORMED DURING DAYTIME, OFF-PEAK HOURS. REFER TO THE VERMONT AGENCY OF TRANSPORTATION STANDARD DRAWINGS E-110 AND E-111 FOR ADDITIONAL TRAFFIC CONTROL INFORMATION. TRAFFIC CONTROL WARNING SIGNS SHALL BE PROVIDED AS NECESSARY ON EACH APPROACH PER THE MANUAL ON UNIFORM TRAFFIC CONTROL DEVICES (MUTCD). PAYMENT FOR THESE SIGNS, REFLECTORIZED PLASTIC DRUMS, ECT. SHALL BE PAID UNDER CONTRACT ITEM 641.10.

- * - PREEMPTION STROBE
- ☐ - OPTICAL PREEMPTION DETECTOR
- ◀ - VIDEO DETECTION CAMERA

US 7 & MOUNTAIN VIEW DRIVE

PROJECT NAME: COLCHESTER	PLOT DATE: 27-MAY-2009
PROJECT NUMBER: STPG S6NL (34)	DRAWN BY: B. MCAVOY
FILE NAME: 09d010/Traffic/td010n01.dg	DESIGNED BY: B. MCAVOY
TRAFFIC SIGNAL SHEET 4	CHECKED BY: B. NYQUIST
	SHEET 6 OF 8

N.T.S.

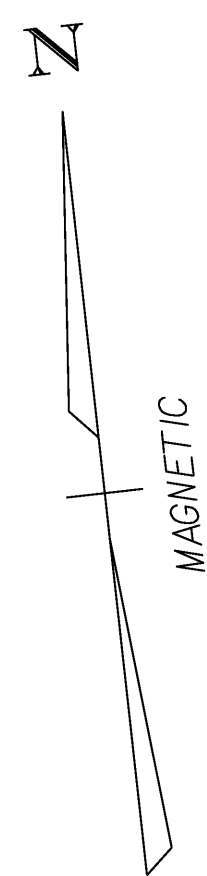
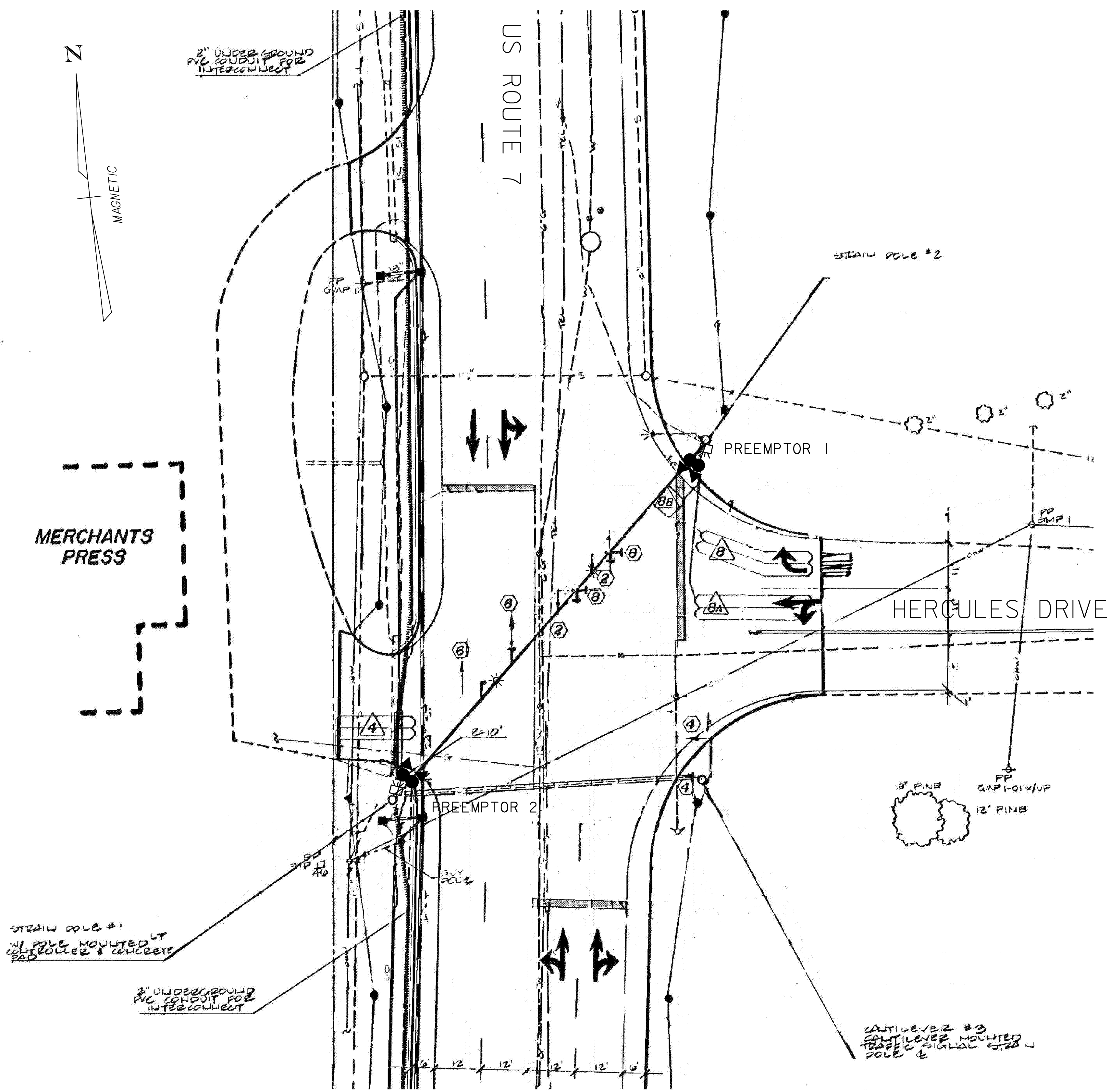

LIST OF MAJOR EQUIPMENT

ITEM # 900.620 SPECIAL PROVISION (VEHICLE PREEMPTION / VIDEO VEHICLE DETECTION SYSTEM) (US 7 @ HERCULES DRIVE)	QUANTITY
OPTICAL PREEMPTION DETECTORS	2 EA
OPTICAL SIGNAL PROCESSOR CARD & CARD CAGE	1 EA
AC STROBE - RED	2 EA
ECONOLITE ASC/3-2100 CONTROLLER	1 EA
VIDEO VEHICLE DETECTION	4 EA

- NOTES:
- EXISTING CONTROLLER TIMINGS SHALL BE RETAINED.
 - EXISTING CONDUIT SHALL BE UTILIZED FOR NECESSARY WIRING.
 - ANY OTHER MISCELLANEOUS EQUIPMENT AND LABOR NECESSARY TO PROVIDE FULLY FUNCTIONAL PREEMPTION & VIDEO DETECTION SYSTEMS SHALL BE INCIDENTAL TO ITEM #900.620 SPECIAL PROVISION (VEHICLE PREEMPTION/VIDEO VEHICLE DETECTION SYSTEM) (US 7 @ HERCULES DRIVE).
 - THE EMERGENCY VEHICLE PREEMPTION SYSTEM SHALL BE AN OPTICALLY ACTIVATED SYSTEM. THE SYSTEM WILL INCLUDE ALL NECESSARY INTERFACE BOARDS, WIRING, DETECTORS, AND CONFIRMATION LIGHTS. EMITTERS AND OTHER VEHICLE MOUNTED EQUIPMENT TO BE PURCHASED SEPERATELY BY THE TOWN.
 - THE NEW CONTROLLER TO REPLACE EXISTING ECONOLITE BRAND MODEL 8000 CONTROLLER. EXISTING CONTROLLER SHALL BE REMOVED AND RETURNED BY THE CONTRACTOR TO THE DISTRICT 5 GARAGE AT 5 BARNES AVE. IN COLCHESTER WITHIN 48 HOURS OF REMOVAL. CONTACT STEVE GUYETTE AT 655-1580 WITH ANY QUESTIONS.
 - VIDEO VEHICLE DETECTORS SHALL BE PLACED SO THAT OCCLUSION IS MINIMIZED AND PHASING IS NOT AFFECTED.
 - VIDEO VEHICLE DETECTION AREAS SHALL EXTEND 5 FT PAST THE STOP BAR.
 - VEHICLE DETECTOR LOOPS TO BE DISCONNECTED AT THE EXISTING PULLBOX LOCATIONS. EXISTING LOOP SENSOR AMPS TO BE SALVAGED (SEE NOTE #5).
 - VIDEO VEHICLE DETECTION SYSTEM SHALL BE ECONOLITE AUTOSCOPE SOLO TERRA OR ITERIS VERSICAM OR TRAFICON VIP SERIES OR APPROVED EQUAL.

	PREEMPTION TIMINGS	
	PREEMPTOR	
	1	2
DIRECTION	US7 NB	US7 SB
HOLD PHASE	2	6
DET. LOCK	NO	NO
DURATION TIME	10	10
MIN. GREEN	4.0	4.0
HOLD GREEN	12.0	12.0
HOLD YELLOW	4.0	4.0
HOLD RED	2.0	2.0
RELEASE PHASE	2&6	2&6

CONSTRUCTION ACTIVITIES WILL BE SHORT DURATION AND WILL LIKELY RESULT IN MINIMAL IMPACT TO THE TRAVELING PUBLIC. ALL WORK SHALL BE PERFORMED DURING DAYTIME, OFF-PEAK HOURS. REFER TO THE VERMONT AGENCY OF TRANSPORTATION STANDARD DRAWINGS E-110 AND E-111 FOR ADDITIONAL TRAFFIC CONTROL INFORMATION. TRAFFIC CONTROL WARNING SIGNS SHALL BE PROVIDED AS NECESSARY ON EACH APPROACH PER THE MANUAL ON UNIFORM TRAFFIC CONTROL DEVICES (MUTCD). PAYMENT FOR THESE SIGNS, REFLECTORIZED PLASTIC DRUMS, ECT. SHALL BE PAID UNDER CONTRACT ITEM 641.10.

- * - PREEMPTION STROBE
- ◻ - OPTICAL PREEMPTION DETECTOR
- - VIDEO DETECTION CAMERA

N.T.S.

US 7 & HERCULES DRIVE

PROJECT NAME: COLCHESTER	PLOT DATE: 27-MAY-2009
PROJECT NUMBER: STPG SGNL (34)	DRAWN BY: B. MCAVOY
FILE NAME: 09d010/Traffic/td010n01.dg	CHECKED BY: B. NYQUIST
PROJECT LEADER: B. NYQUIST	SHEET 7 OF 8
DESIGNED BY: B. MCAVOY	
TRAFFIC SIGNAL SHEET 5	

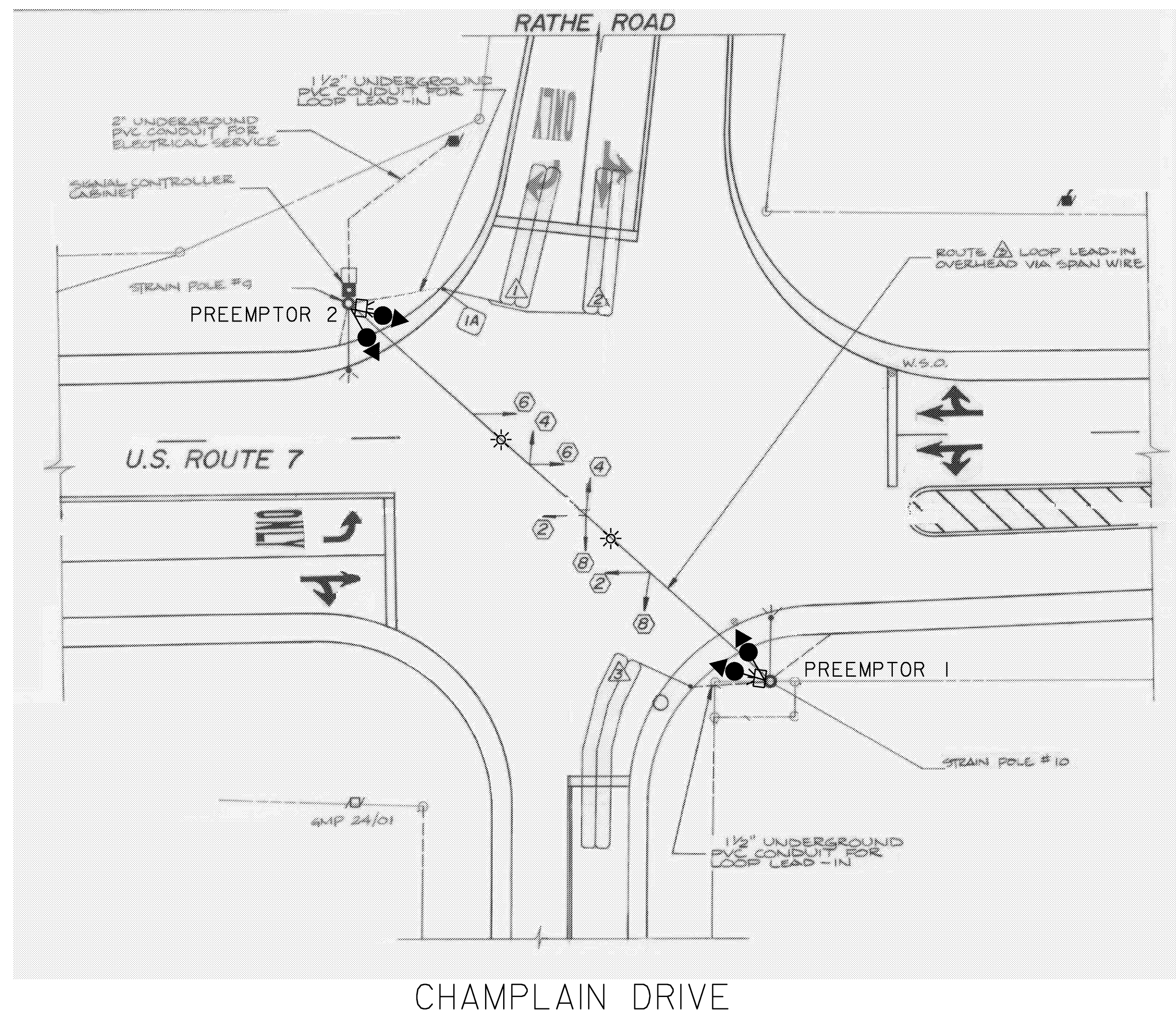
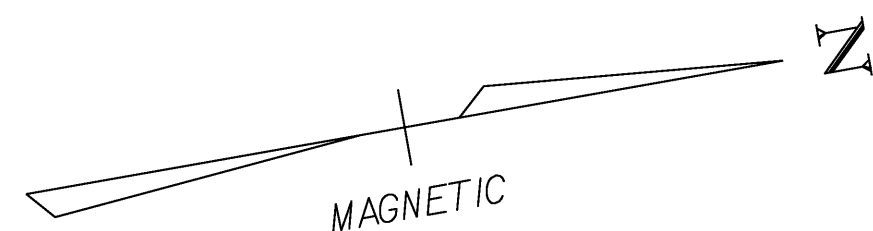

US ROUTE 7

LIST OF MAJOR EQUIPMENT	
ITEM # 900.620 SPECIAL PROVISION (VEHICLE PREEMPTION / VIDEO VEHICLE DETECTION SYSTEM) (US 7 @ RATHE ROAD)	QUANTITY
OPTICAL PREEMPTION DETECTORS	2 EA
OPTICAL SIGNAL PROCESSOR CARD & CARD CAGE	1 EA
AC STROBE - RED	2 EA
ECONOLITE ASC/3-2100 CONTROLLER	1 EA
VIDEO VEHICLE DETECTION	4 EA

NOTES:

- 1) EXISTING CONTROLLER TIMINGS SHALL BE RETAINED.
- 2) EXISTING CONDUIT SHALL BE UTILIZED FOR NECESSARY WIRING.
- 3) ANY OTHER MISCELLANEOUS EQUIPMENT AND LABOR NECESSARY TO PROVIDE FULLY FUNCTIONAL PREEMPTION & VIDEO DETECTION SYSTEMS SHALL BE INCIDENTAL TO ITEM #900.620 SPECIAL PROVISION (VEHICLE PREEMPTION/VIDEO VEHICLE DETECTION SYSTEM) (US 7 @ RATHE ROAD).
- 4) THE EMERGENCY VEHICLE PREEMPTION SYSTEM SHALL BE AN OPTICALLY ACTIVATED SYSTEM. THE SYSTEM WILL INCLUDE ALL NECESSARY INTERFACE BOARDS, WIRING, DETECTORS, AND CONFIRMATION LIGHTS. EMITTERS AND OTHER VEHICLE MOUNTED EQUIPMENT TO BE PURCHASED SEPERATELY BY THE TOWN.
- 5) THE NEW CONTROLLER TO REPLACE EXISTING ECONOLITE BRAND MODEL 8000 CONTROLLER. EXISTING CONTROLLER SHALL BE REMOVED AND RETURNED BY THE CONTRACTOR TO THE DISTRICT 5 GARAGE AT 5 BARNES AVE. IN COLCHESTER WITHIN 48 HOURS OF REMOVAL. CONTACT STEVE GUYETTE AT 655-1580 WITH ANY QUESTIONS.
- 6) VIDEO VEHICLE DETECTORS SHALL BE PLACED SO THAT OCCLUSION IS MINIMIZED AND PHASING IS NOT AFFECTED.
- 7) VIDEO VEHICLE DETECTION AREAS SHALL EXTEND 5 FT PAST THE STOP BAR.
- 8) VEHICLE DETECTOR LOOPS TO BE DISCONNECTED AT THE EXISTING PULLBOX LOCATIONS. EXISTING LOOP SENSOR AMPS TO BE SALVAGED (SEE NOTE #5).
- 9) VIDEO VEHICLE DETECTION SYSTEM SHALL BE ECONOLITE AUTOSCOPE SOLO TERRA OR ITERIS VERSICAM OR TRAFICON VIP SERIES OR APPROVED EQUAL.

	PREEMPTION TIMINGS	
	PREEMPTOR	
	1	2
DIRECTION	US7 NB	US7 SB
HOLD PHASE	2	6
DET. LOCK	NO	NO
DURATION TIME	10	10
MIN. GREEN	4.0	4.0
HOLD GREEN	12.0	12.0
HOLD YELLOW	4.0	4.0
HOLD RED	2.0	2.0
RELEASE PHASE	2&6	2&6

CONSTRUCTION ACTIVITIES WILL BE SHORT DURATION AND WILL LIKELY RESULT IN MINIMAL IMPACT TO THE TRAVELING PUBLIC. ALL WORK SHALL BE PERFORMED DURING DAYTIME, OFF-PEAK HOURS. REFER TO THE VERMONT AGENCY OF TRANSPORTATION STANDARD DRAWINGS E-110 AND E-111 FOR ADDITIONAL TRAFFIC CONTROL INFORMATION. TRAFFIC CONTROL WARNING SIGNS SHALL BE PROVIDED AS NECESSARY ON EACH APPROACH PER THE MANUAL ON UNIFORM TRAFFIC CONTROL DEVICES (MUTCD). PAYMENT FOR THESE SIGNS, REFLECTORIZED PLASTIC DRUMS, ECT. SHALL BE PAID UNDER CONTRACT ITEM 641.10.

- * - PREEMPTION STROBE
- ☐ - OPTICAL PREEMPTION DETECTOR
- ◐ - VIDEO DETECTION CAMERA

US 7 & RATHE ROAD

PROJECT NAME: COLCHESTER	PLOT DATE: 27-MAY-2009
PROJECT NUMBER: STPG SGNL (34)	DRAWN BY: B. MCAVOY
FILE NAME: 09d010/Traffic/td010n1.dg	CHECKED BY: B. NYQUIST
PROJECT LEADER: B. NYQUIST	SHEET 8 OF 8
DESIGNED BY: B. MCAVOY	
TRAFFIC SIGNAL SHEET 6	

N.T.S.