

INDEX OF SHEETS

1. TITLE SHEET
2. QUANTITY SHEET
- 3-8. TRAFFIC SIGNAL SHEETS

STANDARDS

E-100	CONSTRUCTION APPROACH SIGNS	01/02/2004
E-100A	SIDE ROAD CONSTRUCTION APPROACH SIGNS	01/02/2004
E-101	CONSTRUCTION SIGN DETAILS	05/30/2003
E-102	CONSTRUCTION SIGN DETAILS	06/30/2003
E-110	MAJOR MAINTENANCE OPERATION LANE CLOSURE	08/08/1995
E-111	MINOR MAINTENANCE OPERATIONS	03/11/1997
E-171A	TRAFFIC CONTROL SIGNALS GENERAL NOTES AND DETAILS	08/09/1995
E-171B	TRAFFIC CONTROL SIGNALS MISC. DETAILS	08/09/1995
E-171C	TRAFFIC CONTROL SIGNALS CANTILEVER MOUNTING DETAILS	08/09/1995

# STATE OF VERMONT AGENCY OF TRANSPORTATION



## PROPOSED IMPROVEMENT TOWN OF COLCHESTER COUNTY OF CHITTENDEN US ROUTE 7 - PRINCIPAL ARTERIAL

TOWN OF COLCHESTER, US 7 AT THE INTERSECTIONS OF SOUTH PARK DRIVE (MM 0.146), I-89 EXIT 16 SB RAMP (MM 0.211), I-89 EXIT 16 NB RAMP (MM 0.225), MOUNTAIN VIEW DRIVE (MM 0.397), HERCULES DRIVE (MM 0.669), AND RATHE ROAD (MM 0.892).

LENGTH OF ROADWAY - US 7 & SOUTH PARK DRIVE	500 FT	.09 MILES
LENGTH OF ROADWAY - US 7 & I-89 EXIT 16 SB RAMP	500 FT	.09 MILES
LENGTH OF ROADWAY - US 7 & I-89 EXIT 16 NB RAMP	500 FT	.09 MILES
LENGTH OF ROADWAY - US 7 & MOUNTAIN VIEW DRIVE	500 FT	.09 MILES
LENGTH OF ROADWAY - US 7 & HERCULES DRIVE	500 FT	.09 MILES
LENGTH OF ROADWAY - US 7 & RATHE ROAD	500 FT	.09 MILES
TOTAL LENGTH OF ROADWAY	3000 FT	.57 MILES

THIS PROJECT SHALL CONSIST OF ALL WORK ASSOCIATED WITH THE INSTALLATION OF PREEMPTION & VIDEO DETECTION EQUIPMENT AT SIX SIGNALIZED INTERSECTIONS.

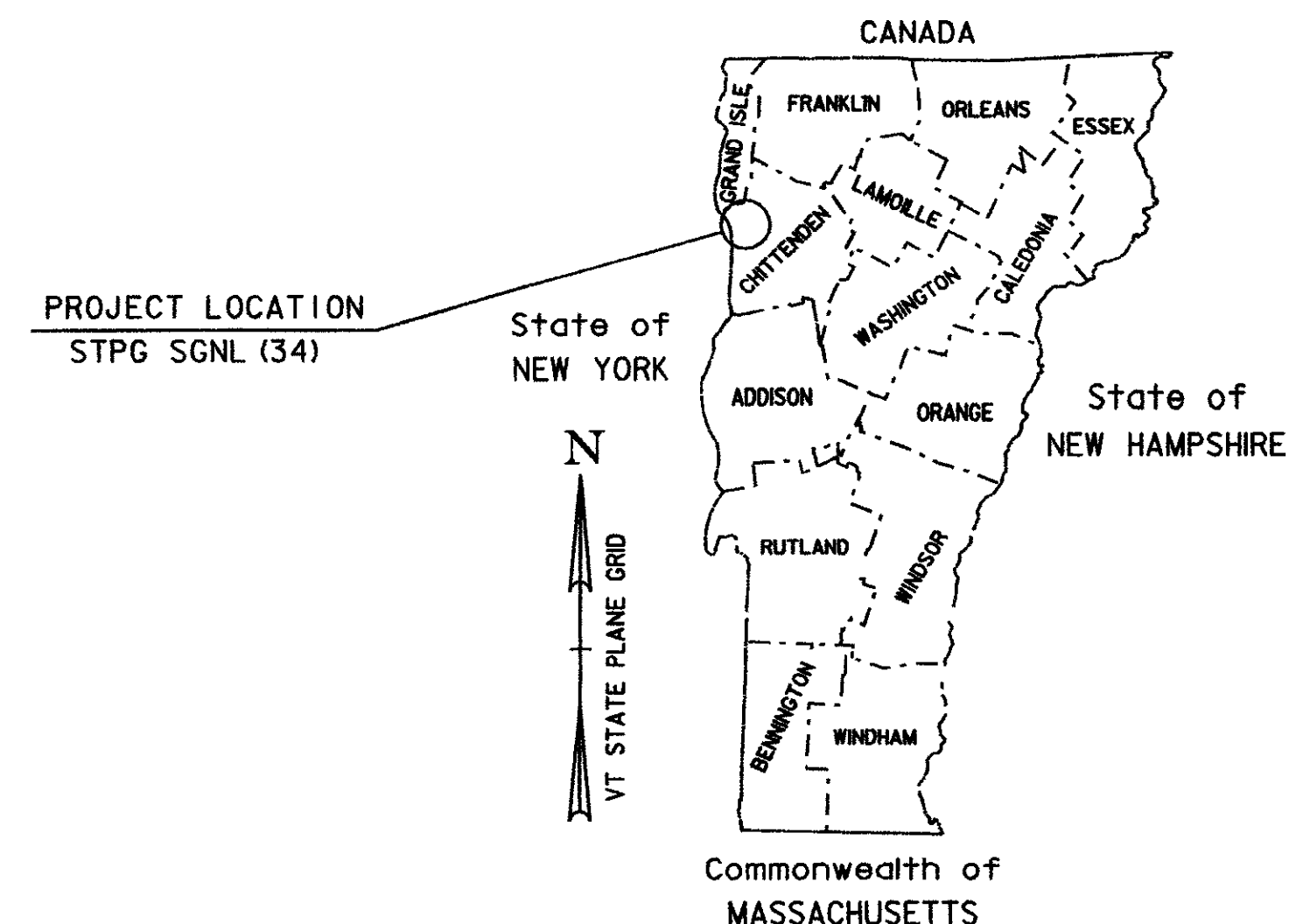

RECORD PLANS	
CONTRACTOR	EAST COAST SIGNALS, INC - DEERFIELD, NH
RESIDENT ENGINEER	DALE NORTON
CONSTRUCTION BEGAN	OCTOBER 8, 2009
CONSTRUCTION COMPLETE	NOVEMBER 16, 2009
RECORD PLANS BY	DALE NORTON
I HEREBY CERTIFY THAT ALL THE CONSTRUCTION REQUIRED BY THIS SET OF DRAWINGS HAS BEEN ACCOMPLISHED AS INDICATED HEREIN	
BY	<i>Dale R. Norton</i> RESIDENT ENGINEER
DATE	28 June 2010
NOTE: Any further information concerning final quantities, amounts or other details relative to this project may be found at Central Files in the electronic archives	

CONVENTIONAL SYMBOLS	
COUNTY LINE	
TOWN LINE	
LIMITS OF ACCESS	
POINT OF ACCESS	
FENCE LINE	
STONE WALL	
TRAVELED WAY	
GUARD RAIL	
RAILROAD	
SURVEY LINE	
CULVERT	
POWER POLE	
TELEPHONE POLE	
TREES	
CONTROL OF ACCESS	
PROPERTY LINE	
R.O.W. TAKING LINE	
SLOPE RIGHTS	
TOP OF CUT	
TOE OF SLOPE	

SURVEYED BY : N/A  
 SURVEYED DATE : N/A  
 DATUM  
 VERTICAL N/A  
 HORIZONTAL N/A

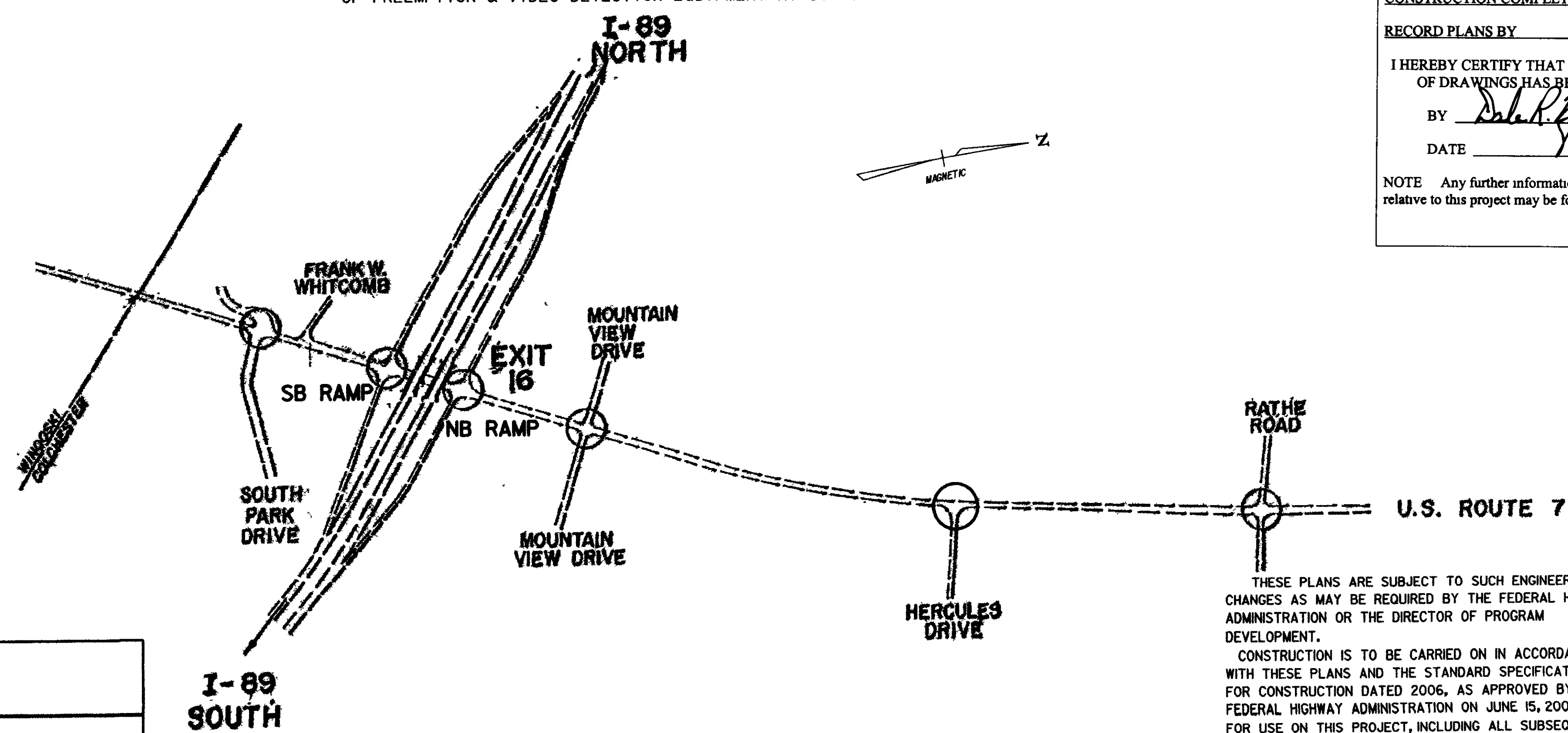

N.T.S.

BUILT AS DESIGNED

THESE PLANS ARE SUBJECT TO SUCH ENGINEERING CHANGES AS MAY BE REQUIRED BY THE FEDERAL HIGHWAY ADMINISTRATION OR THE DIRECTOR OF PROGRAM DEVELOPMENT.  
 CONSTRUCTION IS TO BE CARRIED ON IN ACCORDANCE WITH THESE PLANS AND THE STANDARD SPECIFICATIONS FOR CONSTRUCTION DATED 2006, AS APPROVED BY THE FEDERAL HIGHWAY ADMINISTRATION ON JUNE 15, 2006 FOR USE ON THIS PROJECT, INCLUDING ALL SUBSEQUENT REVISIONS AND SUCH REVISED SPECIFICATIONS AND SPECIAL PROVISIONS AS ARE INCORPORATED IN THESE PLANS.

DIRECTOR OF PROGRAM DEVELOPMENT	
APPROVED <i>[Signature]</i>	DATE 5-27-09
PROJECT MANAGER : B. NYQUIST	
PROJECT NAME : COLCHESTER	
PROJECT NUMBER : STPG SGNL (34)	
SHEET 1 OF 8 SHEETS	