

# STATE OF VERMONT AGENCY OF TRANSPORTATION



## PROPOSED IMPROVEMENT CLASS 1 TOWN HIGHWAY CITY OF MONTPELIER COUNTY OF WASHINGTON U.S. ROUTE 2

BEGINNING IN THE CITY OF MONTPELIER ON U.S. ROUTE 2 AT STA. 0+00.00 (MM 0.000) AND EXTENDING EASTERLY ALONG U.S. ROUTE 2 FOR A DISTANCE OF 8,479.68 FEET (1.606 MILES) TO STA. 84+79.68 (MM 1.606).

|                          |         |         |
|--------------------------|---------|---------|
| PROJECT DATA:            | LENGTH  | LENGTH  |
| CITY OF MONTPELIER       | (FEET)  | (MILES) |
| U.S. ROUTE 2             |         |         |
| STA. 0+00.00 TO 84+79.68 | 8479.68 |         |
| MM 0.000 TO 1.606        |         | 1.606   |
| TOTAL LENGTH OF PROJECT: | 8479.68 | 1.606   |
| TOTAL LENGTH OF ROADWAY: | 8479.68 | 1.606   |

WORK TO BE PERFORMED UNDER THIS PROJECT INCLUDES COLD PLANING AND RESURFACING OF THE EXISTING HIGHWAY WITH A LEVELING COURSE AND WEARING COURSE, NEW PAVEMENT MARKINGS, GUARDRAIL, SIGNS AND OTHER INCIDENTAL ITEMS.

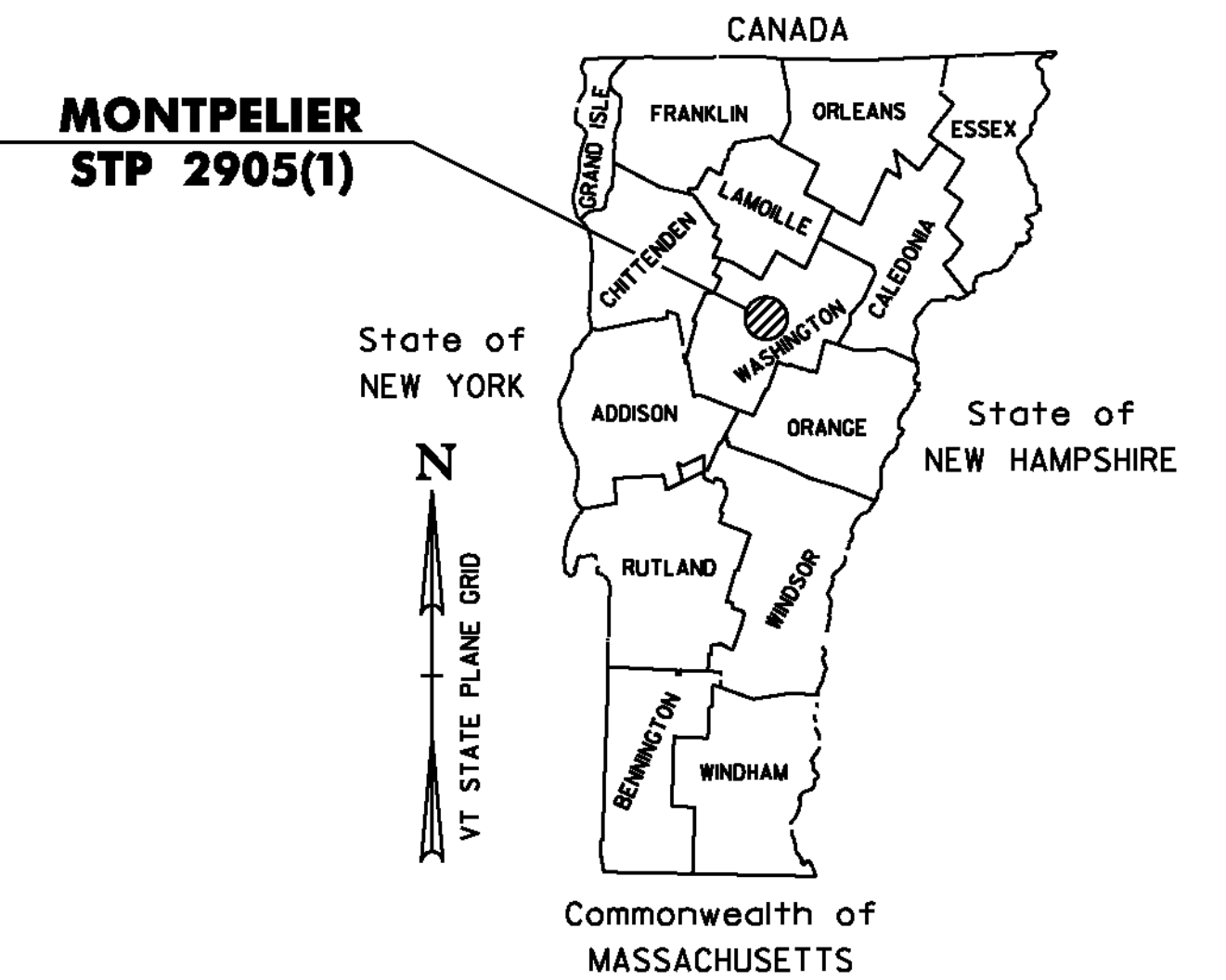

### TRAFFIC DATA U.S. ROUTE 2

| LOCATION                        | AADT |      | DHV  |      | ESALS     |           |
|---------------------------------|------|------|------|------|-----------|-----------|
|                                 | 2011 | 2021 | 2011 | 2021 | 2011-2021 | 2011-2031 |
| <b>U.S. ROUTE 2</b>             |      |      |      |      |           |           |
| BEGIN PROJECT MM 0.000 MM 0.177 | 2300 | 2300 | 300  | 300  | 289,000   | 622,000   |
| MM 0.177 TO MM 1.606            | 4200 | 4300 | 520  | 530  | 361,000   | 841,000   |

| SUPERPAVE BITUMINOUS CONCRETE PAVEMENT MIXTURE DESIGN CRITERIA |  |
|--|--|
| DESIGN LANE/DESIGN LIFE ESALS                                  | 420,500  |
| DESIGN NUMBER OF GYRATIONS                                     | 65   |
| PERFORMANCE GRADE ASPHALT BINDER                               | SEE SECTION 490 OF THE GENERAL SPECIAL PROVISIONS AND THE SPECIAL PROVISIONS |

QUALITY ASSURANCE PROGRAM: LEVEL 3

### CONVENTIONAL SYMBOLS

|                    |  |
|--------------------|--|
| COUNTY LINE        |  |
| TOWN LINE          |  |
| LIMITS OF ACCESS   |  |
| POINT OF ACCESS    |  |
| FENCE LINE         |  |
| STONE WALL         |  |
| TRAVELED WAY       |  |
| GUARDRAIL          |  |
| RAILROAD           |  |
| SURVEY LINE        |  |
| CULVERT            |  |
| UTILITY POLE       |  |
| TREES              |  |
| CONTROL OF ACCESS  |  |
| PROPERTY LINE      |  |
| R.O.W. TAKING LINE |  |
| SLOPE RIGHTS       |  |
| TOP OF CUT         |  |
| TOE OF SLOPE       |  |

SURVEYED BY : N/A  
SURVEYED DATE : N/A

DATUM  
VERTICAL N/A  
HORIZONTAL N/A

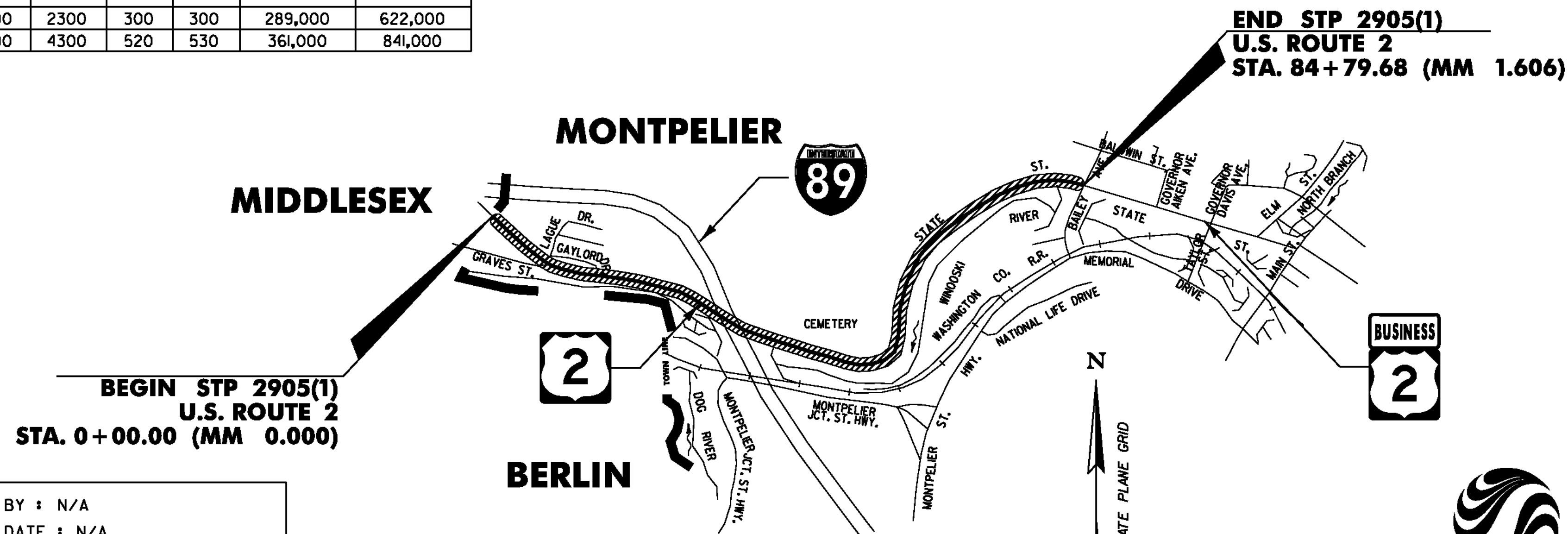

RIGHT-OF-WAY LIMITS, IF APPLICABLE, ARE PROVIDED SOLELY FOR THE CONVENIENCE OF THE STATE AND ITS CONTRACTOR DURING THE COURSE OF THIS PAVING PROJECT. ANY REFERENCES TO OFFSETS ON THESE PLANS ARE APPROXIMATE AND SHOULD NOT BE RELIED UPON FOR ANY PURPOSES.

THESE PLANS ARE SUBJECT TO SUCH ENGINEERING CHANGES AS MAY BE REQUIRED BY THE FEDERAL HIGHWAY ADMINISTRATION OR THE DIRECTOR OF PROGRAM DEVELOPMENT.

CONSTRUCTION IS TO BE CARRIED ON IN ACCORDANCE WITH THESE PLANS AND THE STANDARD SPECIFICATIONS FOR CONSTRUCTION DATED 2006, AS APPROVED BY THE FEDERAL HIGHWAY ADMINISTRATION ON JUNE 15, 2006 FOR USE ON THIS PROJECT, INCLUDING ALL SUBSEQUENT REVISIONS AND SUCH REVISED SPECIFICATIONS AND SPECIAL PROVISIONS AS ARE INCORPORATED IN THESE PLANS.

UNLESS OTHERWISE NOTED, ALL DRAWINGS AND DETAILS ON THESE PLANS ARE DRAWN "NOT TO SCALE".



|                                  |
|----------------------------------|
| PROJECT MANAGER : MICHAEL FOWLER |
| PROJECT NAME : MONTPELIER        |
| PROJECT NUMBER : STP 2905 (1)    |
| SHEET 8 OF 79 SHEETS             |