

PLAN VIEW
SCALE 3/4" = 1'-0"

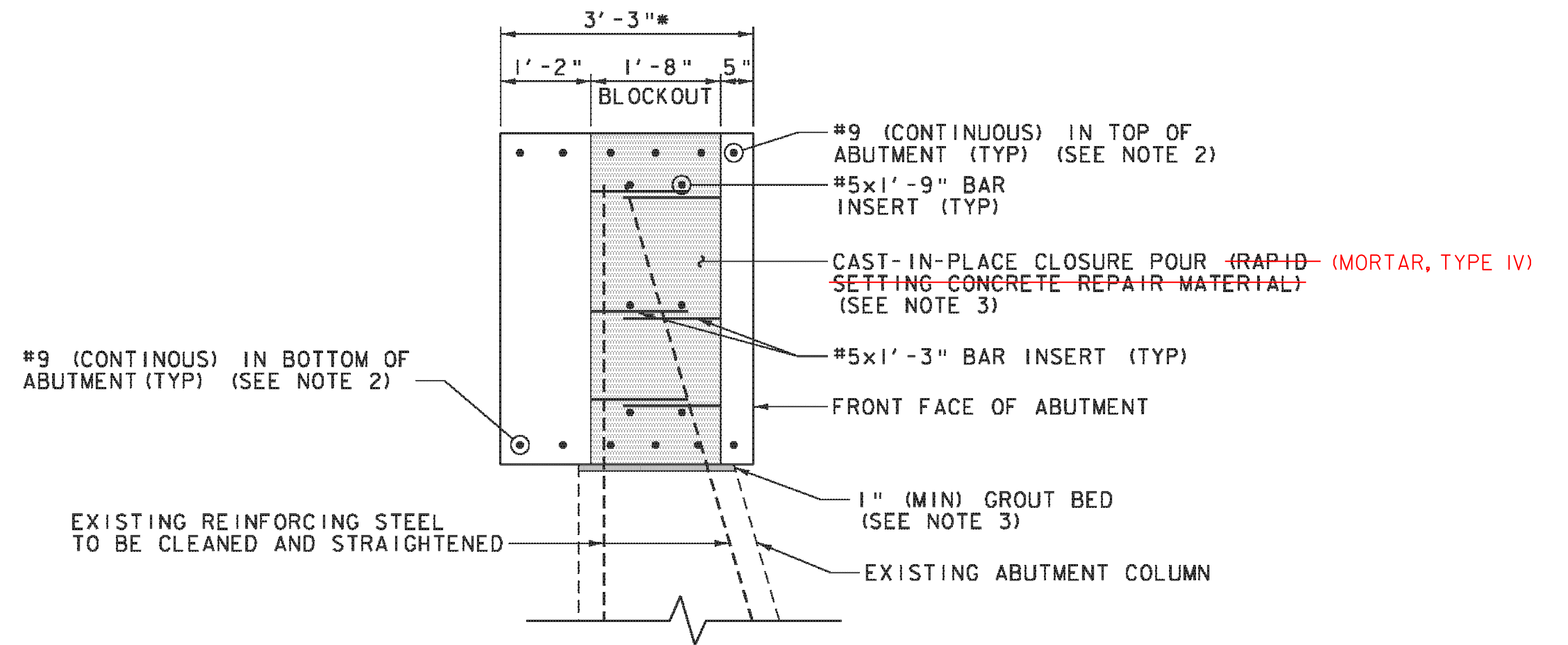

* = PRECAST ABUTMENT CAP IS 3" WIDER THAN CAST-IN-PLACE CAP TO ALLOW FOR ADDITIONAL CAP THICKNESS IN FRONT OF THE BLOCKOUT.

SECTION A-A
SCALE 3/4" = 1'-0"

 BLOCKOUT FOR GROUTED REINFORCING STEEL CONNECTION TO EXISTING ABUTMENT COLUMNS.

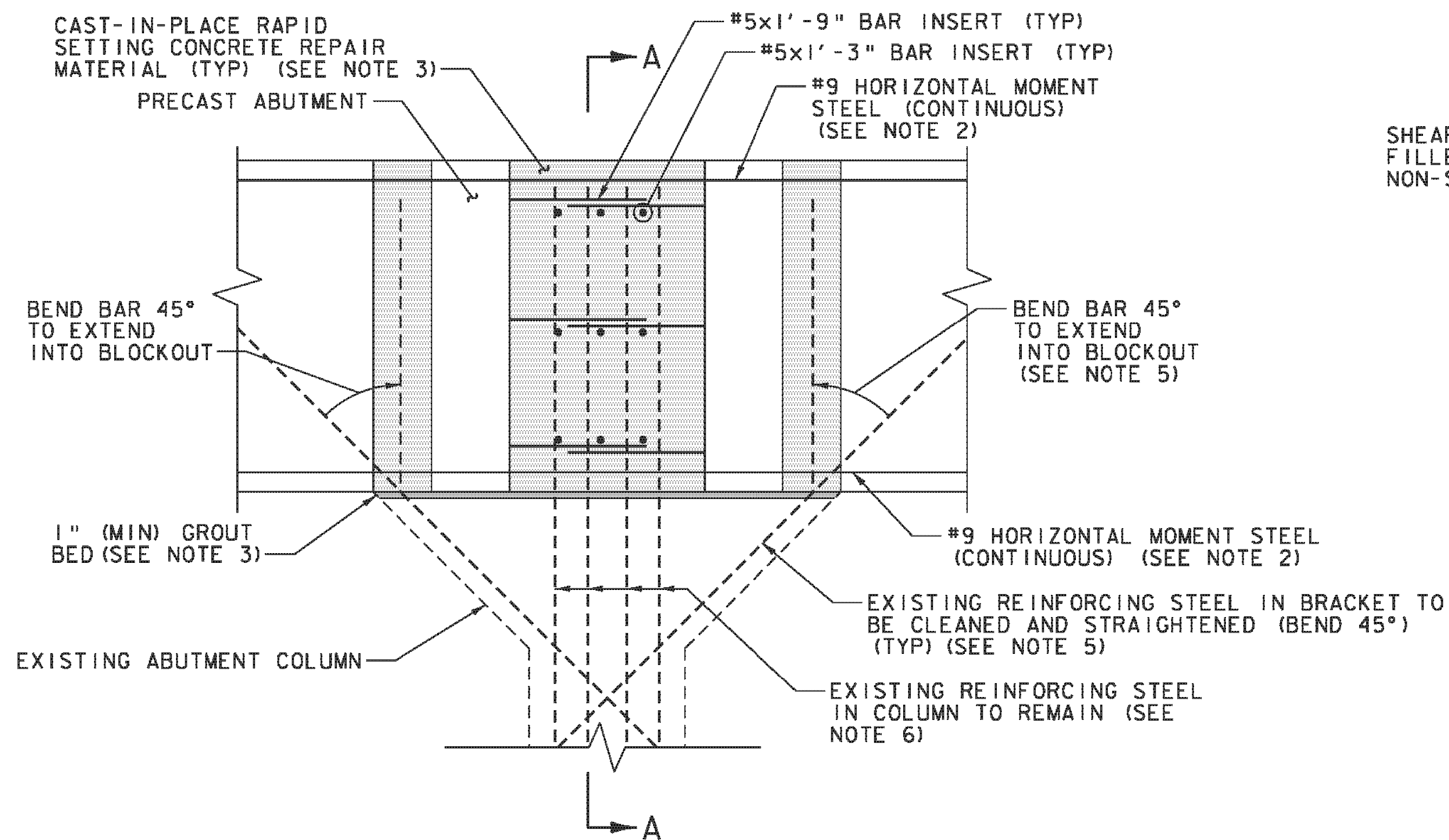

ELEVATION VIEW
SCALE 3/4" = 1'-0"

ABUTMENT REINFORCING STEEL BLOCKOUT DETAILS

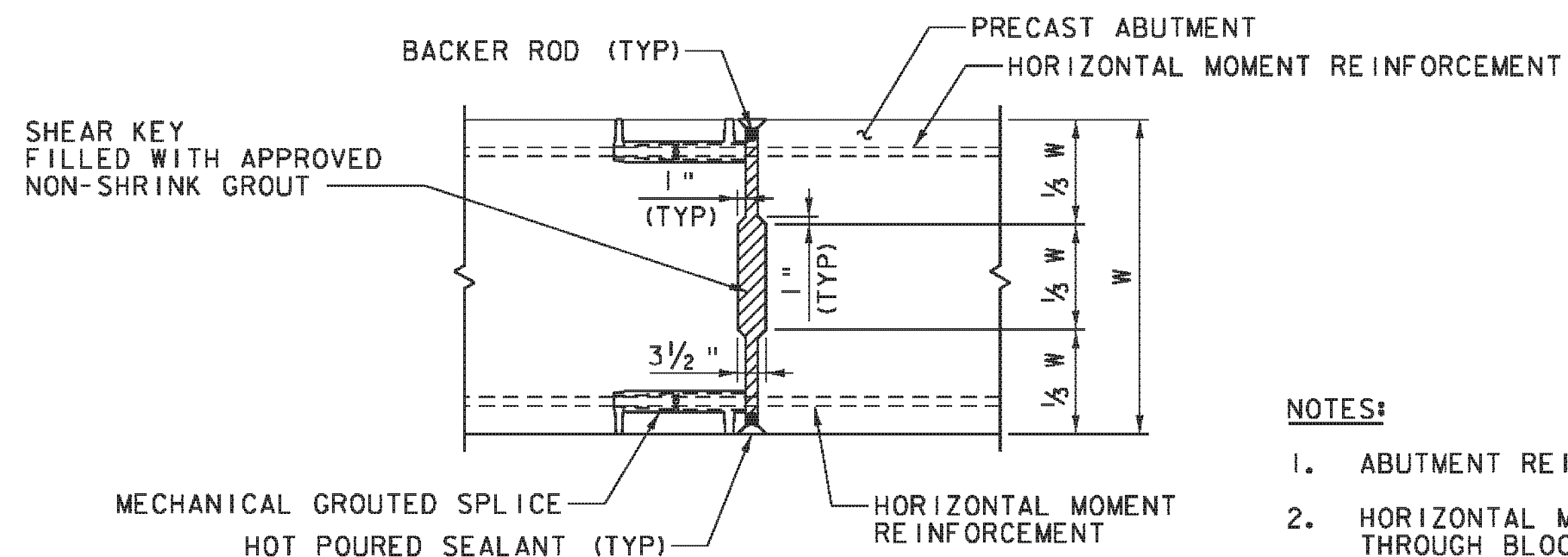

VERTICAL PRECAST JOINT
ELEVATION VIEW
SCALE 3/4" = 1'-0"

THIS DETAIL WAS NOT USED. THE PRECAST ABUTMENT WAS DELIVERED IN ONE PIECE.

NOTES:

1. ABUTMENT REINFORCEMENT NOT SHOWN FOR CLARITY.
2. HORIZONTAL MOMENT REINFORCEMENT SHALL EXTEND THROUGH BLOCKOUTS.
3. SEE SHEET 31 FOR ADDITIONAL PRECAST ABUTMENT AND REINFORCING NOTES.
4. PRIOR TO PRECAST CAP FABRICATION CONTRACTOR SHALL VERIFY ACTUAL LOCATION OF EXISTING COLUMN BASED ON FIELD MEASUREMENTS TO ENSURE PROPER FIT-UP BETWEEN EXISTING COLUMNS AND NEW PRECAST ABUTMENT CAP.
5. SEE SHEET 32 FOR BENDING REQUIREMENTS OF EXISTING DIAGONAL REINFORCING STEEL.
6. THE EXISTING REINFORCING STEEL PROTRUDING FROM THE EXISTING ABUTMENT COLUMN SHALL BE CLEANED AND REMAIN IN ITS ORIGINAL POSITION, THE EXISTING REINFORCING STEEL SHALL NOT BE TIED AND/OR BUNDLED TOGETHER. IF THE EXISTING REINFORCING STEEL IS BENT DURING THE REMOVAL OF THE EXISTING ABUTMENT IT SHALL BE REALIGNED TO ITS ORIGINAL POSITION OR TO A POSITION AS DIRECTED BY THE ENGINEER.

PROJECT NAME: THETFORD
PROJECT NUMBER: BHF 0177(9)

FILE NAME: z08j174precast.dgn PLOT DATE: 3/1/2012
PROJECT LEADER: M.A. COLGAN DRAWN BY: E.A. FIALA
DESIGNED BY: G.S. GOODRICH CHECKED BY: S.E. BURBANK
PRECAST ABUTMENT DETAILS SHEET 53 OF 78

