

NOTES

- ALL DISTANCES SHOWN ARE DESIRABLE MINIMUMS. FIELD CONDITIONS SHALL CONTROL THE ACTUAL PLACEMENT OF CONSTRUCTION SIGNS. SEE VTRANS' STD. T-10 FOR ADDITIONAL SIGN PLACEMENT DETAILS.
- SEE TRAFFIC CONTROL LAYOUT SHEET, SHEET 18, FOR FURTHER DETAILS WITHIN THE PROJECT AREA.
- CONSTRUCTION SIGNING AND ALL TEMPORARY TRAFFIC CONTROL MEASURES SHALL BE IN ACCORDANCE WITH SECTION 6 OF THE LATEST EDITION OF THE MANUAL ON UNIFORM TRAFFIC CONTROL DEVICES (MUTCD).
- CONSTRUCTION SIGNS SHALL BE IN NEW OR LIKE NEW CONDITION PER VTRANS' STANDARDS.
- CONSTRUCTION SIGNS SHALL BE OF THE SIZES SHOWN ON THE PLAN WITH BLACK LEGENDS ON FLUORESCENT ORANGE BACKGROUNDS. LEAD SIGN (W20-1) SHALL BE ASTM D4956 TYPE VIII FLUORESCENT ORANGE SHEETING.
- PAYMENT FOR THE INSTALLATION, MAINTENANCE, AND REMOVAL OF ALL CONSTRUCTION SIGNING WILL BE MADE UNDER ITEM 641.10 TRAFFIC CONTROL.
- ALL SIGN STANDS AND POST INSTALLATIONS SHALL BE NATIONAL COOPERATIVE HIGHWAY RESEARCH PROGRAM REPORT (NCHRP) 350 COMPLIANT.
- RELEVANT EXISTING SIGNS ARE SHOWN ON THIS PLAN FOR REFERENCE. SIGNS SHOWN ON THIS PLAN DO NOT REPRESENT A FULL ACCOUNT OF SIGNS WITHIN THE LIMITS SHOWN.
- PROPOSED CONSTRUCTION SIGNS SHALL NOT INTERFERE WITH THE SIGHT LINES TO EXISTING SIGNS. PROPOSED SIGNS SHALL BE LOCATED A MINIMUM OF 100 FEET FROM THE NEAREST EXISTING OR PROPOSED SIGN. EXACT SIGN LOCATIONS SHALL BE APPROVED BY THE ENGINEER.
- SHOULD WORK ON RED MILL DRIVE OCCUR BEFORE WORK BEGINS ON THE PEDESTRIAN BRIDGE, OR AFTER WORK ON THE PEDESTRIAN BRIDGE IS COMPLETED, SIDE ROAD APPROACH SIGNING SHALL BE ERECTED AS SHOWN ON VTRANS' STD. T-10 AND AT THE DIRECTION OF THE ENGINEER.
- THE CONTRACTOR SHALL COVER OR REMOVE ANY SIGNS THAT CONTRADICT TEMPORARY TRAFFIC CONTROL SIGNS. ALL SIGNS REMOVED OR COVERED BY THE CONTRACTOR SHALL BE REPLACED OR UNCOVERED BY THE CONTRACTOR WHEN THE TRAFFIC CONTROL PLAN IS DISASSEMBLED. PAYMENT FOR THIS WORK SHALL BE CONSIDERED INCIDENTAL TO ITEM 641.10 TRAFFIC CONTROL. ANY DAMAGE TO EXISTING SIGNS BY THE CONTRACTOR SHALL BE REPLACED BY THE CONTRACTOR WITH NO ADDITIONAL COMPENSATION.
- THE CONTRACTOR SHALL PLACE PORTABLE CHANGEABLE MESSAGE SIGNS APPROXIMATELY 1000 FEET IN ADVANCE OF THE LEAD SIGN ON VT 15, OR AS DIRECTED BY THE ENGINEER. PAYMENT FOR THIS WORK SHALL BE UNDER ITEM 641.15 PORTABLE CHANGEABLE MESSAGE SIGN.
- SEE VTRANS' STD. T-10 FOR ADDITIONAL SIGN DETAILS.

SEE TRAFFIC CONTROL LAYOUT SHEET, SHEET 18, FOR DETAILS

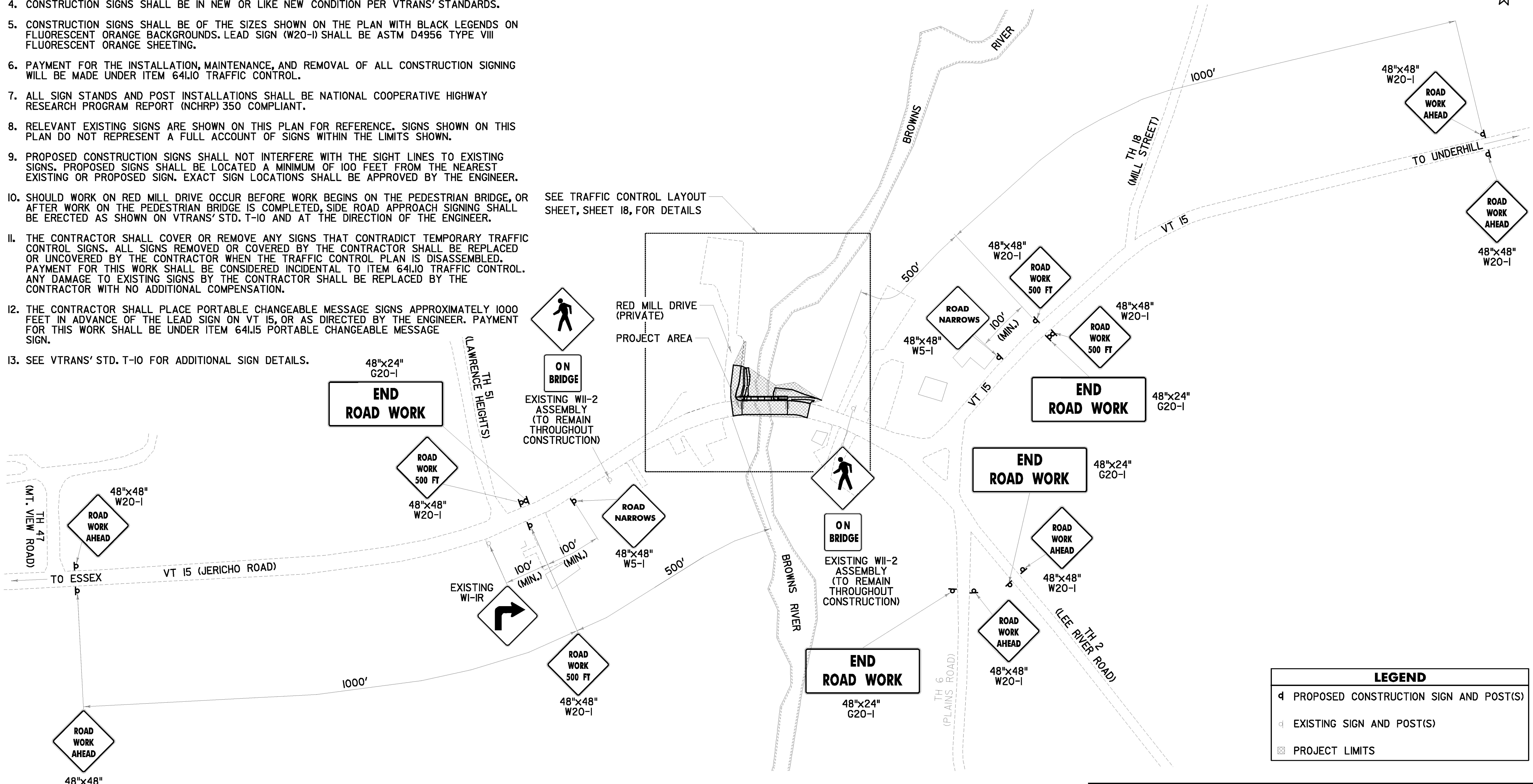
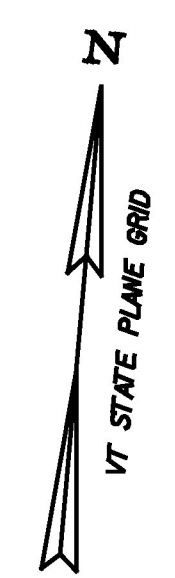

LEGEND	
	PROPOSED CONSTRUCTION SIGN AND POST(S)
	EXISTING SIGN AND POST(S)
	PROJECT LIMITS

NOT TO SCALE



CONSTRUCTION APPROACH SIGNING SHEET	PROJECT NAME: JERICO	PLOT DATE: 4/7/2014
	PROJECT NUMBER: STP FTBR (3)	DRAWN BY: C.R.H.
	PROJECT LEADER: M.D.S.	CHECKED BY: D.E.G.
	DESIGNED BY: C.R.H.	SHEET 20 OF 62
	DWG. NO.: CSP-1	

FILE NAME: V:\Projects\JERICHO\STP\13\CAD\WSTN\08F004\Consult\ents\208F004.dwg
DATE/TIME: 4/7/2014
USER: c.r.h.