

TYPICAL BRIDGE SECTION *
SCALE: 1/2" = 1'-0"

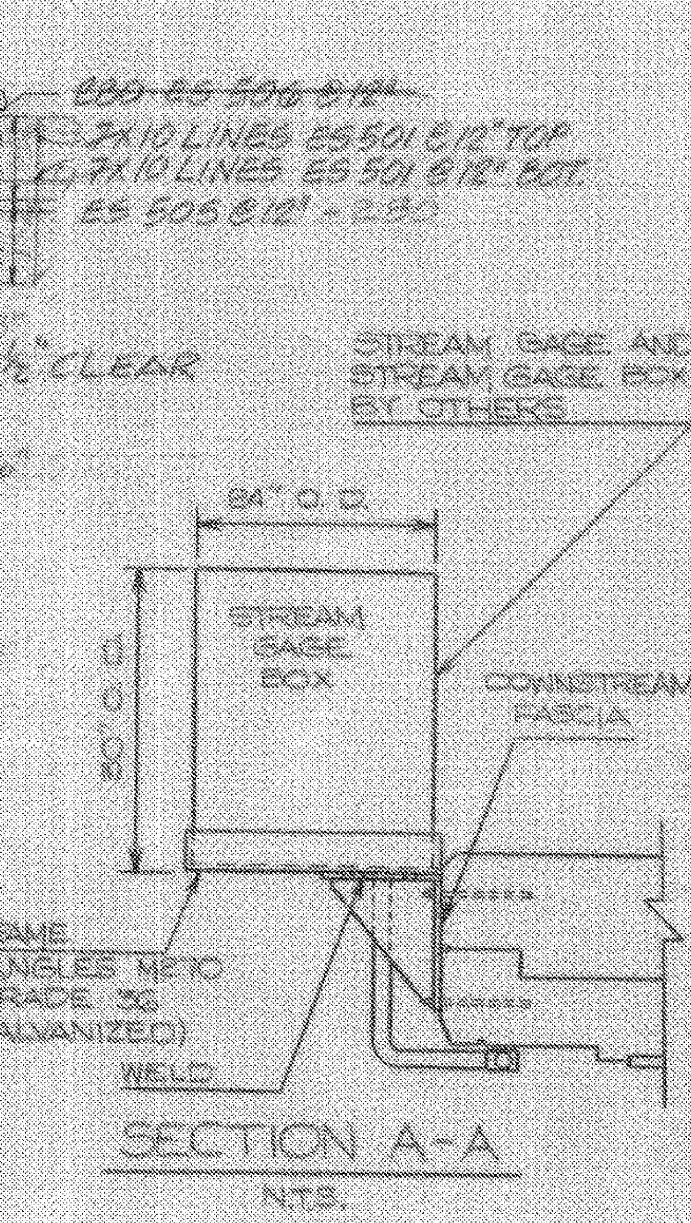

SECTION A-A
NTS.

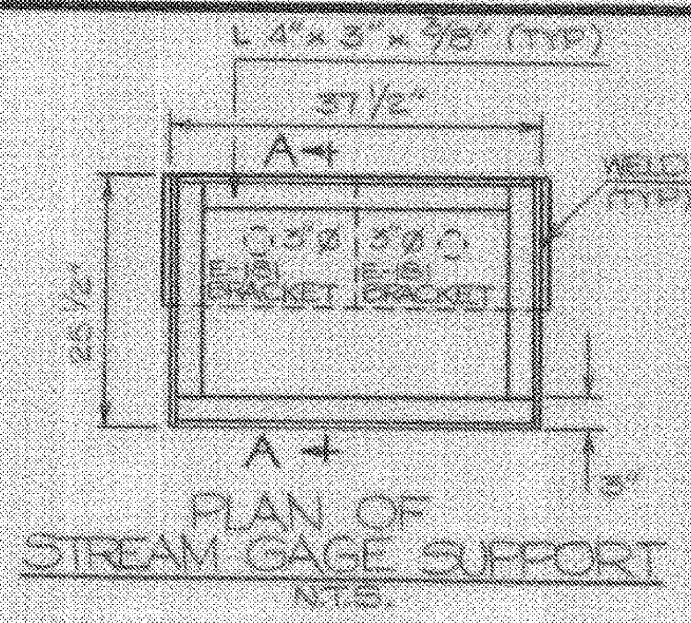
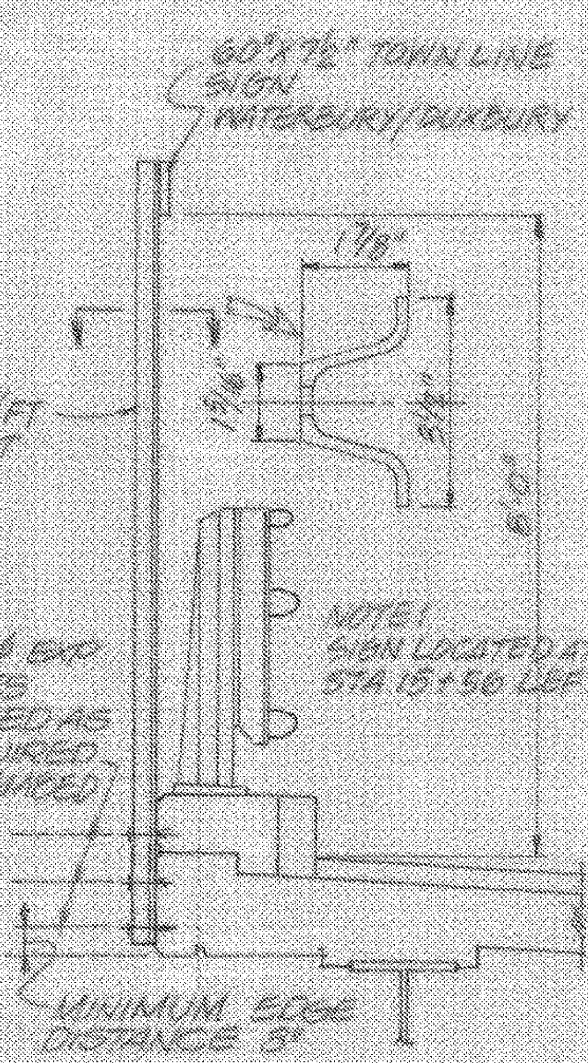

TOWN LINE SIGN
DETAIL
SCALE: 1/2" = 1'-0"

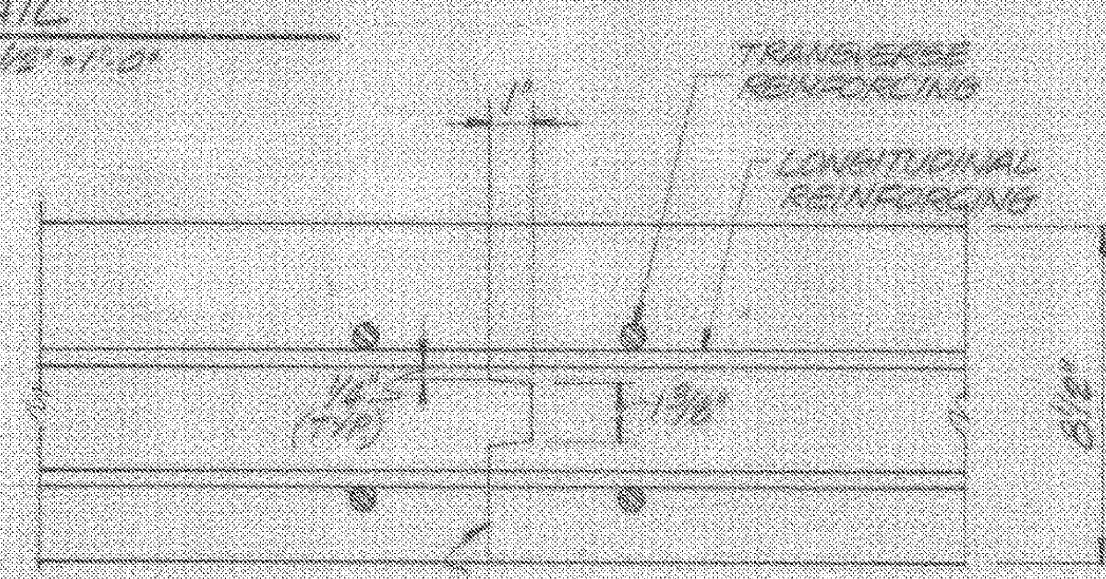

TRANSVERSE BRIDGE SLAB
CONSTRUCTION JOINT DETAILS
SCALE: 3/4" = 1'-0"

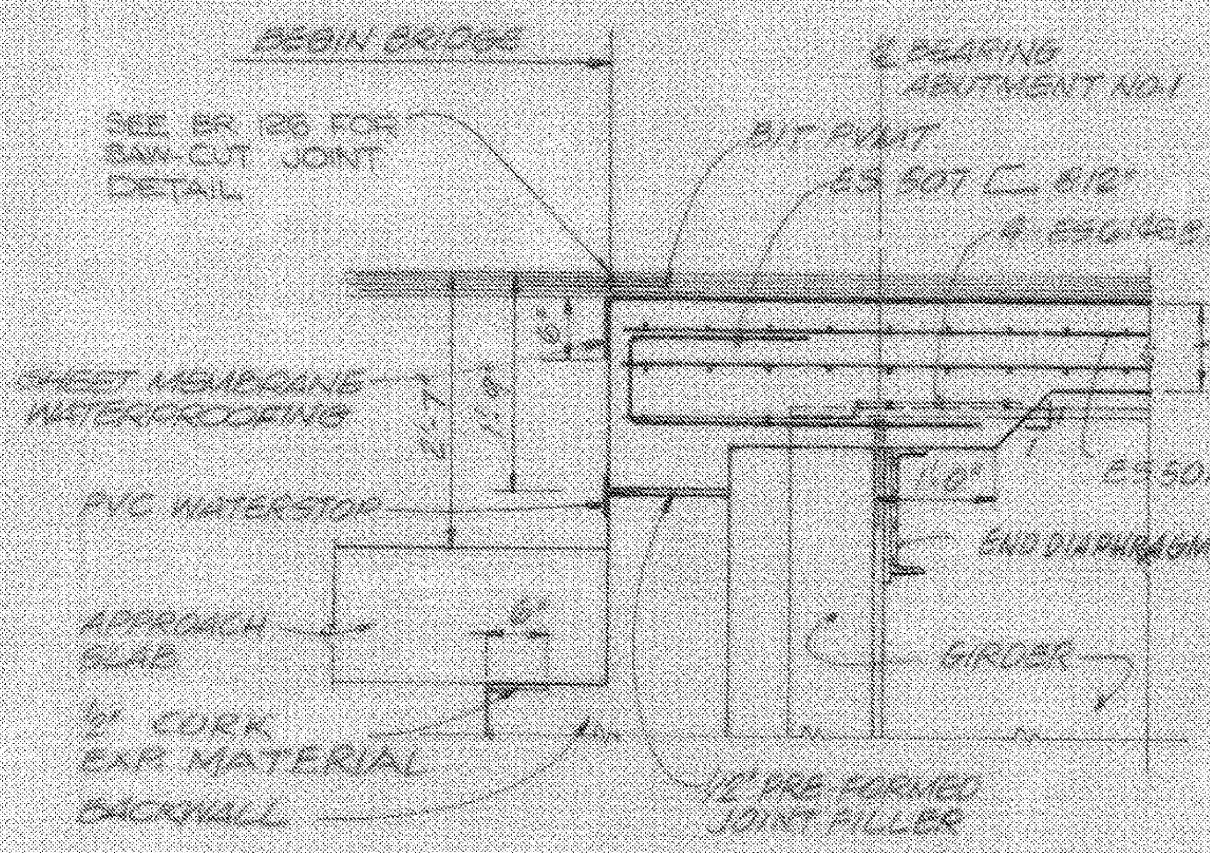

SLAB DETAIL AT ABUTMENT NO. 1
SCALE: 3/4" = 1'-0"

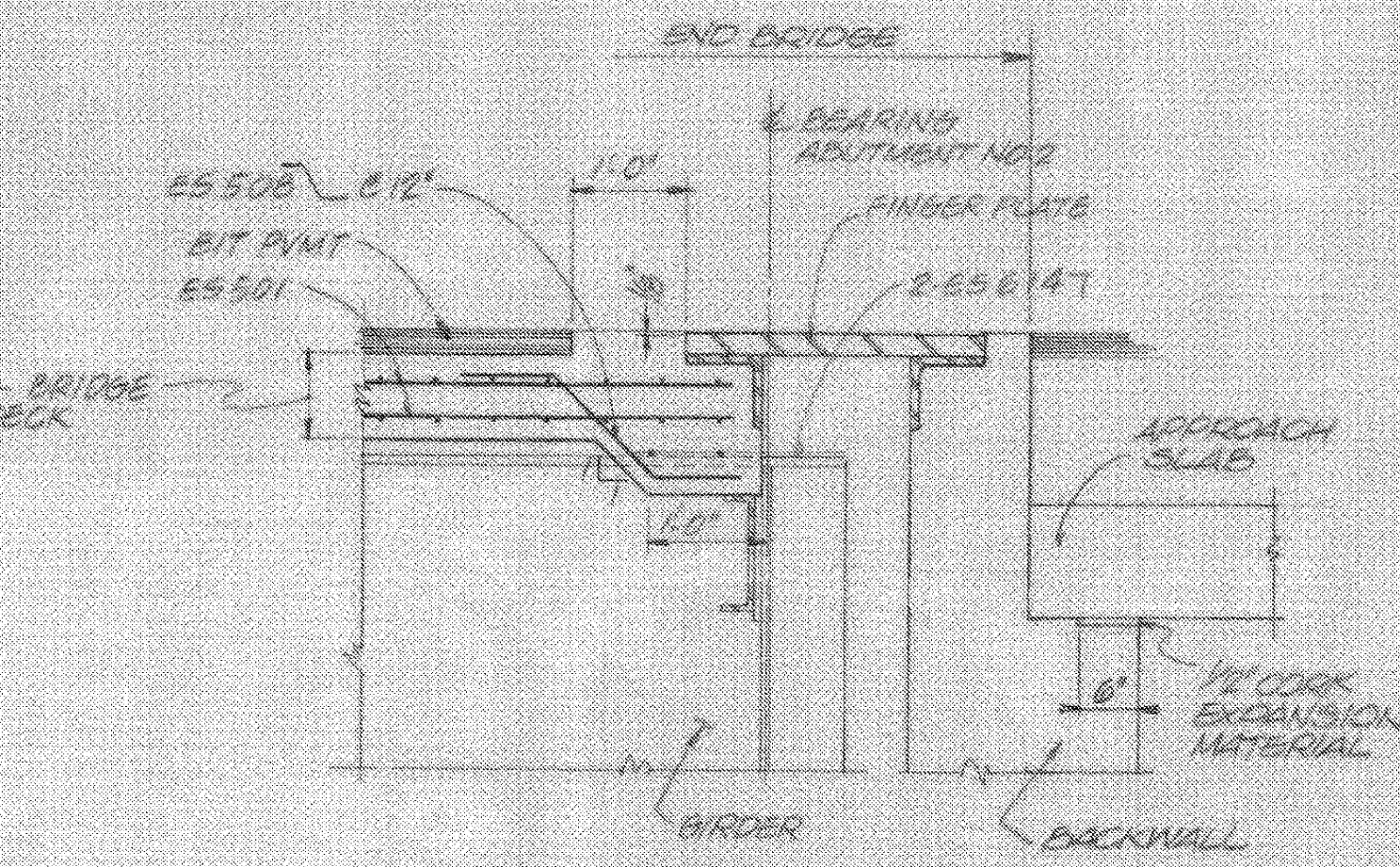

SLAB DETAIL AT ABUTMENT NO. 2
SCALE: 3/4" = 1'-0"

- NOTES:
1. THE BRIDGE RAILING SHALL BE 3 RAIL ALUMINUM. RAILING ON THE SIDEWALK SIDE (WEST FASCIA) SHALL HAVE SPINDLES. SEE BRIDGE SHEET NO. BR127.
 2. SEE DRAWING BR111 FOR GIRDER HAUNCH AND SHEAR CONNECTOR DETAILS.
 3. ALL SUPERSTRUCTURE REINFORCING STEEL SHALL BE EPOXY COATED.
 4. * - EXCEPT FROM STA. 14+25 TO 14+82.99 (SEE BRIDGE DECK REINFORCING PLAN, BR108 & SECTIONS A-A & B-B FOR DETAILS AT NORTHEAST CORNER.)

**STATE OF VERMONT
AGENCY OF TRANSPORTATION**

Town Of WATERBURY-DUXBURY-MORETOWN	Bridge No. 48
Highway No. U.S. RTE 2	Log Sta. Surv. Sta. 15+61
U.S. RTE. 2 OVER WINOOSKI RIVER	
SUPERSTRUCTURE DETAILS	
Designed By C.J.B.	Drawn By R.J.L.
Checked By L.C.	Date 9/89
Bridge Design Supervisor DWK	Date 9/90
PROJECT WATERBURY-DUXBURY-MORETOWN	PROJECT NO. BRF-013-4(10)
L.C. Info.	Bridge Sheet No. BR 107
	Sheet 51 of 162

BARNES AND JARNIS, INC.
CONSULTING ENGINEERS
BOSTON, MASS.

For Reference Only
Waterbury-Moretown
BHF MEMB (12)
Sheet .8 of 28