

BRIDGE DATA		
Item	Present	Proposed
Overall Span along & Road	52'-8"	70'-0"
roadway Width Face to Face of Curb	16'-0"	30'-0"
Clear Span Along & of Road	50'-0"	75'-0"
Clear Span Normal to Stream	47'-0"	71'-0"
Clear Height to Low Bridge Seat	23'-0"	2'-0"
Max. High Water Elev.	633.2	631.0
Waterway Area to Low Bridge Seat	1000 sq ft	1290 sq ft
Normal to Max. H.W. Elev.	400 sq ft	520 sq ft
To Stream Us Normal H.W. Elev.	2600 sq ft	300 sq ft
Stream Velocity	10 ft/min	10 ft/min
Drift & Scour	None	None

Sheet No.	Description
10	Preliminary Information Sheet
11	Plan & Profile
12	Bridge Plan & Elevation
13	Abutment No. 1 (Detail)
14	Abutment No. 2 & Lt. Wing (Details)
15	Abutment No. 2 - Rt. Wing (Details)
16	Superstructure
17	Std. Pipe & Spindle Rail - Std. Dwg. SB-551
18	Typical Details - Std. Dwg. SB-201 (Det. A, C, D, E, F, H, J, K, & L)
19	Barricades, Signs & Lights - Std. Dwg. SB-11
20	Steel Beam Guard Rail - Std. Dwg. SB-48
21	Steel Beam Guard Rail - Std. Dwg. SB-48

Parcel Instrument Date	Grantor	Grantee	Recorded Book	Recorded Page	Recorded Date	Remarks
#3 A & B W.D.O.E. 11-1-50	FRANK E. HATCH	ST. OF VT.	37	618-19	12-22-50	
#4 A & B W.D.O.E. 11-14-50	WALTER A. MALMQUIST	ST. OF VT.	39	4-5-6	1-17-51	
#5 W.D.O.E. 10-25-50	CARL S. & LINNA S. KELLEY	ST. OF VT.	37	610-11	12-22-50	
#6 W.D.O.E. 10-25-50	EDWIN S. & CLARA G. KNIGHT	ST. OF VT.	37	617-18	12-22-50	Culvert 25' x 12'

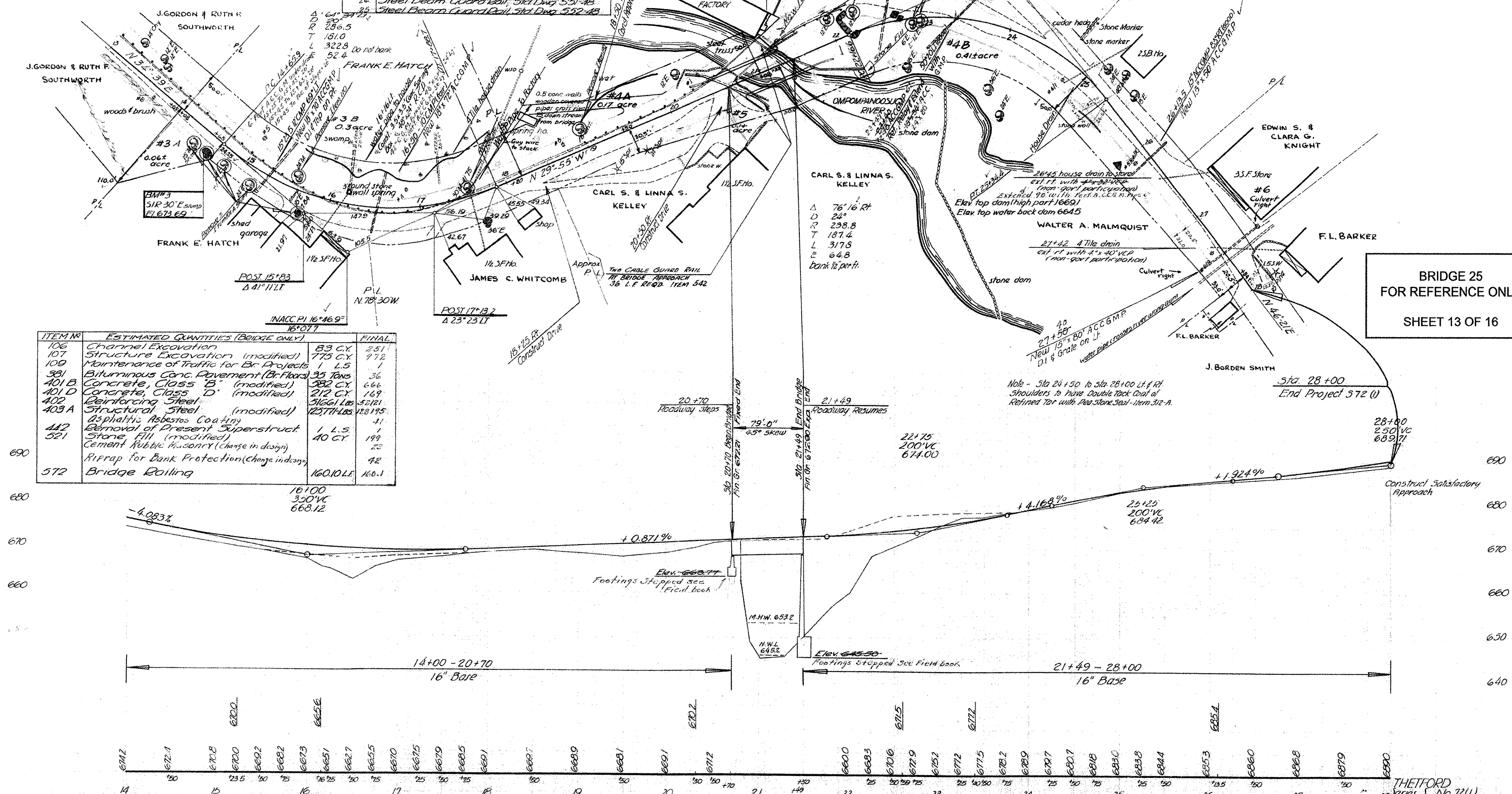

BRIDGE 25
FOR REFERENCE ONLY
SHEET 13 OF 16

ITEM NO.	ESTIMATED QUANTITIES (BRIDGE ONLY)	FINAL
106	Channel Excavation	83 CY 251
107	Structure Excavation (modified)	775 CY 772
109	Maintenance of Traffic for Br. Projects	1 L.S. 1
351	Bituminous Conc. Pavement (Br. Floor)	35 Tons 36
401 B	Concrete, Class B (modified)	382 CY 666
401 D	Concrete, Class D (modified)	212 CY 169
402	Reinforcing Steel	51661 Lbs 52121
403 A	Structural Steel (modified)	125711 Lbs 128195
412	Asphaltic Asbestos Coating	1 L.S. 1
521	Removal of Present Superstruct Stone Pile (modified)	40 CY 199
	Cement Rubble Masonry (change in design)	22
	Riprap for Bank Protection (change in design)	42
572	Bridge Railing	160.10 LF 160.1

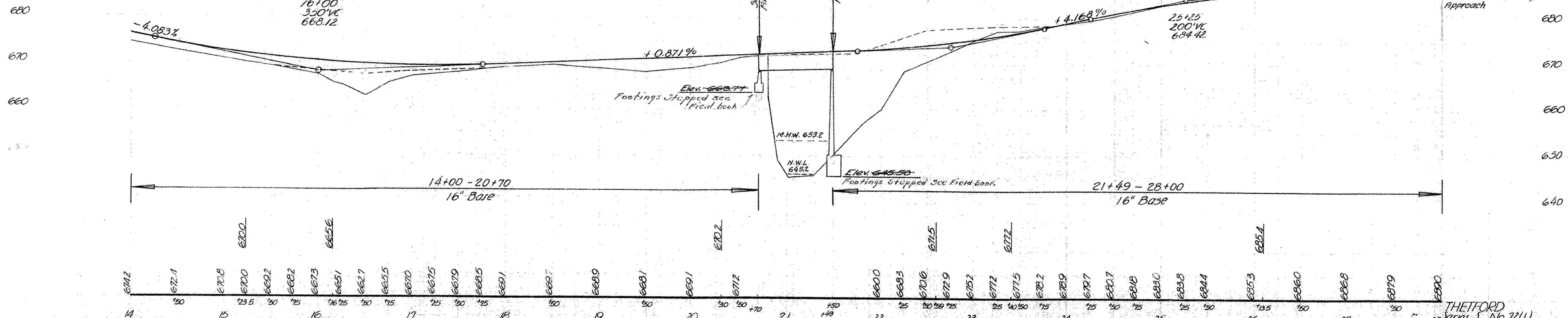

B.M. #3 16' Rt. 14+56 51R 30' Elm Slump - Elev. 673.69
 B.M. #4 15' Lt. Sta 21+37 Spot on Conc. Loading Platform - Elev. 675.11

THETFORD
 Series 5 No. 72(1)
 Sheet 9 of 44