

INDEX OF SHEETS

- 1 TITLE SHEET
- 2 PROJECT TYPICAL SHEET
- 3 PAVING DETAIL SHEET
- 4 ASPHALTIC PLUG JOINT DETAILS SHEET
- 5-6 QUANTITY SHEETS
- 7 ITEM DETAIL SUMMARY SHEET
- 8-16 PROJECT LAYOUT SHEETS
- 17-18 TRAFFIC SIGN SUMMARY SHEETS
- 19 TEMPORARY TRAFFIC CONTROL PLAN

VTrans STANDARDS

- C-1 01-03-00
- C-2A 10-14-05
- C-3A 03-10-08
- C-3B 03-10-08
- E-100 01-02-04
- E-100A 01-02-04
- E-101 05-30-03
- E-102 06-30-03
- E-102A 05-01-04
- E-106 03-01-04
- E-108 08-18-95
- E-110 08-08-95
- E-121 08-08-95
- E-145A 12-23-94
- E-145B 12-23-94
- E-152 05-01-04
- E-160 05-20-99
- E-161 08-18-95
- E-162 05-20-99
- E-163 05-20-99
- E-164 05-20-99
- E-191 02-01-99
- E-192 10-12-00
- E-193 08-18-95

RECORD PLANS

CONTRACTOR: PIKE INDUSTRIES, INC. - BERLIN, VT

RESIDENT ENGINEER: CARL FIELDER

CONSTRUCTION BEGAN: SEPTEMBER 22, 2008

CONSTRUCTION COMPLETE: JUNE 3, 2008

RECORD PLANS BY: CARL FIELDER & C. PIERCE

I HEREBY CERTIFY THAT ALL THE CONSTRUCTION REQUIRED BY THIS SET OF DRAWINGS HAS BEEN ACCOMPLISHED AS INDICATED HEREIN.

BY *Carl Fielder* RESIDENT ENGINEER

DATE *2/19/10*

NOTE: Any further information concerning final quantities, amounts or other details relative to this project may be found at Central Files in the electronic archives.

STATE OF VERMONT
AGENCY OF TRANSPORTATION

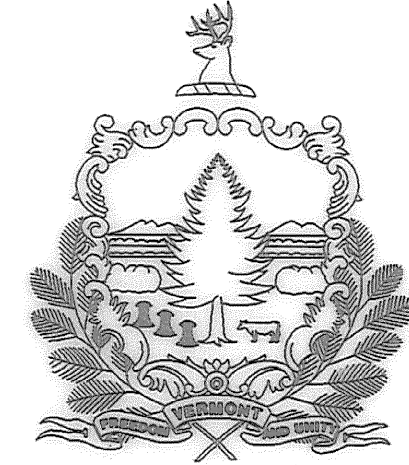

PROPOSED IMPROVEMENT
CITY OF BARRE
COUNTY OF WASHINGTON
U.S. ROUTE 302

BEGINNING AT THE BERLIN/BARRE TOWN LINE AND EXTENDING EASTERLY ALONG U.S. ROUTE 302 FOR A DISTANCE OF 8,943.5 FEET TO STA. 89+43.50

TOTAL LENGTH OF PROJECT: 8,943.5 FEET = 1.694 MILES
TOTAL LENGTH OF ROADWAY: 8,943.5 FEET = 1.694 MILES

WORK TO BE PERFORMED UNDER THIS PROJECT INCLUDES COLD PLANING, RESURFACING OF THE EXISTING HIGHWAY, NEW PAVEMENT MARKINGS AND INCIDENTAL ITEMS

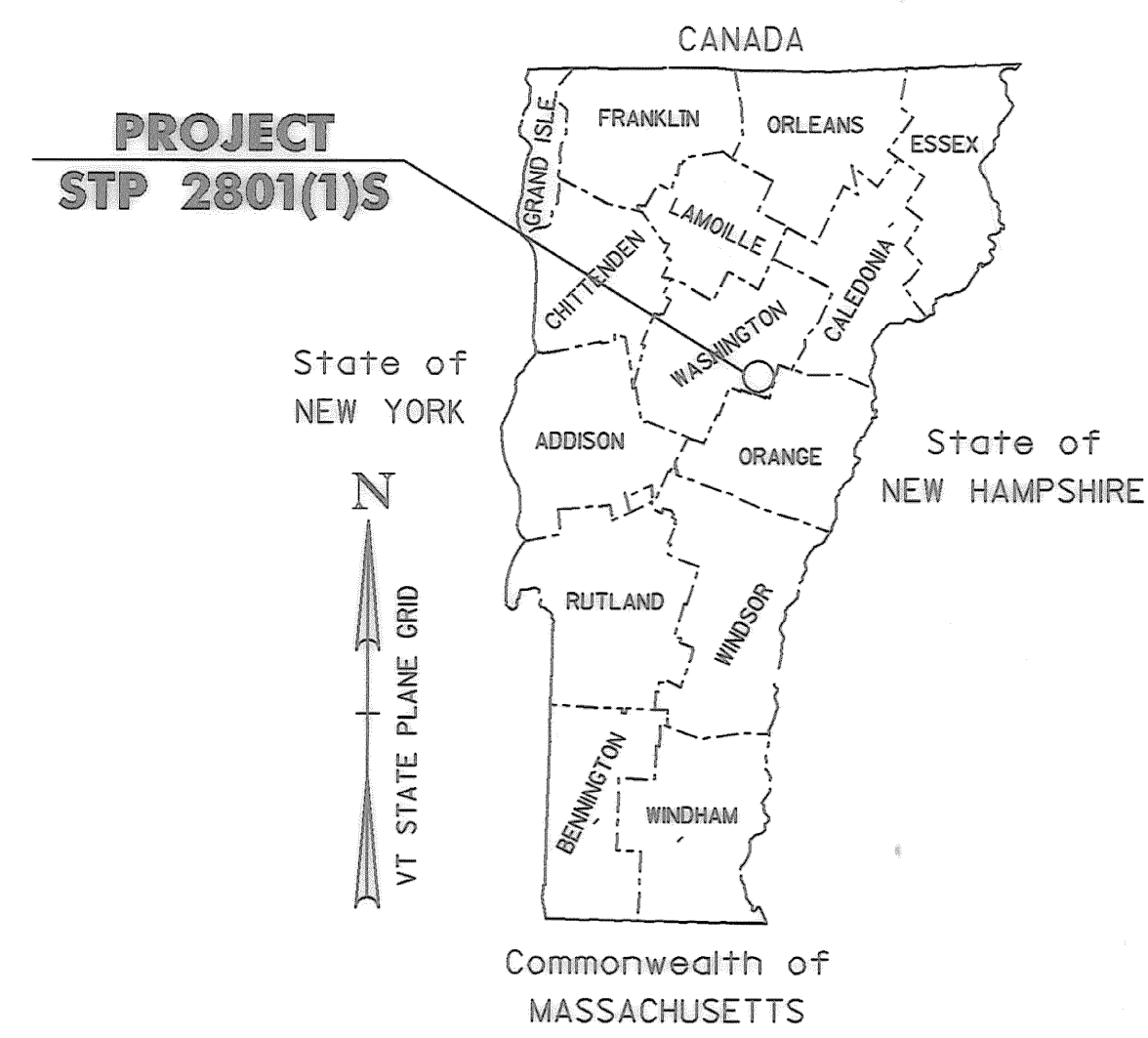

BITUMINOUS CONCRETE PAVEMENT SUPERPAVE MIXTURE DESIGN CRITERIA

DESIGN LANE/DESIGN LIFE ESALS	3,464,500
DESIGN NUMBER OF GYRATIONS	65
PERFORMANCE GRADED ASPHALT BINDER	64-28

TRAFFIC DATA
U.S. ROUTE 302

LOCATION	AADT		DHV		ESALS	
	2008	2018	2008	2018	2008-2018	2008-2028
BEGIN PROJECT (BERLIN T/L) TO RICHARDSON ROAD	12,100	12,700	1,300	1,300	926,000	2,184,000
RICHARDSON ROAD TO BERLIN STREET	14,900	15,600	1,600	1,600	2,384,000	5,284,000
BERLIN STREET TO BECKLEY STREET	15,500	16,300	1,600	1,700	2,463,000	6,263,000
BECKLEY STREET TO END PROJECT (VT 14/VT 62)	15,700	16,300	1,600	1,700	2,737,000	6,929,000

BEGIN STP 2801(1)S
U.S. ROUTE 302
STA. 0+00.00

END PROJECT STP 2801(1)S
U.S. ROUTE 302
STA. 89+43.50

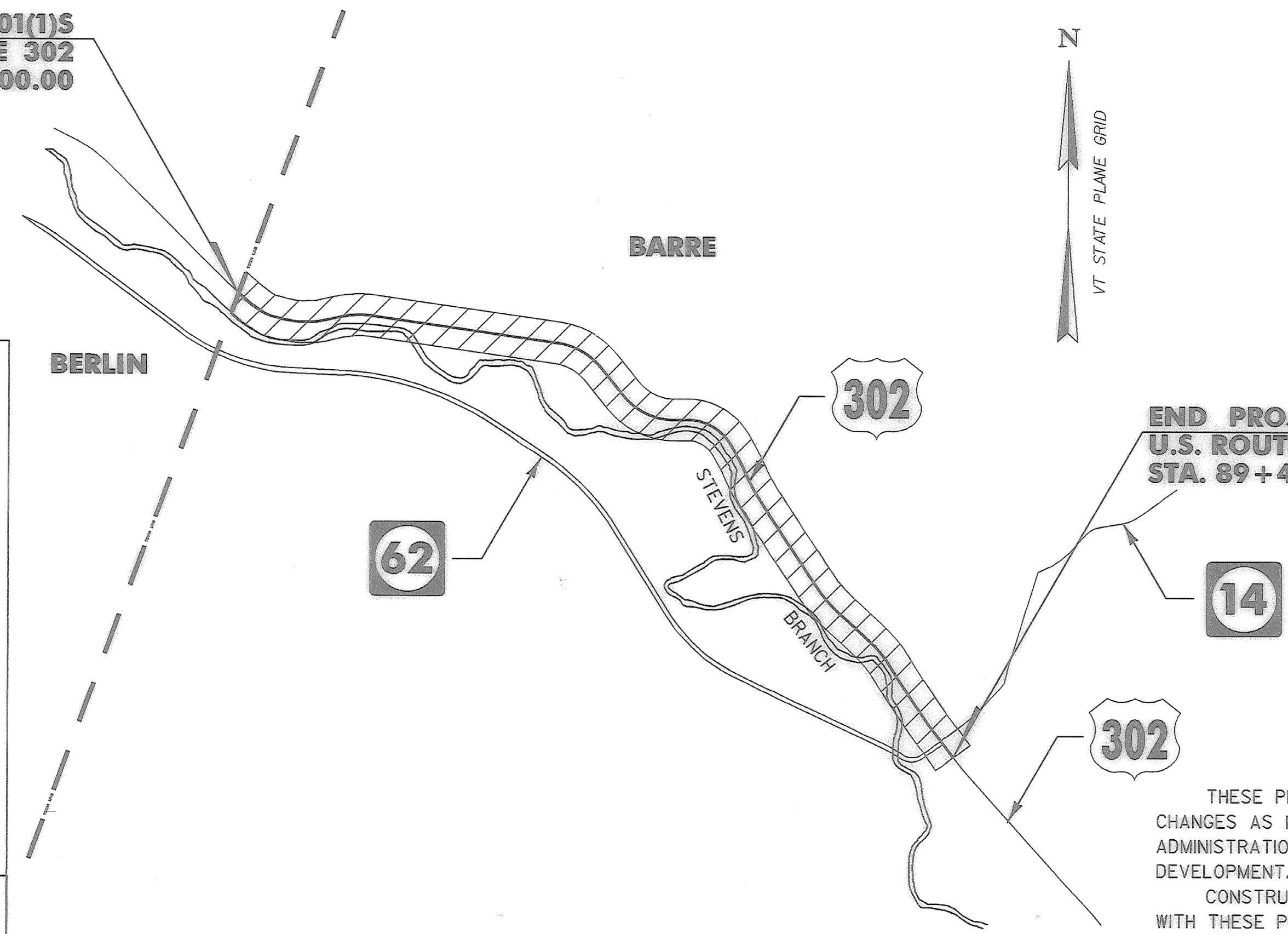

- UTILITY LEGEND**
- ◊ = EXISTING HYDRANT
 - ◻ = EXISTING DI
 - = EXISTING MANHOLE
 - TEL = EXISTING TELEPHONE MANHOLE
 - ELEC = EXISTING ELECTRIC MANHOLE
 - SMH = EXISTING SEWER MANHOLE
 - WSO = EXISTING WATER SHUTOFF
 - GSO = EXISTING GAS SHUTOFF
 - ✉ = EXISTING MAILBOX
- SIGN LEGEND**
- N = NEW
 - R = REMOVE
 - R&S = REMOVE & SALVAGE
 - S = SALVAGE SIGN
 - RET = RETAIN
 - B-B = BACK TO BACK
 - ⓪ = RETURN TO CITY OF BARRE

SURVEYED BY : N/A
SURVEYED DATE : N/A

DATUM

VERTICAL N/A
HORIZONTAL N/A

- CONVENTIONAL SYMBOLS**
- COUNTY LINE
 - TOWN LINE
 - LIMITS OF ACCESS
 - POINT OF ACCESS
 - FENCE LINE
 - STONE WALL
 - TRAVELED WAY
 - GUARD RAIL
 - RAILROAD
 - SURVEY LINE
 - CULVERT
 - POWER POLE
 - TELEPHONE POLE
 - TREES
 - CONTROL OF ACCESS
 - PROPERTY LINE
 - R.O.W. TAKING LINE
 - SLOPE RIGHTS
 - TOP OF CUT
 - TOE OF SLOPE

THESE PLANS ARE SUBJECT TO SUCH ENGINEERING CHANGES AS MAY BE REQUIRED BY THE FEDERAL HIGHWAY ADMINISTRATION OR THE DIRECTOR OF PROGRAM DEVELOPMENT.

CONSTRUCTION IS TO BE CARRIED ON IN ACCORDANCE WITH THESE PLANS AND THE STANDARD SPECIFICATIONS FOR CONSTRUCTION DATED 2006, AS APPROVED BY THE FEDERAL HIGHWAY ADMINISTRATION ON JUNE 15, 2006 FOR USE ON THIS PROJECT, INCLUDING ALL SUBSEQUENT REVISIONS AND SUCH REVISED SPECIFICATIONS AND SPECIAL PROVISIONS AS ARE INCORPORATED IN THESE PLANS.



NOTE: RIGHT-OF-WAY LIMITS, IF APPLICABLE, ARE PROVIDED SOLELY FOR THE CONVENIENCE OF THE STATE AND ITS CONTRACTOR DURING THE COURSE OF THIS PAVING PROJECT. ANY REFERENCES TO OFFSETS ON THESE PLANS ARE APPROXIMATE AND SHOULD NOT BE RELIED UPON FOR ANY PURPOSES.

UNLESS OTHERWISE NOTED, ALL DRAWINGS AND DETAILS ON THESE PLANS ARE DRAWN "NOT TO SCALE".

DIRECTOR OF PROGRAM DEVELOPMENT
APPROVED: *Richard J. Filwood* DATE 7-9-08
PROJECT MANAGER: TED DOMEY

PROJECT NAME: BARRE CITY
PROJECT NUMBER: STP 2801(1)S

SHEET 1 OF 19 SHEETS



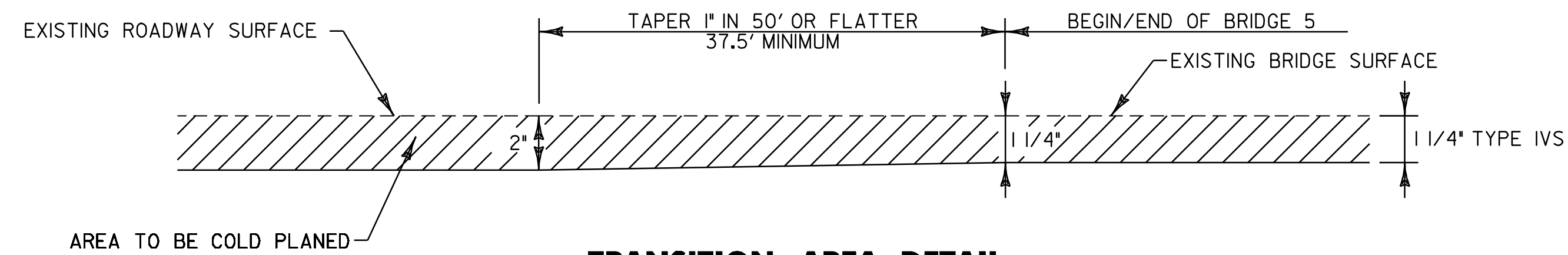

TRANSITION AREA DETAIL

FULL ROADWAY WIDTH

STA. 80+78.5 TO 81+16.0
 STA. 81+40.0 TO 81+77.5

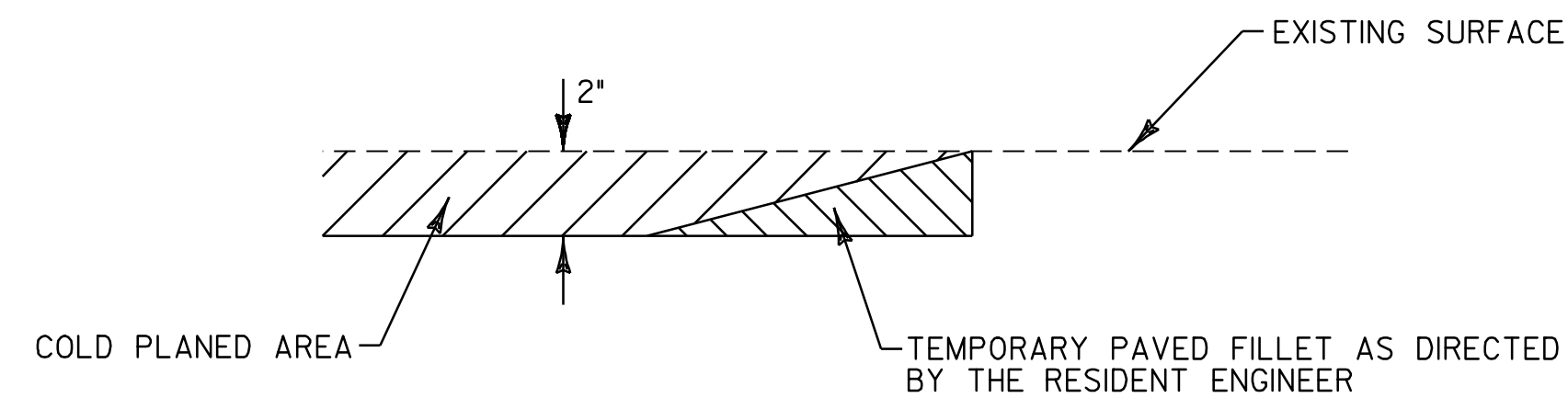

DETAIL AT VERTICAL COLD PLANE JOINTS

NOTE: THIS DETAIL SHALL BE USED FOR THE SIDE ROADS LISTED BELOW AND AT ALL DRIVES AS DIRECTED BY THE RESIDENT ENGINEER. PAYMENT SHALL BE INCIDENTAL TO ITEM 490.30.

FULL ROADWAY WIDTH

- STA. 0+00.00 (BEGIN PROJECT)
- STA. 29+81.8, LT (PACKARD ST.)
- STA. 31+77.0, LT (FORD ST.)
- STA. 41+11.2, LT (RICHARDSON RD.)
- STA. 54+35.6, RT (WILLEY ST.)
- STA. 55+67.6, LT (SIXTH ST.)
- STA. 58+11.5, LT (FIFTH ST.)
- STA. 60+52.4, LT (FOURTH ST.)
- STA. 62+95.2, LT (THIRD ST.)
- STA. 65+33.0, LT (SECOND ST.)
- STA. 65+33.0, RT (WEST SECOND ST.)
- STA. 67+76.4, LT (FIRST ST.)
- STA. 68+95.6, RT (BERLIN ST.)
- STA. 71+68.5, LT (BECKLEY ST.)
- STA. 76+35.0, LT (N. SEMINARY ST.)
- STA. 82+24.4, RT (BLACKWELL ST.)
- STA. 84+74.1, LT (BROOK ST.)
- STA. 86+17.7, RT (HORACE LANE)
- STA. 87+51.0, RT (VT ROUTE 62)
- STA. 87+57.4, LT (VT ROUTE 14)
- STA. 89+43.5 (END PROJECT)

NOT TO SCALE



**PAVING
 DETAIL
 SHEET**

PROJECT NAME: BARRE CITY
 PROJECT NUMBER: STP 2801(1)S

FILE NAME: p08d022.dgn
 PROJECT LEADER: JLL
 DESIGNED BY: STANTEC
 IPARM FILE: p08d022pds.i

PLOT DATE: 14-APR-2010
 DRAWN BY: STANTEC
 CHECKED BY: JLL
 SHEET 3 OF 19

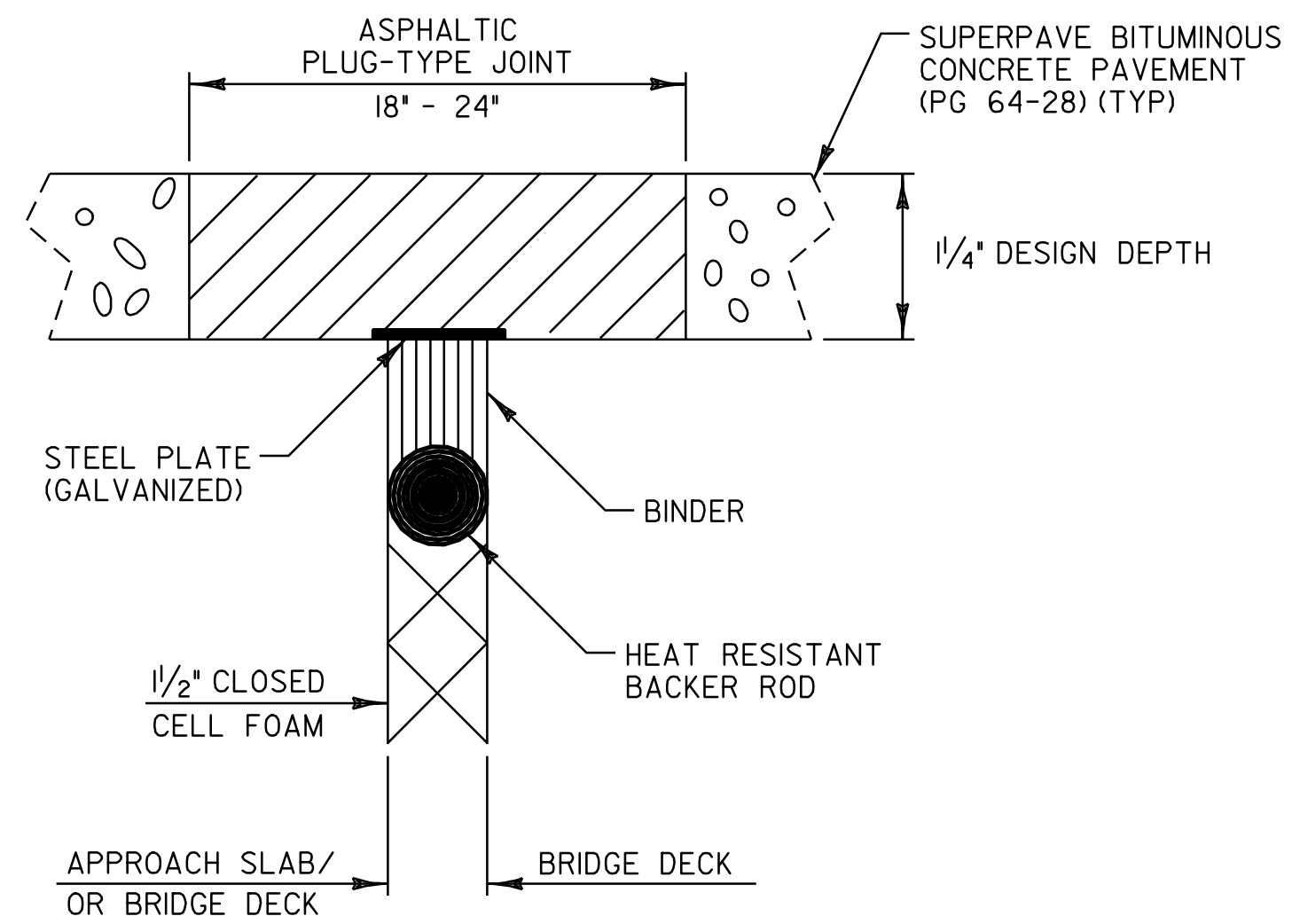

ASPHALTIC PLUG-TYPE JOINT DETAIL

BR 5 U.S. ROUTE 302 BARRE CITY STA. 81+16 (39 LF)
 BR 5 U.S. ROUTE 302 BARRE CITY STA. 81+40 (39 LF)

NOTES:

1. THE JOINT SHALL BE LOCATED CENTRALLY OVER THE DECK EXPANSION GAP OR FIXED JOINT MARKED OUT TO THE MANUFACTURER'S RECOMMENDED WIDTH.
2. THE JOINT SHALL BE EXCAVATED AS SHOWN ON THE PLANS BY USE OF SAWS AND PNEUMATIC HAMMER OR A HAMMER AND CHISEL.
3. THE JOINT AREA SHALL BE BLAST CLEANED OF DEBRIS AND ASPHALT. THE JOINT AREA SHALL BE THOROUGHLY DRIED USING HOT COMPRESSED AIR PRIOR TO APPLYING BINDER MATERIAL.
4. SPALLED AND DEFECTIVE CONCRETE SHALL BE REPAIRED WITH AN APPROVED MATERIAL AS AGREED UPON BY THE RESIDENT ENGINEER.
5. PROPERLY SIZED HEAT RESISTANT BACKER ROD SHALL BE PLACED IN THE MOVEMENT GAP ALLOWING FOR 1 INCH +/- OF BINDER ABOVE THE ROD.
6. THE BINDER MATERIAL SHALL BE HEATED AND PLACED AS RECOMMENDED BY THE MANUFACTURER.
7. PLACE 1/4 INCH THICK BY 8 INCH WIDE SECTIONS OF STEEL PLATE OVER THE CENTER OF THE MOVEMENT GAP. SECURE PLATES FROM MOVING BY INSERTING LOCATING PINS THROUGH THE PRESTAMPED HOLES INTO BACKER ROD AND COVER WITH HOT BINDER.
 - A. THE STEEL PLATES MAY BE OMITTED WHERE THE APPROACH SLAB IS COVERED WITH A STONE BASE OR BITUMINOUS PAVEMENT AND VERTICAL MOVEMENT OF THE PLATES MIGHT OCCUR.
8. THE BINDER MATERIAL AND AGGREGATE SHALL BE HEATED AND MIXED AS RECOMMENDED BY THE MANUFACTURER.
9. THE INSTALLATION OF MATERIAL, COMPACTION, AND TOPCOATING SHALL BE AS RECOMMENDED BY THE MANUFACTURER.
10. IMMEDIATELY AFTER TOPCOATING, AN ANTI-SKID MATERIAL SHALL BE CAST OVER THE JOINT TO REDUCE THE RISK OF TRACKING.
11. JOINT SHALL BE PROTECTED FROM TRAFFIC UNTIL THE MATERIAL HAS COOLED TO 125°F±.

WEATHER LIMITATIONS

BINDER MATERIAL SHALL BE APPLIED ONLY WHEN THE FOLLOWING CONDITIONS PREVAIL:

- A. THE AMBIENT AIR TEMPERATURE IS AT LEAST 50 F AND RISING.
- B. THE ROAD SURFACE IS SUFFICIENTLY DRY.
- C. WEATHER CONDITIONS OR OTHER CONDITIONS ARE FAVORABLE AND ARE EXPECTED TO REMAIN SO FOR THE PERFORMANCE OF SATISFACTORY WORK.

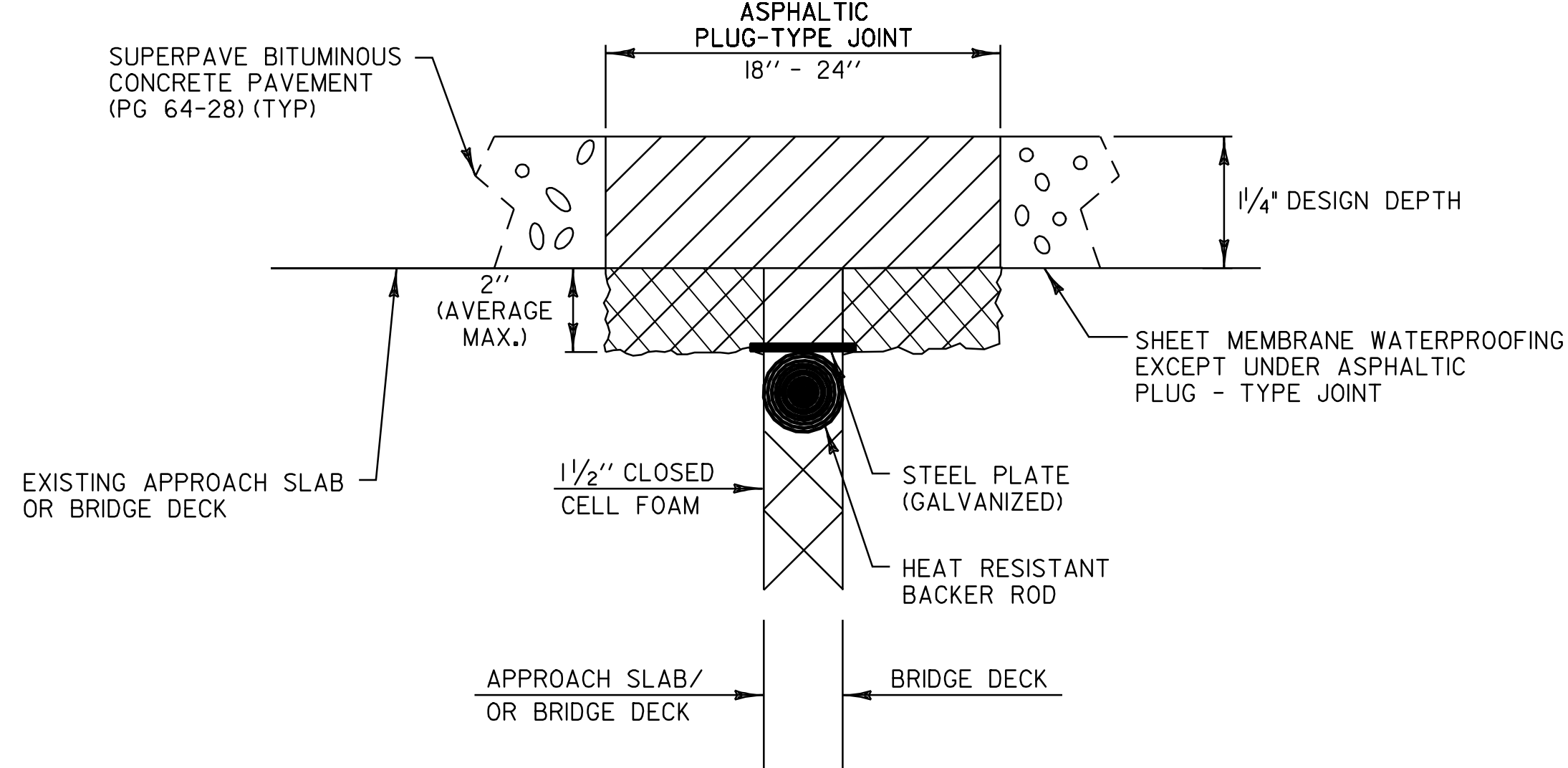

ASPHALTIC PLUG-TYPE JOINT DETAIL REMOVAL OF UP TO 2" DETERIORATED CONCRETE

NOTES:

1. UPON ENCOUNTERING UP TO 2" AVERAGE OF DETERIORATED CONCRETE, THE CONTRACTOR SHALL REMOVE THE DETERIORATED MATERIAL AND REPLACE IT WITH THE ASPHALTIC PLUG JOINT MATERIAL AS DIRECTED BY THE RESIDENT ENGINEER.
2. REMOVAL OF THE DETERIORATED CONCRETE WILL NOT BE PAID SEPARATELY BUT WILL BE CONSIDERED INCIDENTAL TO THE UNIT BID PRICE FOR ITEM 516.10. THE ADDITIONAL PLUG JOINT MATERIAL BELOW THE DESIGN DEPTH REQUIRED TO REPLACE THE DETERIORATED CONCRETE WILL BE CONSIDERED INCIDENTAL TO THE UNIT BID PRICE FOR THE ITEM 516.10.
3. THE STEEL PLATE IN THE ASPHALTIC PLUG JOINT MAY BE OMITTED ONLY IF THE REPAIRED SURFACE IS SO IRREGULAR IT WILL CAUSE VERTICAL MOVEMENT AND IT IS DIRECTED BY THE RESIDENT ENGINEER.

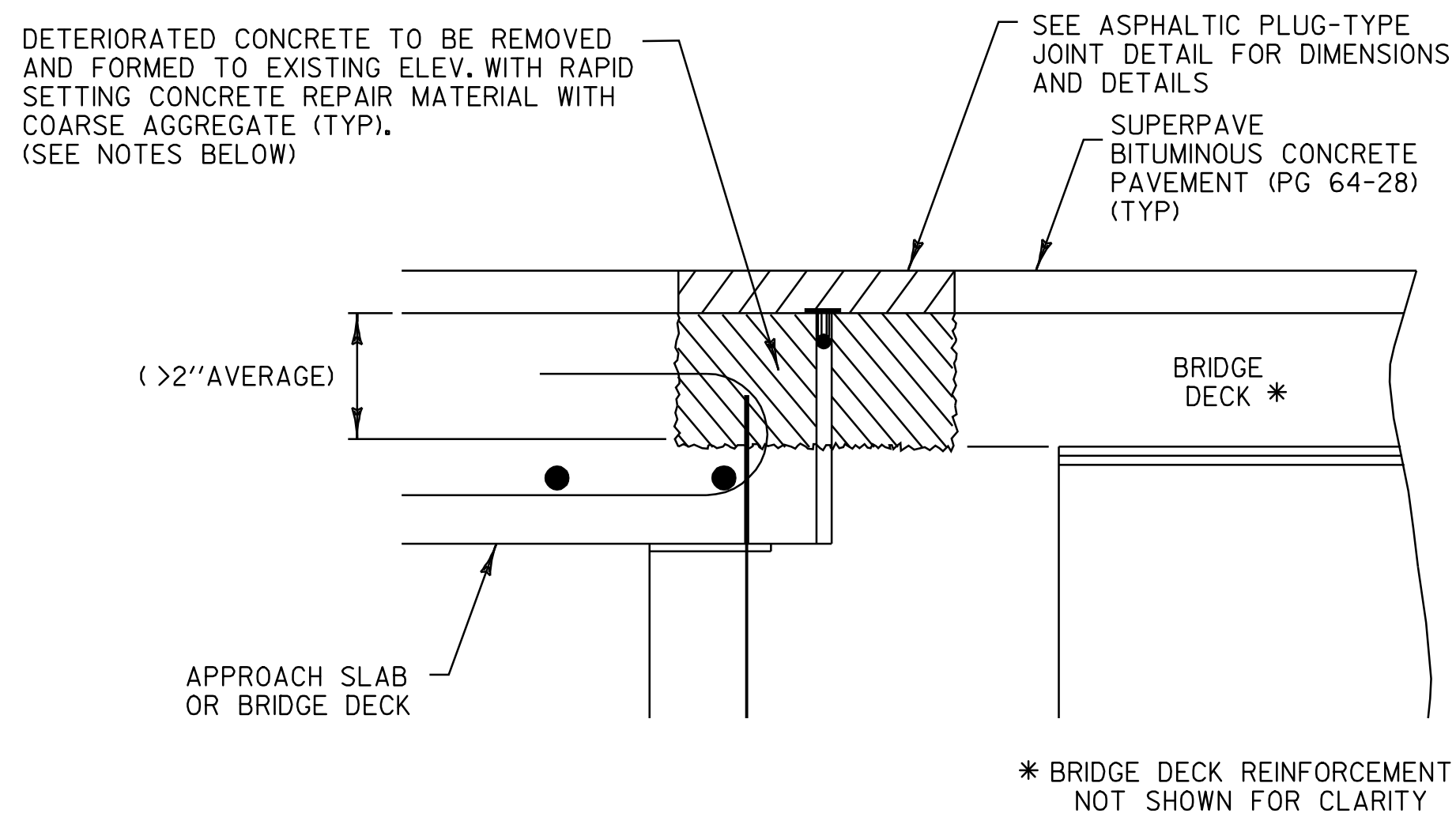

ASPHALTIC PLUG-TYPE JOINT DETAIL REMOVAL OF >2" DETERIORATED CONCRETE

NOTES:

1. UPON ENCOUNTERING GREATER THAN 2" AVERAGE OF DETERIORATED CONCRETE, THE CONTRACTOR SHALL REMOVE THE DETERIORATED MATERIAL AND REPLACE IT WITH RAPID SETTING CONCRETE REPAIR MATERIAL WITH COARSE AGGREGATE.
2. REMOVAL OF THE DETERIORATED CONCRETE WILL BE INCLUDED IN THE UNIT BID PRICE FOR ITEM 580.20 RAPID SETTING CONCRETE REPAIR MATERIAL WITH COARSE AGGREGATE.
3. THE STEEL PLATE IN THE ASPHALTIC PLUG JOINT MAY BE OMITTED ONLY IF THE REPAIRED SURFACE IS SO IRREGULAR IT WILL CAUSE VERTICAL MOVEMENT AND IT IS DIRECTED BY THE RESIDENT ENGINEER.



NOT TO SCALE

ASPHALTIC PLUG JOINT DETAILS SHEET

PROJECT NAME: BARRE CITY
 PROJECT NUMBER: STP 280(I)S

FILE NAME: p08d022.dgn
 PROJECT LEADER: JLL
 DESIGNED BY: STANTEC
 IPARM FILE: p08d022apjs.i

PLOT DATE: 14-APR-2010
 DRAWN BY: STANTEC
 CHECKED BY: JLL
 SHEET 4 OF 19

**BEGIN STP 2801(1)S U.S. ROUTE 302
BARRE CITY STA 0+00=MM 0.000
BERLIN/BARRE TOWN LINE**

646.20 4 INCH WHITE LINE
STA. 0+00.0 TO 5+00.0, SOLID LT & RT
(INCLUDING EDGE LINE BREAKS OR RADII FOR TOWN HIGHWAYS)

646.21 4 INCH YELLOW LINE
STA. 0+00.0 TO 5+00.0, SOLID LT & RT
(INCLUDING CENTERLINE BREAKS FOR TOWN HIGHWAYS)

646.602 TEMPORARY 4 INCH WHITE LINE, PAINT
STA. 0+00.0 TO 5+00.0, SOLID LT & RT
(INCLUDING EDGE LINE BREAKS OR RADII FOR TOWN HIGHWAYS)

646.612 TEMPORARY 4 INCH YELLOW LINE, PAINT
STA. 0+00.0 TO 5+00.0, SOLID LT & RT
(INCLUDING CENTERLINE BREAKS FOR TOWN HIGHWAYS)

604.40 CHANGING ELEVATION OF DI, CB, OR MH
STA. 0+04.5, LT
STA. 3+00.7, LT

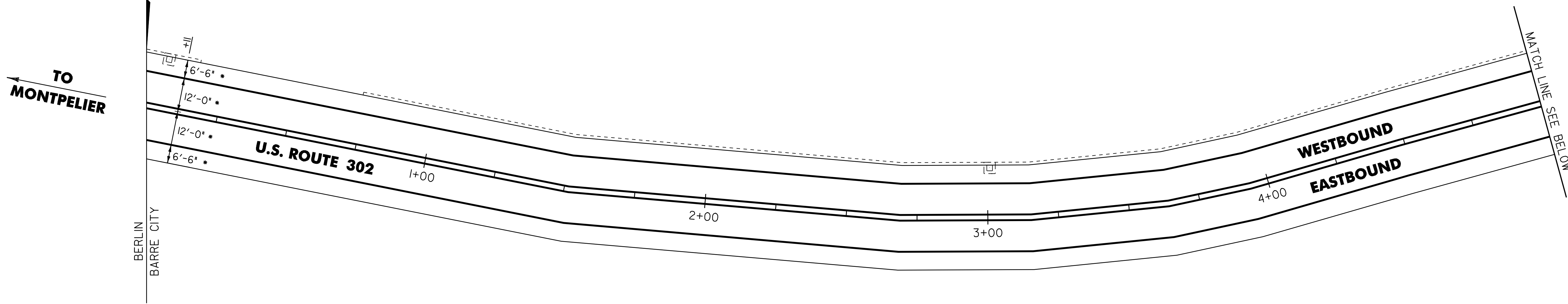

* MATCH EXISTING PAVEMENT MARKINGS

646.20 4 INCH WHITE LINE
STA. 5+00.0 TO 10+00.0, SOLID LT & RT
(INCLUDING EDGE LINE BREAKS OR RADII FOR TOWN HIGHWAYS)

646.21 4 INCH YELLOW LINE
STA. 5+00.0 TO 10+00.0, SOLID LT & RT
(INCLUDING CENTERLINE BREAKS FOR TOWN HIGHWAYS)

646.602 TEMPORARY 4 INCH WHITE LINE, PAINT
STA. 5+00.0 TO 10+00.0, SOLID LT & RT
(INCLUDING EDGE LINE BREAKS OR RADII FOR TOWN HIGHWAYS)

646.612 TEMPORARY 4 INCH YELLOW LINE, PAINT
STA. 5+00.0 TO 10+00.0, SOLID LT & RT
(INCLUDING CENTERLINE BREAKS FOR TOWN HIGHWAYS)

604.40 CHANGING ELEVATION OF DI, CB, OR MH
STA. 6+86.4, LT
~~STA. 8+77.3, LT~~

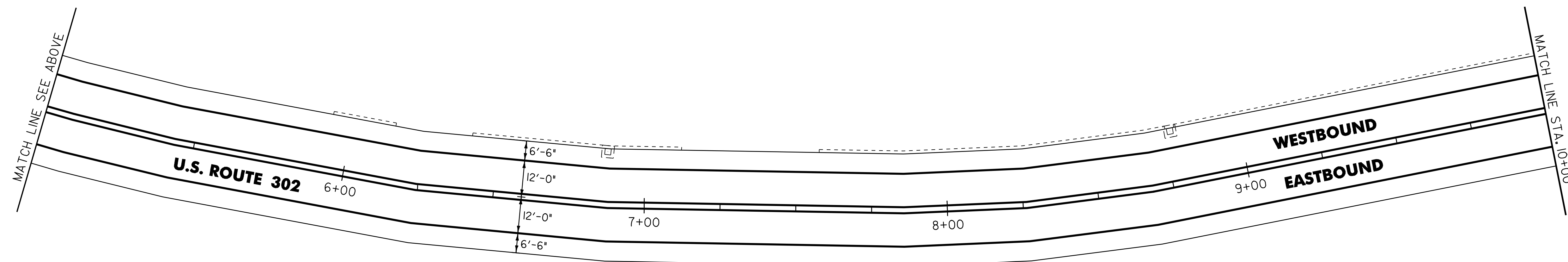

NOT TO SCALE



PROJECT LAYOUT SHEET #1	PROJECT NAME: BARRE CITY	PLOT DATE: 14-APR-2010
	PROJECT NUMBER: STP 2801(1)S	DRAWN BY: STANTEC
	FILE NAME: p08d022.dgn	CHECKED BY: JLL
	DESIGNED BY: STANTEC	SHEET 8 OF 19
	IPARM FILE: p08d022i01.i	

646.20 4 INCH WHITE LINE
 STA. 10+00.0 TO 15+00.0, SOLID LT & RT
 (INCLUDING EDGE LINE BREAKS OR RADII FOR TOWN HIGHWAYS)

646.21 4 INCH YELLOW LINE
 STA. 10+00.0 TO 15+00.0, SOLID LT & RT
 (INCLUDING CENTERLINE BREAKS FOR TOWN HIGHWAYS)

646.602 TEMPORARY 4 INCH WHITE LINE, PAINT
 STA. 10+00.0 TO 15+00.0, SOLID LT & RT
 (INCLUDING EDGE LINE BREAKS OR RADII FOR TOWN HIGHWAYS)

646.612 TEMPORARY 4 INCH YELLOW LINE, PAINT
 STA. 10+00.0 TO 15+00.0, SOLID LT & RT
 (INCLUDING CENTERLINE BREAKS FOR TOWN HIGHWAYS)

604.40 CHANGING ELEVATION OF DI, CB OR MH
 STA. 14+43.6, LT

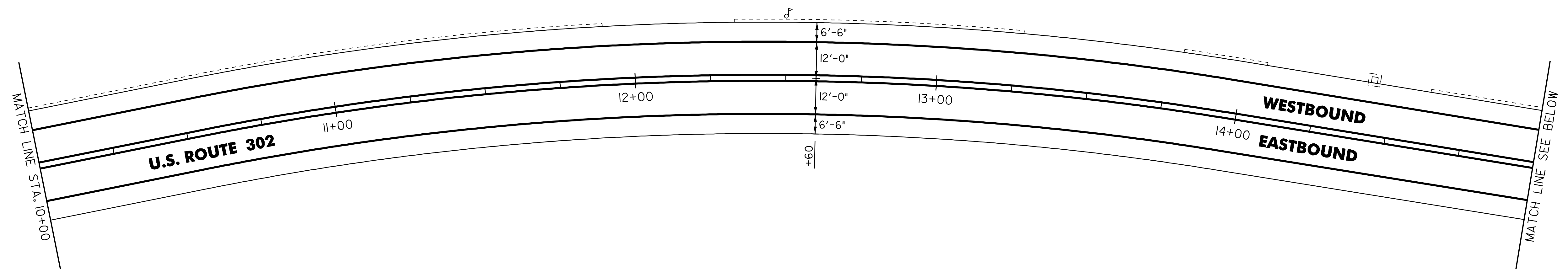

646.20 4 INCH WHITE LINE
 STA. 15+00.0 TO 20+00.0, SOLID LT & RT
 (INCLUDING EDGE LINE BREAKS OR RADII FOR TOWN HIGHWAYS)

646.21 4 INCH YELLOW LINE
 STA. 15+00.0 TO 20+00.0, SOLID LT & RT
 (INCLUDING CENTERLINE BREAKS FOR TOWN HIGHWAYS)

646.602 TEMPORARY 4 INCH WHITE LINE, PAINT
 STA. 15+00.0 TO 20+00.0, SOLID LT & RT
 (INCLUDING EDGE LINE BREAKS OR RADII FOR TOWN HIGHWAYS)

646.612 TEMPORARY 4 INCH YELLOW LINE, PAINT
 STA. 15+00.0 TO 20+00.0, SOLID LT & RT
 (INCLUDING CENTERLINE BREAKS FOR TOWN HIGHWAYS)

604.40 CHANGING ELEVATION OF DI, CB OR MH
 -STA. 15+90.3, LT
 STA. 17+39.6, LT
 -STA. 19+36.0, LT

604.47 C.I. GRATE W/ FRAME, TYPE D
 17+39.6 LT

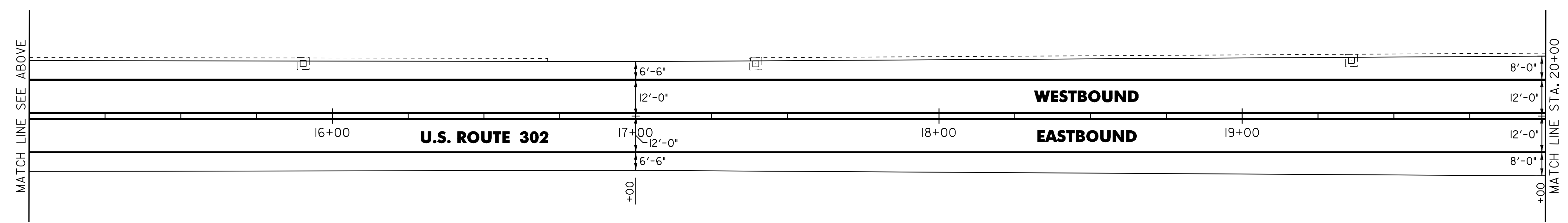

NOT TO SCALE



PROJECT LAYOUT SHEET #2

PROJECT NAME: BARRE CITY	PLOT DATE: 14-APR-2010
PROJECT NUMBER: STP 280(I)S	DRAWN BY: STANTEC
FILE NAME: p08d022.dgn	CHECKED BY: JLL
PROJECT LEADER: JLL	SHEET 9 OF 19
DESIGNED BY: STANTEC	
IPARM FILE: p08d022i02.i	

646.20 4 INCH WHITE LINE
 STA. 20+00.0 TO 25+00.0, SOLID LT & RT
 (INCLUDING EDGE LINE BREAKS OR RADII FOR TOWN HIGHWAYS)

646.21 4 INCH YELLOW LINE
 STA. 20+00.0 TO 25+00.0, SOLID LT & RT
 (INCLUDING CENTERLINE BREAKS FOR TOWN HIGHWAYS)

646.602 TEMPORARY 4 INCH WHITE LINE, PAINT
 STA. 20+00.0 TO 25+00.0, SOLID LT & RT
 (INCLUDING EDGE LINE BREAKS OR RADII FOR TOWN HIGHWAYS)

646.612 TEMPORARY 4 INCH YELLOW LINE, PAINT
 STA. 20+00.0 TO 25+00.0, SOLID LT & RT
 (INCLUDING CENTERLINE BREAKS FOR TOWN HIGHWAYS)

604.40 CHANGING ELEVATION OF DI, CB OR MH
~~STA. 21+87.0, LT~~
~~STA. 24+08.9, LT~~

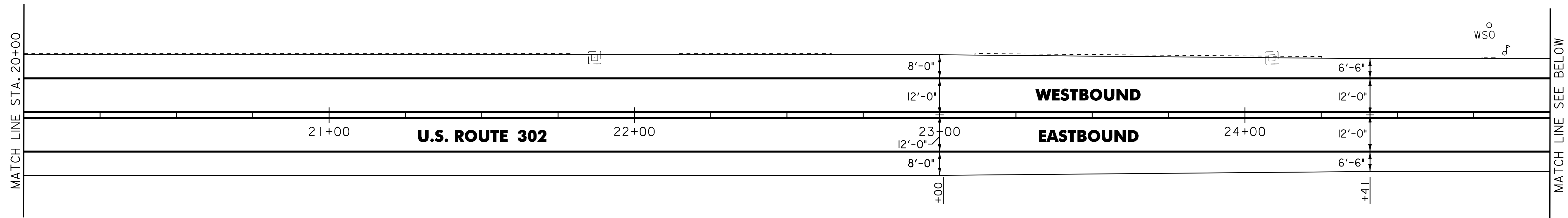

646.20 4 INCH WHITE LINE
 STA. 25+00.0 TO 30+00.0, SOLID LT & RT
 (INCLUDING EDGE LINE BREAKS OR RADII FOR TOWN HIGHWAYS)

646.21 4 INCH YELLOW LINE
 STA. 25+00.0 TO 30+00.0, SOLID LT & RT
 (INCLUDING CENTERLINE BREAKS FOR TOWN HIGHWAYS)

646.602 TEMPORARY 4 INCH WHITE LINE, PAINT
 STA. 25+00.0 TO 30+00.0, SOLID LT & RT
 (INCLUDING EDGE LINE BREAKS OR RADII FOR TOWN HIGHWAYS)

646.612 TEMPORARY 4 INCH YELLOW LINE, PAINT
 STA. 25+00.0 TO 30+00.0, SOLID LT & RT
 (INCLUDING CENTERLINE BREAKS FOR TOWN HIGHWAYS)

604.40 CHANGING ELEVATION OF DI, CB OR MH
 STA. 25+58.3, LT
~~STA. 26+57.2, LT~~
~~STA. 27+09.2, LT~~
~~STA. 28+08.5, LT~~
~~STA. 29+30.8, LT~~

604.47 C.I. GRATE W/ FRAME, TYPE D
 25+58.3 LT

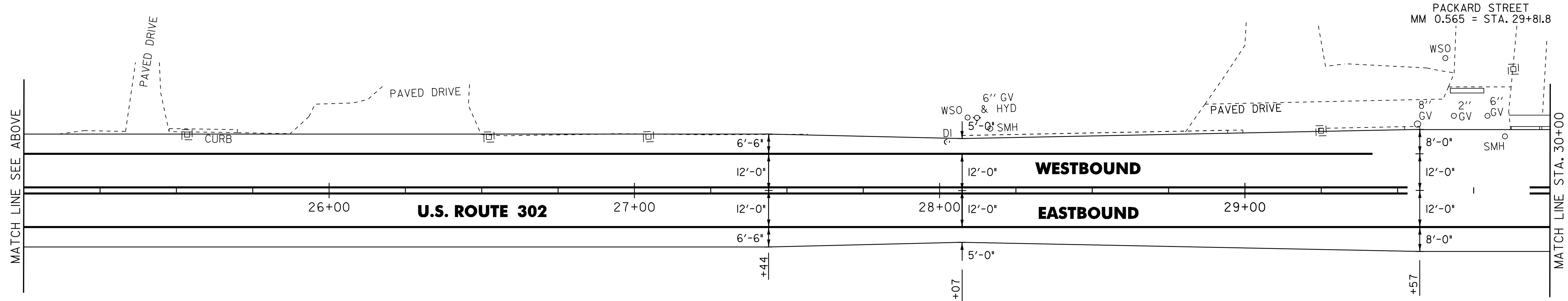

604.42 CHANGING ELEVATION OF SEWER MANHOLES
 STA. 29+91.5, LT



NOT TO SCALE

PROJECT LAYOUT SHEET #3

PROJECT NAME: BARRE CITY	PLOT DATE: 14-APR-2010
PROJECT NUMBER: STP 280(I)S	DRAWN BY: STANTEC
FILE NAME: p08d022.dgn	CHECKED BY: JLL
DESIGNED BY: STANTEC	SHEET 10 OF 19
IPARM FILE: p08d022i03.i	

646.20 4 INCH WHITE LINE
 STA. 30+00.0 TO 35+00.0, SOLID LT & RT
 (INCLUDING EDGE LINE BREAKS OR RADII FOR TOWN HIGHWAYS)

646.21 4 INCH YELLOW LINE
 STA. 30+00.0 TO 35+00.0, SOLID LT & RT
 (INCLUDING CENTERLINE BREAKS FOR TOWN HIGHWAYS)

646.602 TEMPORARY 4 INCH WHITE LINE, PAINT
 STA. 30+00.0 TO 35+00.0, SOLID LT & RT
 (INCLUDING EDGE LINE BREAKS OR RADII FOR TOWN HIGHWAYS)

646.612 TEMPORARY 4 INCH YELLOW LINE, PAINT
 STA. 30+00.0 TO 35+00.0, SOLID LT & RT
 (INCLUDING CENTERLINE BREAKS FOR TOWN HIGHWAYS)

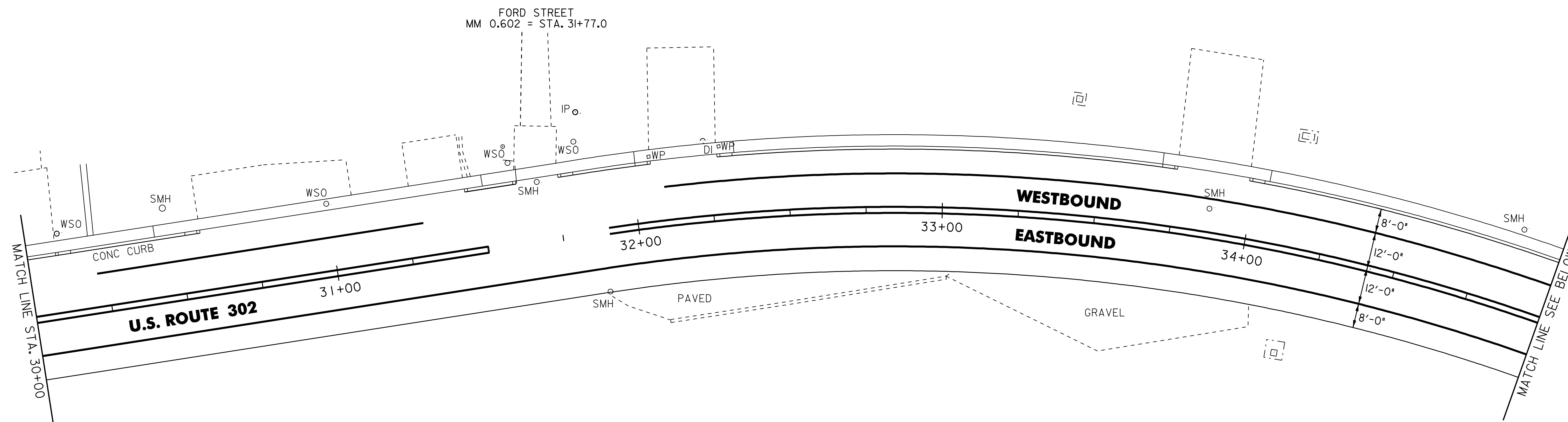

604.42 CHANGING ELEVATION OF SEWER MANHOLES
~~STA. 31+74.6, LT~~
~~STA. 31+95.5, RT~~
~~STA. 33+97.0, LT~~

646.20 4 INCH WHITE LINE
 STA. 35+00.0 TO 40+00.0, SOLID LT & RT
 (INCLUDING EDGE LINE BREAKS OR RADII FOR TOWN HIGHWAYS)

646.21 4 INCH YELLOW LINE
 STA. 35+00.0 TO 40+00.0, SOLID LT & RT
 STA. 35+05.0 TO 38+50.0, DOUBLE SOLID RT

646.23 8 INCH YELLOW LINE
 STA. 35+05.0 TO 38+50.0, SOLID DIAGONALS RT

646.602 TEMPORARY 4 INCH WHITE LINE, PAINT
 STA. 35+00.0 TO 40+00.0, SOLID LT & RT
 (INCLUDING EDGE LINE BREAKS OR RADII FOR TOWN HIGHWAYS)

646.612 TEMPORARY 4 INCH YELLOW LINE, PAINT
 STA. 35+00.0 TO 40+00.0, SOLID LT & RT
 STA. 35+05.0 TO 38+50.0, DOUBLE SOLID RT

646.652 TEMPORARY 8 INCH YELLOW LINE, PAINT
 STA. 35+05.0 TO 38+50.0, SOLID DIAGONALS RT

646.30 LETTER OR SYMBOL
 STA. 38+54.0, RT - ARROW
 STA. 39+08.3, RT - "ONLY"
 STA. 39+62.5, RT - ARROW

675.50 REMOVING SIGNS
 AS SHOWN - I

646.692 TEMPORARY LETTER OR SYMBOL, PAINT
 STA. 38+54.0, RT - ARROW
 STA. 39+62.5, RT - ARROW

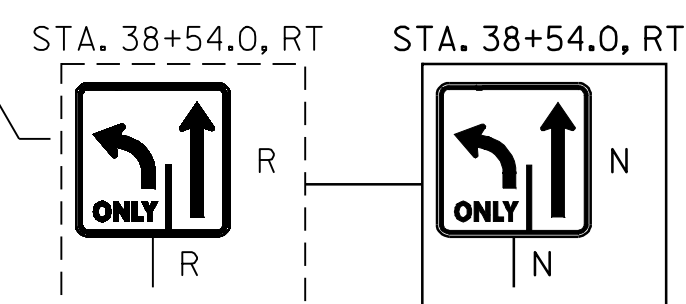
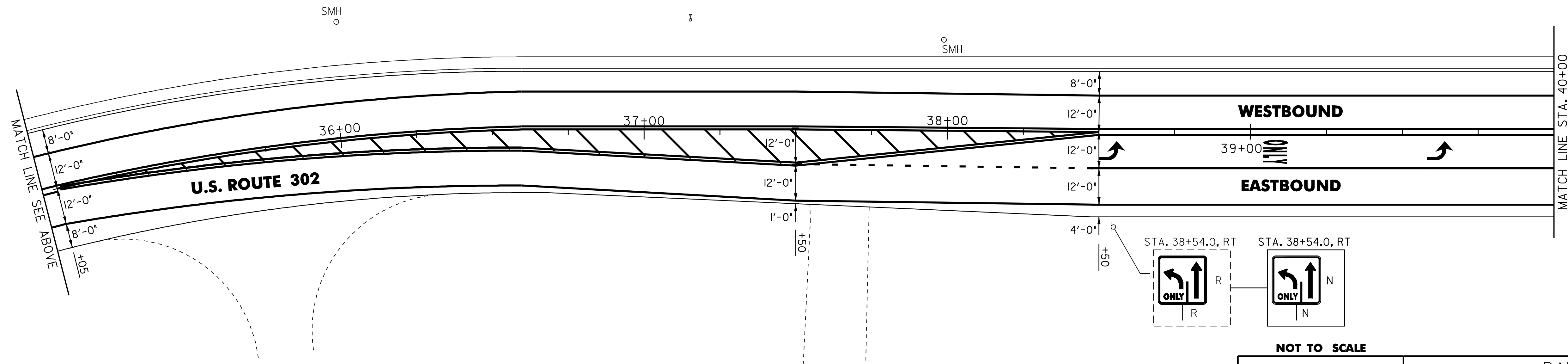

NOT TO SCALE



PROJECT LAYOUT SHEET #4

PROJECT NAME: BARRE CITY	PLOT DATE: 14-APR-2010
PROJECT NUMBER: STP 280(I)S	DRAWN BY: STANTEC
FILE NAME: p08d022.dgn	CHECKED BY: JLL
DESIGNED BY: STANTEC	SHEET 11 OF 19
IPARM FILE: p08d022i04.i	

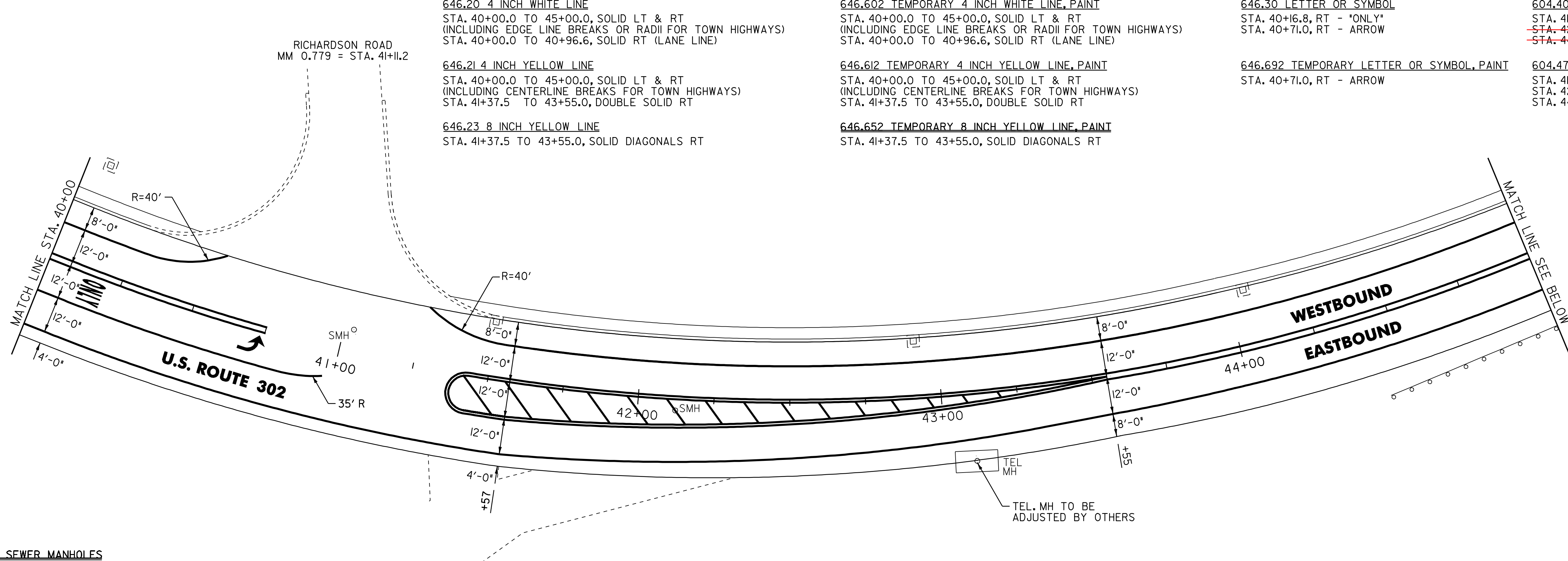

646.20 4 INCH WHITE LINE
 STA. 40+00.0 TO 45+00.0, SOLID LT & RT
 (INCLUDING EDGE LINE BREAKS OR RADII FOR TOWN HIGHWAYS)
 STA. 40+00.0 TO 40+96.6, SOLID RT (LANE LINE)

646.21 4 INCH YELLOW LINE
 STA. 40+00.0 TO 45+00.0, SOLID LT & RT
 (INCLUDING CENTERLINE BREAKS FOR TOWN HIGHWAYS)
 STA. 41+37.5 TO 43+55.0, DOUBLE SOLID RT

646.23 8 INCH YELLOW LINE
 STA. 41+37.5 TO 43+55.0, SOLID DIAGONALS RT

646.602 TEMPORARY 4 INCH WHITE LINE, PAINT
 STA. 40+00.0 TO 45+00.0, SOLID LT & RT
 (INCLUDING EDGE LINE BREAKS OR RADII FOR TOWN HIGHWAYS)
 STA. 40+00.0 TO 40+96.6, SOLID RT (LANE LINE)

646.612 TEMPORARY 4 INCH YELLOW LINE, PAINT
 STA. 40+00.0 TO 45+00.0, SOLID LT & RT
 (INCLUDING CENTERLINE BREAKS FOR TOWN HIGHWAYS)
 STA. 41+37.5 TO 43+55.0, DOUBLE SOLID RT

646.652 TEMPORARY 8 INCH YELLOW LINE, PAINT
 STA. 41+37.5 TO 43+55.0, SOLID DIAGONALS RT

646.30 LETTER OR SYMBOL
 STA. 40+16.8, RT - "ONLY"
 STA. 40+71.0, RT - ARROW

646.692 TEMPORARY LETTER OR SYMBOL, PAINT
 STA. 40+71.0, RT - ARROW

604.40 CHANGING ELEVATION OF DI, CB, OR MH
 STA. 41+50.5, LT
~~STA. 42+92.0, LT~~
~~STA. 44+05.5, LT~~

604.47 CAST IRON GRATE WITH FRAME, TYPE D
 STA. 41+50.5, LT
 STA. 42+92.0, LT
 STA. 44+05.5, LT

604.42 CHANGING ELEVATION OF SEWER MANHOLES
 STA. 41+17.6, LT
 STA. 42+22.6, RT

646.20 4 INCH WHITE LINE
 STA. 45+00.0 TO 50+00.0, SOLID LT & RT
 (INCLUDING EDGE LINE BREAKS OR RADII FOR TOWN HIGHWAYS)

646.602 TEMPORARY 4 INCH WHITE LINE, PAINT
 STA. 45+00.0 TO 50+00.0, SOLID LT & RT
 (INCLUDING EDGE LINE BREAKS OR RADII FOR TOWN HIGHWAYS)

646.21 4 INCH YELLOW LINE
 STA. 45+00.0 TO 50+00.0, SOLID LT & RT
 (INCLUDING CENTERLINE BREAKS FOR TOWN HIGHWAYS)

646.612 TEMPORARY 4 INCH YELLOW LINE, PAINT
 STA. 45+00.0 TO 50+00.0, SOLID LT & RT
 (INCLUDING CENTERLINE BREAKS FOR TOWN HIGHWAYS)

604.42 CE SMH
47+03 LT

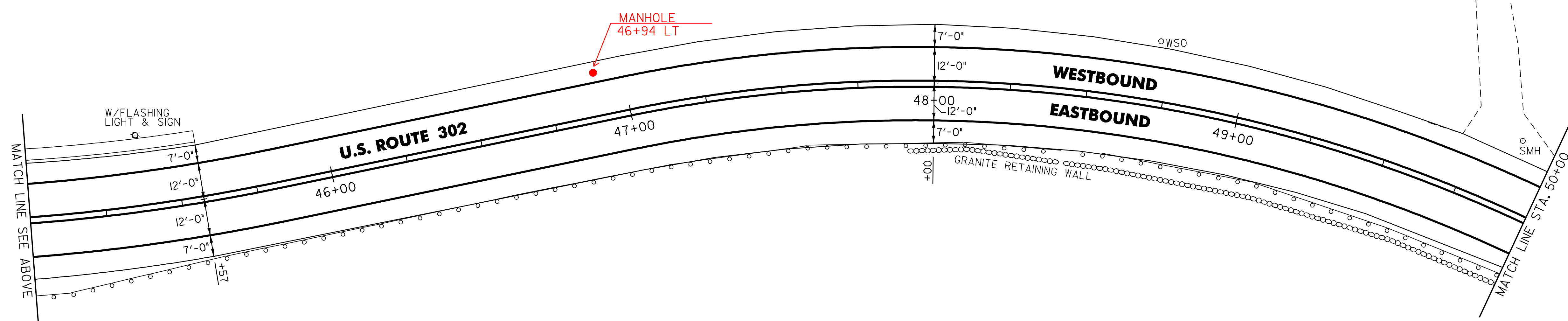

NOT TO SCALE

PROJECT LAYOUT SHEET #5	PROJECT NAME: BARRE CITY	PLOT DATE: 14-APR-2010
	PROJECT NUMBER: STP 280(I)S	DRAWN BY: STANTEC
	FILE NAME: p08d022.dgn	CHECKED BY: JLL
	DESIGNED BY: STANTEC	SHEET 12 OF 19
	IPARM FILE: p08d022105.dgn	

646.20 4 INCH WHITE LINE
 STA. 50+00.0 TO 55+00.0, SOLID LT & RT
 (INCLUDING EDGE LINE BREAKS OR RADII FOR TOWN HIGHWAYS)
 STA. 54+64.8 TO 55+00.0, SOLID LT (LANE LINE)

646.602 TEMPORARY 4 INCH WHITE LINE, PAINT
 STA. 50+00.0 TO 55+00.0, SOLID LT & RT
 (INCLUDING EDGE LINE BREAKS OR RADII FOR TOWN HIGHWAYS)
 STA. 54+64.8 TO 55+00.0, SOLID LT (LANE LINE)

646.30 LETTER OR SYMBOL
 STA. 54+72.8, LT - ARROW

646.31 CROSSWALK MARKING
 STA. 54+60.8, LT/RT

675.50 REMOVING SIGNS
 AS SHOWN - 2

646.21 4 INCH YELLOW LINE
 STA. 50+00.0 TO 51+66.2, SOLID LT & RT
 STA. 51+66.2 TO 54+02.3, DOUBLE SOLID LT
 STA. 51+66.2 TO 55+00.0, DOUBLE SOLID RT
 (INCLUDING CENTERLINE BREAKS FOR TOWN HIGHWAYS)

646.612 TEMPORARY 4 INCH YELLOW LINE, PAINT
 STA. 50+00.0 TO 51+66.2, SOLID LT & RT
 STA. 51+66.2 TO 54+02.3, DOUBLE SOLID LT
 STA. 51+66.2 TO 55+00.0, DOUBLE SOLID RT
 (INCLUDING CENTERLINE BREAKS FOR TOWN HIGHWAYS)

646.692 TEMPORARY LETTER OR SYMBOL, PAINT
 STA. 54+72.8, LT - ARROW

646.702 TEMPORARY CROSSWALK MARKING, PAINT
 STA. 54+60.8, LT/RT

646.23 8 INCH YELLOW LINE
 STA. 51+66.2 TO 54+02.3, SOLID DIAGONALS LT & RT

646.652 TEMPORARY 8 INCH YELLOW LINE, PAINT
 STA. 51+66.2 TO 54+02.3, SOLID DIAGONALS LT & RT

629.20 ADJUST ELEVATION OF VALVE BOX
 STA. 54+30.7, RT

646.20 4 INCH WHITE LINE
 STA. 55+00.0 TO 60+00.0, SOLID LT & RT
 (INCLUDING EDGE LINE BREAKS OR RADII FOR TOWN HIGHWAYS)
 STA. 55+00.0 TO 55+30.0, SOLID LT (LANE LINE)
 STA. 55+30.0 TO 56+46.0, DASHED LT (LANE LINE)

646.21 4 INCH YELLOW LINE
 STA. 55+00.0 TO 57+50.0, DOUBLE SOLID RT
 (INCLUDING CENTERLINE BREAKS FOR TOWN HIGHWAYS)
 STA. 55+86.0 TO 57+50.0, DOUBLE SOLID LT
 STA. 57+50.0 TO 60+00.0, SOLID LT & RT
 (INCLUDING CENTERLINE BREAKS FOR TOWN HIGHWAYS)

646.602 TEMPORARY 4 INCH WHITE LINE, PAINT
 STA. 55+00.0 TO 60+00.0, SOLID LT & RT
 (INCLUDING EDGE LINE BREAKS OR RADII FOR TOWN HIGHWAYS)
 STA. 55+00.0 TO 55+30.0, SOLID LT (LANE LINE)
 STA. 55+30.0 TO 56+46.0, DASHED LT (LANE LINE)

646.612 TEMPORARY 4 INCH YELLOW LINE, PAINT
 STA. 55+00.0 TO 57+50.0, DOUBLE SOLID RT
 (INCLUDING CENTERLINE BREAKS FOR TOWN HIGHWAYS)
 STA. 55+86.0 TO 57+50.0, DOUBLE SOLID LT
 STA. 57+50.0 TO 60+00.0, SOLID LT & RT
 (INCLUDING CENTERLINE BREAKS FOR TOWN HIGHWAYS)

646.652 TEMPORARY 8 INCH YELLOW LINE, PAINT
 STA. 55+86.0 TO 57+50.0, SOLID DIAGONALS LT & RT

646.30 LETTER OR SYMBOL
 STA. 55+26.0, LT - ARROW

646.692 TEMPORARY LETTER OR SYMBOL, PAINT
 STA. 55+26.0, LT - ARROW

675.50 REMOVING SIGNS
 AS SHOWN - 1

604.40 CHANGING ELEVATION OF DI, CB, OR MH
~~STA. 55+34.5, RT~~
~~STA. 55+60.0, LT~~
~~STA. 55+77.0, C~~
~~STA. 55+84.4, LT~~
~~STA. 57+81.3, LT~~
~~STA. 58+77.0, RT~~
~~STA. 58+94.2, LT~~
~~STA. 59+02.0, RT (-2)~~

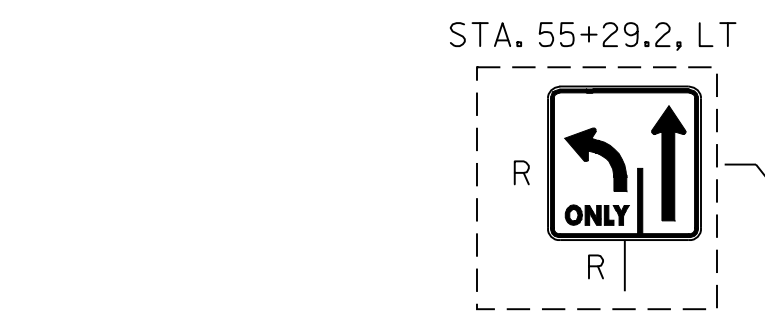

SIXTH STREET
 MM 1.054 = STA. 55+67.6

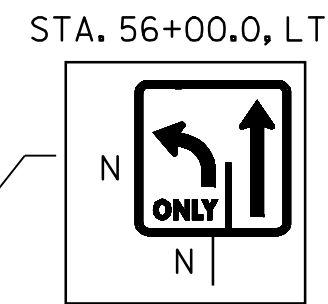

FIFTH STREET
 MM 1.101 = STA. 58+11.5

STA. 59+59.7, LT
 EXISTING DRAINAGE
 STRUCTURE TO BE
 RETAINED AS-IS

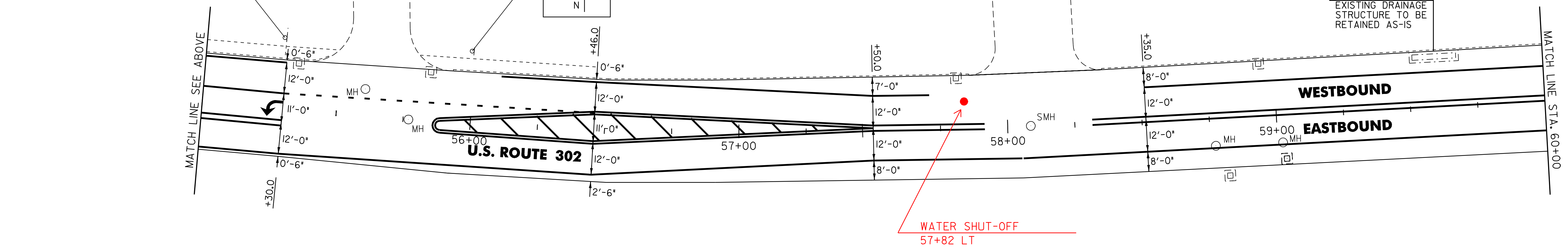

WATER SHUT-OFF
 57+82 LT

604.42 CHANGING ELEVATION OF SEWER MANHOLES
 STA. 58+08.6, C



NOT TO SCALE

PROJECT LAYOUT SHEET #6

PROJECT NAME: BARRE CITY
 PROJECT NUMBER: STP 280(I)S

FILE NAME: p08d022.dgn
 PROJECT LEADER: JLL
 DESIGNED BY: STANTEC
 IPARM FILE: p08d022i06.I

PLOT DATE: 14-APR-2010
 DRAWN BY: STANTEC
 CHECKED BY: JLL
 SHEET 13 OF 19

646.20 4 INCH WHITE LINE
 STA. 60+00.0 TO 65+00.0, SOLID LT & RT
 (INCLUDING EDGE LINE BREAKS OR RADII FOR TOWN HIGHWAYS)

646.602 TEMPORARY 4 INCH WHITE LINE, PAINT
 STA. 60+00.0 TO 65+00.0, SOLID LT & RT
 (INCLUDING EDGE LINE BREAKS OR RADII FOR TOWN HIGHWAYS)

604.40 CHANGING ELEVATION OF DI, CB, OR MH
~~STA. 60+02.3, RT~~
~~STA. 60+52.4, LT~~
~~STA. 60+76.0, LT~~
~~STA. 61+00.0, RT~~
~~STA. 61+73.1, LT~~
~~STA. 61+99.5, RT~~
~~STA. 63+24.4, RT~~
~~STA. 64+22.5, RT (2)~~
~~STA. 64+33.0, LT~~
60+72 LT

604.42 CHANGING ELEVATION OF SEWER MANHOLES
 STA. 60+02.3, RT
 STA. 62+93.0, RT
61+73 LT
60+64 RT
62+83 RT
63+24 RT
64+24 RT

646.21 4 INCH YELLOW LINE
 STA. 60+00.0 TO 65+00.0, SOLID LT & RT
 (INCLUDING CENTERLINE BREAKS FOR TOWN HIGHWAYS)

646.612 TEMPORARY 4 INCH YELLOW LINE, PAINT
 STA. 60+00.0 TO 65+00.0, SOLID LT & RT
 (INCLUDING CENTERLINE BREAKS FOR TOWN HIGHWAYS)

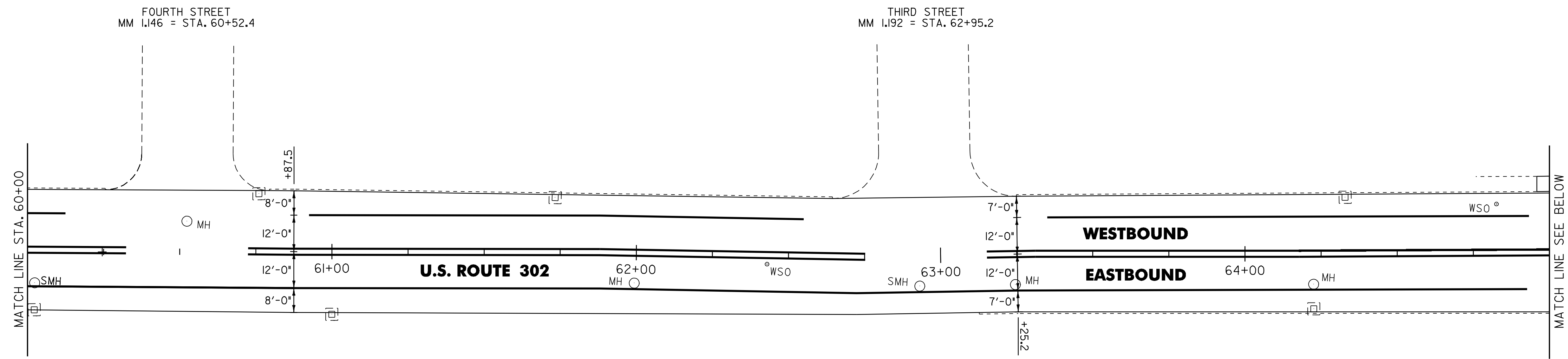

629.20 ADJUST ELEVATION OF VALVE BOX
 STA. 62+43.0, RT
 STA. 64+82.7, LT

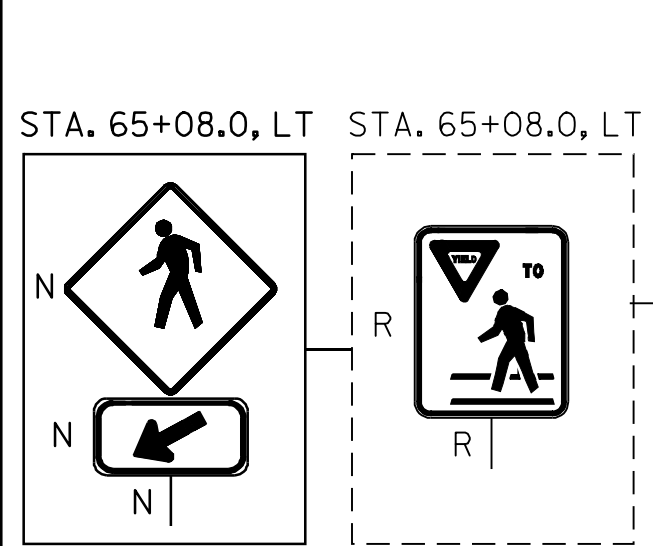

646.20 4 INCH WHITE LINE
 STA. 65+00.0 TO 70+00.0, SOLID LT & RT
 (INCLUDING EDGE LINE BREAKS OR RADII FOR TOWN HIGHWAYS)

646.21 4 INCH YELLOW LINE
 STA. 65+00.0 TO 68+58.0, SOLID LT & RT
 (INCLUDING CENTERLINE BREAKS FOR TOWN HIGHWAYS)

646.23 8 INCH YELLOW LINE
 STA. 69+32.2 TO 70+00.0, SOLID DIAGONALS LT & RT

646.81 PAINTED CURB
 STA. 67+92 TO 68+10, LT

675.60 ERECTING SALVAGED SIGNS
 AS SHOWN - 1

616.28 CAST IN PLACE CONCRETE CURB, TYPE B
 STA. 67+87 TO 68+01, RT
 STA. 67+92 TO 68+10, LT

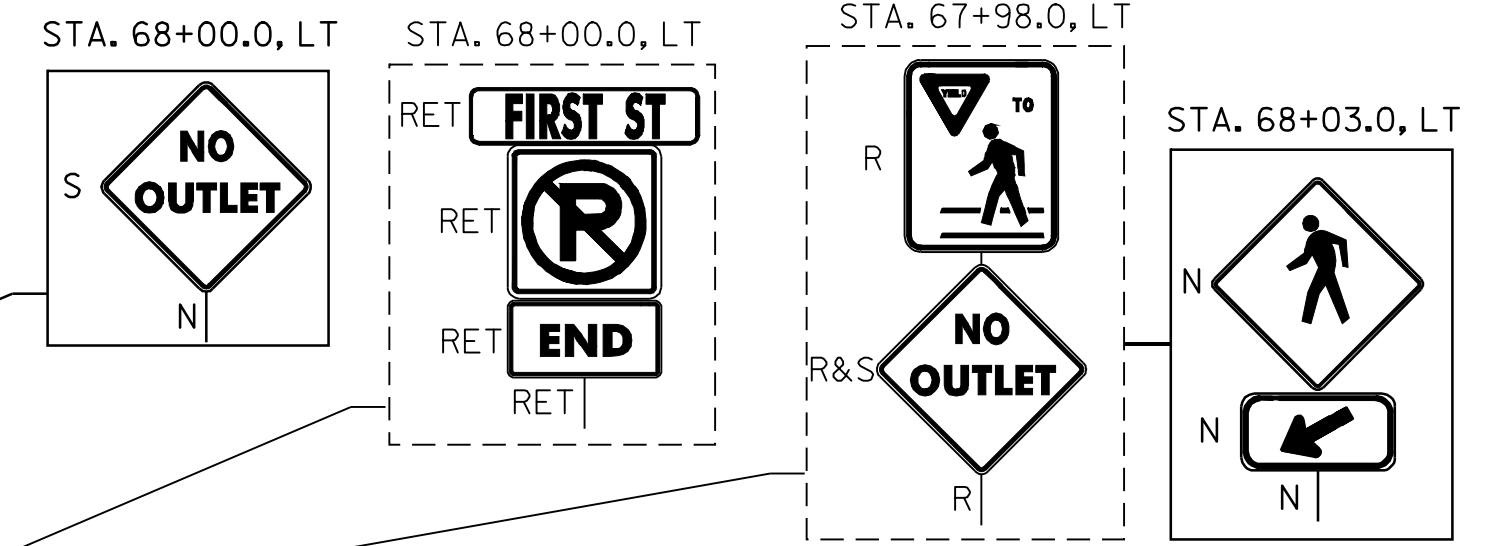

646.602 TEMPORARY 4 INCH WHITE LINE, PAINT
 STA. 65+00.0 TO 70+00.0, SOLID LT & RT
 (INCLUDING EDGE LINE BREAKS OR RADII FOR TOWN HIGHWAYS)

646.612 TEMPORARY 4 INCH YELLOW LINE, PAINT
 STA. 65+00.0 TO 68+58.0, SOLID LT & RT
 (INCLUDING CENTERLINE BREAKS FOR TOWN HIGHWAYS)

646.652 TEMPORARY 8 INCH YELLOW LINE, PAINT
 STA. 69+32.2 TO 70+00.0, SOLID DIAGONALS LT & RT

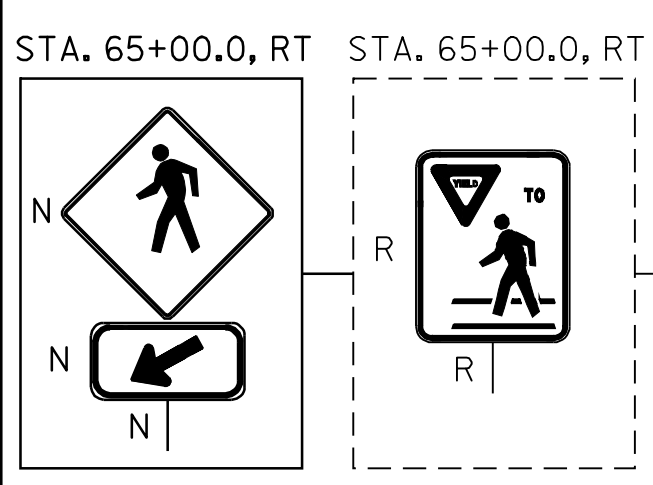
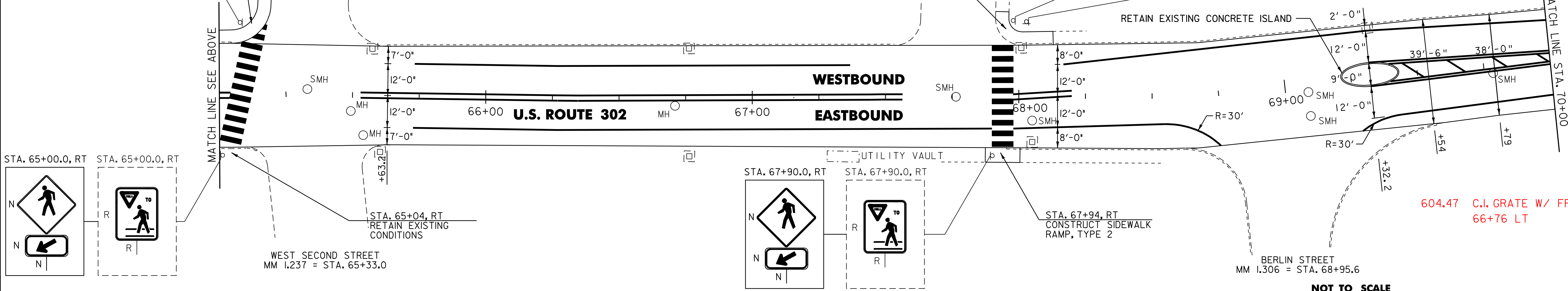

646.31 CROSSWALK MARKING
 STA. 65+04.0, RT TO 65+13.0, LT
 STA. 67+93.8, LT/RT

675.50 REMOVING SIGNS
 AS SHOWN - 5

604.40 CHANGING ELEVATION OF DI, CB, OR MH
~~STA. 65+49.4, RT~~
~~STA. 65+54.2, RT~~
~~STA. 65+57.2, LT~~
~~STA. 66+71.0, RT~~
~~STA. 66+76.3, LT~~
~~STA. 68+01.0, LT~~
~~STA. 68+05.0, RT~~
~~STA. 69+33.0, LT~~

604.42 CHANGING ELEVATION OF SEWER MANHOLES
~~STA. 65+33.0, LT~~
~~STA. 67+76.4, C~~
~~STA. 68+05.0, RT~~
~~STA. 69+08.6, RT (2)~~
~~STA. 69+78.3, RT~~
65+93 LT
65+54 RT
65+49 RT
66+71 CL

604.47 C.I. GRATE W/ FRAME, TYPE D
 66+76 LT



NOT TO SCALE

PROJECT LAYOUT SHEET #7

PROJECT NAME: BARRE CITY	PLOT DATE: 14-APR-2010
PROJECT NUMBER: STP 280(I)S	DRAWN BY: STANTEC
FILE NAME: p08d022.dgn	CHECKED BY: JLL
DESIGNED BY: STANTEC	SHEET 14 OF 19
IPARM FILE: p08d022107.I	

646.20 4 INCH WHITE LINE
 STA. 80+00.0 TO 85+00.0, SOLID LT & RT
 (INCLUDING EDGE LINE BREAKS OR RADII FOR TOWN HIGHWAYS)

646.21 4 INCH YELLOW LINE
 STA. 80+00.0 TO 85+00.0, SOLID LT & RT
 (INCLUDING CENTERLINE BREAKS FOR TOWN HIGHWAYS)

646.81 PAINTED CURB
 STA. 84+86.0 TO 85+00.0, RT

646.602 TEMPORARY 4 INCH WHITE LINE, PAINT
 STA. 80+00.0 TO 85+00.0, SOLID LT & RT
 (INCLUDING EDGE LINE BREAKS OR RADII FOR TOWN HIGHWAYS)

646.612 TEMPORARY 4 INCH YELLOW LINE, PAINT
 STA. 80+00.0 TO 85+00.0, SOLID LT & RT
 (INCLUDING CENTERLINE BREAKS FOR TOWN HIGHWAYS)

675.50 REMOVING SIGNS
 AS SHOWN - 1

646.31 CROSSWALK MARKING
 STA. 84+74.1, LT (BROOK ST.)
 STA. 84+90.0, LT TO 84+96.0, RT

646.702 TEMPORARY CROSSWALK MARKING, PAINT
 STA. 84+74.1, LT (BROOK ST.)
 STA. 84+90.0, LT TO 84+96.0, RT

646.26 24 INCH STOP BAR
 STA. 84+74.1, LT (BROOK ST. - ON EXIST. PAVEMENT)

646.682 TEMPORARY 24 INCH STOP BAR, PAINT
 STA. 84+74.1, LT (BROOK ST. - ON EXIST. PAVEMENT)

604.40 CHANGING ELEVATION OF DI, CB, OR MH
~~STA. 80+06.9, LT~~
~~STA. 80+06.9, RT~~
~~STA. 80+43.5, LT~~
~~STA. 83+10.2, RT~~
~~STA. 83+14.3, LT~~
~~STA. 83+36.6, LT~~
~~STA. 83+36.6, RT~~
~~STA. 83+95.0, RT~~
~~STA. 84+14.4, LT~~
~~STA. 84+38.0, LT~~
~~STA. 84+90.6, LT~~

604.47 CAST IRON GRATE WITH FRAME, TYPE D
 STA. 83+95.0, RT
 83+36 LT
 83+45 LT

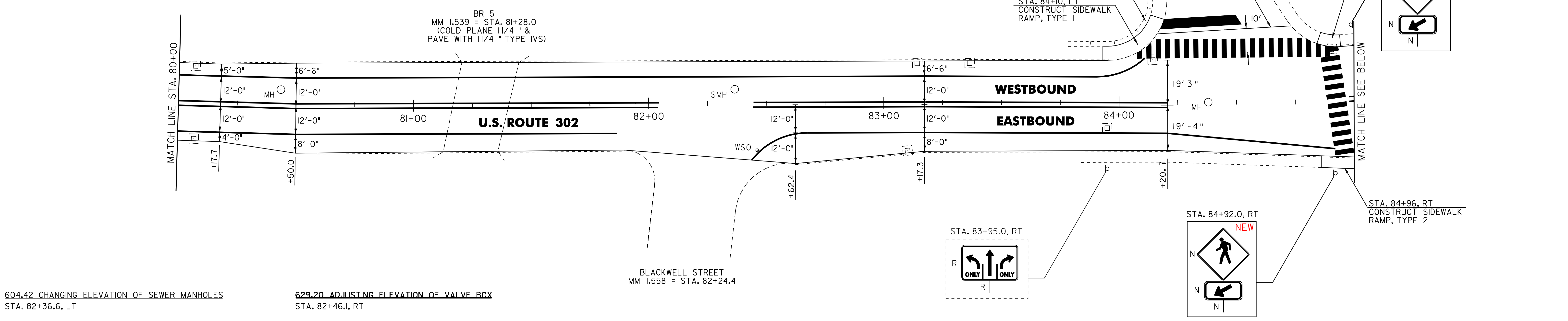

646.20 4 INCH WHITE LINE
 STA. 85+00.0 TO 86+91.0, SOLID LT & RT
 STA. 85+00.0 TO 86+20.0, DOTTED RT (LANE LINE)
 STA. 85+00.0 TO 86+91.0, SOLID RT (LANE LINE)
 STA. 86+20.0 TO 86+91.0, SOLID RT (LANE LINE)
 STA. 88+17.5 TO 89+43.5, SOLID LT & RT
 STA. 88+17.5 TO 89+43.5, SOLID LT (LANE LINE)
 STA. 88+17.5 TO 89+43.5, SOLID LT (LANE LINE)

(INCLUDING EDGE LINE BREAKS OR RADII FOR TOWN HIGHWAYS AND CROSSWALKS)

646.21 4 INCH YELLOW LINE
 STA. 85+00.0 TO 86+91.0, DOUBLE SOLID LT
 STA. 88+17.5 TO 89+43.5, DOUBLE SOLID RT
 (INCLUDING CENTERLINE BREAKS FOR TOWN HIGHWAYS AND CROSSWALKS)

646.81 PAINTED CURB
 STA. 85+00.0, TO 85+06.0, RT
 STA. 86+90.0, TO 87+10.0, RT

646.602 TEMPORARY 4 INCH WHITE LINE, PAINT
 STA. 85+00.0 TO 86+91.0, SOLID LT & RT
 STA. 85+00.0 TO 86+20.0, DOTTED RT (LANE LINE)
 STA. 85+00.0 TO 86+91.0, SOLID RT (LANE LINE)
 STA. 86+20.0 TO 86+91.0, SOLID RT (LANE LINE)
 STA. 88+17.5 TO 89+43.5, SOLID LT & RT
 STA. 88+17.5 TO 89+43.5, SOLID LT (LANE LINE)
 STA. 88+17.5 TO 89+43.5, SOLID LT (LANE LINE)

(INCLUDING EDGE LINE BREAKS OR RADII FOR TOWN HIGHWAYS AND CROSSWALKS)

646.612 TEMPORARY 4 INCH YELLOW LINE, PAINT
 STA. 85+00.0 TO 86+91.0, DOUBLE SOLID LT
 STA. 88+17.5 TO 89+43.5, DOUBLE SOLID RT
 (INCLUDING CENTERLINE BREAKS FOR TOWN HIGHWAYS AND CROSSWALKS)

675.50 REMOVING SIGNS
 AS SHOWN - 2

646.30 LETTER OR SYMBOL
 STA. 86+82.0, C - ARROW
 STA. 86+82.0, RT - ARROW
 STA. 88+26.5, LT - ARROW
 STA. 88+26.5, C - ARROW

646.692 TEMPORARY LETTER OR SYMBOL, PAINT
 STA. 86+82.0, C - ARROW
 STA. 86+82.0, RT - ARROW
 STA. 88+26.5, LT - ARROW
 STA. 88+26.5, C - ARROW

646.31 CROSSWALK MARKING
 STA. 87+00.0, RT TO 87+11.0, LT
 STA. 87+51.0, RT (VT 62)
 STA. 87+57.4, LT (VT 14-ON EXISTING PAVEMENT)
 STA. 88+07.0, LT/RT

646.702 TEMPORARY CROSSWALK MARKING, PAINT
 STA. 87+00.0, RT TO 87+11.0, LT
 STA. 87+51.0, RT (VT 62)
 STA. 87+57.4, LT (VT 14-ON EXISTING PAVEMENT)
 STA. 88+07.0, LT/RT

604.47 CAST IRON GRATE WITH FRAME, TYPE D
 STA. 85+82.2, LT
 STA. 88+39.5, LT
 STA. 88+39.5, RT
 STA. 89+25.0, RT
 STA. 89+41.0, LT
 89+30 RT
 85+26 RT

604.40 CHANGING ELEVATION OF DI, CB, OR MH
 STA. 85+26.0, RT
 STA. 85+82.2, LT
 STA. 87+95.0, LT
 STA. 88+39.5, LT
 STA. 88+39.5, RT
 STA. 89+25.0, RT
 STA. 89+30.0, RT
 STA. 89+41.0, LT

646.602 TEMPORARY 4 INCH WHITE LINE, PAINT
 STA. 85+00.0 TO 86+91.0, SOLID LT & RT
 STA. 85+00.0 TO 86+20.0, DOTTED RT (LANE LINE)
 STA. 85+00.0 TO 86+91.0, SOLID RT (LANE LINE)
 STA. 86+20.0 TO 86+91.0, SOLID RT (LANE LINE)
 STA. 88+17.5 TO 89+43.5, SOLID LT & RT
 STA. 88+17.5 TO 89+43.5, SOLID LT (LANE LINE)
 STA. 88+17.5 TO 89+43.5, SOLID LT (LANE LINE)

(INCLUDING EDGE LINE BREAKS OR RADII FOR TOWN HIGHWAYS AND CROSSWALKS)

646.612 TEMPORARY 4 INCH YELLOW LINE, PAINT
 STA. 85+00.0 TO 86+91.0, DOUBLE SOLID LT
 STA. 88+17.5 TO 89+43.5, DOUBLE SOLID RT
 (INCLUDING CENTERLINE BREAKS FOR TOWN HIGHWAYS AND CROSSWALKS)

675.50 REMOVING SIGNS
 AS SHOWN - 2

646.30 LETTER OR SYMBOL
 STA. 86+82.0, C - ARROW
 STA. 86+82.0, RT - ARROW
 STA. 88+26.5, LT - ARROW
 STA. 88+26.5, C - ARROW

646.692 TEMPORARY LETTER OR SYMBOL, PAINT
 STA. 86+82.0, C - ARROW
 STA. 86+82.0, RT - ARROW
 STA. 88+26.5, LT - ARROW
 STA. 88+26.5, C - ARROW

646.31 CROSSWALK MARKING
 STA. 87+00.0, RT TO 87+11.0, LT
 STA. 87+51.0, RT (VT 62)
 STA. 87+57.4, LT (VT 14-ON EXISTING PAVEMENT)
 STA. 88+07.0, LT/RT

646.702 TEMPORARY CROSSWALK MARKING, PAINT
 STA. 87+00.0, RT TO 87+11.0, LT
 STA. 87+51.0, RT (VT 62)
 STA. 87+57.4, LT (VT 14-ON EXISTING PAVEMENT)
 STA. 88+07.0, LT/RT

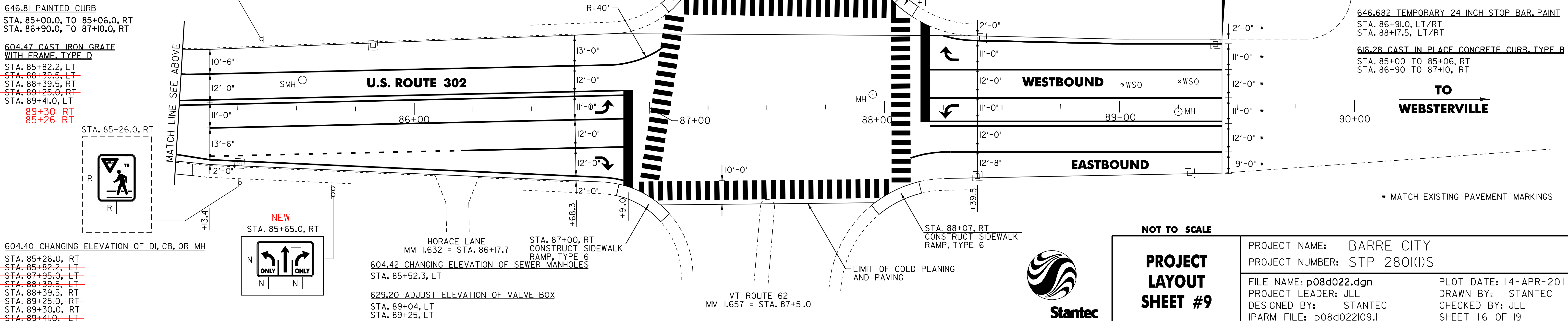

END STP 2801(1)S U.S. ROUTE 302
BARRE CITY STA 89+43.5=MM 1.694
MATCH THE CITY'S PROJECT

646.26 24 INCH STOP BAR
 STA. 86+91.0, LT/RT
 STA. 88+17.5, LT/RT

646.682 TEMPORARY 24 INCH STOP BAR, PAINT
 STA. 86+91.0, LT/RT
 STA. 88+17.5, LT/RT

616.28 CAST IN PLACE CONCRETE CURB, TYPE B
 STA. 85+00 TO 85+06, RT
 STA. 86+90 TO 87+10, RT



NOT TO SCALE

PROJECT LAYOUT SHEET #9

PROJECT NAME: BARRE CITY
 PROJECT NUMBER: STP 2801(1)S

FILE NAME: p08d022.dgn
 PROJECT LEADER: JLL
 DESIGNED BY: STANTEC
 IPARM FILE: p08d022109.1

PLOT DATE: 14-APR-2010
 DRAWN BY: STANTEC
 CHECKED BY: JLL
 SHEET 16 OF 19

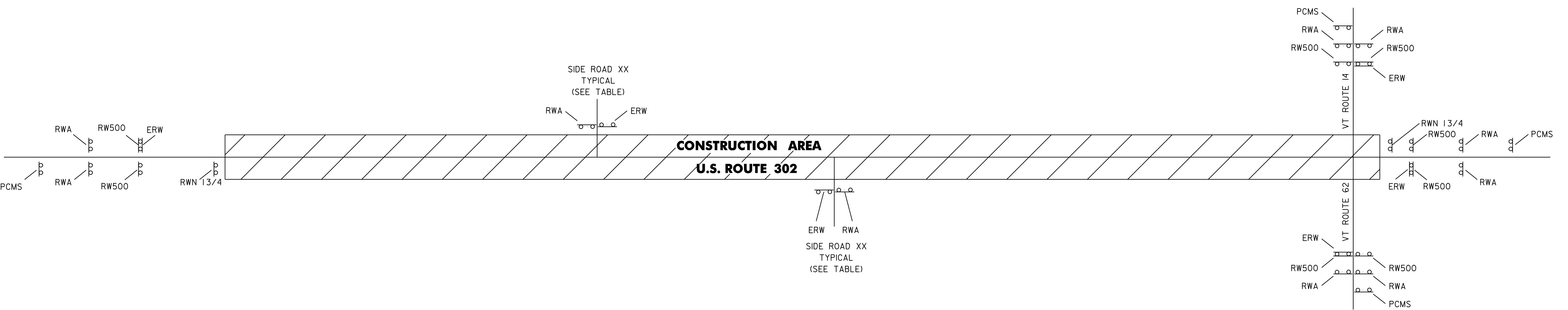

SEE VTrans STANDARD E-100 AND E-100A FOR SIGN PLACEMENT.

LOCATION	ERW	RW500	RWA	RWN 13/4	PCMS
BARRE CITY					
BEGIN PROJECT	1	2	2	1	1
PACKARD ST.	1		1		
FORD ST.	1		1		
RICHARDSON RD.	1		1		
WILLEY ST.	1		1		
SIXTH ST.	1		1		
FIFTH ST.	1		1		
FOURTH ST.	1		1		
THIRD ST.	1		1		
SECOND ST.	1		1		
W. SECOND ST.	1		1		
FIRST ST.	1		1		
BERLIN ST.	1		1		
BECKLEY ST.	1		1		
N. SEMINARY ST.	1		1		
BLACKWELL ST.	1		1		
BROOK ST.	1		1		
HORACE LN.	1		1		
MAPLE ST. (VT ROUTE 14)	1	2	2		1
VT ROUTE 62	1	2	2		1
END PROJECT	1	2	2	1	1
TOTAL	19	8	25	2	4

LEGEND

- ERW = END ROAD WORK
- RW500 = ROAD WORK 500 FT
- RWA = ROAD WORK AHEAD
- RWN 13/4 = ROAD WORK NEXT 1 3/4 MILES
- PCMS = PORTABLE CHANGEABLE MESSAGE SIGN

NOTE: PAYMENT FOR TEMPORARY CONSTRUCTION SIGNING WILL BE INCLUDED IN THE UNIT PRICE BID FOR CONTRACT ITEM 641.10



TEMPORARY TRAFFIC CONTROL PLAN	PROJECT NAME: BARRE CITY	PLOT DATE: 14-APR-2010 15:51
	PROJECT NUMBER: STP 280(K)S	DRAWN BY: STANTEC
	DESIGNED BY: STANTEC	CHECKED BY: JLL
	IPARM FILE: p08d022cas.l	SHEET 19 OF 19