

646.20 4 INCH WHITE LINE
 STA. 50+00.0 TO 55+00.0, SOLID LT & RT
 (INCLUDING EDGE LINE BREAKS OR RADII FOR TOWN HIGHWAYS)
 STA. 54+64.8 TO 55+00.0, SOLID LT (LANE LINE)

646.602 TEMPORARY 4 INCH WHITE LINE, PAINT
 STA. 50+00.0 TO 55+00.0, SOLID LT & RT
 (INCLUDING EDGE LINE BREAKS OR RADII FOR TOWN HIGHWAYS)
 STA. 54+64.8 TO 55+00.0, SOLID LT (LANE LINE)

646.30 LETTER OR SYMBOL
 STA. 54+72.8, LT - ARROW

646.31 CROSSWALK MARKING
 STA. 54+60.8, LT/RT

675.50 REMOVING SIGNS
 AS SHOWN - 2

646.21 4 INCH YELLOW LINE
 STA. 50+00.0 TO 51+66.2, SOLID LT & RT
 STA. 51+66.2 TO 54+02.3, DOUBLE SOLID LT
 STA. 51+66.2 TO 55+00.0, DOUBLE SOLID RT
 (INCLUDING CENTERLINE BREAKS FOR TOWN HIGHWAYS)

646.612 TEMPORARY 4 INCH YELLOW LINE, PAINT
 STA. 50+00.0 TO 51+66.2, SOLID LT & RT
 STA. 51+66.2 TO 54+02.3, DOUBLE SOLID LT
 STA. 51+66.2 TO 55+00.0, DOUBLE SOLID RT
 (INCLUDING CENTERLINE BREAKS FOR TOWN HIGHWAYS)

646.692 TEMPORARY LETTER OR SYMBOL, PAINT
 STA. 54+72.8, LT - ARROW

646.702 TEMPORARY CROSSWALK MARKING, PAINT
 STA. 54+60.8, LT/RT

646.23 8 INCH YELLOW LINE
 STA. 51+66.2 TO 54+02.3, SOLID DIAGONALS LT & RT

646.652 TEMPORARY 8 INCH YELLOW LINE, PAINT
 STA. 51+66.2 TO 54+02.3, SOLID DIAGONALS LT & RT

629.20 ADJUST ELEVATION OF VALVE BOX
 STA. 54+30.7, RT

646.20 4 INCH WHITE LINE
 STA. 55+00.0 TO 60+00.0, SOLID LT & RT
 (INCLUDING EDGE LINE BREAKS OR RADII FOR TOWN HIGHWAYS)
 STA. 55+00.0 TO 55+30.0, SOLID LT (LANE LINE)
 STA. 55+30.0 TO 56+46.0, DASHED LT (LANE LINE)

646.21 4 INCH YELLOW LINE
 STA. 55+00.0 TO 57+50.0, DOUBLE SOLID RT
 (INCLUDING CENTERLINE BREAKS FOR TOWN HIGHWAYS)
 STA. 55+86.0 TO 57+50.0, DOUBLE SOLID LT
 STA. 57+50.0 TO 60+00.0, SOLID LT & RT
 (INCLUDING CENTERLINE BREAKS FOR TOWN HIGHWAYS)

646.602 TEMPORARY 4 INCH WHITE LINE, PAINT
 STA. 55+00.0 TO 60+00.0, SOLID LT & RT
 (INCLUDING EDGE LINE BREAKS OR RADII FOR TOWN HIGHWAYS)
 STA. 55+00.0 TO 55+30.0, SOLID LT (LANE LINE)
 STA. 55+30.0 TO 56+46.0, DASHED LT (LANE LINE)

646.612 TEMPORARY 4 INCH YELLOW LINE, PAINT
 STA. 55+00.0 TO 57+50.0, DOUBLE SOLID RT
 (INCLUDING CENTERLINE BREAKS FOR TOWN HIGHWAYS)
 STA. 55+86.0 TO 57+50.0, DOUBLE SOLID LT
 STA. 57+50.0 TO 60+00.0, SOLID LT & RT
 (INCLUDING CENTERLINE BREAKS FOR TOWN HIGHWAYS)

646.652 TEMPORARY 8 INCH YELLOW LINE, PAINT
 STA. 55+86.0 TO 57+50.0, SOLID DIAGONALS LT & RT

646.30 LETTER OR SYMBOL
 STA. 55+26.0, LT - ARROW

646.692 TEMPORARY LETTER OR SYMBOL, PAINT
 STA. 55+26.0, LT - ARROW

675.50 REMOVING SIGNS
 AS SHOWN - 1

604.40 CHANGING ELEVATION OF DI, CB, OR MH
~~STA. 55+34.5, RT~~
~~STA. 55+60.0, LT~~
~~STA. 55+77.0, C~~
~~STA. 55+84.4, LT~~
~~STA. 57+81.3, LT~~
~~STA. 58+77.0, RT~~
~~STA. 58+94.2, LT~~
~~STA. 59+02.0, RT (2)~~

STA. 55+29.2, LT

SIXTH STREET
 MM 1.054 = STA. 55+67.6

STA. 56+00.0, LT

FIFTH STREET
 MM 1.101 = STA. 58+11.5

STA. 59+59.7, LT
 EXISTING DRAINAGE
 STRUCTURE TO BE
 RETAINED AS-IS

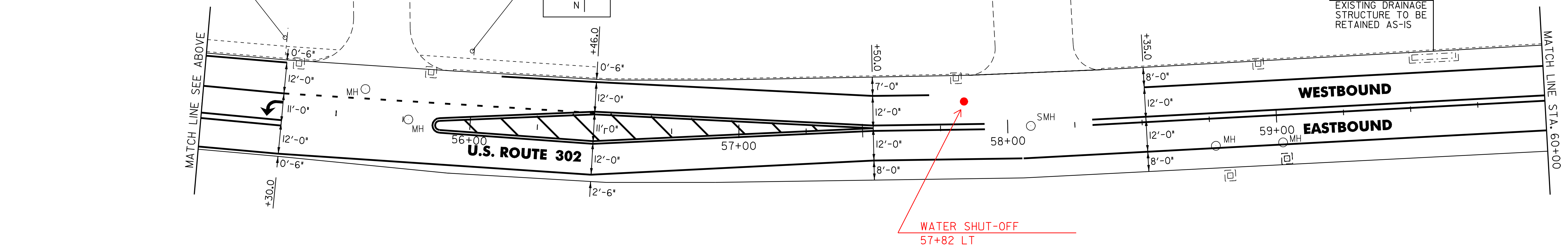

604.42 CHANGING ELEVATION OF SEWER MANHOLES
 STA. 58+08.6, C



NOT TO SCALE

PROJECT LAYOUT SHEET #6

PROJECT NAME: BARRE CITY	PLOT DATE: 14-APR-2010
PROJECT NUMBER: STP 280(I)S	DRAWN BY: STANTEC
FILE NAME: p08d022.dgn	CHECKED BY: JLL
PROJECT LEADER: JLL	SHEET 13 OF 19
DESIGNED BY: STANTEC	
IPARM FILE: p08d022106.I	