

INDEX OF SHEETS

- 1 TITLE SHEET
- 2 PROJECT TYPICAL SHEET
- 3 PAVING DETAIL SHEET
- 4 ASPHALTIC PLUG JOINT DETAILS SHEET
- 5-6 QUANTITY SHEETS
- 7 ITEM DETAIL SUMMARY SHEET
- 8-16 PROJECT LAYOUT SHEETS
- 17-18 TRAFFIC SIGN SUMMARY SHEETS
- 19 TEMPORARY TRAFFIC CONTROL PLAN

VTrans STANDARDS

- C-1 01-03-00
- C-2A 10-14-05
- C-3A 03-10-08
- C-3B 03-10-08
- E-100 01-02-04
- E-100A 01-02-04
- E-101 05-30-03
- E-102 06-30-03
- E-102A 05-01-04
- E-106 03-01-04
- E-108 08-18-95
- E-110 08-08-95
- E-121 08-08-95
- E-145A 12-23-94
- E-145B 12-23-94
- E-152 05-01-04
- E-160 05-20-99
- E-161 08-18-95
- E-162 05-20-99
- E-163 05-20-99
- E-164 05-20-99
- E-191 02-01-99
- E-192 10-12-00
- E-193 08-18-95

STATE OF VERMONT
AGENCY OF TRANSPORTATION

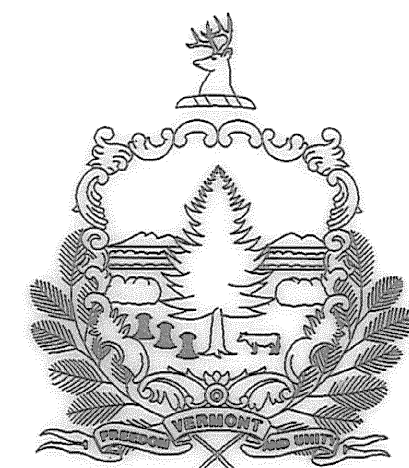

PROPOSED IMPROVEMENT
CITY OF BARRE
COUNTY OF WASHINGTON
U.S. ROUTE 302

BEGINNING AT THE BERLIN/BARRE TOWN LINE AND EXTENDING EASTERLY ALONG
U.S. ROUTE 302 FOR A DISTANCE OF 8,943.5 FEET TO STA. 89+43.50

TOTAL LENGTH OF PROJECT: 8,943.5 FEET = 1.694 MILES
TOTAL LENGTH OF ROADWAY: 8,943.5 FEET = 1.694 MILES

WORK TO BE PERFORMED UNDER THIS PROJECT INCLUDES COLD PLANING, RESURFACING
OF THE EXISTING HIGHWAY, NEW PAVEMENT MARKINGS AND INCIDENTAL ITEMS

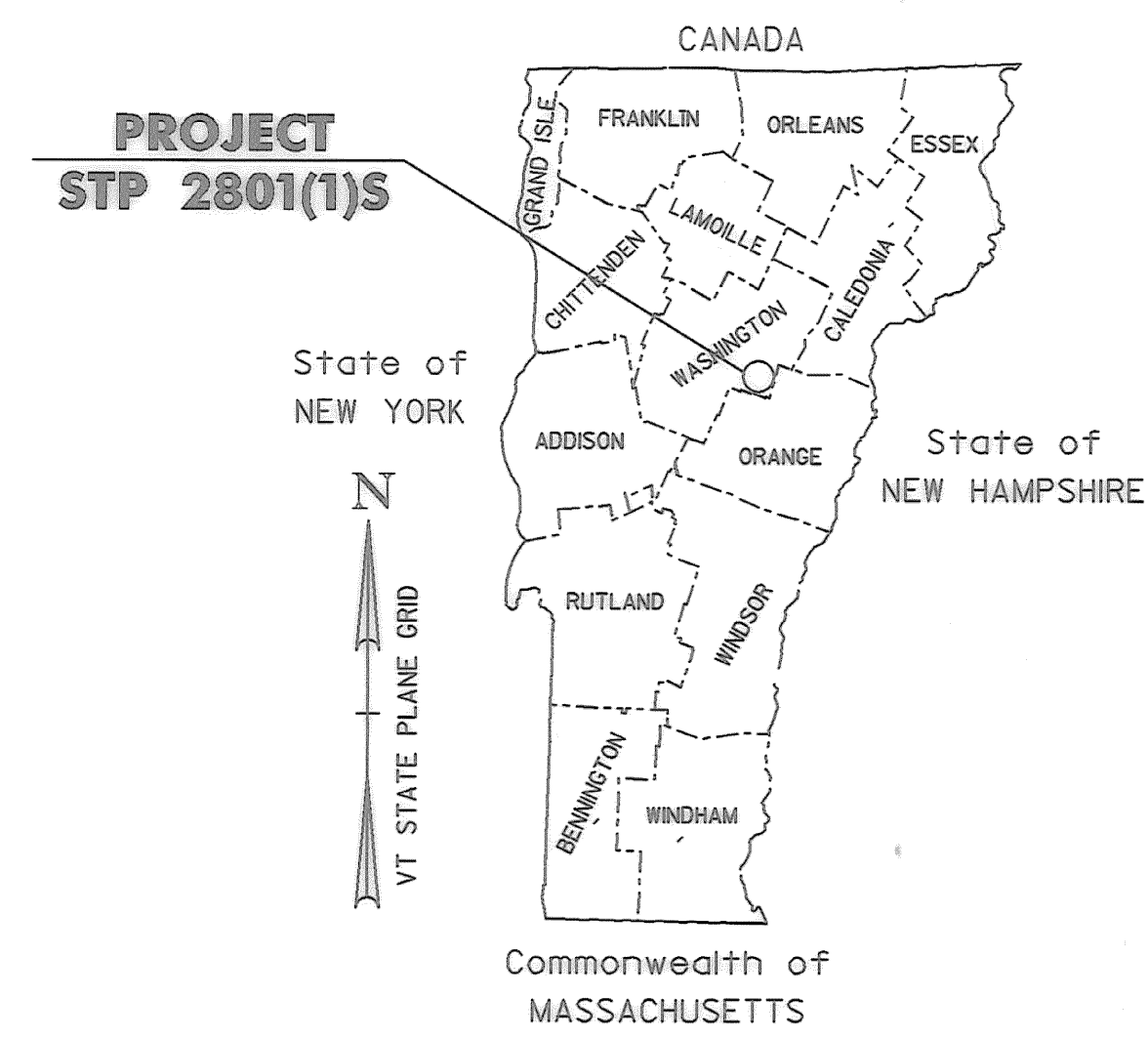

RECORD PLANS

CONTRACTOR: PIKE INDUSTRIES, INC. - BERLIN, VT

RESIDENT ENGINEER: CARL FIELDER

CONSTRUCTION BEGAN: SEPTEMBER 22, 2008

CONSTRUCTION COMPLETE: JUNE 3, 2008

RECORD PLANS BY: CARL FIELDER & C. PIERCE

I HEREBY CERTIFY THAT ALL THE CONSTRUCTION REQUIRED BY THIS SET OF DRAWINGS HAS BEEN ACCOMPLISHED AS INDICATED HEREIN.

BY *Carl Fielder* RESIDENT ENGINEER
DATE *2/19/10*

NOTE: Any further information concerning final quantities, amounts or other details relative to this project may be found at Central Files in the electronic archives.

**BITUMINOUS CONCRETE PAVEMENT
SUPERPAVE MIXTURE DESIGN CRITERIA**

DESIGN LANE/DESIGN LIFE ESALS	3,464,500
DESIGN NUMBER OF GYRATIONS	65
PERFORMANCE GRADED ASPHALT BINDER	64-28

TRAFFIC DATA
U.S. ROUTE 302

LOCATION	AADT		DHV		ESALS	
	2008	2018	2008	2018	2008-2018	2008-2028
BEGIN PROJECT (BERLIN T/L) TO RICHARDSON ROAD	12,100	12,700	1,300	1,300	926,000	2,184,000
RICHARDSON ROAD TO BERLIN STREET	14,900	15,600	1,600	1,600	2,384,000	5,284,000
BERLIN STREET TO BECKLEY STREET	15,500	16,300	1,600	1,700	2,463,000	6,263,000
BECKLEY STREET TO END PROJECT (VT 14/VT 62)	15,700	16,300	1,600	1,700	2,737,000	6,929,000

**BEGIN STP 2801(1)S
U.S. ROUTE 302
STA. 0+00.00**

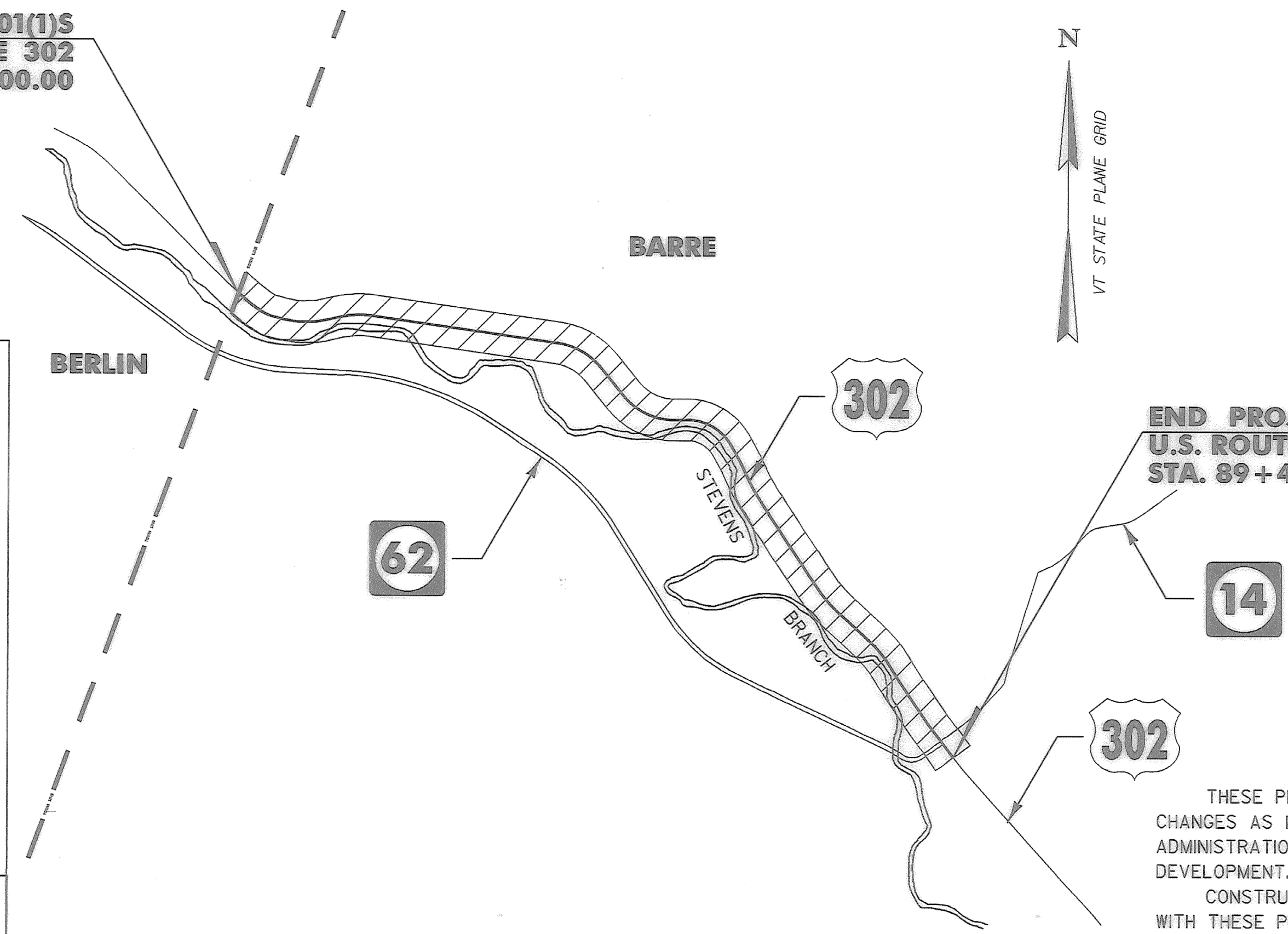

**END PROJECT STP 2801(1)S
U.S. ROUTE 302
STA. 89+43.50**

- UTILITY LEGEND**
- ◊ = EXISTING HYDRANT
 - ◻ = EXISTING DI
 - = EXISTING MANHOLE
 - TEL = EXISTING TELEPHONE MANHOLE
 - ELEC = EXISTING ELECTRIC MANHOLE
 - SMH = EXISTING SEWER MANHOLE
 - WSO = EXISTING WATER SHUTOFF
 - GSO = EXISTING GAS SHUTOFF
 - ♣ = EXISTING MAILBOX
- SIGN LEGEND**
- N = NEW
 - R = REMOVE
 - R&S = REMOVE & SALVAGE
 - S = SALVAGE SIGN
 - RET = RETAIN
 - B-B = BACK TO BACK
 - ⓪ = RETURN TO CITY OF BARRE

SURVEYED BY : N/A
SURVEYED DATE : N/A

DATUM

VERTICAL N/A
HORIZONTAL N/A

- CONVENTIONAL SYMBOLS**
- COUNTY LINE
 - TOWN LINE
 - LIMITS OF ACCESS
 - POINT OF ACCESS
 - FENCE LINE
 - STONE WALL
 - TRAVELED WAY
 - GUARD RAIL
 - RAILROAD
 - SURVEY LINE
 - CULVERT
 - POWER POLE
 - TELEPHONE POLE
 - TREES
 - CONTROL OF ACCESS
 - PROPERTY LINE
 - R.O.W. TAKING LINE
 - SLOPE RIGHTS
 - TOP OF CUT
 - TOE OF SLOPE

THESE PLANS ARE SUBJECT TO SUCH ENGINEERING CHANGES AS MAY BE REQUIRED BY THE FEDERAL HIGHWAY ADMINISTRATION OR THE DIRECTOR OF PROGRAM DEVELOPMENT.

CONSTRUCTION IS TO BE CARRIED ON IN ACCORDANCE WITH THESE PLANS AND THE STANDARD SPECIFICATIONS FOR CONSTRUCTION DATED 2006, AS APPROVED BY THE FEDERAL HIGHWAY ADMINISTRATION ON JUNE 15, 2006 FOR USE ON THIS PROJECT, INCLUDING ALL SUBSEQUENT REVISIONS AND SUCH REVISED SPECIFICATIONS AND SPECIAL PROVISIONS AS ARE INCORPORATED IN THESE PLANS.



NOTE:
RIGHT-OF-WAY LIMITS, IF APPLICABLE, ARE PROVIDED SOLELY FOR THE CONVENIENCE OF THE STATE AND ITS CONTRACTOR DURING THE COURSE OF THIS PAVING PROJECT. ANY REFERENCES TO OFFSETS ON THESE PLANS ARE APPROXIMATE AND SHOULD NOT BE RELIED UPON FOR ANY PURPOSES.

UNLESS OTHERWISE NOTED, ALL DRAWINGS AND DETAILS ON THESE PLANS ARE DRAWN "NOT TO SCALE".

DIRECTOR OF PROGRAM DEVELOPMENT
APPROVED: *Richard J. Filwood* DATE *7-9-08*

PROJECT MANAGER: TED DOMEY

PROJECT NAME: BARRE CITY
PROJECT NUMBER: STP 2801(1)S

SHEET 1 OF 19 SHEETS