

646.402 DURABLE 4 INCH WHITE LINE, THERMOPLASTIC  
 (ALL LINES WILL INCLUDE EDGE LINE BREAKS AND RADII FOR SIDE ROADS)  
 VT ROUTE 128 STA. 26+00 TO 32+00, SOLID LT & RT  
 VT ROUTE 128 STA. 28+21, SOLID LT (TH 33 EDGELINES)  
 VT ROUTE 128 STA. 28+80, SOLID LT (TH 33 EDGELINES)  
 VT ROUTE 128 APPROACH STA. 0+12 TO 1+00, SOLID LT & RT

646.602 TEMPORARY 4 INCH WHITE LINE, PAINT  
 (ALL LINES WILL INCLUDE EDGE LINE BREAKS AND RADII FOR SIDE ROADS)  
 VT ROUTE 128 STA. 26+00 TO 32+00, SOLID LT & RT  
 VT ROUTE 128 STA. 28+21, SOLID LT (TH 33 EDGELINES)  
 VT ROUTE 128 STA. 28+80, SOLID LT (TH 33 EDGELINES)  
 VT ROUTE 128 APPROACH STA. 0+12 TO 1+00, SOLID LT & RT

646.482 DURABLE 24 INCH STOP BAR, THERMOPLASTIC  
 VT ROUTE 128 STA. 28+21, LT (TH 33) - "STOP"  
 VT ROUTE 128 STA. 28+80, LT (TH 33)  
 VT ROUTE 128 APPROACH STA. 0+17, LT

646.682 TEMPORARY 24 INCH STOP BAR, PAINT  
 VT ROUTE 128 STA. 28+21, LT (TH 33) - "STOP"  
 VT ROUTE 128 STA. 28+80, LT (TH 33)  
 VT ROUTE 128 APPROACH STA. 0+17, LT

675.50 REMOVING SIGNS  
 AS SHOWN - 7

675.60 ERECTING SALVAGED SIGNS  
 AS SHOWN - 1

646.412 DURABLE 4 INCH YELLOW LINE, THERMOPLASTIC  
 (ALL LINES WILL INCLUDE C BREAKS FOR SIDE ROADS)  
 VT ROUTE 128 STA. 26+00 TO 32+00, SOLID LT & RT  
 VT ROUTE 128 STA. 28+21, DOUBLE SOLID LT (TH 33)  
 VT ROUTE 128 STA. 28+80, DOUBLE SOLID LT (TH 33)  
 VT ROUTE 128 APPROACH STA. 0+16 TO 1+00, SOLID LT & RT

646.612 TEMPORARY 4 INCH YELLOW LINE, PAINT  
 (ALL LINES WILL INCLUDE C BREAKS FOR SIDE ROADS)  
 VT ROUTE 128 STA. 26+00 TO 32+00, SOLID LT & RT  
 VT ROUTE 128 STA. 28+21, DOUBLE SOLID LT (TH 33)  
 VT ROUTE 128 STA. 28+80, DOUBLE SOLID LT (TH 33)  
 VT ROUTE 128 APPROACH STA. 0+16 TO 1+00, SOLID LT & RT

646.492 DURABLE LETTER OR SYMBOL, THERMOPLASTIC  
 VT ROUTE 128 STA. 28+21, LT (TH 33) - "STOP"  
 VT ROUTE 128 STA. 28+51, RT - "STOP"  
 VT ROUTE 128 STA. 28+80, LT (TH 33) - "STOP"  
 VT ROUTE 128 STA. 28+91, RT - "AHEAD"  
 VT ROUTE 128 APPROACH STA. 0+26, LT - "STOP"

646.692 TEMPORARY LETTER OR SYMBOL, PAINT  
 VT ROUTE 128 STA. 28+21, LT (TH 33) - "STOP"  
 VT ROUTE 128 STA. 28+51, RT - "STOP"  
 VT ROUTE 128 STA. 28+80, LT (TH 33) - "STOP"  
 VT ROUTE 128 STA. 28+91, RT - "AHEAD"  
 VT ROUTE 128 APPROACH STA. 0+26, LT - "STOP"

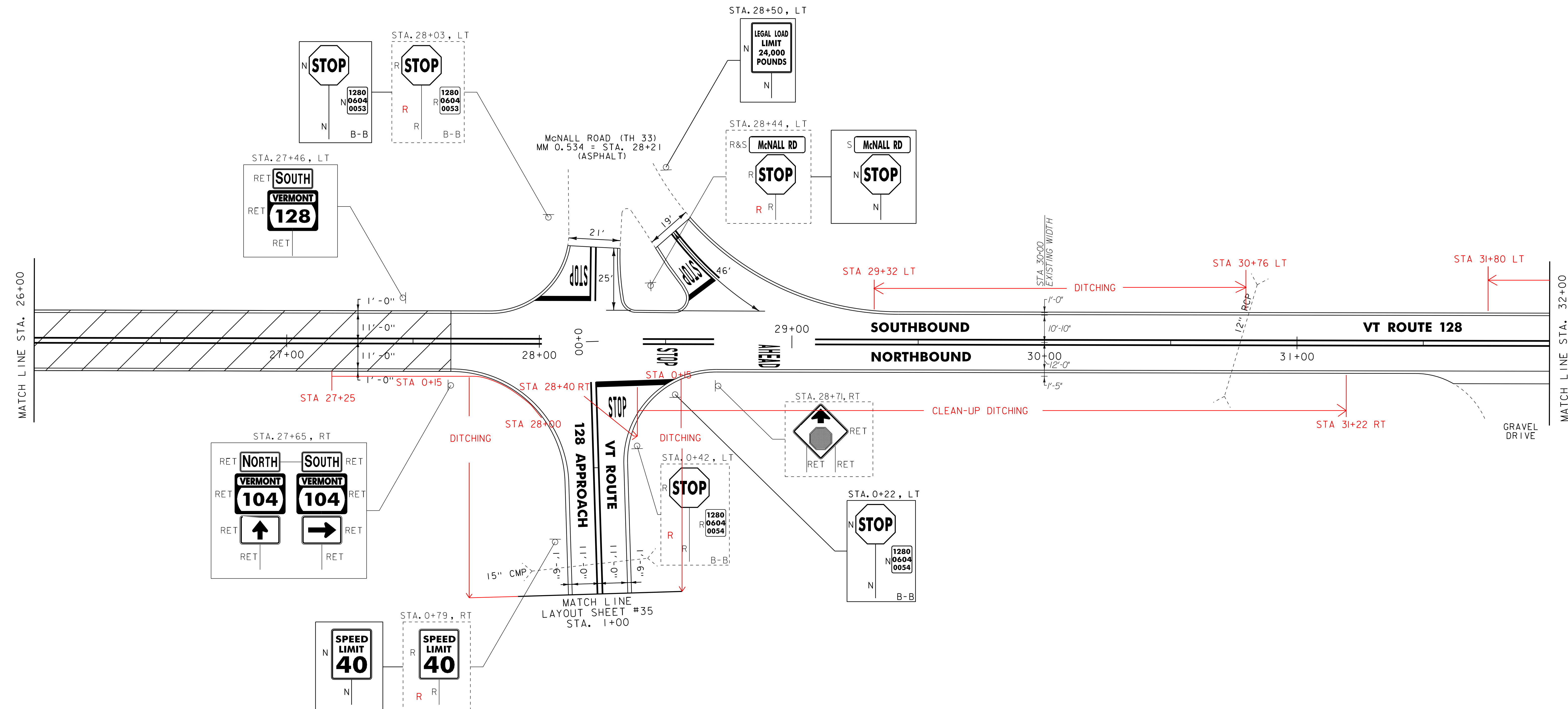

RECLAIM TO COLD PLANE TRANSITION AREA  
 (SEE DETAIL ON TYPICAL SHEET #2)

NOTES:  
 1. ALL EXISTING SIGNS NOT SHOWN SHALL BE RETAINED.  
 2. FOR LEGENDS, SEE LAYOUT SHEET #1.  
 NOT TO SCALE

<b>PROJECT LAYOUT SHEET #33</b>	PROJECT NAME: WESTFORD - FAIRFAX	FILE NAME: p08c212.dgn	PLOT DATE: 31-OCT-2012 13:58
	PROJECT NUMBER: STP 2804(1)	DESIGNED BY: STANTEC	DRAWN BY: STANTEC
		IPARM FILE: p08c212133.i	CHECKED BY: JLL
			SHEET 49 OF 79

