

INDEX OF SHEETS

- 1 TITLE SHEET
- 2 PROJECT NOTES
- 3-4 TYPICAL SECTIONS & DETAILS SHEETS
- 5 QUANTITY SHEET
- 6 LAYOUT
- 7 CULVERT PROFILE
- 8 EPSC NARRATIVE
- 9 EPSC EXISTING CONDITIONS SITE PLAN
- 10 EPSC CONSTRUCTION SITE PLAN
- 11 EPSC FINAL CONDITIONS SITE PLAN
- 12-14 EPSC DETAIL SHEETS
- 15 CROSS SECTIONS

VAOT STANDARDS FOR CONSTRUCTION

D-16	DRAINAGE DETAILS INCLUDING DROP INLETS, IRON GRATE TYPE B&C, CONC END SECTIONS, ETC.	06-01-1994
D-34	REINFORCED CONCRETE CRADLE HEADWALL	03-12-2007
E-100	CONSTRUCTION APPROACH SIGNS	01-02-2004
E-100A	SIDE ROAD CONSTRUCTION - APPROACH SIGNS	01-02-2004
E-101	CONSTRUCTION SIGN DETAILS	05-30-2003
E-102	CONSTRUCTION SIGN DETAILS	06-30-2003
E-102A	CONSTRUCTION SIGN DETAILS	05-01-2004
E-103	MAINLINE TRAFFIC CONTROL DIVIDED HIGHWAY ONE LANE CLOSED	03-01-2004
E-106	TRAFFIC CONTROL- MISCELLANEOUS DETAILS	03-01-2004
E-107	DELINEATION, BARRICADES AND DETOURS FOR CONSTRUCTION AREAS	06-30-2003
E-107A	BREAKAWAY BARRICADE DETAILS	06-08-2009
E-III	MINOR MAINTENANCE OPERATIONS	03-11-1997
E-120	STANDARD SIGN PLACEMENT - EXPRESSWAY & FREEWAY	08-08-1995
E-121	STANDARD SIGN PLACEMENT - CONVENTIONAL ROAD	08-08-1995

TRAFFIC DATA

2008 AADT: 1200

STATE OF VERMONT
AGENCY OF TRANSPORTATION



PROPOSED IMPROVEMENT
CULVERT REHABILITATION PROJECT
TOWN OF IRASBURG
COUNTY OF ORLEANS
VERMONT ROUTE 58 (MAJOR COLLECTOR)

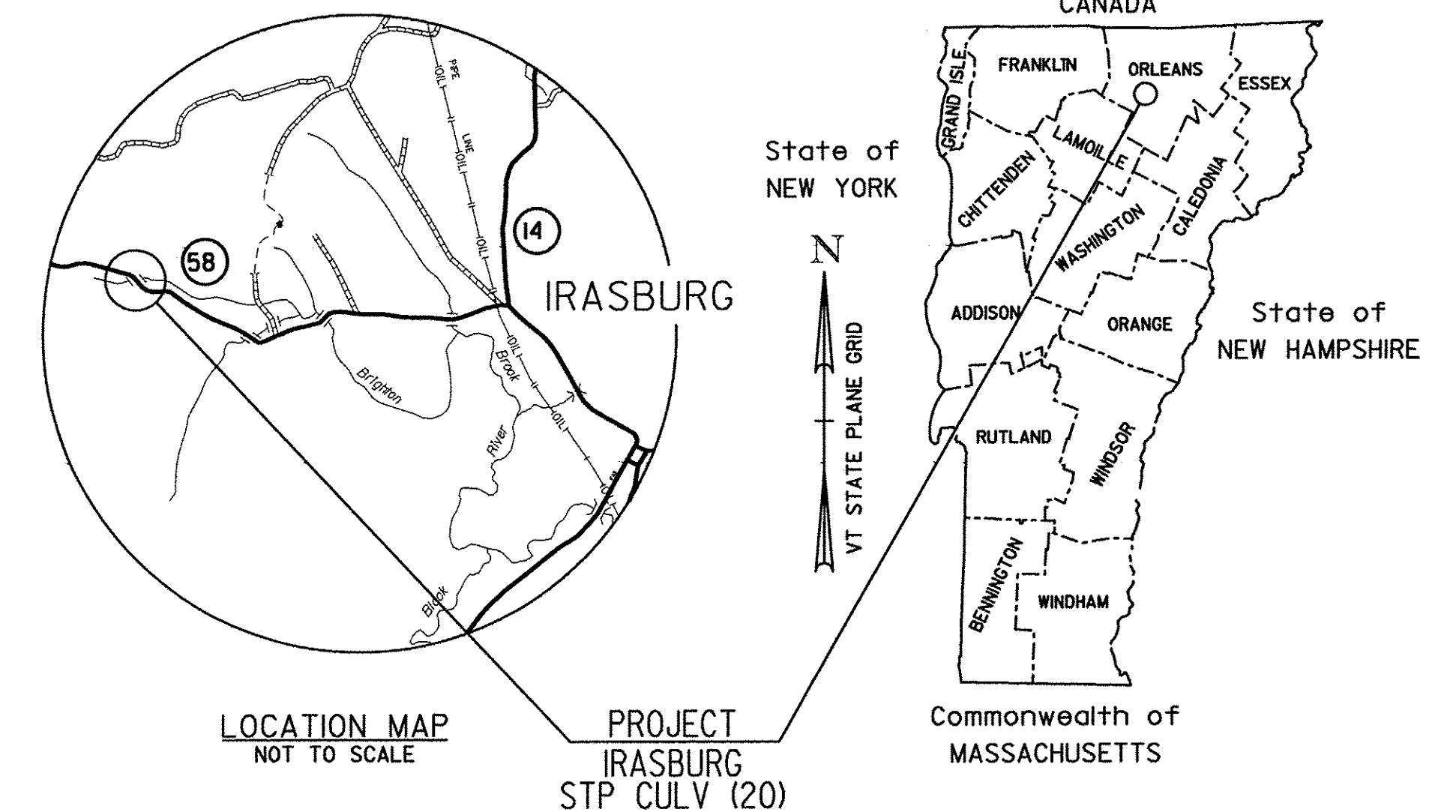

PROJECT LOCATION: WORK TO BE PERFORMED AT THIS LOCATION, ON VERMONT ROUTE 58, 2.2 MILES WEST OF JUNCTION WITH VERMONT ROUTE 14.

PROJECT DESCRIPTION: THIS PROJECT CONSISTS OF INSTALLATION OF PIPE LINER, INSTALLATION OF HEADWALLS, CHANNEL AND EMBANKMENT STABILIZATION.

RECORD PLANS

CONTRACTOR: J.P. SICARD, INC. - BARTON, VT

RESIDENT ENGINEER: SETH HISMAN

CONSTRUCTION BEGAN: MAY 26, 2011

CONSTRUCTION COMPLETE: AUGUST 26, 2012

RECORD PLANS BY: SETH HISMAN

I HEREBY CERTIFY THAT ALL THE CONSTRUCTION REQUIRED BY THIS SET OF DRAWINGS HAS BEEN ACCOMPLISHED AS INDICATED HEREIN.

BY *Seth Hisman* RESIDENT ENGINEER

DATE 3/13/13

NOTE: Any further information concerning final quantities, amounts or other details relative to this project may be found at Central Files in the electronic archives.

QUALITY ASSURANCE PROGRAM: LEVEL 2

CONVENTIONAL SYMBOLS

COUNTY LINE	
TOWN LINE	
LIMITS OF ACCESS	
POINT OF ACCESS	
FENCE LINE	
STONE WALL	
TRAVELED WAY	
GUARD RAIL	
RAILROAD	
SURVEY LINE	
CULVERT	
POWER POLE	
TELEPHONE POLE	
TREES	
CONTROL OF ACCESS	
PROPERTY LINE	
R.O.W. TAKING LINE	
SLOPE RIGHTS	
TOP OF CUT	
TOE OF SLOPE	

SURVEYED BY : VHB
SURVEYED DATE : DECEMBER 2008

DATUM
VERTICAL ASSUMED
HORIZONTAL ASSUMED

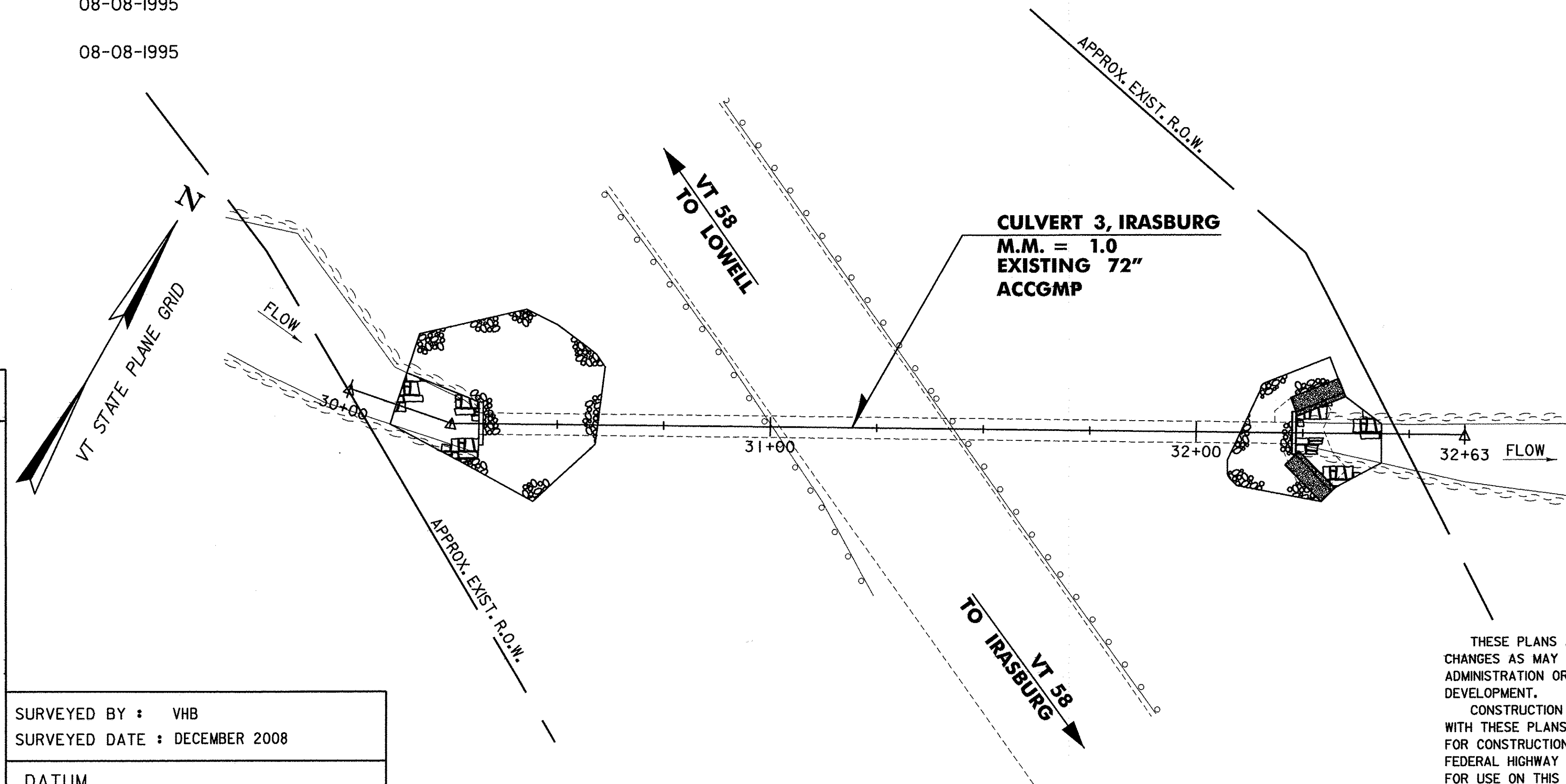
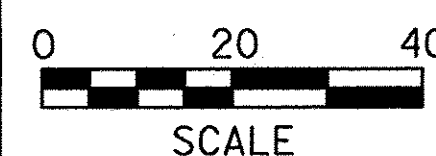

THESE PLANS ARE SUBJECT TO SUCH ENGINEERING CHANGES AS MAY BE REQUIRED BY THE FEDERAL HIGHWAY ADMINISTRATION OR THE DIRECTOR OF PROGRAM DEVELOPMENT.

CONSTRUCTION IS TO BE CARRIED ON IN ACCORDANCE WITH THESE PLANS AND THE STANDARD SPECIFICATIONS FOR CONSTRUCTION DATED 2006, AS APPROVED BY THE FEDERAL HIGHWAY ADMINISTRATION ON JUNE 15, 2006 FOR USE ON THIS PROJECT, INCLUDING ALL SUBSEQUENT REVISIONS AND SUCH REVISED SPECIFICATIONS AND SPECIAL PROVISIONS AS ARE INCORPORATED IN THESE PLANS.

FINAL PLANS
JULY 27, 2010



DIRECTOR OF PROGRAM DEVELOPMENT

APPROVED *Paul J. Sargent* DATE 9-17-10

PROJECT MANAGER : MARK SARGENT

PROJECT NAME : IRASBURG
PROJECT NUMBER : STP CULV (20)

SHEET 1 OF 15 SHEETS