

646.402 DURABLE 4 INCH WHITE LINE, THERMOPLASTIC  
 (ALL LINES WILL INCLUDE EDGE LINE BREAKS AND RADIUS FOR TOWN HIGHWAYS)  
 MIDDLEBURY:  
 STA 128+50.00 - STA 143+50.00 EDGE LINE LT & RT

646.412 DURABLE 4 INCH YELLOW LINE, THERMOPLASTIC  
 (ALL LINES WILL INCLUDE C/L BREAKS FOR TOWN HIGHWAYS) S=SOLID, D=DASHED  
 MIDDLEBURY: LT C RT  
 STA 128+50.00 - STA 143+50.00 S - S  
 STA 138+44.16 DOUBLE SOLID LT, TH-35

646.602 TEMPORARY 4 INCH WHITE LINE, PAINT  
 (ALL LINES WILL INCLUDE EDGE LINE BREAKS AND RADIUS FOR TOWN HIGHWAYS)  
 MIDDLEBURY:  
 STA 128+50.00 - STA 143+50.00 EDGE LINE LT & RT

646.612 TEMPORARY 4 INCH YELLOW LINE, PAINT  
 (ALL LINES WILL INCLUDE C/L BREAKS FOR TOWN HIGHWAYS) S=SOLID, D=DASHED  
 MIDDLEBURY: LT C RT  
 STA 128+50.00 - STA 143+50.00 S - S  
 STA 138+44.16 DOUBLE SOLID LT, TH-35

646.482 DURABLE 24 INCH STOP BAR, THERMOPLASTIC  
 MIDDLEBURY:  
 STA 138+44.16 LT, TH-35

646.682 TEMPORARY 24 INCH STOP BAR, PAINT  
 MIDDLEBURY:  
 STA 138+44.16 LT, TH-35

646.492 DURABLE LETTER OR SYMBOL, THERMOPLASTIC  
 MIDDLEBURY:  
 STA 138+44.16 LT, TH-35 "S,T,O,P" (4 EA)

646.692 TEMPORARY LETTER OR SYMBOL, PAINT  
 MIDDLEBURY:  
 STA 138+44.16 LT, TH-35 "S,T,O,P" (4 EA)

675.50 REMOVING SIGNS  
 AS SHOWN - 24

675.60 ERECTING SALVAGED SIGNS  
 AS SHOWN - 5

MATCH LINE STA 128+50.00, SEE PREVIOUS SHEET

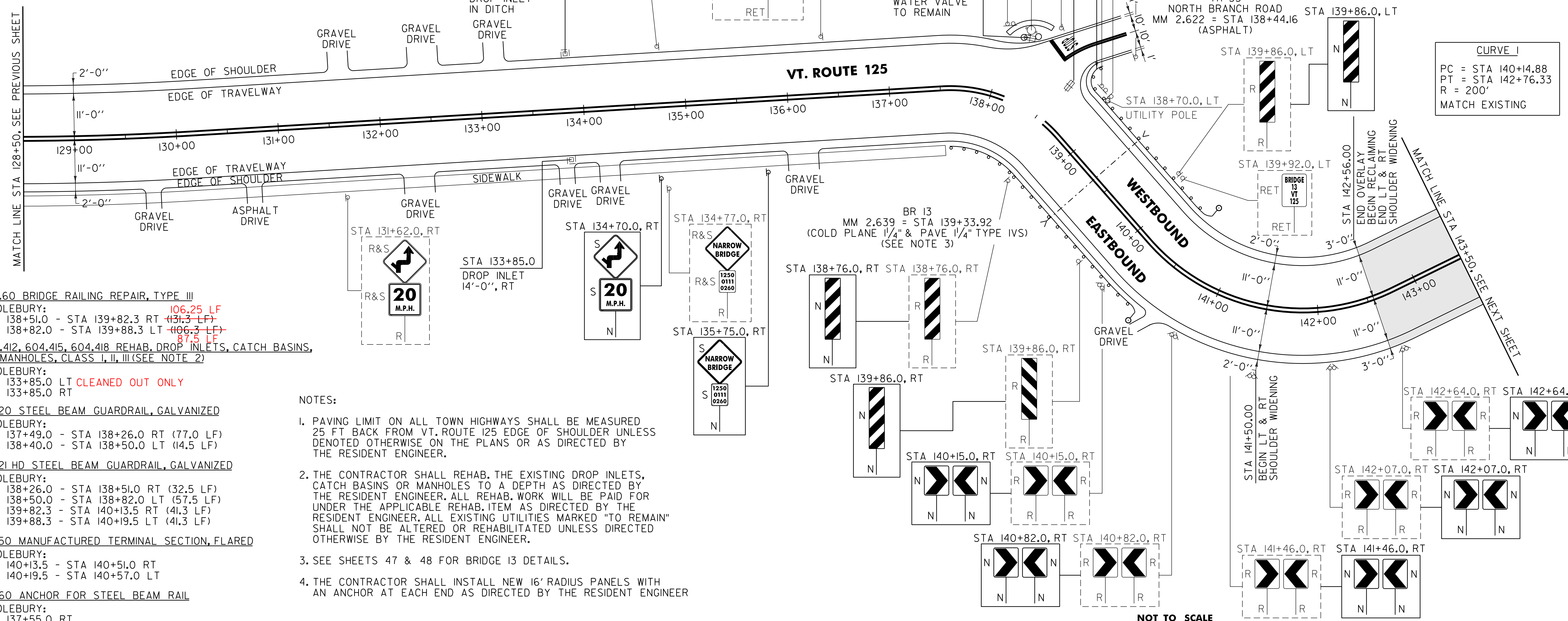

**CURVE 1**  
 PC = STA 140+14.88  
 PT = STA 142+76.33  
 R = 200'  
 MATCH EXISTING

525.60 BRIDGE RAILING REPAIR, TYPE III  
 MIDDLEBURY:  
 STA 138+51.0 - STA 139+82.3 RT (106.25 LF)  
 STA 138+82.0 - STA 139+88.3 LT (106.3 LF)  
 STA 139+88.3 - STA 140+19.5 LT (87.5 LF)

604.412, 604.415, 604.418 REHAB. DROP INLETS, CATCH BASINS, OR MANHOLES, CLASS I, II, III (SEE NOTE 2)  
 MIDDLEBURY:  
 STA 133+85.0 LT CLEANED OUT ONLY  
 STA 133+85.0 RT

- NOTES:
- PAVING LIMIT ON ALL TOWN HIGHWAYS SHALL BE MEASURED 25 FT BACK FROM VT. ROUTE 125 EDGE OF SHOULDER UNLESS DENOTED OTHERWISE ON THE PLANS OR AS DIRECTED BY THE RESIDENT ENGINEER.
  - THE CONTRACTOR SHALL REHAB. THE EXISTING DROP INLETS, CATCH BASINS OR MANHOLES TO A DEPTH AS DIRECTED BY THE RESIDENT ENGINEER. ALL REHAB. WORK WILL BE PAID FOR UNDER THE APPLICABLE REHAB. ITEM AS DIRECTED BY THE RESIDENT ENGINEER. ALL EXISTING UTILITIES MARKED "TO REMAIN" SHALL NOT BE ALTERED OR REHABILITATED UNLESS DIRECTED OTHERWISE BY THE RESIDENT ENGINEER.
  - SEE SHEETS 47 & 48 FOR BRIDGE 13 DETAILS.
  - THE CONTRACTOR SHALL INSTALL NEW 16' RADIUS PANELS WITH AN ANCHOR AT EACH END AS DIRECTED BY THE RESIDENT ENGINEER

621.20 STEEL BEAM GUARDRAIL, GALVANIZED  
 MIDDLEBURY:  
 STA 137+49.0 - STA 138+26.0 RT (77.0 LF)  
 STA 138+40.0 - STA 138+50.0 LT (14.5 LF)

621.21 HD STEEL BEAM GUARDRAIL, GALVANIZED  
 MIDDLEBURY:  
 STA 138+26.0 - STA 138+51.0 RT (32.5 LF)  
 STA 138+50.0 - STA 138+82.0 LT (57.5 LF)  
 STA 139+82.3 - STA 140+13.5 RT (41.3 LF)  
 STA 139+88.3 - STA 140+19.5 LT (41.3 LF)

621.50 MANUFACTURED TERMINAL SECTION, FLARED  
 MIDDLEBURY:  
 STA 140+13.5 - STA 140+51.0 RT  
 STA 140+19.5 - STA 140+57.0 LT

621.60 ANCHOR FOR STEEL BEAM RAIL  
 MIDDLEBURY:  
 STA 137+55.0 RT  
 STA 138+40.0 LT  
 STA 138+66.5 LT

621.80 REMOVAL AND DISPOSAL OF GUARDRAIL  
 MIDDLEBURY:  
 STA 137+55.0 - STA 138+51.0 RT (96.0 LF)  
 STA 138+40.0 - STA 138+82.0 LT (60.0 LF)  
 STA 139+82.3 - STA 140+42.0 RT (60.0 LF)  
 STA 139+88.3 - STA 140+48.0 LT (60.0 LF)

629.20 ADJUST ELEVATION OF VALVE BOX  
 MIDDLEBURY:  
 STA 138+56.0 LT

676.10 DELINEATOR WITH STEEL POST  
 MIDDLEBURY:  
 STA 140+51.0 RT  
 STA 140+57.0 LT

AREA TO BE RECLAIMED

**SIGN LEGEND**  
 R = REMOVE  
 S = SALVAGE  
 N = NEW  
 RET = RETAIN  
 B-B = BACK TO BACK  
 EXISTING =   
 NEW =

NOT TO SCALE

|                                |                             |                              |
|--------------------------------|-----------------------------|------------------------------|
| <b>PROJECT LAYOUT SHEET #7</b> | PROJECT NAME: MIDDLEBURY    | PLOT DATE: 18-SEP-2013 17:09 |
|                                | PROJECT NUMBER: STP 2627(1) | DRAWN BY: C.A.K.             |
|                                | FILE NAME: p06c222.dgn      | CHECKED BY: D.W.E.           |
|                                | PROJECT LEADER: D.E.G.      | SHEET 26 OF 114              |
|                                | DESIGNED BY: M.J.L.         |                              |
|                                | IPARM FILE: p06c222107.1    |                              |