

Figure 6C-2. Types of Tapers and Buffer Spaces

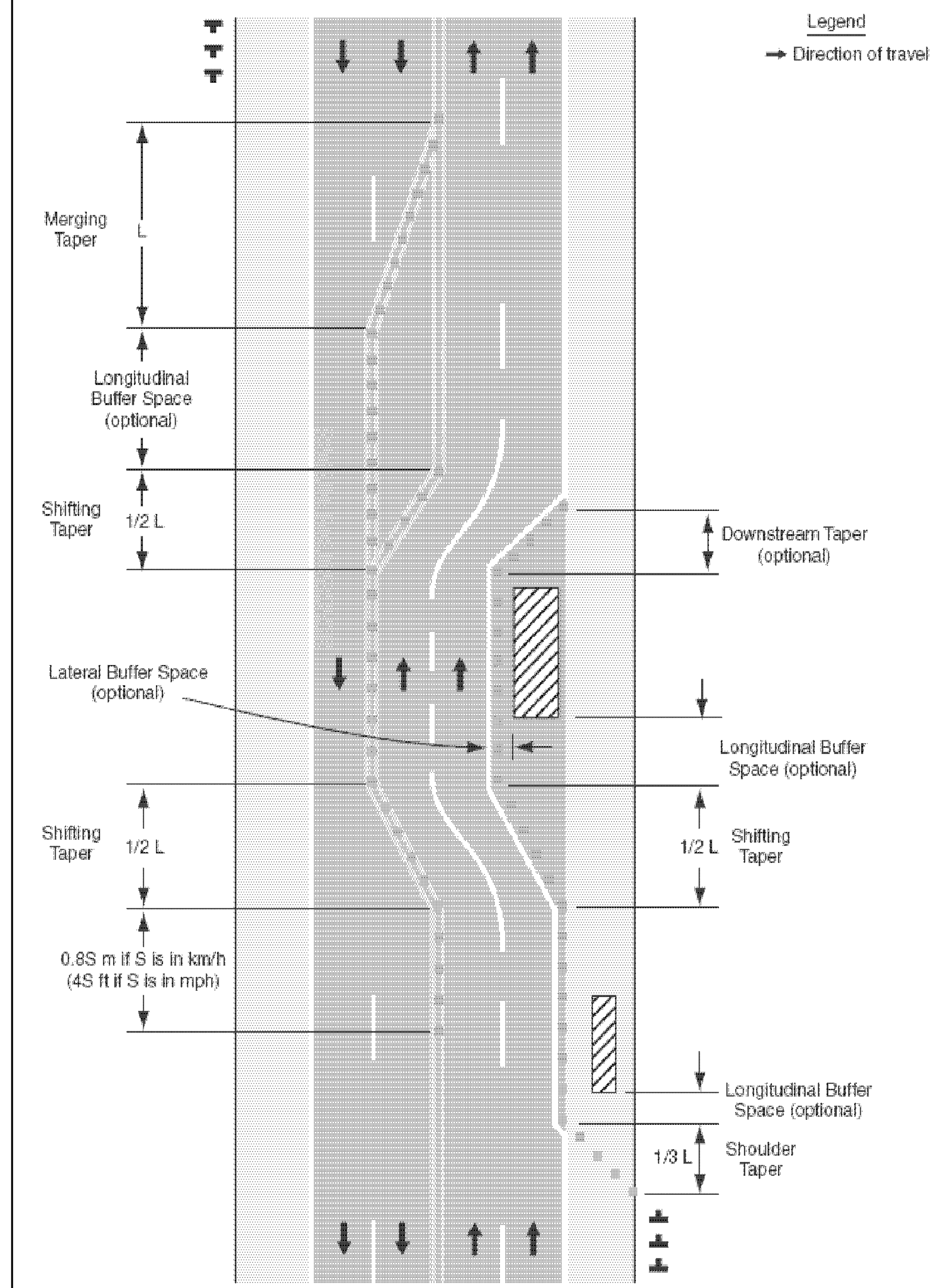
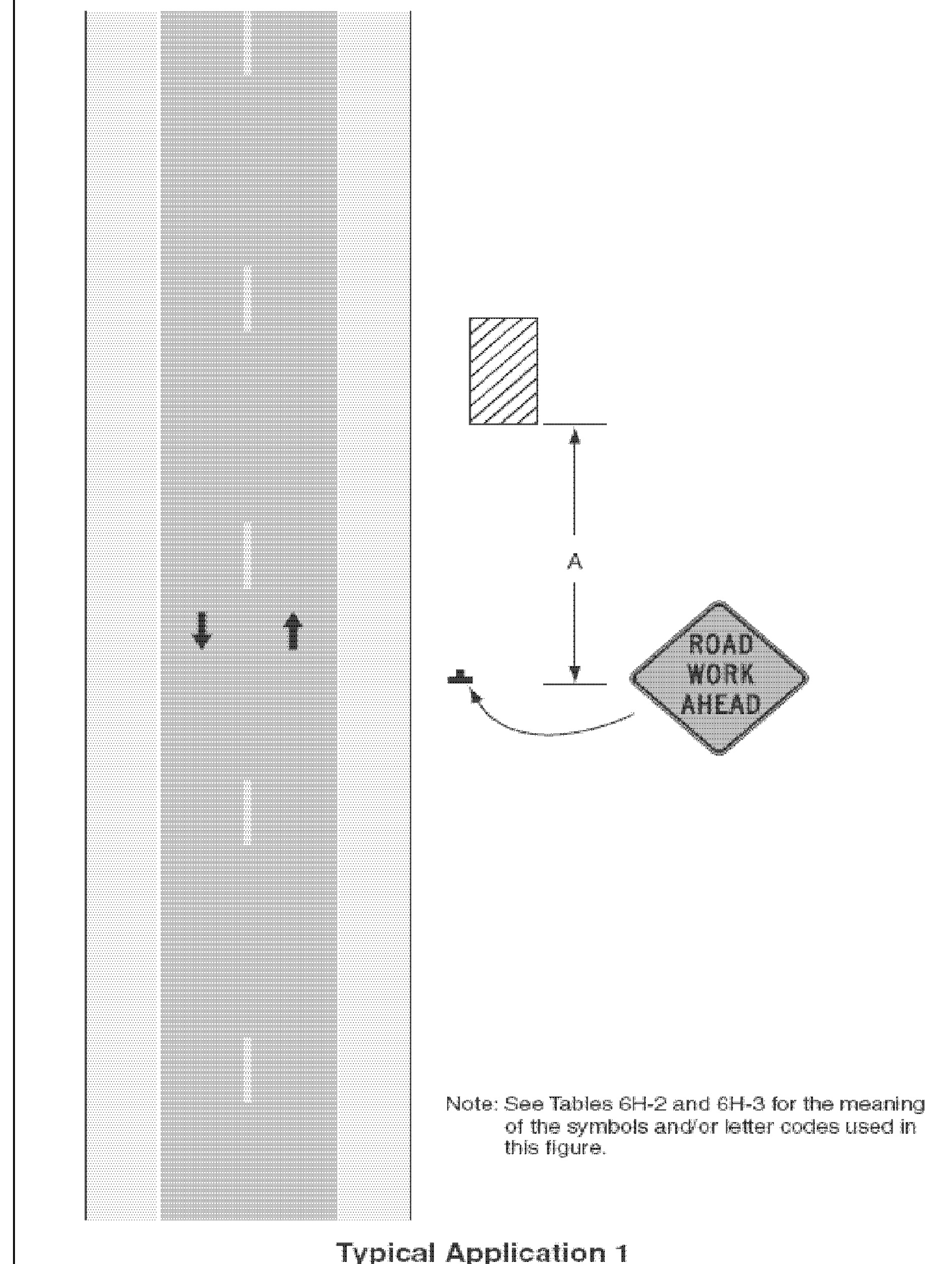
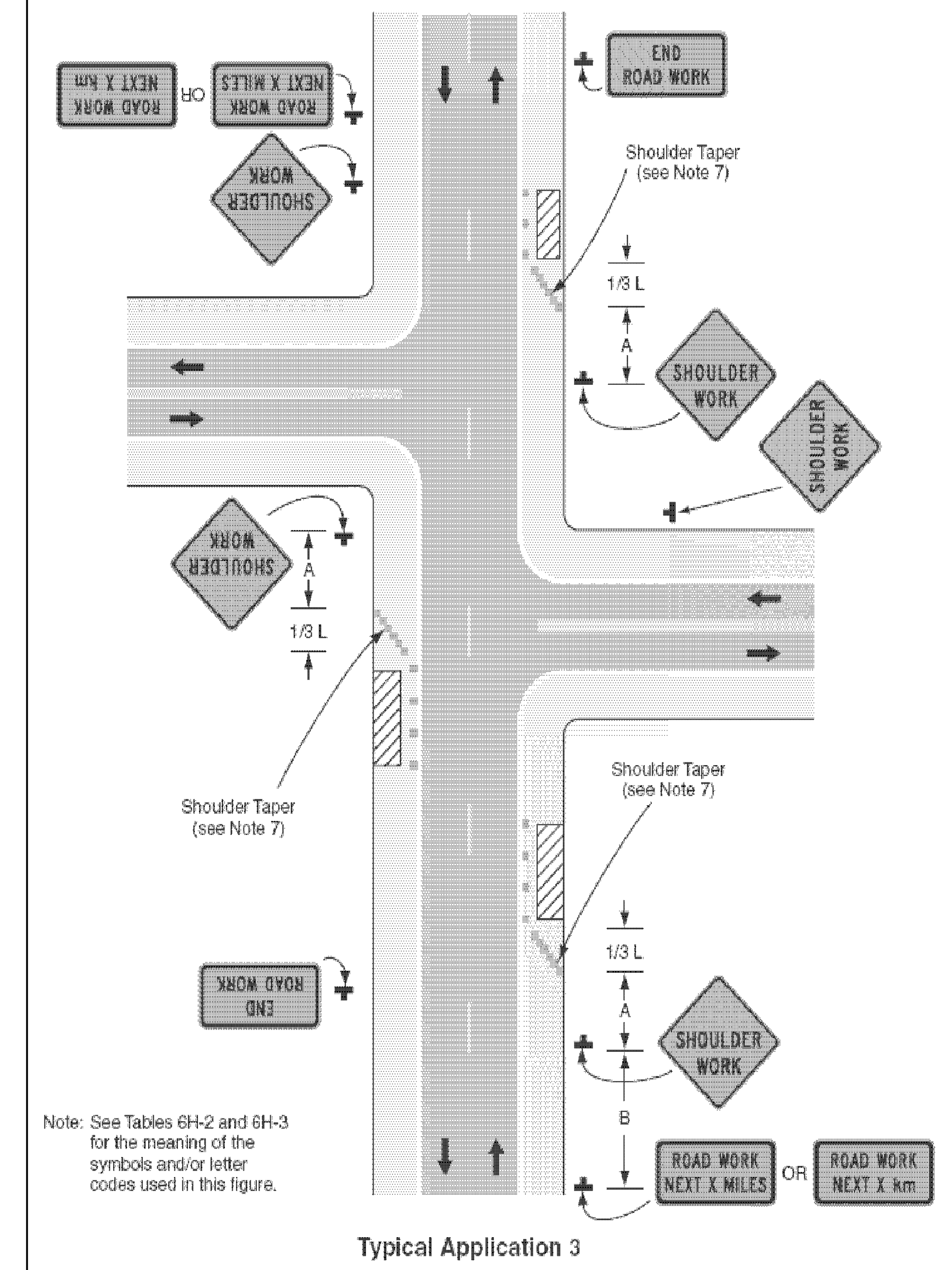

Figure 6H-1. Work Beyond the Shoulder (TA-1)



Note: See Tables 6H-2 and 6H-3 for the meaning of the symbols and/or letter codes used in this figure.

Figure 6H-3. Work on Shoulders (TA-3)



Note: See Tables 6H-2 and 6H-3 for the meaning of the symbols and/or letter codes used in this figure.

Table 6C-3. Taper Length Criteria for Temporary Traffic Control Zones

Type of Taper	Taper Length (L)*
Merging Taper	at least L
Shifting Taper	at least 0.5L
Shoulder Taper	at least 0.33L
One-Lane, Two-Way Traffic Taper	30 m (100 ft) maximum
Downstream Taper	30 m (100 ft) per lane

Table 6C-4. Formulas for Determining Taper Lengths

Speed Limit (S)	Taper Length (L) Meters	Speed Limit (S)	Taper Length (L) Feet
60 km/h or less	$L = \frac{WS^2}{155}$	40 mph or less	$L = \frac{WS^2}{80}$
70 km/h or more	$L = \frac{WS}{1.5}$	45 mph or more	$L = WS$

Where: L = taper length in meters (feet)  
 W = width of offset in meters (feet)  
 S = posted speed limit, or off-peak 85th-percentile speed prior to work starting, or the anticipated operating speed in km/h (mph)

**TRAFFIC CONTROL SHEET 2**

PROJECT NAME: NEWPORT-COVENTRY-NEWPORT  
 PROJECT NUMBER: STP 2802(I)  
 FILE NAME: 08b158.dgn  
 PROJECT LEADER: CDL  
 DESIGNED BY: BMB  
 PLOT FILE: 08b158-131.I  
 PLOT DATE: 8/4/2011  
 DRAWN BY: BMB  
 CHECKED BY: EPD  
 SHEET 131 OF 134