

PAY LIMIT 621.217 HD STEEL BEAM GUARDRAIL,  
GALVANIZED/NESTED W/8 FEET POSTS

**NOTE:**

1. 25'-0" rail lengths may be used to eliminate the intermediate lap without a post. Do not place a lap without a post unless needed due to length of gap.
2. Posts 1 thru 3 are CRT posts with two blockouts. See Section B-B for details.
3. Install the back face of the nested guardrail a minimum of 5'-0" from the face of the curb-like headwall.

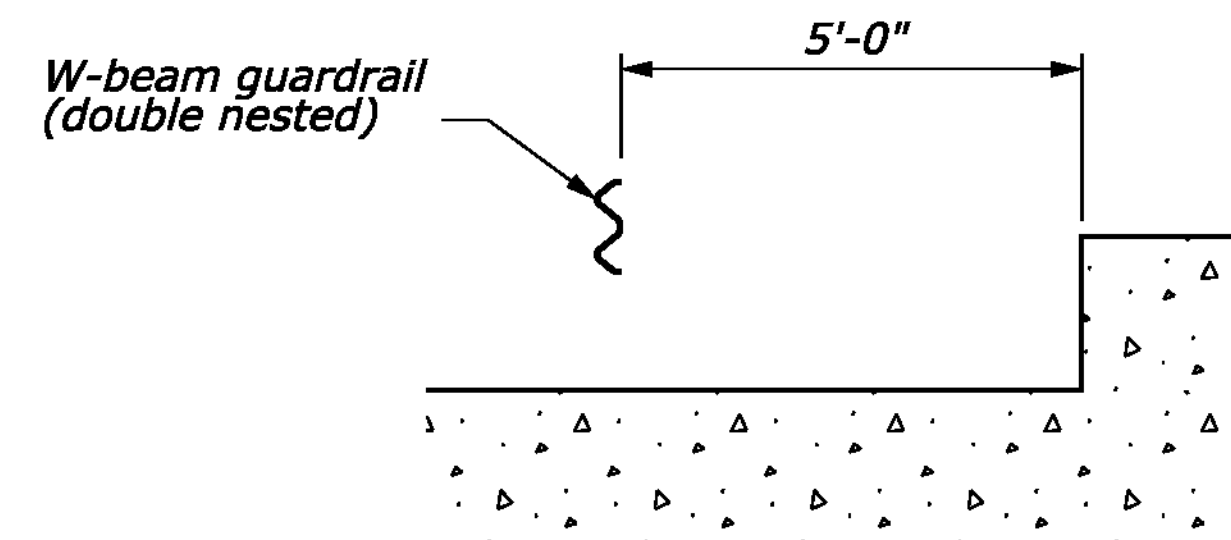
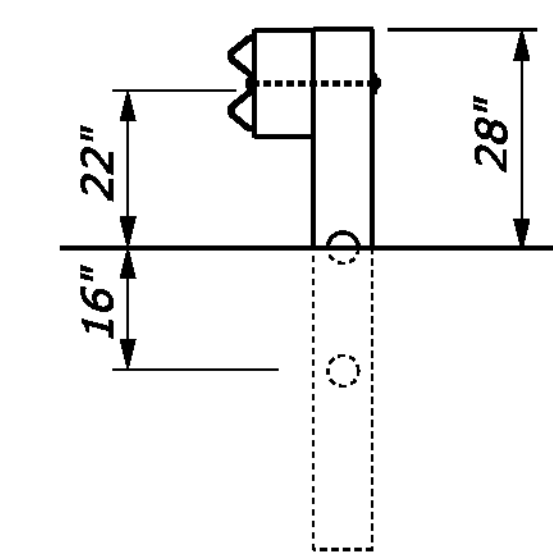
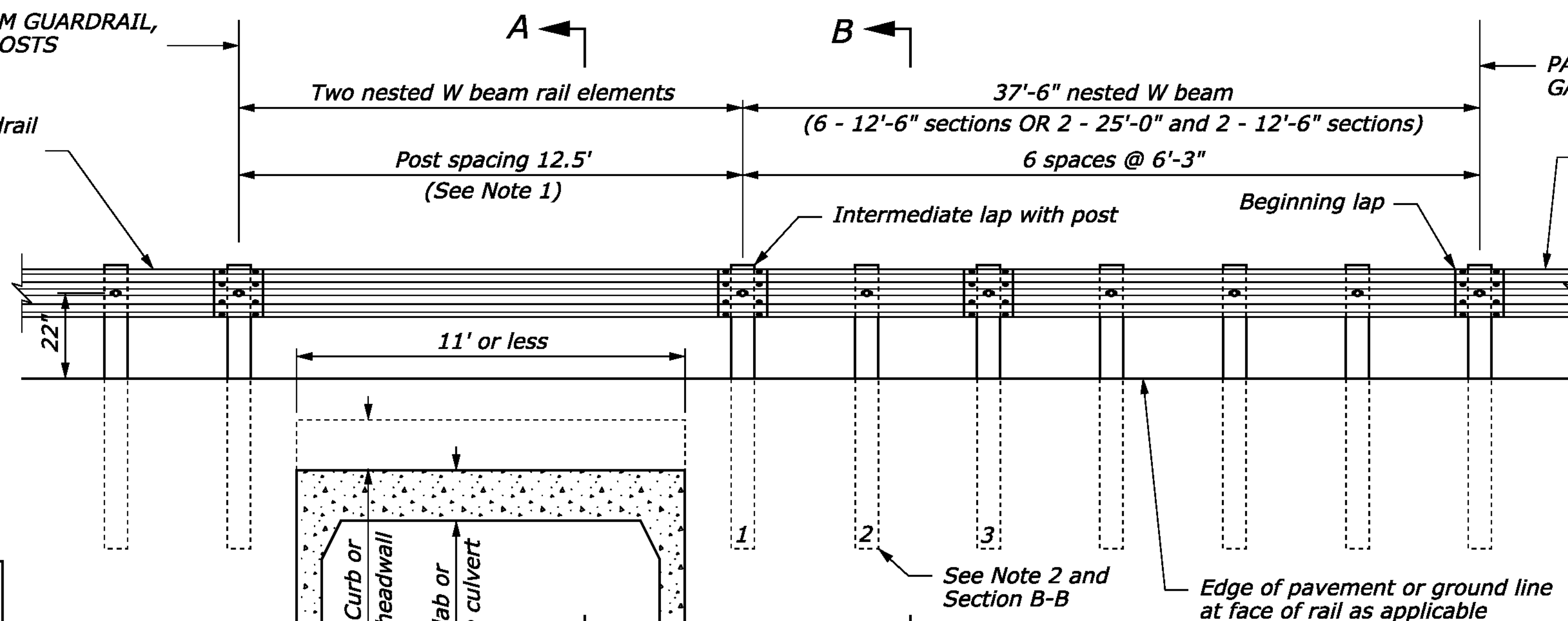

SECTION A-A  
(See Note 3)

8 - 2" x 5/8" guardrail bolts and recess nuts (typ.)  
Nested W-beam rail element

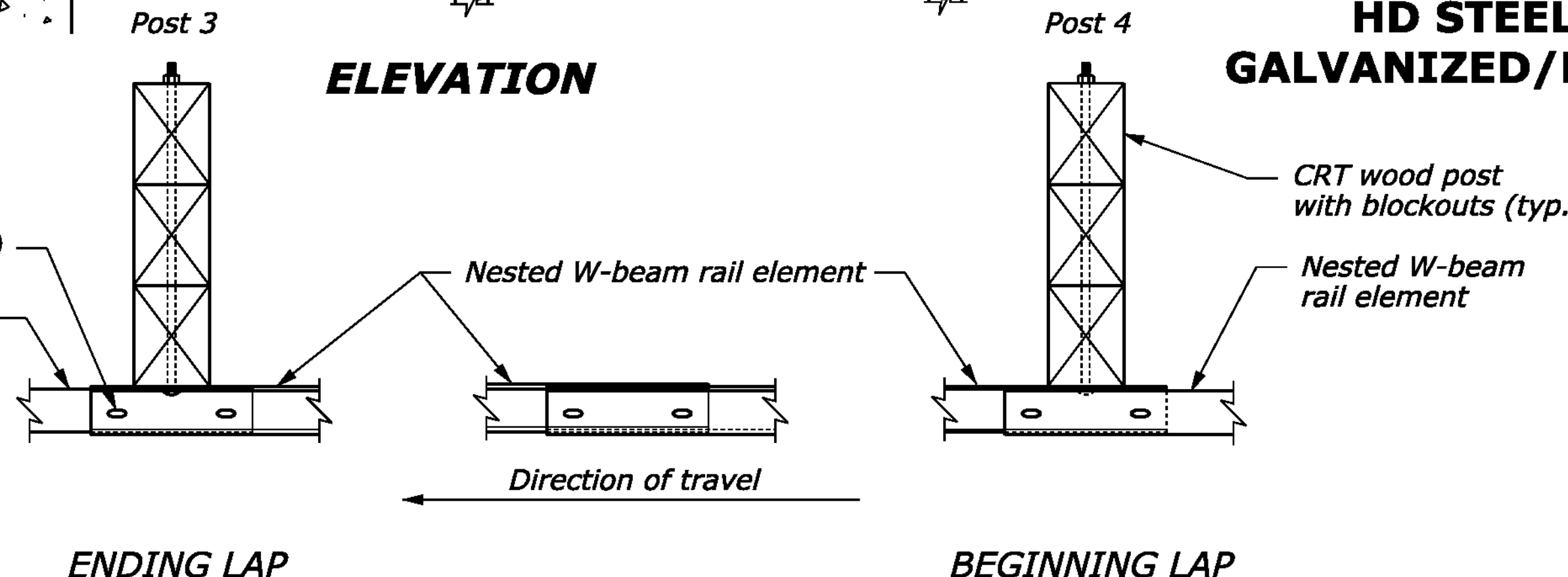

**HD STEEL BEAM GUARDRAIL,  
GALVANIZED/NESTED W/8 FEET POSTS**

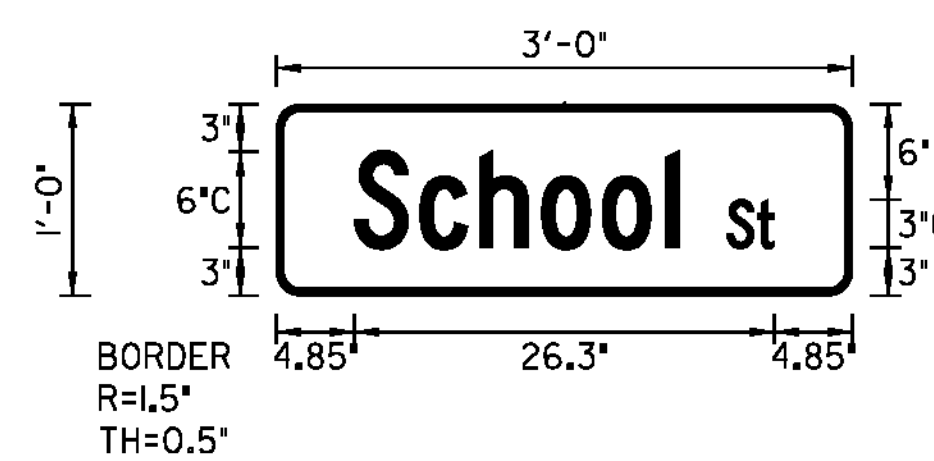

**D3-1**

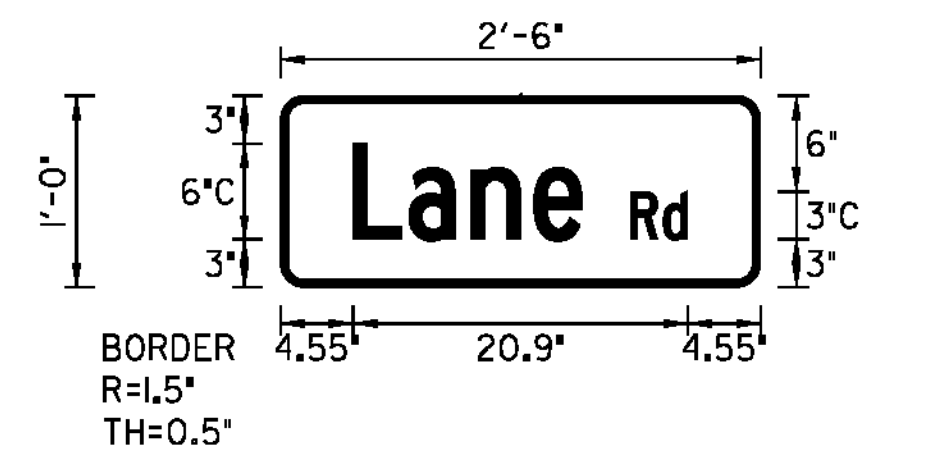

**D3-1**

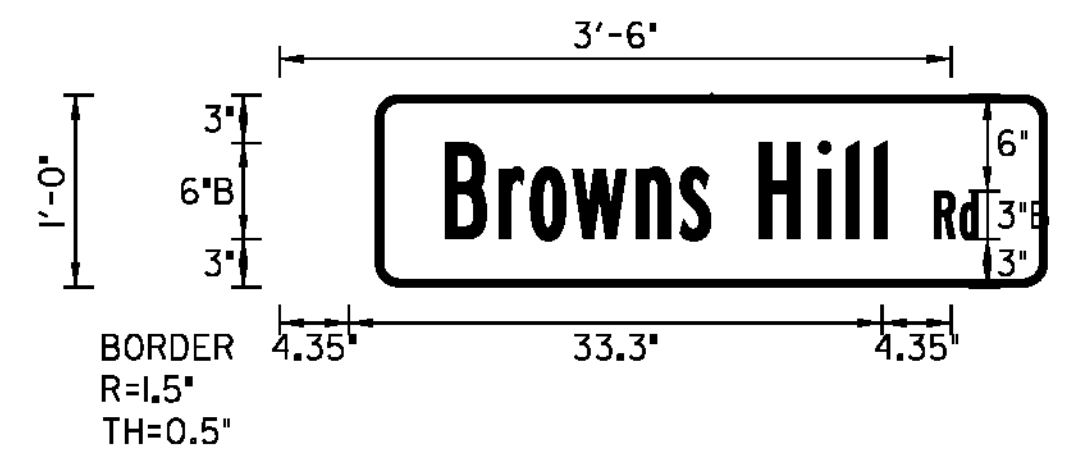

**D3-1**

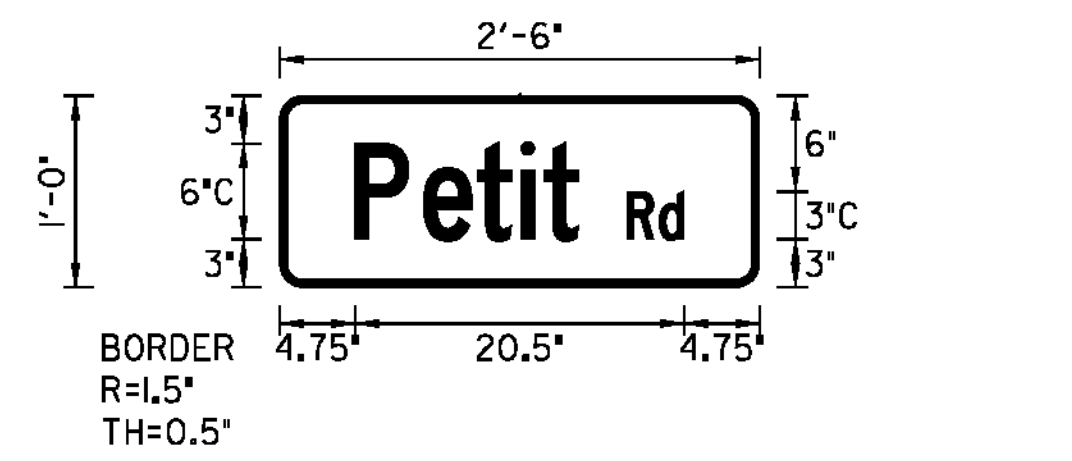

**D3-1**

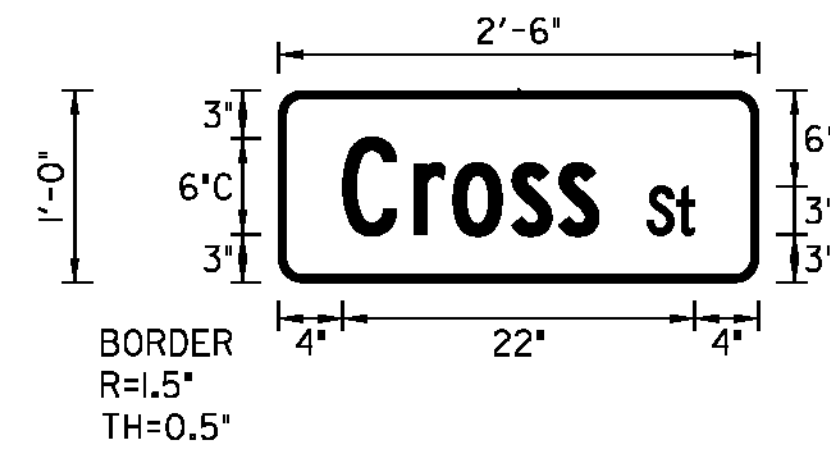

**D3-1**

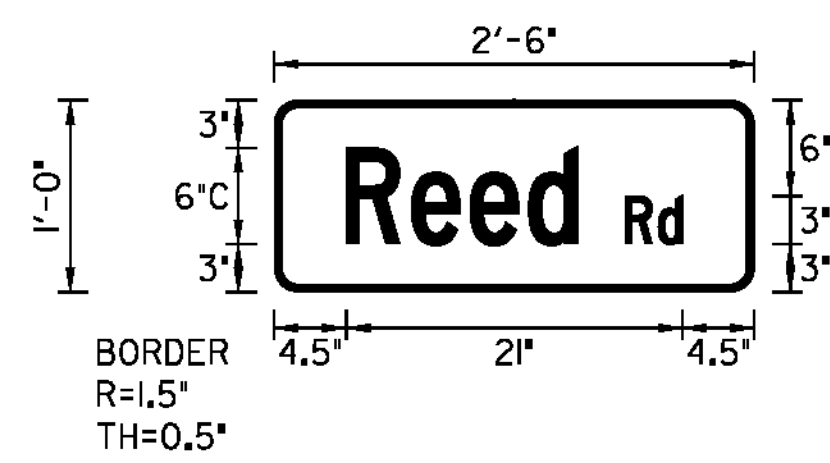

**D3-1**

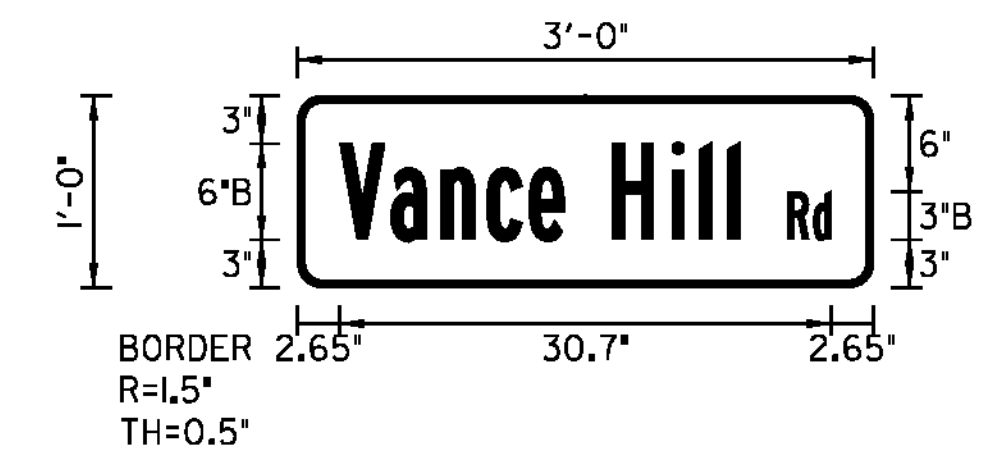

**D3-1**

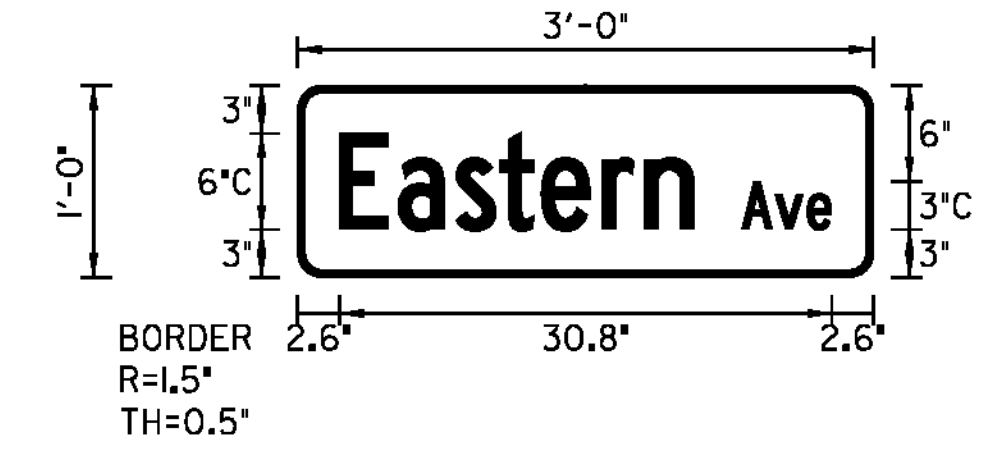

**D3-1**

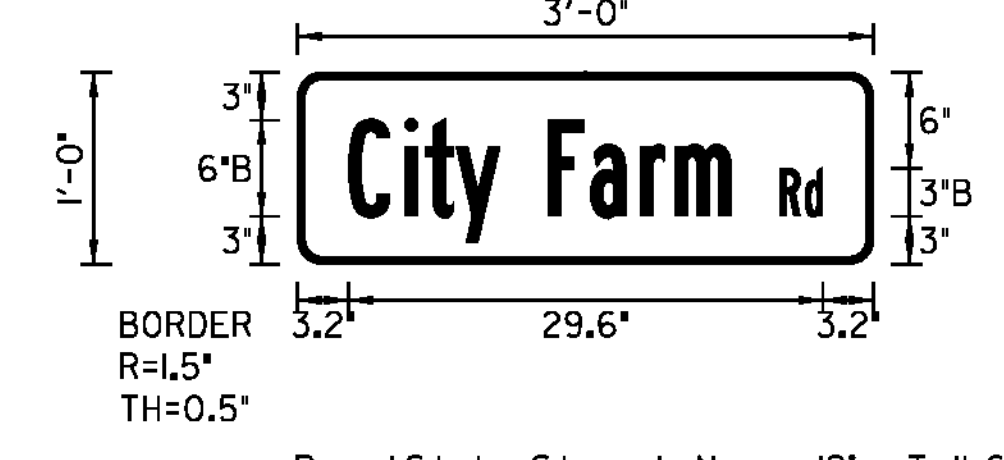

**D3-1**

**MISCELLANEOUS  
DETAIL SHEET 3**

DETAILS ARE NOT TO SCALE

PROJECT NAME:	NEWPORT-COVENTRY-NEWPORT
PROJECT NUMBER:	STP 2802(I)
FILE NAME:	08b158.dgn
PROJECT LEADER:	CDL
DESIGNED BY:	VTRANS
PLOT FILE:	08b158-129.1
PLOT DATE:	8/3/2011
DRAWN BY:	VTRANS
CHECKED BY:	EPD
SHEET	129 OF 134