

DURABLE 4 INCH WHITE LINE (SEE OPTION ITEMS)  
 STA. 262+25 - STA. 267+75 (SOLID LT & RT)

TEMPORARY 4 INCH WHITE LINE, PAINT  
 STA. 262+25 - STA. 267+75 (SOLID LT & RT)

DURABLE 4 INCH YELLOW LINE (SEE OPTION ITEMS)  
 STA. 262+25 - STA. 267+75 (DASHED LT)  
 STA. 262+25 - STA. 267+75 (SOLID RT)

TEMPORARY 4 INCH YELLOW LINE, PAINT  
 STA. 262+25 - STA. 267+75 (DASHED LT)  
 STA. 262+25 - STA. 267+75 (SOLID RT)

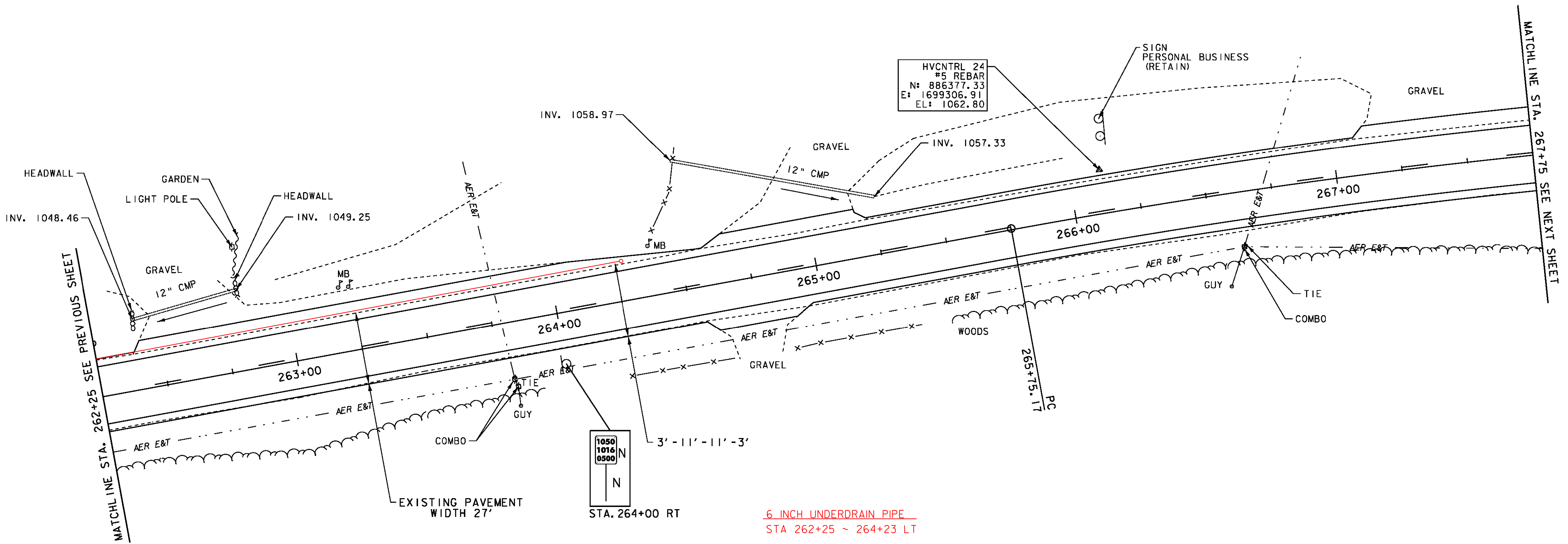
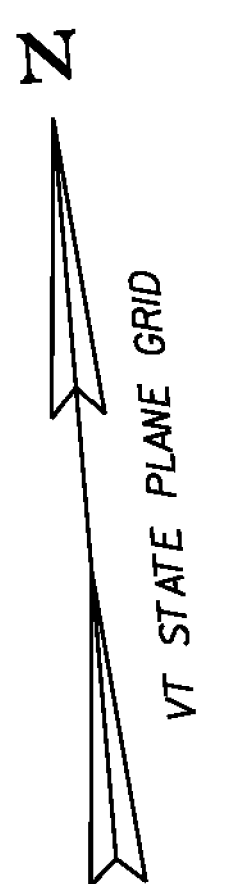

HVCNTRL 24  
 #5 REBAR  
 N: 886377.33  
 E: 1699306.91  
 EL: 1062.80

1050  
 1016  
 0500  
 N  
 N  
 STA. 264+00 RT

6 INCH UNDERDRAIN PIPE  
 STA 262+25 ~ 264+23 LT

6 INCH UNDERDRAIN CARRIER PIPE  
 STA 264+23 LT

UNDERDRAIN FLUSHING BASIN  
 STA 264+23 LT

- LEGEND**
- MAILBOX
  - BORING
  - SIGN
  - HYDRANT
  - MANHOLE
  - WATER SHUT OFF (WSO)
  - GAS PIPELINE MARKER
  - CATCH BASIN / DROP INLET
  - CURB INLET
  - TRAFFIC CONTROL BOX
  - PARKING METER
  - UTILITY POLE

- SIGN LEGEND**
- R = REMOVE
  - R&S = REMOVE AND SALVAGE
  - RET = RETAIN
  - S = SALVAGE
  - N = NEW
  - B-B = BACK TO BACK

DATUM  
 NAVD 88  
 NAD 83

SCALE 1" = 20'-0"  
 20 0 20

<b>PROJECT LAYOUT SHEET 26</b>	PROJECT NAME: NEWPORT-COVENTRY-NEWPORT	PLOT DATE: 8/3/2011
	PROJECT NUMBER: STP 2802(1)	DRAWN BY: BMB
	FILE NAME: 08b158.dgn	CHECKED BY: EPD
	DESIGNED BY: BMB	SHEET 53 OF 134
	PLOT FILE: 08b158-53.1	