

DURABLE 4 INCH WHITE LINE (SEE OPTION ITEMS)
 STA. 245+25 - STA. 250+75 (SOLID LT & RT)

REMOVING SIGNS
 AS SHOWN - 2

DURABLE 4 INCH YELLOW LINE (SEE OPTION ITEMS)
 STA. 245+25 - STA. 248+50 (SOLID LT & RT)
 STA. 248+50 - STA. 250+75 (SOLID LT)
 STA. 249+00 - STA. 250+75 (DASHED RT)

TEMPORARY 4 INCH WHITE LINE, PAINT
 STA. 245+25 - STA. 250+75 (SOLID LT & RT)

TEMPORARY 4 INCH YELLOW LINE, PAINT
 STA. 245+25 - STA. 248+50 (SOLID LT & RT)
 STA. 248+50 - STA. 250+75 (SOLID LT)
 STA. 249+00 - STA. 250+75 (DASHED RT)

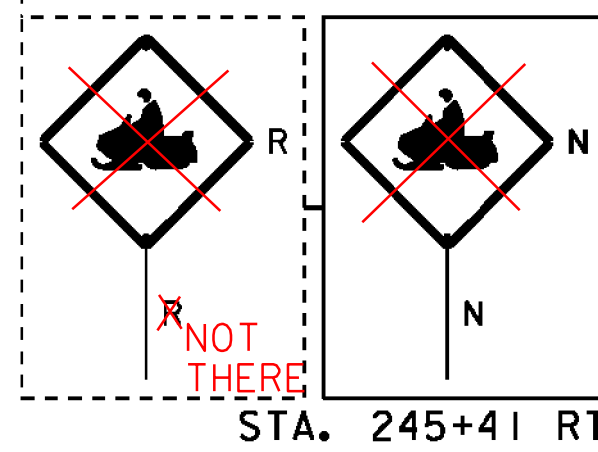
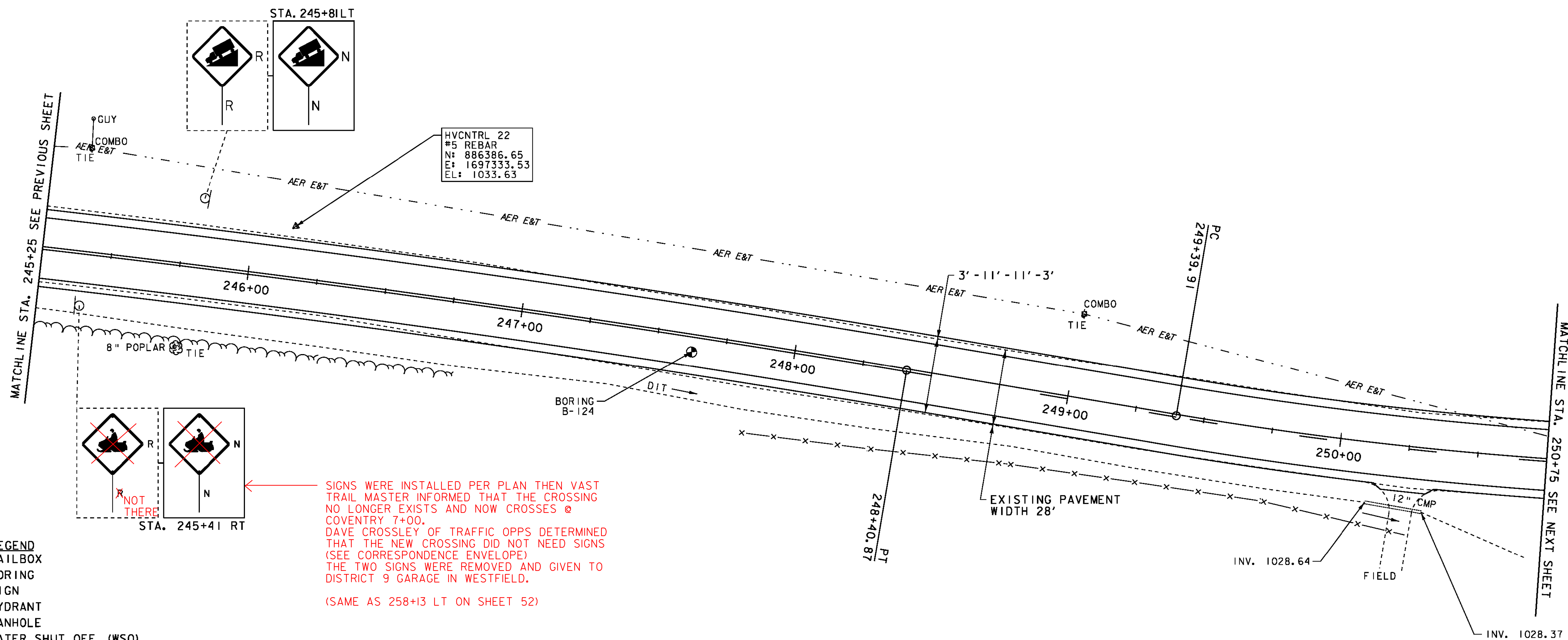

SIGNS WERE INSTALLED PER PLAN THEN VAST TRAIL MASTER INFORMED THAT THE CROSSING NO LONGER EXISTS AND NOW CROSSES @ COVENTRY 7+00. DAVE CROSSLEY OF TRAFFIC OPPTS DETERMINED THAT THE NEW CROSSING DID NOT NEED SIGNS (SEE CORRESPONDENCE ENVELOPE) THE TWO SIGNS WERE REMOVED AND GIVEN TO DISTRICT 9 GARAGE IN WESTFIELD.
 (SAME AS 258+13 LT ON SHEET 52)

- LEGEND**
- MAILBOX
 - BORING
 - SIGN
 - HYDRANT
 - MANHOLE
 - WATER SHUT OFF (WSO)
 - GAS PIPELINE MARKER
 - CATCH BASIN / DROP INLET
 - CURB INLET
 - ⊠ TRAFFIC CONTROL BOX
 - ⊕ PARKING METER
 - ⊖ UTILITY POLE

- SIGN LEGEND**
- R = REMOVE
 - R&S = REMOVE AND SALVAGE
 - RET = RETAIN
 - S = SALVAGE
 - N = NEW
 - B-B = BACK TO BACK

DATUM
 NAVD 88
 NAD 83

SCALE 1" = 20'-0"
 20 0 20

PROJECT LAYOUT SHEET 23	PROJECT NAME: NEWPORT-COVENTRY-NEWPORT	PLOT DATE: 8/3/2011
	PROJECT NUMBER: STP 2802(1)	DRAWN BY: BMB
	FILE NAME: 08b158.dgn	CHECKED BY: EPD
	DESIGNED BY: BMB	SHEET 50 OF 134
	PLOT FILE: 08b158-50.1	