

COMMON EXCAVATION
 STA. 239+75 - STA. 240+25 RT
6 INCH UNDERDRAIN PIPE
 STA. 239+75 - STA. 240+25 RT
 240+25 242+16
6 INCH UNDERDRAIN CARRIER PIPE
 STA. 240+25 RT 242+16 RT
 STA 240+20 RT
UNDERDRAIN FLUSHING BASIN
 STA. 240+25 RT 242+16 RT
 STA 240+20 RT
STONE FILL, TYPE I
 STA. 241+75 - STA. 242+75 LT
 239+75 ~ 240+26 RT

STEEL BEAM GUARDRAIL, GALVANIZED W/8 FEET POSTS
 STA. 239+75.00 - STA. 243+02.00 LT
ANCHOR FOR STEEL BEAM RAIL
 STA. 243+02.00 LT
REMOVAL AND DISPOSAL OF GUARDRAIL
 STA. 239+75 - STA. 242+94 LT
DELINEATOR WITH STEEL POST
 STA. 243+02 LT

DURABLE 4 INCH WHITE LINE (SEE OPTION ITEMS)
 STA. 239+75 - STA. 245+25 (SOLID LT & RT)
DURABLE 4 INCH YELLOW LINE (SEE OPTION ITEMS)
 STA. 239+75 - STA. 245+25 (SOLID LT & RT)
TEMPORARY 4 INCH WHITE LINE, PAINT
 STA. 239+75 - STA. 245+25 (SOLID LT & RT)
TEMPORARY 4 INCH YELLOW LINE, PAINT
 STA. 239+75 - STA. 245+25 (SOLID LT & RT)

REMOVING SIGNS
 AS SHOWN - 1

CURVE #22
 DELTA = 6°47'20"
 D = 0°57'18"
 R = 6000.00'
 T = 355.88'
 L = 710.94'
 E = 10.55'
 0.02 FT/FT
 150' RUNOFF (50 MPH)

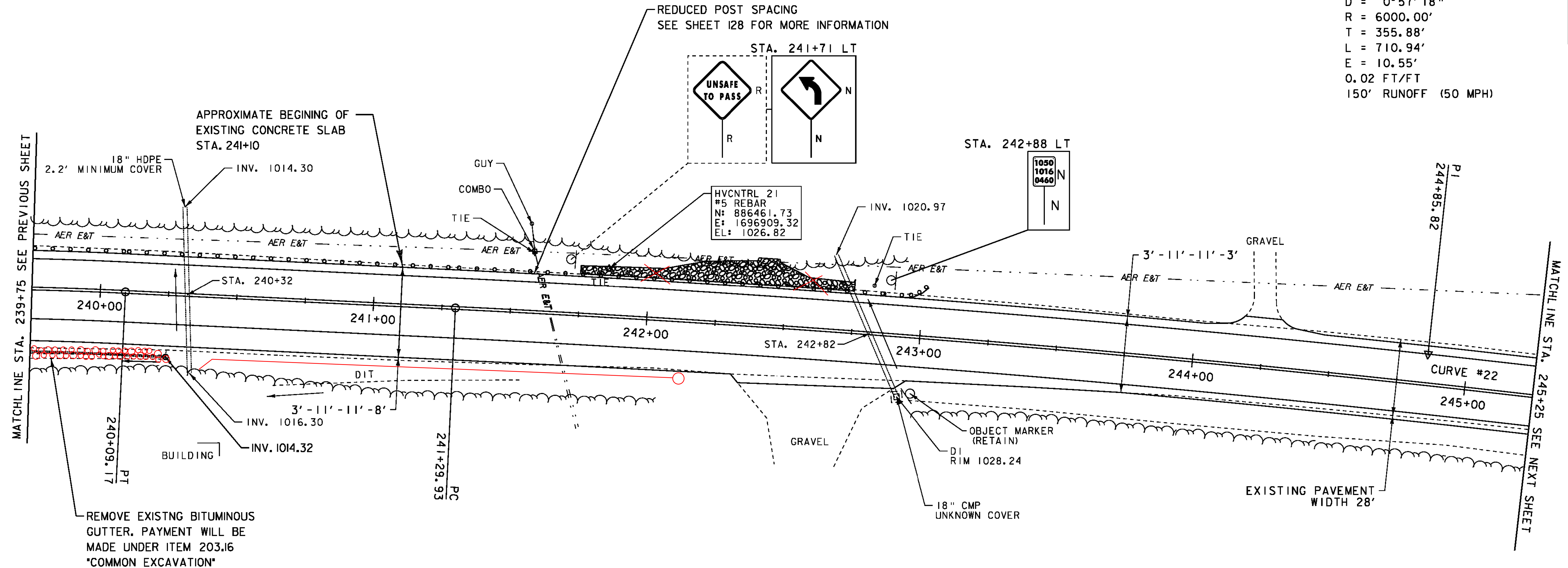
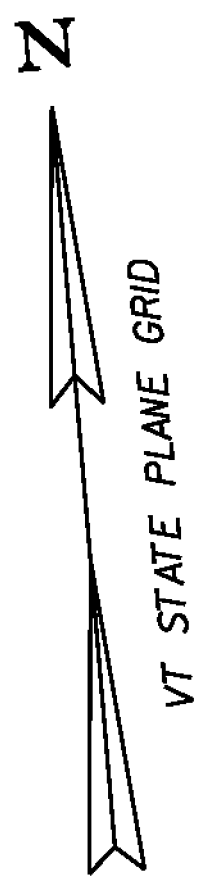

- LEGEND**
- MAILBOX
 - BORING
 - SIGN
 - HYDRANT
 - MANHOLE
 - WATER SHUT OFF (WSO)
 - GAS PIPELINE MARKER
 - CATCH BASIN / DROP INLET
 - CURB INLET
 - TRAFFIC CONTROL BOX
 - PARKING METER
 - UTILITY POLE

- SIGN LEGEND**
- R = REMOVE
 - R&S = REMOVE AND SALVAGE
 - RET = RETAIN
 - S = SALVAGE
 - N = NEW
 - B-B = BACK TO BACK

DATUM
 NAVD 88
 NAD 83

SCALE 1" = 20'-0"
 20 0 20

PROJECT LAYOUT SHEET 22	PROJECT NAME: NEWPORT-COVENTRY-NEWPORT	PLOT DATE: 8/3/2011
	PROJECT NUMBER: STP 2802(1)	DRAWN BY: BMB
	FILE NAME: 08b158.dgn	CHECKED BY: EPD
	DESIGNED BY: BMB	SHEET 49 OF 134
	PLOT FILE: 08b158-49.1	