

REMOVAL OF EXISTING CURB
 STA. 224+49 - STA. 224+75 RT

STEEL BEAM GUARDRAIL, GALVANIZED
 STA. 221+85.50 - STA. 223+25.00 RT

STEEL BEAM GUARDRAIL, GALVANIZED W/8 FEET POSTS
 STA. 223+25.00 - STA. 224+75.00 RT

ANCHOR FOR STEEL BEAM RAIL
 STA. 221+85.5 RT

REMOVAL AND DISPOSAL OF GUARDRAIL
 STA. 221+95.00 - STA. 224+25.00 RT

DURABLE 4 INCH WHITE LINE (SEE OPTION ITEMS)
 STA. 219+50 - STA. 224+75 (SOLID LT & RT)

DURABLE 4 INCH YELLOW LINE (SEE OPTION ITEMS)
 STA. 219+50 - STA. 224+75 (SOLID LT & RT)
 STA. 222+50 - STA. 224+75 (DOUBLE SOLID RT)

DURABLE 8 INCH YELLOW LINE (SEE OPTION ITEMS)
 STA. 222+81 - STA. 224+75 (HATCHED RT)

TEMPORARY 4 INCH WHITE LINE, PAINT
 STA. 219+50 - STA. 224+75 (SOLID LT & RT)

TEMPORARY 4 INCH YELLOW LINE, PAINT
 STA. 219+50 - STA. 224+75 (SOLID LT & RT)
 STA. 222+50 - STA. 224+75 (DOUBLE SOLID RT)

REMOVING SIGNS
 AS SHOWN - 16

DELINEATOR WITH STEEL POST
 STA. 221+86 RT

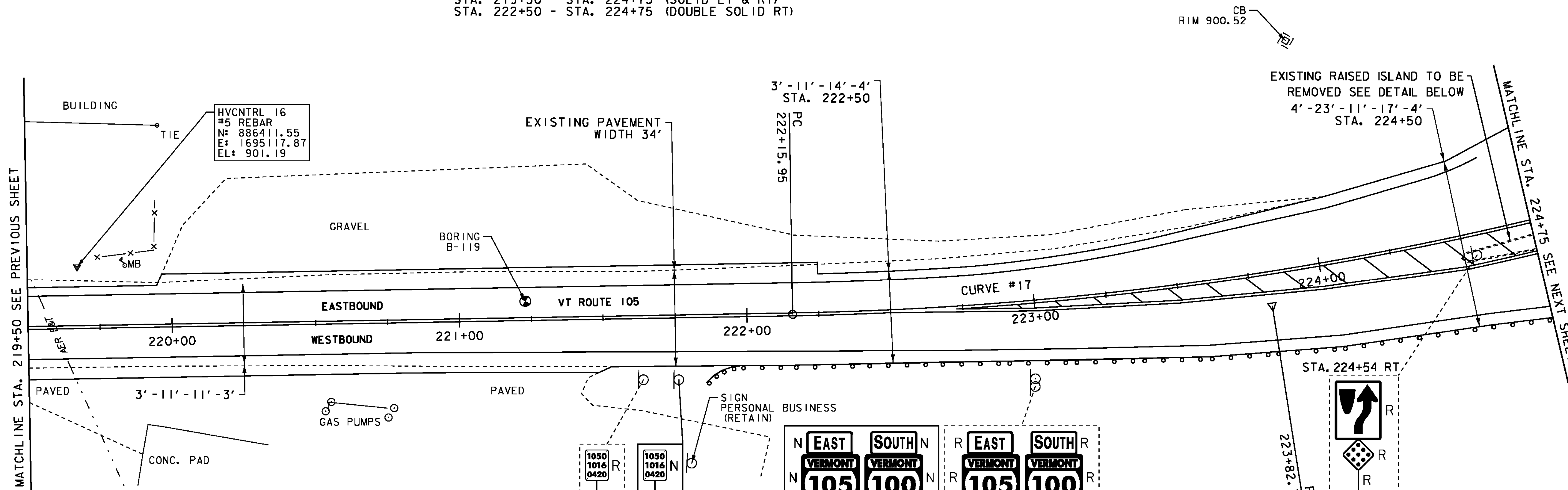
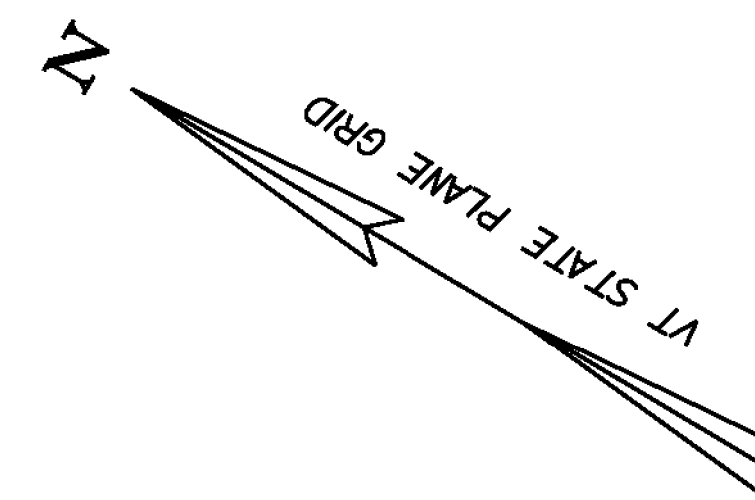

SIGN LEGEND

R = REMOVE
 R&S = REMOVE AND SALVAGE
 RET = RETAIN
 S = SALVAGE
 N = NEW
 B-B = BACK TO BACK

LEGEND

MAILBOX
 BORING
 SIGN
 HYDRANT
 MANHOLE
 WATER SHUT OFF (WSO)
 GAS PIPELINE MARKER
 CATCH BASIN / DROP INLET
 CURB INLET
 TRAFFIC CONTROL BOX
 PARKING METER
 UTILITY POLE

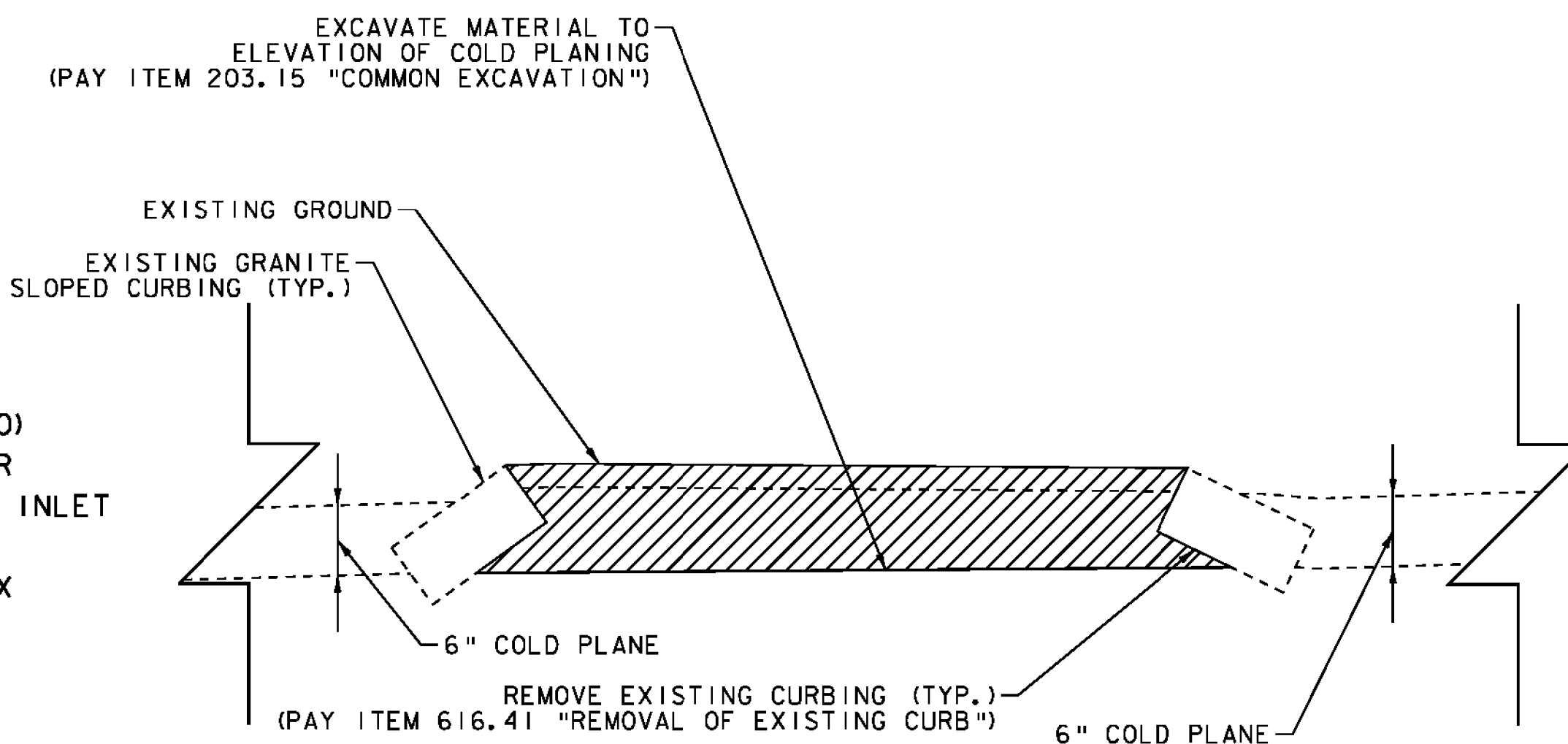

CURVE #17
 DELTA = 15° 49' 24"
 D = 4° 46' 29"
 R = 1200.00'
 T = 166.76'
 L = 331.40'
 E = 11.53'
 BANKING 0.044 FT/FT
 125' RUNOFF (50 MPH)

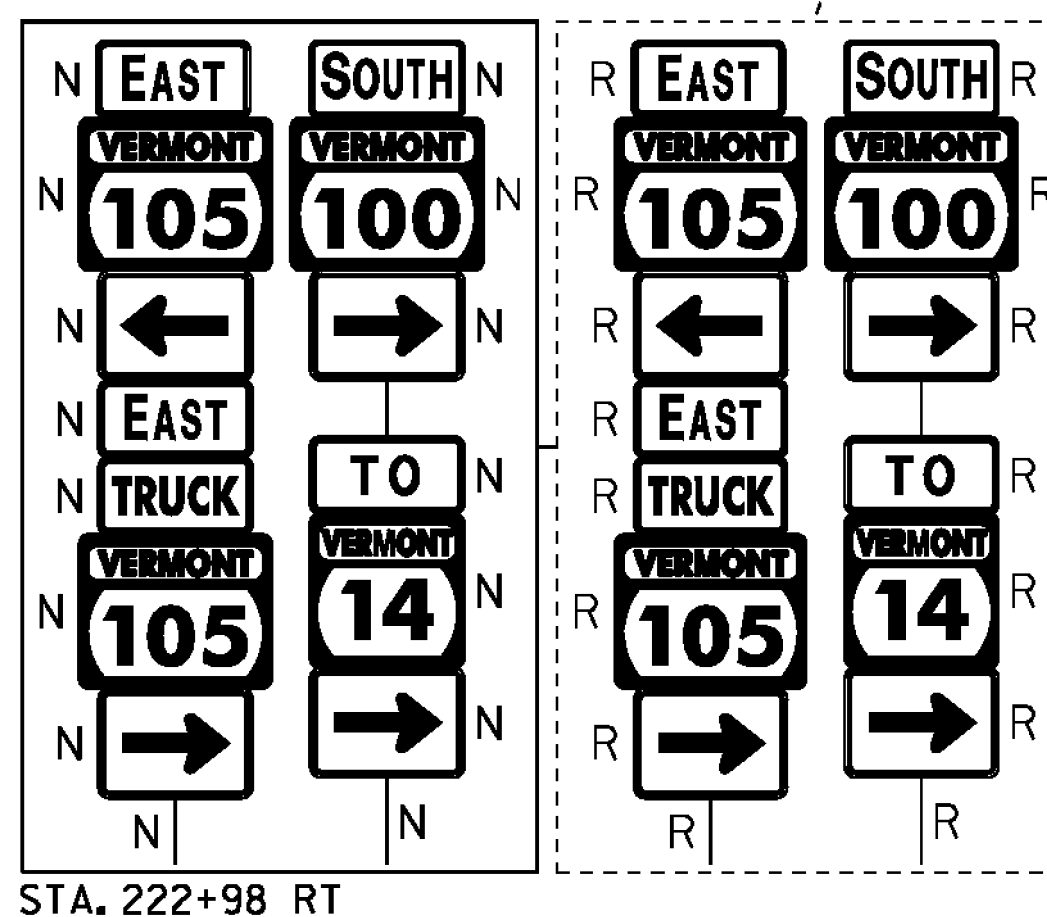

DATUM
 NAVD 88
 NAD 83

ISLAND REMOVAL

SCALE 1" = 20'-0"
 20 0 20

PROJECT LAYOUT SHEET 18

PROJECT NAME: NEWPORT-COVENTRY-NEWPORT
 PROJECT NUMBER: STP 2802(I)
 FILE NAME: 08b158.dgn
 PROJECT LEADER: CDL
 DESIGNED BY: BMB
 PLOT FILE: 08b158-45.I
 PLOT DATE: 8/3/2011
 DRAWN BY: BMB
 CHECKED BY: EPD
 SHEET 45 OF 134