

STEEL BEAM GUARDRAIL, GALVANIZED
 211+18 STA. 210+75.50 - STA. 212+77.50 RT 211+30.5
 STA. 211+40.00 - STA. 213+75.00 LT

STEEL BEAM GUARDRAIL, GALVANIZED WITH 8 FT POSTS
 STA. 212+77.50 - STA. 213+75.00 RT
 211+30.5

ANCHOR FOR STEEL BEAM RAIL
 STA. 210+75.5 RT 211+18 RT
 STA. 211+40 LT

REMOVAL AND DISPOSAL OF GUARDRAIL
 STA. 211+40.00 - STA. 213+75.00 RT
 STA. 211+42.00 - STA. 213+75.00 LT

DURABLE 4 INCH WHITE LINE (SEE OPTION ITEMS)
 STA. 208+25 - STA. 213+75 (SOLID LT & RT)

DURABLE 4 INCH YELLOW LINE (SEE OPTION ITEMS)
 STA. 208+25 - STA. 213+75 (SOLID LT & RT)

TEMPORARY 4 INCH WHITE LINE, PAINT
 STA. 208+25 - STA. 213+75 (SOLID LT & RT)

TEMPORARY 4 INCH YELLOW LINE, PAINT
 STA. 208+25 - STA. 213+75 (SOLID LT & RT)

REMOVING SIGNS
 AS SHOWN - 7

DELINEATOR WITH STEEL POST
 STA. 210+76 RT
 STA. 211+40 LT

RELOCATE MAILBOX, SINGLE SUPPORT
 STA. 209+87 LT

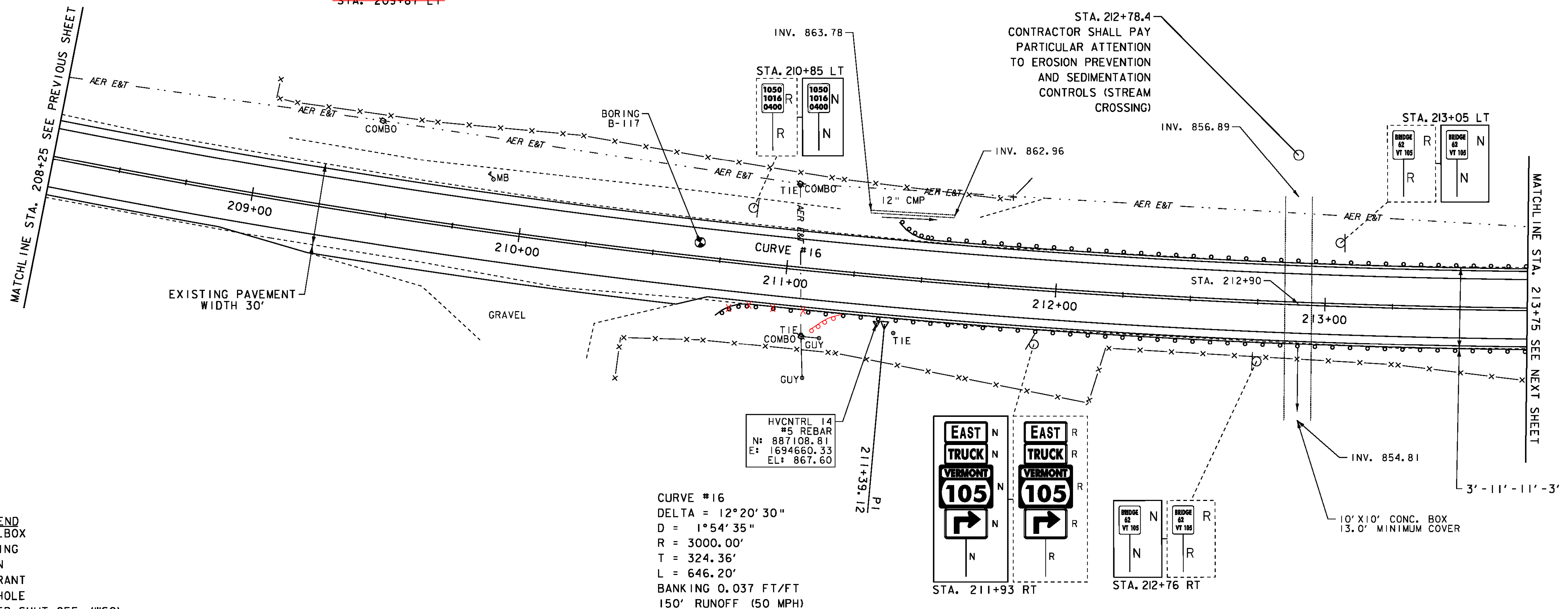

- LEGEND**
- MAILBOX
 - BORING
 - SIGN
 - HYDRANT
 - MANHOLE
 - WATER SHUT OFF (WSO)
 - GAS PIPELINE MARKER
 - CATCH BASIN / DROP INLET
 - CURB INLET
 - TRAFFIC CONTROL BOX
 - PARKING METER
 - UTILITY POLE

- SIGN LEGEND**
- R = REMOVE
 - R&S = REMOVE AND SALVAGE
 - RET = RETAIN
 - S = SALVAGE
 - N = NEW
 - B-B = BACK TO BACK

CURVE #16
 DELTA = 12°20'30"
 D = 1°54'35"
 R = 3000.00'
 T = 324.36'
 L = 646.20'
 BANKING 0.037 FT/FT
 150' RUNOFF (50 MPH)

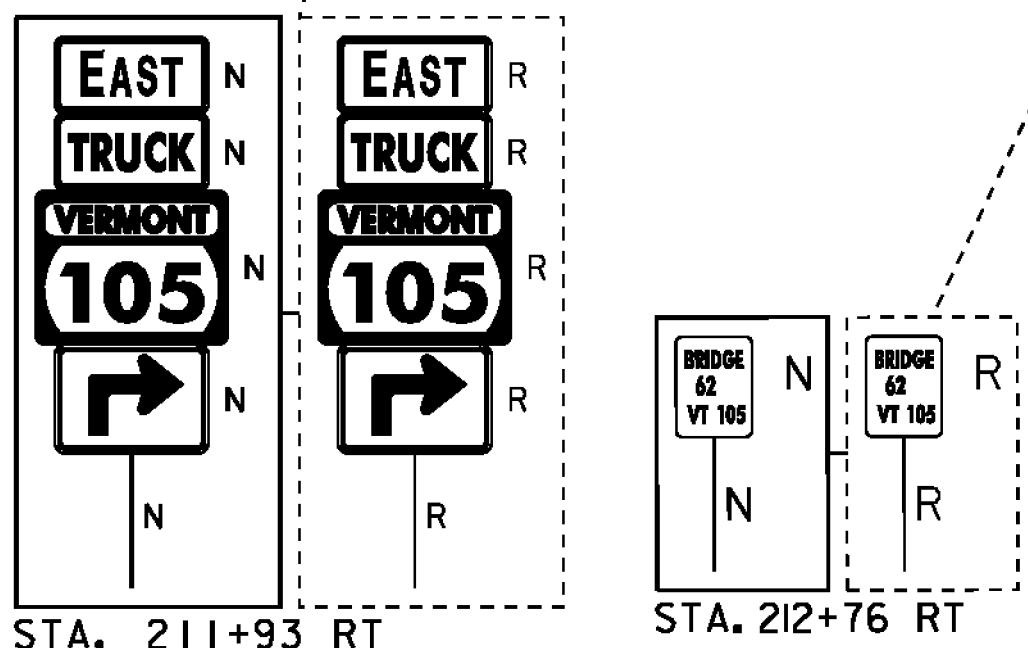

DATUM
 NAVD 88
 NAD 83

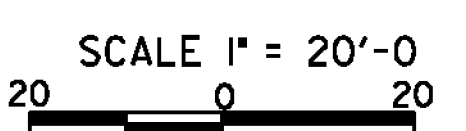

PROJECT LAYOUT SHEET 16	PROJECT NAME: NEWPORT-COVENTRY-NEWPORT	PLOT DATE: 8/3/2011
	PROJECT NUMBER: STP 2802(1)	DRAWN BY: BMB
	FILE NAME: 08b158.dgn	CHECKED BY: EPD
	DESIGNED BY: BMB	SHEET 43 OF 134
	PLOT FILE: 08b158-43.1	