

DURABLE 4 INCH WHITE LINE (SEE OPTION ITEMS)
 STA. 179+75 - STA. 185+50 (SOLID LT & RT)
 DURABLE 4 INCH YELLOW LINE (SEE OPTION ITEMS)
 STA. 179+75 - STA. 185+50 (SOLID LT & RT)

TEMPORARY 4 INCH WHITE LINE, PAINT
 STA. 179+75 - STA. 185+50 (SOLID LT & RT)
 TEMPORARY 4 INCH YELLOW LINE, PAINT
 STA. 179+75 - STA. 185+50 (SOLID LT & RT)

RELOCATE MAILBOX, SINGLE SUPPORT
 STA. 181+48 LT

CURVE #10
 DELTA = 2°38'10"
 D = 1°54'35"
 R = 3000.00'
 T = 69.03'
 L = 138.03'
 BANKING 0.037 FT/FT
 150' RUNOFF (50 MPH)

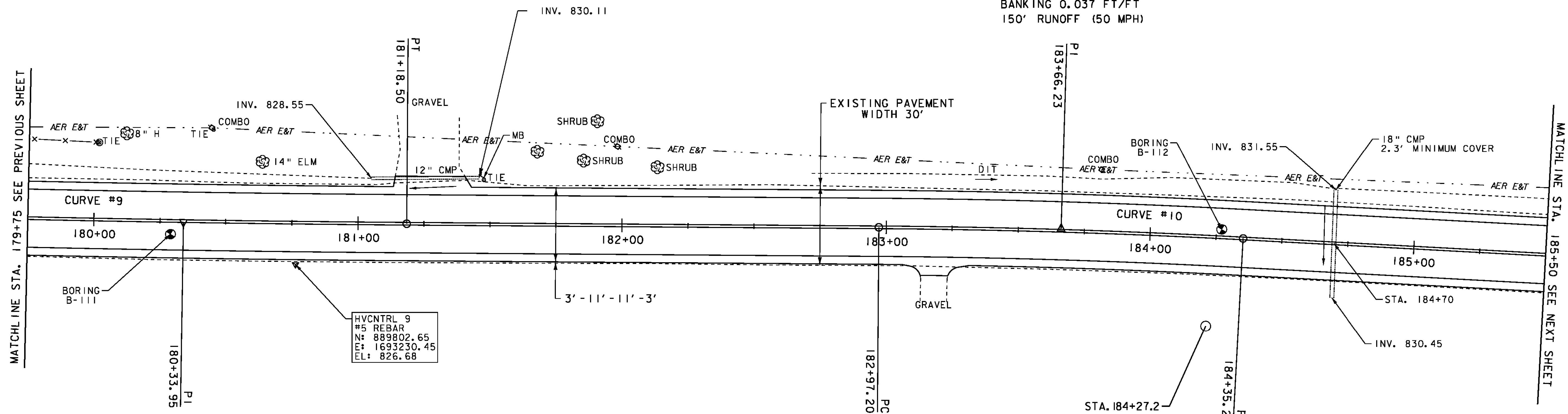

CURVE #9
 DELTA = 0°58'08"
 D = 0°34'23"
 R = 10000.00'
 T = 84.56'
 L = 169.12'
 NORMAL CROWN (50 MPH)

STA. 184+27.2
 CONTRACTOR SHALL PAY PARTICULAR ATTENTION TO EROSION PREVENTION AND SEDIMENTATION CONTROLS (INTERMITTENT STREAM FEEDING INTO WETLANDS)

HVCNTRL 9
 #5 REBAR
 N: 889802.65
 E: 1693230.45
 EL: 826.68

- LEGEND**
- MAILBOX
 - BORING
 - SIGN
 - HYDRANT
 - MANHOLE
 - WATER SHUT OFF (WSO)
 - GAS PIPELINE MARKER
 - CATCH BASIN / DROP INLET
 - CURB INLET
 - ⊗ TRAFFIC CONTROL BOX
 - ⊕ PARKING METER
 - ⊖ UTILITY POLE

- SIGN LEGEND**
- R = REMOVE
 - R&S = REMOVE AND SALVAGE
 - RET = RETAIN
 - S = SALVAGE
 - N = NEW
 - B-B = BACK TO BACK

DATUM
 NAVD 88
 NAD 83

SCALE 1" = 20'-0"
 20 0 20

PROJECT LAYOUT SHEET 11

PROJECT NAME: NEWPORT-COVENTRY-NEWPORT
 PROJECT NUMBER: STP 2802(1)
 FILE NAME: 08b158.dgn
 PROJECT LEADER: CDL
 DESIGNED BY: BMB
 PLOT FILE: 08b158-38.1
 PLOT DATE: 8/3/2011
 DRAWN BY: BMB
 CHECKED BY: EPD
 SHEET 38 OF 134