

CURVE #6
 DELTA = 3°13'50"
 D = 0°28'39"
 R = 12000.00'
 T = 338.39'
 L = 676.60'
 NORMAL CROWN (50 MPH)

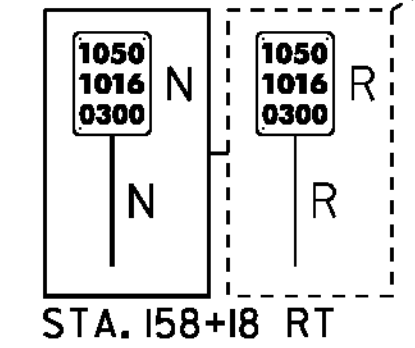
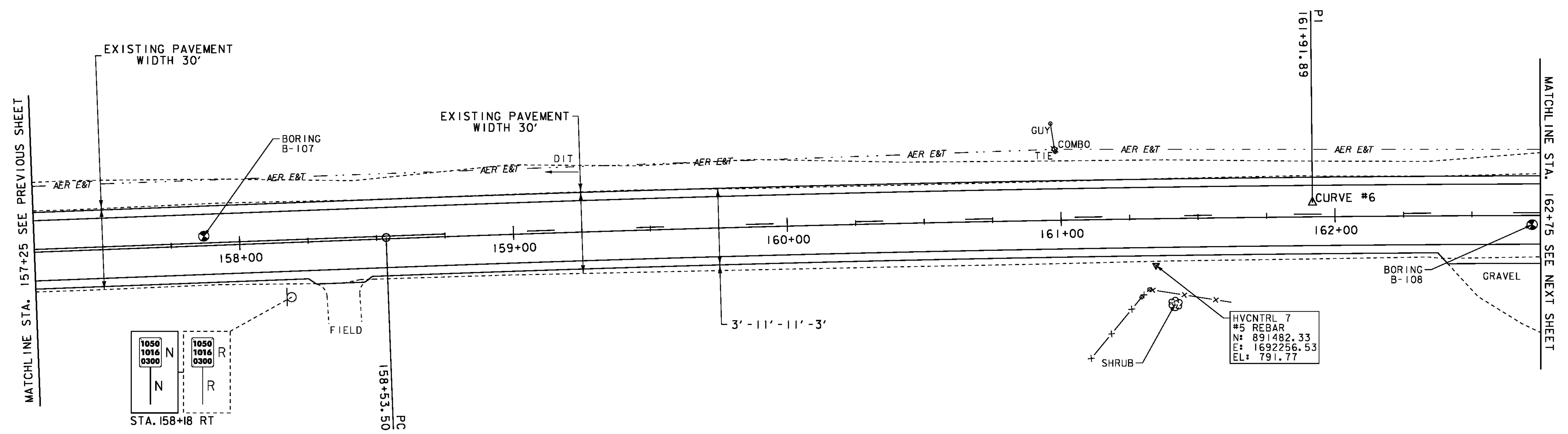
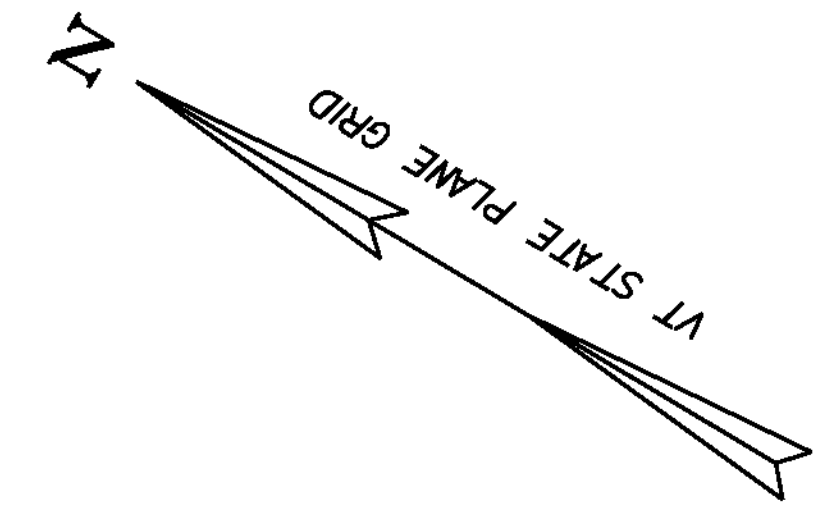

HVCNTRL 7
 #5 REBAR
 N: 891482.33
 E: 1692256.53
 EL: 791.77

DURABLE 4 INCH WHITE LINE (SEE OPTION ITEMS)
 STA. 157+25 - STA. 162+75 (SOLID LT & RT)

DURABLE 4 INCH YELLOW LINE (SEE OPTION ITEMS)
 STA. 157+25 - STA. 158+75 (SOLID LT & RT)
 STA. 158+75 - STA. 162+75 (DASHED LT)
 STA. 158+75 - STA. 162+75 (SOLID RT)

TEMPORARY 4 INCH WHITE LINE, PAINT
 STA. 157+25 - STA. 162+75 (SOLID LT & RT)

TEMPORARY 4 INCH YELLOW LINE, PAINT
 STA. 157+25 - STA. 158+75 (SOLID LT & RT)
 STA. 158+75 - STA. 162+75 (DASHED LT)
 STA. 158+75 - STA. 162+75 (SOLID RT)

REMOVING SIGNS
 AS SHOWN - 1

- LEGEND**
- MAILBOX
 - BORING
 - SIGN
 - HYDRANT
 - MANHOLE
 - WATER SHUT OFF (WSO)
 - GAS PIPELINE MARKER
 - CATCH BASIN / DROP INLET
 - CURB INLET
 - TRAFFIC CONTROL BOX
 - PARKING METER
 - UTILITY POLE

- SIGN LEGEND**
- R = REMOVE
 - R&S = REMOVE AND SALVAGE
 - RET = RETAIN
 - S = SALVAGE
 - N = NEW
 - B-B = BACK TO BACK

DATUM
 NAVD 88
 NAD 83

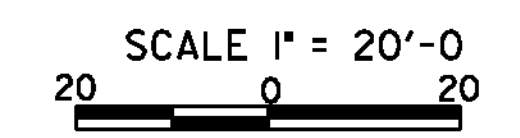

PROJECT LAYOUT SHEET 7

PROJECT NAME: NEWPORT-COVENTRY-NEWPORT
 PROJECT NUMBER: STP 2802(I)

FILE NAME: 08b158.dgn
 PROJECT LEADER: CDL
 DESIGNED BY: BMB
 PLOT FILE: 08b158-34.1

PLOT DATE: 8/3/2011
 DRAWN BY: BMB
 CHECKED BY: EPD
 SHEET 34 OF 134