

REHAB. DROP INLETS, CATCH BASINS,  
OR MANHOLES, CLASS I OR CLASS II

STA. 142+07 RT "TYPE D GRATE"  
STA. 142+10 LT "TYPE D GRATE"

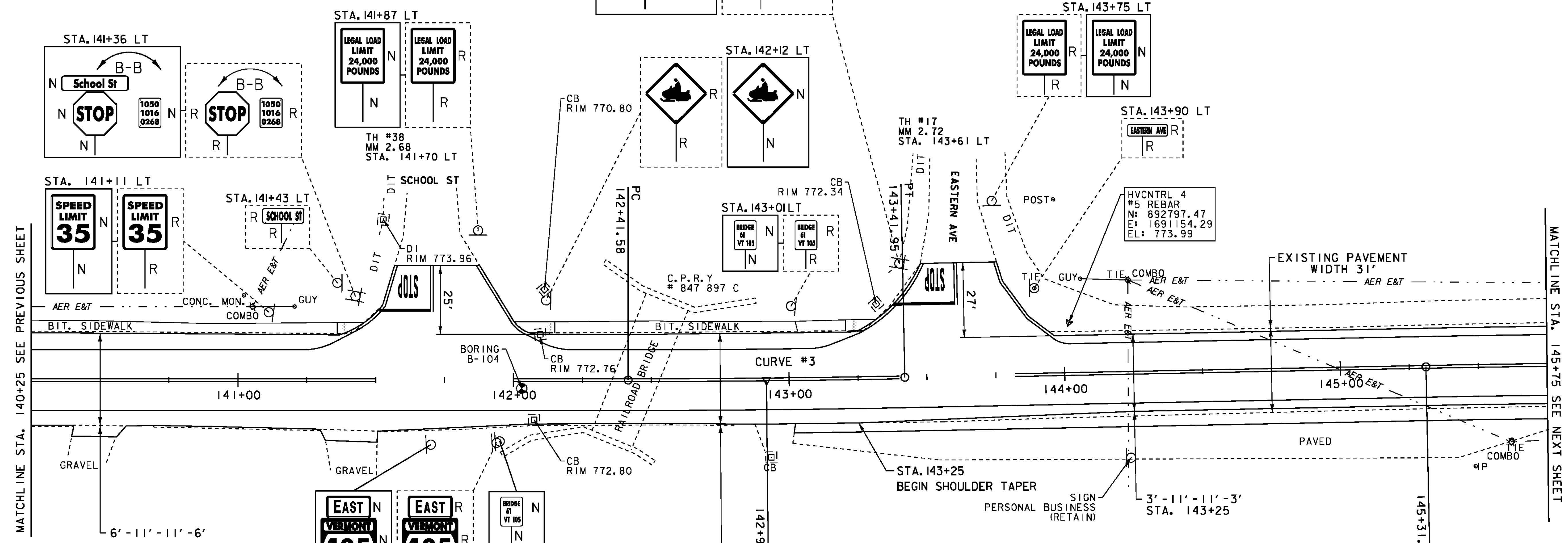

- SIGN LEGEND**
- R = REMOVE
  - R&S = REMOVE AND SALVAGE
  - RET = RETAIN
  - S = SALVAGE
  - N = NEW
  - B-B = BACK TO BACK

- LEGEND**
- MAILBOX
  - BORING
  - SIGN
  - HYDRANT
  - MANHOLE
  - WATER SHUT OFF (WSO)
  - GAS PIPELINE MARKER
  - CATCH BASIN / DROP INLET
  - CURB INLET
  - TRAFFIC CONTROL BOX
  - PARKING METER
  - UTILITY POLE

- DURABLE 4 INCH WHITE LINE (SEE OPTION ITEMS)**
- STA. 140+25 - STA. 145+75 (SOLID LT & RT) (WITH EDGELINE BREAKS AT TOWN ROADS)
- DURABLE 4 INCH YELLOW LINE (SEE OPTION ITEMS)**
- STA. 140+25 - STA. 145+75 (SOLID LT & RT) (WITH CENTERLINE BREAKS AT TOWN ROADS)
  - STA. 141+70 LT (CENTERLINE TH#38)
  - STA. 143+61 LT (CENTERLINE TH#17)
- DURABLE 24 INCH STOP BAR (SEE OPTION ITEMS)**
- STA. 141+51 - STA. 141+70 LT
  - STA. 143+38 - STA. 143+61 LT
- DURABLE LETTER OR SYMBOL (SEE OPTION ITEMS)**
- STA. 141+62 LT "STOP"
  - STA. 143+54 LT "STOP"

- TEMPORARY 4 INCH WHITE LINE, PAINT**
- STA. 140+25 - STA. 145+75 (SOLID LT & RT) (WITH EDGELINE BREAKS AT TOWN ROADS)
- TEMPORARY 4 INCH YELLOW LINE, PAINT**
- STA. 140+25 - STA. 145+75 (SOLID LT & RT) (WITH CENTERLINE BREAKS AT TOWN ROADS)
  - STA. 141+70 LT (CENTERLINE TH#38)
  - STA. 143+61 LT (CENTERLINE TH#17)
- TEMPORARY 24 INCH STOP BAR, PAINT**
- STA. 141+51 - STA. 141+70 LT
  - STA. 143+38 - STA. 143+61 LT
- TEMPORARY LETTER OR SYMBOL, PAINT**
- STA. 141+62 LT "STOP"
  - STA. 143+54 LT "STOP"

REMOVING SIGNS  
AS SHOWN - 14

DATUM	NAVD 88
	NAD 83

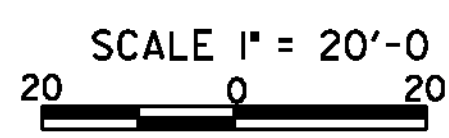

<b>PROJECT LAYOUT SHEET 4</b>	PROJECT NAME: NEWPORT-COVENTRY-NEWPORT
	PROJECT NUMBER: STP 2802(I)
	FILE NAME: 08b158.dgn
	PLOT FILE: 08b158-31.I
	PLOT DATE: 8/2/2011
	DRAWN BY: BMB
	CHECKED BY: EPD
	SHEET 31 OF 134