

**TRAFFIC CONTROL GENERAL NOTES:**

1. THE TRAFFIC CONTROL PHASE I PLAN IS SUGGESTED FOR CONSTRUCTION PURPOSES. THE CONTRACTOR SHALL HAVE THE OPTION OF SUBMITTING A SEPARATE TRAFFIC CONTROL PLAN TO THE RESIDENT ENGINEER FOR REVIEW AND APPROVAL.
2. REFER TO E-SERIES VERMONT STATE STANDARDS AND THE LATEST VERSION OF THE M.U.T.C.D. FOR DETAILED INFORMATION REGARDING CHANNELIZATION DEVICES, TAPER LENGTHS, BARRICADES, DETOURS, LONGITUDINAL DROP-OFFS AND MISCELLANEOUS TRAFFIC CONTROL DETAILS, IF APPLICABLE.
3. EXISTING SIGNS SHALL BE COVERED OR REMOVED WHEN THEY CONFLICT WITH CONSTRUCTION TRAFFIC OPERATIONS.
4. THE POSTED SPEED LIMIT FOR ALL PHASES OF WORK SHALL BE 30 M.P.H.
5. THE CONTRACTOR SHALL MAINTAIN ACCESS TO ALL DRIVEWAYS DURING CONSTRUCTION.
6. FURNISHING, INSTALLING, MAINTENANCE OF, RELOCATING AND REMOVING REFLECTORIZED DRUMS AND CONSTRUCTION SIGNING FOR TRAFFIC SHIFTS SHALL BE PAID FOR UNDER ITEM NO. 641.10 - TRAFFIC CONTROL.
7. TEMPORARY SUBBASE AND SURFACE COURSE MATERIALS NOT INCORPORATED INTO THE COMPLETE AND ACCEPTED WORK WILL BE PAID FOR UNDER THE APPROPRIATE SECTION 900 (TEMPORARY ROADWAY) OR (TEMPORARY ROADWAY WIDENING) PAY ITEM.
8. THE CONTRACTOR SHALL PROVIDE FOUR (4) PORTABLE CHANGEABLE MESSAGE SIGNS FOR THE DURATION OF THE PROJECT. THE LOCATION AND MESSAGE CONTENT SHALL BE DETERMINED IN THE FIELD BY THE RESIDENT ENGINEER.
9. ALL WORK SHALL BE WITHIN THE EXISTING VERMONT AND TOWN OF HYDE PARK RIGHT-OF-WAY.

**POTENTIAL CONSTRUCTION ACTIVITIES ASSOCIATED WITH TRAFFIC CONTROL, PHASE I**

1. PRIOR TO THE COMMENCEMENT OF ANY WORK OR THE PLACEMENT OF EQUIPMENT ON THE ROADWAY THE CONTRACTOR SHALL PROVIDE ADVANCED WARNING SIGNS IN ACCORDANCE WITH THE CONSTRUCTION SIGNING APPROACH PLAN AND THE LATEST VERSION OF THE M.U.T.C.D.
2. INSTALL AND MAINTAIN EROSION PREVENTION AND SEDIMENT CONTROL MEASURES IN ACCORDANCE WITH THE EROSION CONTROL PLANS AND DETAILS IN ADDITION TO THE VERMONT DEPARTMENT OF ENVIRONMENTAL CONSERVATION'S "LOW RISK SITE HANDBOOK FOR EROSION PREVENTION AND SEDIMENT CONTROL."
3. REMOVE THE EXISTING FLASHING BEACON. THIS SHALL BE PAID FOR UNDER CONTRACT ITEM 900.620 - SPECIAL PROVISION (REMOVAL OF EXISTING TRAFFIC CONTROL SIGNAL SYSTEM).
4. REMOVE THE CHURCH STREET SLIP RAMP AND ISLAND. SALVAGE THE CURBING TO VITIGONS ACCORDING TO THE SPECIAL PROVISIONS AND AS DIRECTED BY THE RESIDENT ENGINEER.
5. CONSTRUCT TEMPORARY WIDENING FOR DETOURS TO FACILITATE WORK UNDER PHASE 2 AS SHOWN.
6. TEMPORARY SUBBASE AND SURFACE COURSE MATERIALS FOR ROADWAY WIDENINGS DETAILED ON THIS SHEET WILL BE PAID FOR UNDER CONTRACT ITEM 900.645 - SPECIAL PROVISION (TEMPORARY ROADWAY WIDENING(PHASE I)). THIS TEMPORARY WIDENING SHALL BE REMOVED IN PHASE 3.

**NOTES:**

1. THE POTENTIAL CONSTRUCTION ACTIVITIES MAY BE ALTERED AND/OR REORDERED AS DIRECTED BY THE RESIDENT ENGINEER.

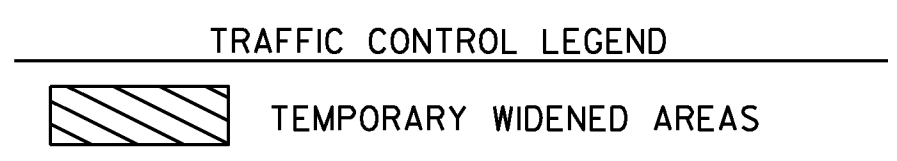

PROJECT NAME:	HYDE PARK	FILE NAME:	+08b126frm.dgn	PLOT DATE:	08-DEC-2010
PROJECT NUMBER:	HES 030-2(23)	PROJECT LEADER:	JLS	DRAWN BY:	MBL
		DESIGNED BY:	MBL	CHECKED BY:	JAD
		TRAFFIC CONTROL PLAN PHASE I		SHEET 69	OF 100