

VT 17
CLOSED

PORTABLE CHANGABLE SIGN - PHASE 1

NORTH OF
CHIMNEY
POINT

PORTABLE CHANGABLE SIGN - PHASE 2

* MMM DD -
* MMM DD

PORTABLE CHANGABLE SIGN - PHASE 3

* M=MONTH
D=DAY

S

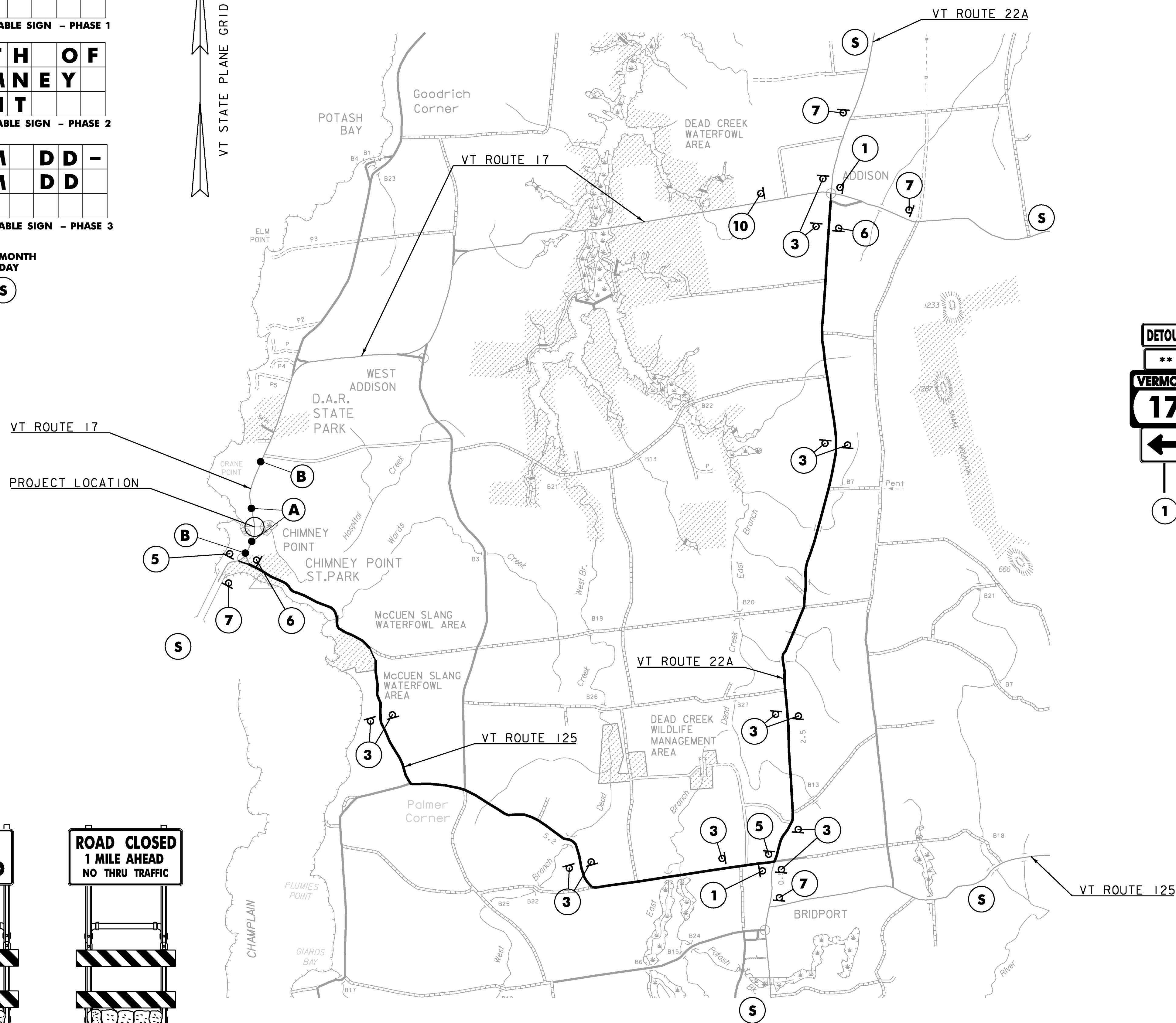
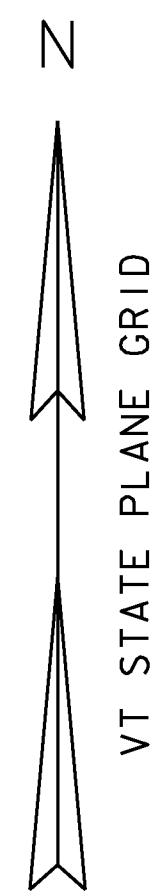

SIGN MOUNTING ON
TYPE III BARRICADE
(MODIFIED)

A

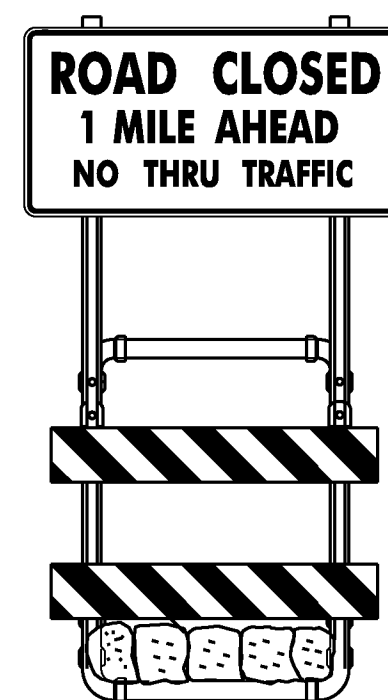

SIGN MOUNTING ON
TYPE III BARRICADE
(MODIFIED)

B

DETOUR PLAN
NOT TO SCALE

ROAD CLOSED
XX MILES AHEAD
NO THRU TRAFFIC

10

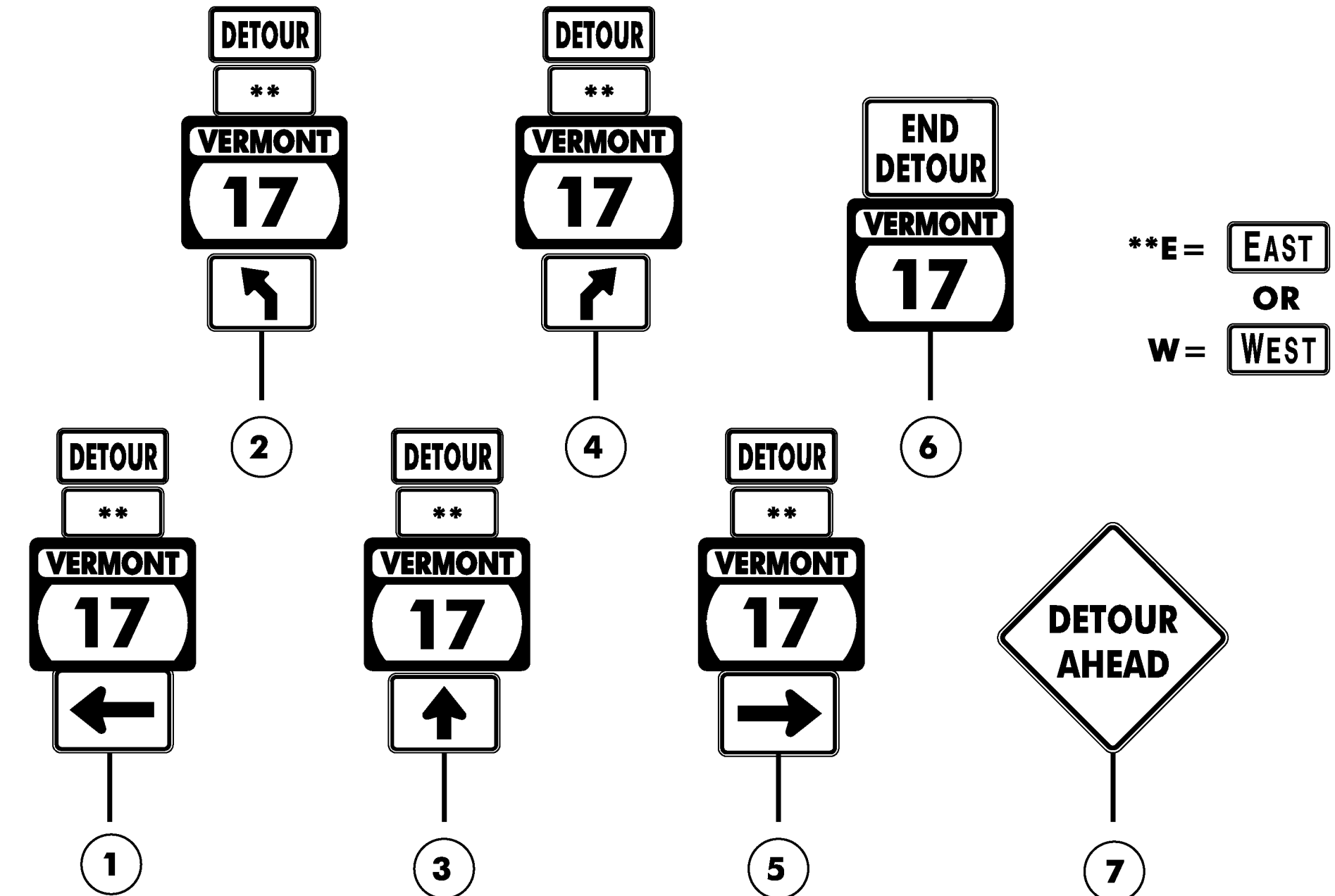

NOTES:

1. THE PORTABLE CHANGABLE MESSAGE SIGNS SHALL BE FULLY OPERATIONAL A MINIMUM OF TWO WEEKS PRIOR TO THE CLOSURE OF VT 17.
2. DURING ACTUAL CLOSURE, ELIMINATE PHASE 3 ONLY.
3. DETOUR SIGNS SHALL BE LOCATED ADJACENT TO EXISTING INTERSECTION ROUTE MARKER ASSEMBLIES WHERE APPLICABLE.
4. CONFIRMATION ROUTE MARKERS (SIGN 3) SHALL BE PLACED IMMEDIATELY AFTER EACH TURN AND AT ALL LOCATIONS ALONG THE DETOUR ROUTE WHERE ROUTE MARKERS FOR THE PARENT ROUTE EXIST.
5. DETOUR SIGNING IS THE RESPONSIBILITY OF THE CONTRACTOR. PAYMENT FOR ALL TEMPORARY TRAFFIC CONTROL DEVICES FOR IMPLEMENTING THE DETOUR, INCLUDING BUT NOT LIMITED TO SIGNS, BARRICADES AND MESSAGE BOARDS, WILL BE INCLUDED IN THE UNIT PRICE BID FOR CONTRACT ITEM 900.645 SPECIAL PROVISION (TRAFFIC CONTROL, ALL-INCLUSIVE).
6. THIS DETOUR PLAN IS AN OUTLINE ONLY AND THE CONTRACTOR SHALL SUBMIT A DETAILED PLAN OF EACH INTERSECTION SHOWING DETOUR SIGN LOCATIONS IN RELATION TO EXISTING SIGNS.

PROJECT NAME: ADDISON
PROJECT NUMBER: STP CULV(I4)

FILE NAME: s08b062detour.dgn
PROJECT LEADER: K. HIGGINS
DESIGNED BY: J. SALVATORI
DETOUR PLAN

PLOT DATE: 15-MAR-2013
DRAWN BY: J. SALVATORI
CHECKED BY: W. LAMMER
SHEET II OF 28