

R.O.W. PLANS

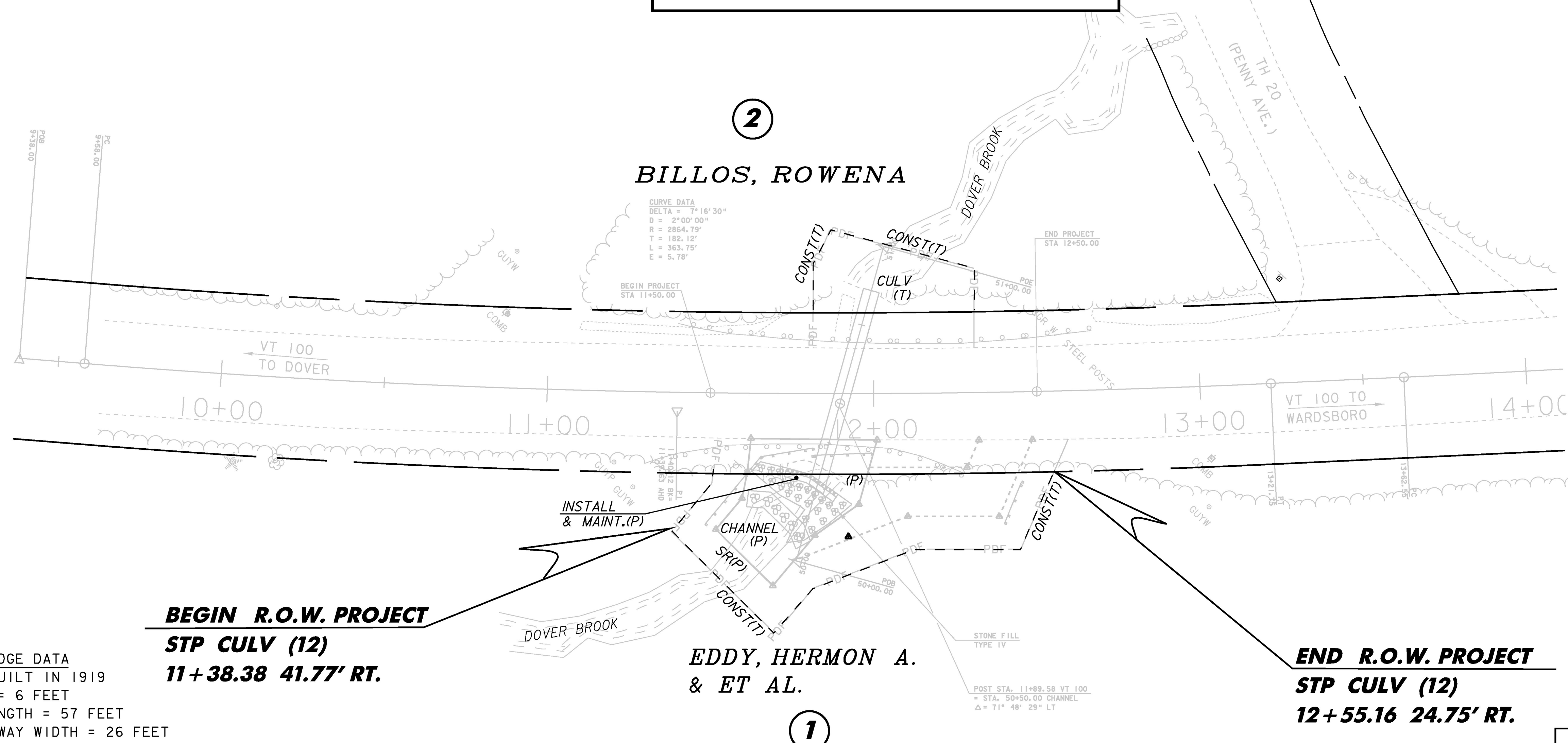
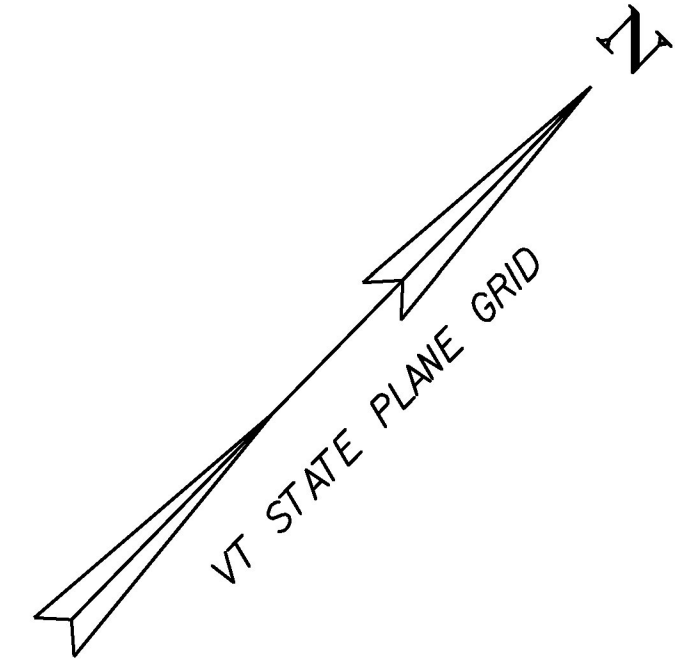
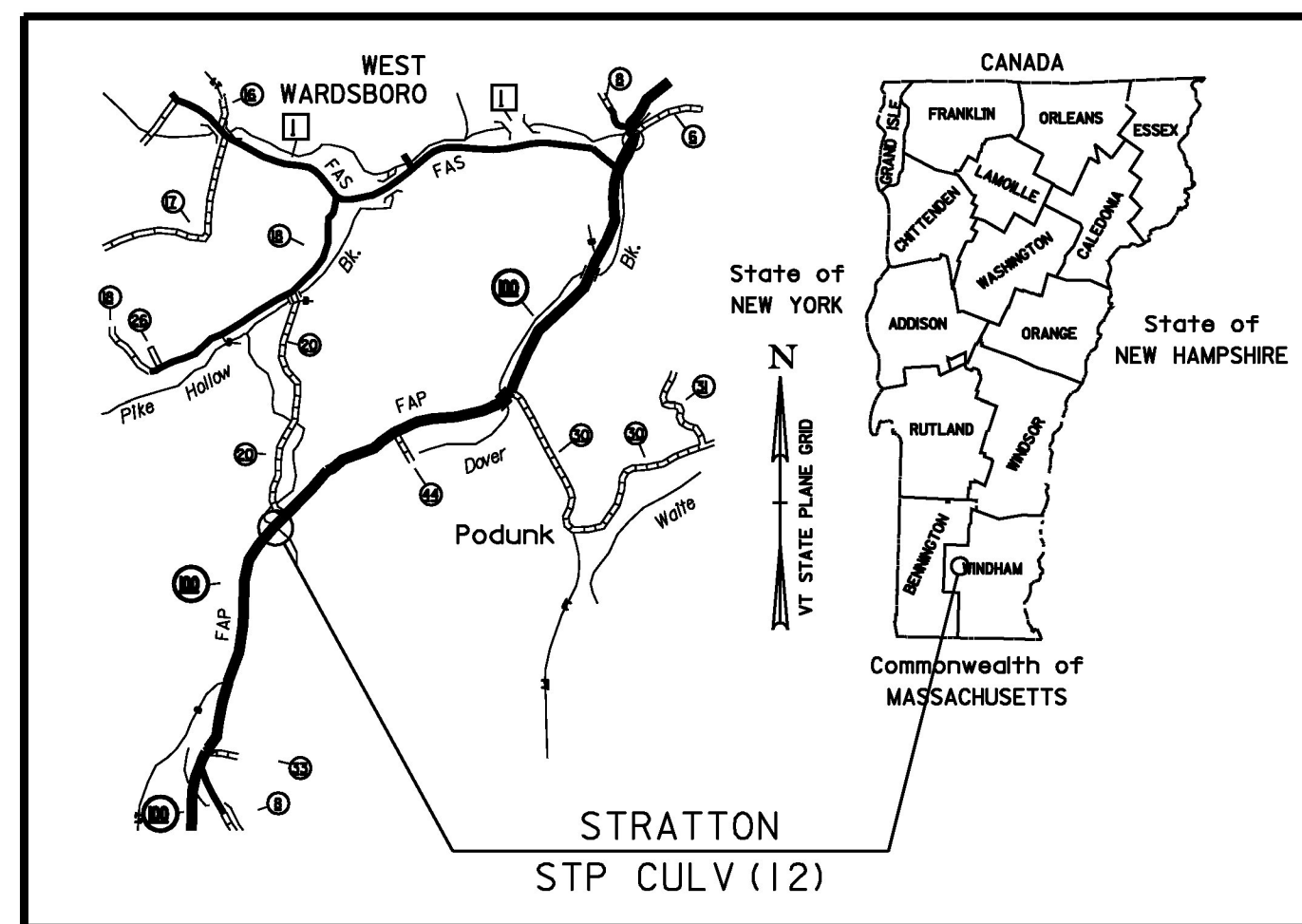

TABLE OF REVISIONS			
REVISION NO.	SHEET NO.	DESCRIPTION	DATE
1	1	PARCEL NO. 2 BILLOS, CHANGE CULVERT (P) TO CULVERT (T) PER C.O. 9612 MADE BY: HR.	05/20/10
		APPROVED BY: HP	
		ELECTRONIC FILES TO STRUCTURES	6-1-10

EXISTING BRIDGE DATA
 72" ACCGMP BUILT IN 1919
 SPAN LENGTH = 6 FEET
 STRUCTURE LENGTH = 57 FEET
 APPROX. ROADWAY WIDTH = 26 FEET

BEGIN R.O.W. PROJECT
STP CULV (12)
11 + 38.38 41.77' RT.

END R.O.W. PROJECT
STP CULV (12)
12 + 55.16 24.75' RT.

TABLE OF PROPERTY ACQUISITION

PARCEL NO.	PROPERTY OWNER	SHEET NO.	BEGINNING STATION	ENDING STATION	TAKE	REMAINDER	RIGHT			RECORDING DATA				REMARKS		
					AREA±	AREA±	TYPE	(T)/(P)	AREA ±	TITLE	DATE	TOWN / CITY	BOOK		PAGE	
1	EDDY, HERMON A. ET AL.	1	11+38.38 RT.	12+55.16 RT.			CONST	(T)	2,389 SF	WD	04/21/10	STRATTON	143	394	INCLUDES EROSION CONTROL & PDF	
			11+52.25 RT.	11+98.19 RT.			SLOPE	(P)	921 SF							
			11+62.90 RT.	11+93.28 RT.			CHANNEL	(P)	442 SF							
			11+72.44 RT.	11+91.28 RT.			INSTALL & MAINT.	(P)	119 SF							
2	BILLOS, ROWENA	1	11+81.14 LT.	12+31.75 LT.			CONST.	(T)	910 SF			STRATTON			INCLUDES EROSION CONTROL & PDF	
			11+94.81 LT.	12+01.85 LT.			CULVERT	(T)								

FOR R.O.W. USE ONLY

LINES SHOWN ON THIS PLAN AS EXISTING PROPERTY LINES P/L ARE BELIEVED TO BE ACCURATE BUT SHOULD NOT BE RELIED UPON FOR PURPOSES UNRELATED TO THE STATE OF VERMONT'S ACQUISITION OF LAND AND RIGHTS FOR THIS PROJECT.

SCALE 1" = 20' - 0"
 20 0 20

PROJECT NAME:	STRATTON	PLOT DATE:	01-JUN-2010
PROJECT NUMBER:	STP CULV(12)	DRAWN BY:	D.D.BEARD
FILE NAME:	s08b058bdr.dgn	DESIGNED BY:	H.J.SALLS
PROJECT LEADER:	C.P.WILLIAMS	ROW SHEET 1 OF 1	CHECKED BY: H.J. SALLS
			SHEET 11 OF 15