

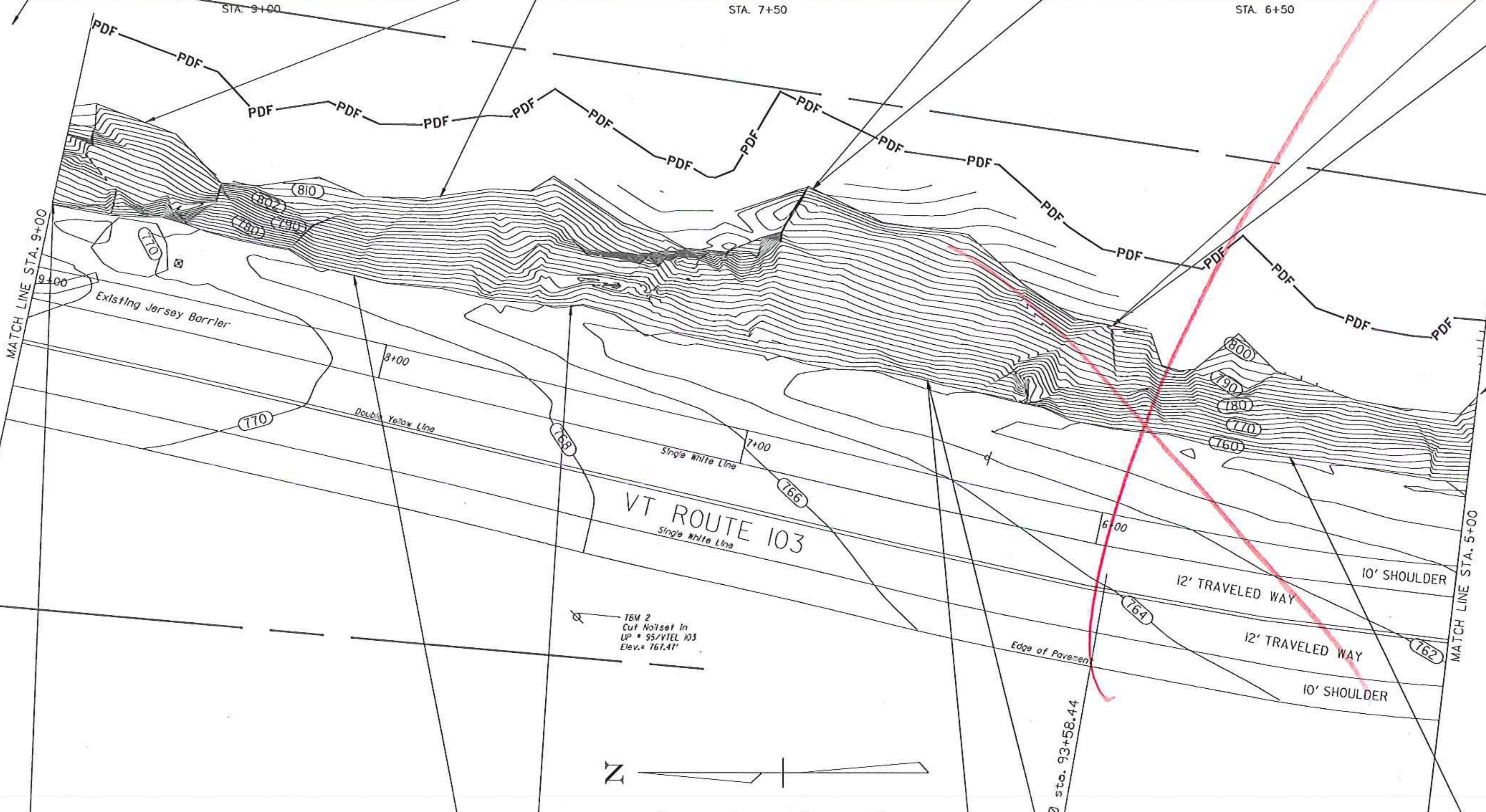

1 = 10'
2 = 15'
3 = 15'
4 = 15'
5 = 15'
6 = 15'



VOID

KEY
o = Rock Dowel
x = Rock Drain

- ☐ CATCH BASIN
- PROPOSED ROCK DOWEL
- PROPOSED ROCK DRAIN
- ▭ PORTION OF ROCK SLOPE TO BE SCALED/REMOVED
- ▭ SHOTCRETE BUTTRESS

- NOTES:
1. ALL DIMENSIONS ARE IN FEET UNLESS OTHERWISE NOTED.
 2. ALL DIMENSIONS TO BE CONFIRMED ON SITE BY CONTRACTOR. ALL DISCREPANCIES SHALL BE REPORTED TO THE ENGINEER IMMEDIATELY.
 3. ALL DRAWINGS SHOULD BE REVIEWED IN CONJUNCTION WITH CONTRACT DOCUMENTS.
 4. ALL WORK TO BE PERFORMED IN ACCORDANCE WITH CONTRACT DOCUMENTS.
 5. CONTRACTOR SHALL IDENTIFY ALL UNDERGROUND UTILITIES, USING DIGSAFE, PRIOR TO DRILLING OR OTHER SUBSURFACE ACTIVITIES.
 6. FINAL LOCATIONS OF ROCK DOWELS SHALL BE DETERMINED BY THE VTRANS GEOLOGIST AFTER SCALING.
 7. DURING INSTALLATION, VTRANS GEOLOGIST MAY IDENTIFY ADDITIONAL STABILIZATION LOCATIONS NOT ON THIS DRAWING.
 8. DIGITAL PHOTOGRAPHS TAKEN APRIL 16, 2008



1 = 20'
2 = 20'
3 = 20'
4 = 20'
5 = 20'
6 = 15'
7 = 15'
8 = 15'
9 = 15'



STA. 8+50

STA. 7+00

STA. 6+00

PROJECT NAME:	CHESTER	PLOT DATE:	23-NOV-2009
PROJECT NUMBER:	NH 025-1(41)	DRAWN BY:	P. PELOQUIN
FILE NAME:	d08b036nui.dgn	CHECKED BY:	S. MENARD
PROJECT LEADER:	K. ROBBIE	LAYOUT SHEET	2
DESIGNED BY:	P. PELOQUIN	SHEET	9
		OF	16